

POTENTIAL REPORT

Type Well: Oil X Gas _____ Distillate _____

Type Test: Comp. _____ Recomp. _____ Retest X Regauge _____

Parish CAMERON Field LITTLE CHENIER

Company ANSON CORP Serial No. 73882

Well Name & No. 888554 LABOUE "A" No. 1

Location: Sec. 17 Twp. 14S Rge. 6W Flowing X Pump _____

Prod. Horizon _____ Perf. Int. 8888' to 8893

Casing Setting: Size 5 1/2" @ 9550

Tubing Setting: Size 2" @ 8837 T.D. 9550

Date Completed _____ Date Gauged 12-12-64

Acidize with _____ gals. Elev. of Derr. Floor _____

TEST DATE

T. P. 1025 C. P. 0 Choke Size 9 /64th

Closing TK Gge. 6 ft. 5 in. @ 7:00 AM Time 12-11-64

Opening TK Gge. 5 ft. 6 in. @ 7:00 AM Time

Diff. 0 ft. 11 in. 2 Hours (Time)

Tank No. 28686 Tank Coef. 2.76

Bbls. per 24 Hrs. _____ Est. Bbls. per Day 30.42

Daily Gas Vol. 60 M.C.F. G/O Ratio 2.000:1

B.S.&W. 1.75 % Corrected Gravity 52 @ 76 Deg. A.P.I.

Witnessed [Signature] Title [Signature]

Gauged by Ben Haleomb Title Agent
Department of Conservation

District Office Lake Charles

Remarks: 3" x 1/4" O.P. - St 600# - Diff.

37" - Flg Taps Std. Chart.

Change from Gas to Oil Allowable

WORK RESUME

List below all work performed under Department of Conservation Work Permits while drilling and completing well.

WORK PERMIT NO.	DATE WORK PERFORMED	SERVICE COMPANY	DESCRIPTION OF WORK
LC 23	June 5th thru June 23rd	Eagle Well Service	Abd. perf 8888 - 8893 and complete in open perf. 9393 - 9398

List below all important Paleontological or Geological Formation tops, Cap Rock and Salt tops and Salt Overhang bottoms.

FORMATION	DEPTH	FORMATION	DEPTH



DEPARTMENT OF CONSERVATION

WELL HISTORY AND WORK RESUME REPORT

FIELD **WILDCAT**

SERIAL NO. **89294**

PRODUCING INTERVAL **8900-8904***

RESERVOIR (COMPANY SAND IDENTIFICATION)

Three typewritten copies of this report must be filed with the District Office of the Department of Conservation in which the well is located within twenty (20) days of the date of completion or recompletion. NOTE: If not properly completed and signed this report will be returned.

LEASE AND WELL DATA

DESIGNATE TYPE OF COMPLETION: NEW WELL RECOMPLETION SAME RESERVOIR DIFFERENT RESERVOIR OIL GAS P&A

OPERATOR **An-Son Petroleum Corporation** ADDRESS **810 Saratoga Building, New Orleans, La.**

LEASE NAME **La Bove** WELL NO. **1**

PARISH **Cameron** SEC. **14** TWP. **14S** RGE. **6W** DATE PERMIT ISSUED **3/19/62**

DATE SPUNDED **4/19/62** TOTAL DEPTH **Original Note 10,510'**
1st Side Track 10,662'
2nd Side Track 9550' PBTD

GROUND ELEVATION CASING HEAD, FLANGE ELEVATION DISTANCE FROM RKB TO CHF **12'**

DATE WELL TURNED INTO TANKS **Shut-in** SINGLE, DUAL OR TRIPLE COMPLETION? **Single** NOTE: IF THIS IS A MULTIPLE COMPLETION, FURNISH A SEPARATE REPORT FOR EACH COMPLETION

WAS WELL DIRECTIONALLY DRILLED? **yes** WAS DIRECTIONAL SURVEY MADE? **yes** WERE 3 COPIES FILED WITH THE DEPARTMENT OF CONSERVATION? **yes** DATE FILED **6/27/62**

TYPE OF ELECTRICAL OR OTHER LOGS RUN (CIRCLE LOGS FILED WITH DEPT. OF CONSERVATION) DATE FILED **Schlumberger IES - Sonic, Gamma Ray** **6/27/62**

CASING, LINER AND TUBING RECORD

CASING SIZE	HOLE SIZE	CASING WEIGHT	DEPTH SET	SACKS CEMENT	TEST PRESSURE	HRS. UNDER PRESSURE	DATE TESTED	NAME OF TEST WITNESS - STATE IF DEPT. AGENT OR OFFSET OPR.
14" DRIVEN								
9-5/8"	12"	32.3 & 36	2637	500	1500	1/2	4/22/62	
5-1/2"	8-1/2"	17#	9550	600	1500	1/2	6/17/62	
TUBING SIZE: 2-1/16" 0.0		DEPTH OF TUBING: 8837		DEPTH OF PACKER (S): 8841				

INITIAL COMPLETION OR RE-COMPLETION DATA

INITIAL PRODUCTION **240** GAS VOLUME **3714** CHOKER SIZE **16/64** WELL STATUS **Shut-in**

TUBING PRESSURE **2800** psi BOPD CASING PRESSURE **0** psi GOR **19471** BS & W **0** BHP - (SHUT-IN) %

GRAVITY **59.8** *API(60°F) CONSERVATION AGENT MAKING GAUGE COMPANY REPRESENTATIVE **Maurice Hinds** DATE GAUGED **6/23/62**

PLUG AND ABANDON (P&A) DATA

CASING SIZE	AMOUNT PULLED	CEMENT PLUGS				DATE WORK PERFORMED	NAME OF TEST WITNESS - STATE IF DEPT. AGENT OR OFFSET OPR.
		FROM	TO	SACKS	HOW PLACED		

CERTIFICATE: I, the undersigned, state: That I am employed by **An-Son Petroleum Corp.** and that I am authorized to make this report, and that this report was prepared under my supervision and direction and that all facts stated herein are true, correct and complete to the best of my knowledge.

Form WH

Signature: *[Signature]* Title:

RECEIVED JUN 20 1962 DEPARTMENT OF CONSERVATION LAKE CHARLES

WORK RESUME

List below all work performed under Department of Conservation Work Permits while drilling and completing well.

WORK PERMIT NO.	DATE WORK PERFORMED	SERVICE COMPANY	DESCRIPTION OF WORK
Plug & ST LC #12	5/9/62	Halliburton & HONCO	Plug back to 8141' and Directionally Drill Hole to 300' N 45° W of present location @ 10,350' TVD
Plug & ST LC #14	5/23/62	Halliburton & HONCO	Plug back to approximately 7000' and Directionally Drill Hole to 225° South 50° East of present location @ 8875' TVD
Perf. LC #269	6/17/62	Great Lakes Petroleum Svs.	Perforate 9393-9398' (ELM) w/4 jet shots per foot and test for production.
Plug & Perforate LC #75	6/21/62	Great Lakes Petroleum Svs.	Set Baker Model D Production Packer with blanking plug at approximately 9341' to blank off perforations 9393-9398'. Perforated 8900- 9004 8704, with 4 jet shots and test for production.

List below all important Paleofaunal or Geological Formation tops, Cap Rock and Salt tops and Salt Overhang bottoms.

FORMATION	DEPTH	FORMATION	DEPTH

2

 <p>DEPARTMENT OF CONSERVATION WELL HISTORY AND WORK RESUME REPORT</p>		FIELD Little Cheniere						
		SERIAL NO. 93672						
		PRODUCING INTERVAL						
		RESERVOIR (COMPANY SAND IDENTIFICATION)						
<p>Three typewritten copies of this report must be filed with the District Office of the Department of Conservation in which the well is located within twenty (20) days of the date of completion or recompletion. NOTE: If not properly completed and signed this report will be returned.</p>								
LEASE AND WELL DATA								
DESIGNATE TYPE OF COMPLETION: NEW WELL <input checked="" type="checkbox"/> RECOMPLETION <input type="checkbox"/> SAME RESERVOIR <input type="checkbox"/> DIFFERENT RESERVOIR <input type="checkbox"/> OIL <input type="checkbox"/> GAS <input type="checkbox"/> P&A <input type="checkbox"/>								
OPERATOR An-Son Corporation		ADDRESS Suite 810 Saratoga Building, New Orleans 12, L.						
LEASE NAME Mermentau Mineral & Land Company, Inc.		WELL NO. 1						
PARISH Cameron	SEC. 14 TWP. 14S RGE. 6W	DATE PERMIT ISSUED December 10, 1962						
DATE SPUDDED Jan. 7, 1963	TOTAL DEPTH 10,577'	PBTD -						
GROUND ELEVATION -	CASING HEAD FLANGE ELEVATION -	DISTANCE FROM RKB TO CHF -						
DATE WELL TURNED INTO TANKS -	SINGLE, DUAL OR TRIPLE COMPLETION -	NOTE: IF THIS IS A MULTIPLE COMPLETION, FURNISH A SEPARATE REPORT FOR EACH COMPLETION						
WAS WELL DIRECTIONALLY DRILLED? No	WAS DIRECTIONAL SURVEY MADE? No	WERE 3 COPIES FILED WITH THE DEPARTMENT OF CONSERVATION? No	DATE FILED N/A					
TYPE OF ELECTRICAL OR OTHER LOGS RUN (CIRCLE LOGS FILED WITH DEPT. OF CONSERVATION) Schlumberger I.E.S.		DATE FILED February 18, 1963						
CASING, LINER AND TUBING RECORD								
CASING SIZE	HOLE SIZE	CASING WEIGHT	DEPTH SET	SACKS CEMENT	TEST PRESSURE	HRS. UNDER PRESSURE	DATE TESTED	NAME OF TEST WITNESS - STATE IF DEPT. AGENT OR OFFSET OPR.
14" Driven			125					
9-5/8"	12 1/2"	32.30	2624	500	2000	1/2	1/10/63	
TUBING SIZE: None		DEPTH OF TUBING:		DEPTH OF PACKER (S):				
INITIAL COMPLETION OR RE-COMPLETION DATA								
INITIAL PRODUCTION None		GAS VOLUME BOPD		CHOKE SIZE MCF/DAY		WELL STATUS		
TUBING PRESSURE psi	CASING PRESSURE psi	GOR		BS & W		BHP - (SHUT-IN) psi		
GRAVITY *API 60°F		CONSERVATION AGENT MAKING GAUGE		COMPANY REPRESENTATIVE		DATE GAUGED		
PLUG AND ABANDON (P&A) DATA								
CASING SIZE	AMOUNT PULLED	CEMENT PLUGS				DATE WORK PERFORMED	NAME OF TEST WITNESS - STATE IF DEPT. AGENT OR OFFSET OPR.	
		FROM	TO	SACKS	HOW PLACED			
9-5/8"	None	2516	2716	84	Western Co.	1/30/63		
		Surface		25	Poured	1/31/63		
CERTIFICATE: I, the undersigned, state: That I am employed by <u>An-Son Corp.</u> and that I am authorized to make this report, and that this report was prepared under my supervision and direction and that all facts stated herein are true, correct and complete to the best of my knowledge.								
Signature: <u>G.C. Durant</u>				Title: _____				

RECEIVED
FEB 19 1963
LEASE C...

G.C. Durant

P & A
LC #37

1/31/63

The Western Co.

Plug and Abandon according to rules and regulations
set forth by Department of Conservation. Set 200'
plug 2516-2716' and set 15 sack surface plug.

Weller

DEPARTMENT OF CONSERVATION
STATE OF LOUISIANA

AFFIDAVIT OF TEST OF CASING IN WELL

DATE WORK DONE 1/11/62

WELL SERIAL NO. 93672

WORK PERMIT NO. _____

_____ DISTRICT

(One copy to be filed with the District Office)

NOTE: This Report Will Be Returned If Not Properly Completed And Signed.

Field Little Chenier Parish Cameron Sec. 14 Twp. 14 Rge. 4

Company Am-Son Corp Lease Mermentau M & L Well No. 1

Size of casing 9 5/8 Weight 32.30 Make Republic

No. of threads per in. 8 Grade H-40 Seamless New 2nd

If second hand, was pipe tested _____ Describe _____

Depth casing shoe landed below derrick floor _____ Ft. Sacks of cement 500 Corn
300 102
150 Corn

Size of hole 12 1/2 Ins. Amount of cement left in pipe 33'

Method of cementing Western Cement set in 5 hrs., under 500 psig.

Total depth 2700' Total time set 26 hrs.

DETAIL OF PRESSURE TEST BEFORE DRILLING PLUG

Date of test 1/10/62 Gauge pressure of casing 2000 psig.

Pressure at end of 30 minutes 0 Pressure drop 2000 psig.

Test fluid: Water Mud Weight _____ Viscosity _____

Remarks: Spudded 1/7/62 cc tools

This work was done according to the Rules and Regulations of the Department of Conservation.

H. E. Walker
WITNESS

Am-Son Corp
COMPANY

(Signed) W. A. ...
REPRESENTATIVE

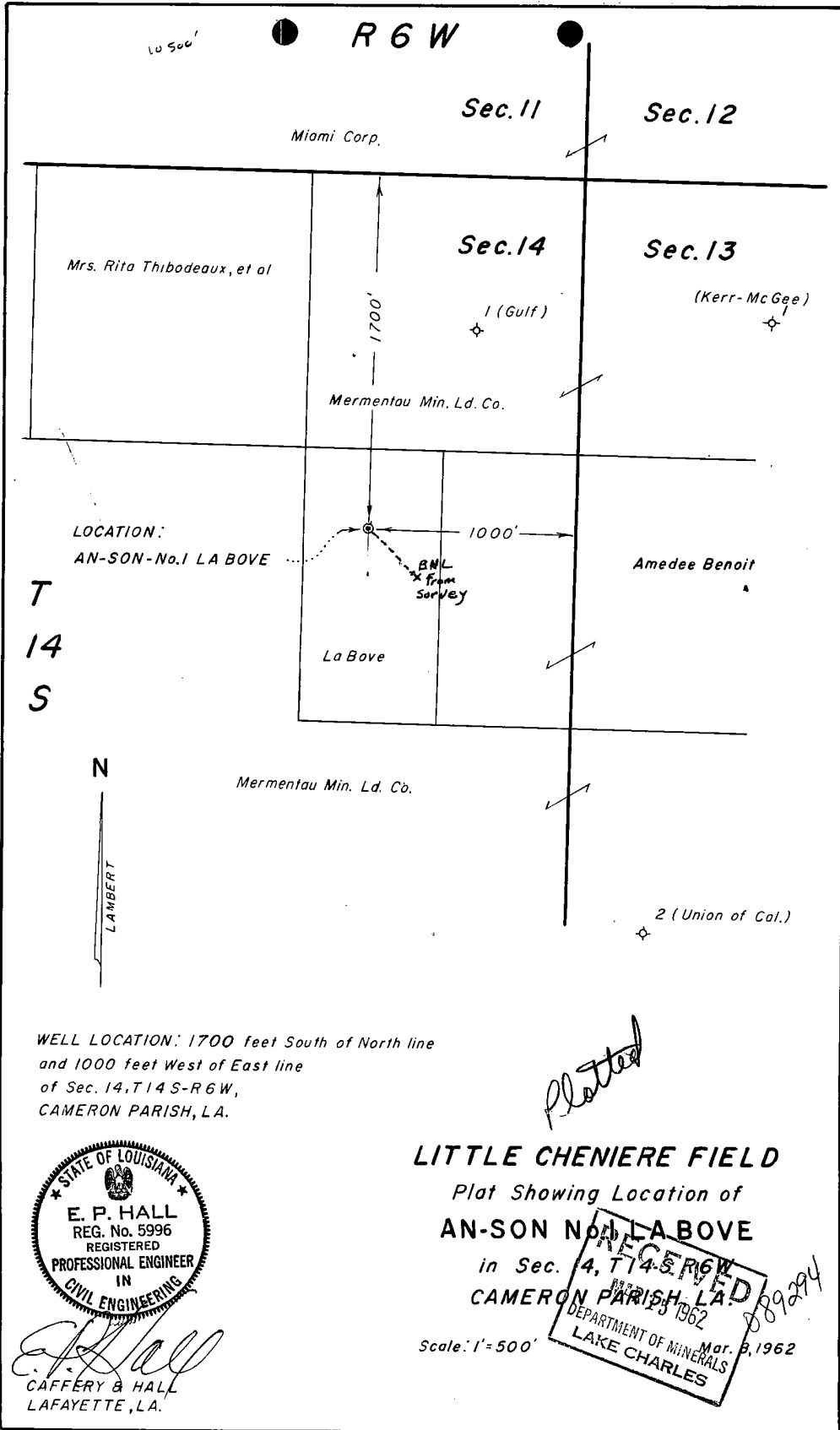

WELL LOCATION: 1700 feet South of North line
 and 1000 feet West of East line
 of Sec. 14, T14S-R6W,
 CAMERON PARISH, LA.

Plotted

LITTLE CHENIERE FIELD

Plat Showing Location of
AN-SON No. 1 LA BOVE
 in Sec. 14, T14S, R6W,
 CAMERON PARISH, LA.

RECEIVED
 MAR 15 1962
 DEPARTMENT OF MINERALS
 LAKE CHARLES
 Mar. 8, 1962
 889274

Scale: 1" = 500'



E. P. Hall
 CAFFERY & HALL
 LAFAYETTE, LA.



AN-SON PETROLEUM CORPORATION

3814 N. SANTA FE OKLAHOMA CITY 18, OKLAHOMA TELEPHONE JACKSON 5-1525

Reply to: 810 Saratoga Building
New Orleans 12, Louisiana

March 14, 1962

Louisiana Department of Conservation
P. O. Drawer 1767
Lake Charles, Louisiana

Gentlemen:

Enclosed herewith in duplicate is Form MD-10-R "Application for Permit to Drill" and three copies of the location plat for our proposed La Bove Well #1, Section 14-T14S-R6W, Cameron Parish, Louisiana. Also enclosed is our Check #6064 in the amount of \$100.00 to cover the permit fee.

Your approval of the application, as submitted, will be appreciated.

Very truly yours,

An-Son Petroleum Corporation

G. C. Durant
G. C. Durant

GCD:rsm
Encls



State of Louisiana
DEPARTMENT OF CONSERVATION
Inter Office

Date: March 15, 1962

To: Baton Rouge Office
From: Lake Charles District
Att'n: Fritz Spencer

Enclosed herewith please find application from An-Son Petr. Corp.
for permit to drill their
LaBoye No. 1 well Zone: Miocene
Wildcat Field, Cameron Parish.

Also enclosed please find:

Check No. 6064 in the amount of \$ 100.00

Well Location Plat X

Well Location Certification X

Form A. D. C. _____

Electric Log _____

Schematic Diagram _____

Applicable Department of Conservation Order No. 29-B & 29-E Pending Hearing
Docket No. _____

Remarks & Recommendations:

**Recommend approval. Location conforms with provisions of statewide orders.
No special orders for this area have been promulgated.**

Yours very truly,

By: Acting District Manager
FREDDIE J. BOUDREUX

cc: Geological Survey
WCW:jt
LT-1

W. W. W.

DEPARTMENT OF CONSERVATION
STATE OF LOUISIANA

AFFIDAVIT OF TEST OF CASING IN WELL

DATE WORK DONE April 21, 1962

WELL SERIAL NO. 89294

WORK PERMIT NO. 73882

Lake Charles, Louisiana DISTRICT
(One copy to be filed with the District Office)

NOTE: This Report Will Be Returned If Not Properly Completed And Signed.

Field Wildcat Parish Cameron Sec. 14 Twp. 14S Rge. 6W

Company An-Son Petroleum Corporation Lease LaBove Well No. 1

Size of casing 9-5/8" Weight 32.30# and 36# Make Republic

No. of threads per in. 8 rd Grade H-40 Seamless New 2nd

If second hand, was pipe tested _____ Describe _____

Depth landed below derrick floor 2637 Ft. Sacks of cement 500

Size of hole 12-1/4 Ins. Amount of cement left in pipe 32'

Method of cementing Displacement By The Western Company Cement set in 4 hrs., under 500 psig.

Total depth 2700 Total time set 25 hrs.

DETAIL OF PRESSURE TEST BEFORE DRILLING PLUG

Date of test April 22, 1962 Gauge pressure of casing 1500 psig.

Pressure at end of 30 minutes 1500 Pressure drop NONE psig.

Test fluid: Water Mud Weight 9.8 Viscosity 40

Remarks: Test OK

This work was done according to the Rules and Regulations of the Department of Conservation.

RECEIVED
APR 24 1962
DEPARTMENT OF MINERALS
COMPANY LAKE CHARLES

WITNESS

An-Son Petroleum Corporation
COMPANY LAKE CHARLES

(Signed) G. C. Durant
REPRESENTATIVE

G. C. Durant

MINERALS DIVISION
DEPARTMENT OF CONSERVATION
STATE OF LOUISIANA

Plug & St.
L. C. # 12

WORK PERMIT

PERMIT TO Plugback & Sidetrack DATE May 9, 1962
PARISH Cameron FIELD Hildcat
COMPANY Ameson Petr. Corp.
ADDRESS 810 Saratoga Bldg., New Orleans, La.
WELL NAME LaBove #1 No. 1 SEC 14 T 14S R 6W
WELL PERMIT SERIAL No. 89294 WORK PERMIT No. _____
LOCATION _____

YOU ARE HEREBY AUTHORIZED TO Plug back to 8,000' and direction-
ally drill hole to 300' N 45° W of present location at
10,350' (true vertical depth) Subject to compliance with State-
wide Order No. 29-E.

PERMIT REQUESTED BY MORTIMER SQUIRES TD 10,600' (TV
(TVB)
Company Representative

AUTHORIZED BY _____
FREDDIE J. BOUDREAU-Acting Distr. Mgr.
District Office



AN-SON PETROLEUM CORPORATION

3814 N. SANTA FE OKLAHOMA CITY 18, OKLAHOMA TELEPHONE JACKSON 5-1525

Reply to: 810 Saratoga Building
New Orleans 12, Louisiana

May 9, 1962

Louisiana Department of Conservation
P.O. Box 1767
Lake Charles, Louisiana

Att'n: Mr. Walker

RE: An-Son Petroleum Corporation
#1 LaBove - W $\frac{1}{2}$ SE $\frac{1}{4}$ NE $\frac{1}{4}$
Section 14, T-14-S, R-6-W
Cameron Parish, Louisiana
Permit Serial No. 89294

Gentlemen:

We have drilled our LaBove #1 well at a location 1,700 feet South of the North line and 1,000 feet West of the East line of Section 14, T-14-S, R-6-W, to a depth of 10,510 feet. We now propose to plug back to approximately 8,000 feet and directionally drill so as to place the hole 300 feet North 45° West of the present location at 10,350 feet (true vertical depth).

An-Son holds leases on all of the NE $\frac{1}{4}$ of Section 14, and each of our leases gives us the right to form a 40-acre unit for oil in the absence of Department of Conservation field rules. Such a unit would have the effect of complying with Louisiana Department of Conservation Order No. 29-E.

Enclosed is Department of Conservation Form MD-11R "Application for Work Permit" to cover the plugging back and sidetracking of the hole.

Very truly yours,

AN-SON PETROLEUM CORPORATION

Mortimer Squires
Mortimer Squires
Operations Manager

MS/GDT/bb

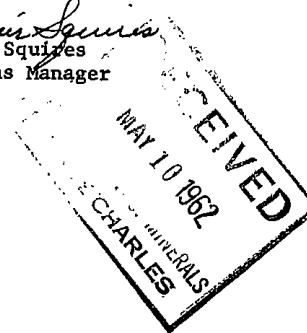

MINERALS DIVISION
DEPARTMENT OF CONSERVATION
STATE OF LOUISIANA

Plug & ST
L. C. #14

WORK PERMIT

PERMIT TYPE (8) Plugback & Sidetrack DATE May 23, 1962
PARISH Cameron FIELD Wildcat
COMPANY An-Son Petr. Corp.
ADDRESS 810 Saratoga Bldg., New Orleans 12, La.
WELL NAME LaBove No. 1 SEC. 14 T. 14S R. 6W
WELL PERMIT SERIAL No. 89294 WORK PERMIT No. _____
LOCATION _____

YOU ARE HEREBY AUTHORIZED TO Plug back to approximately 7000'
and directionally drill hole to 225' South 50° East
of present location at 8875' T. V. D.

PERMIT REQUESTED BY MARTIMER SOUTRES TD. 9500' T.V.D.
Company Representative

AUTHORIZED BY *Freddie J. Boudreaux*
for FREDDIE J. BOUDREAU-Acting Distr. Mgr.
District Office



AN-SON PETROLEUM CORPORATION

3814 N. SANTA FE OKLAHOMA CITY 18, OKLAHOMA TELEPHONE JACKSON 5-1525

Reply to: 810 Saratoga Building
New Orleans 12, Louisiana

May 23, 1962

Walker

Louisiana Department of Conservation
P. O. Box 1767
Lake Charles, Louisiana

RE: An-Son #1 LaBove
W/2 SE/4 NE/4
Section 14-T14S-R6W
Cameron Parish, Louisiana
Permit Serial No. 89294

Attention: Mr. Walker

Gentlemen:

The An-Son Petroleum Corporation #1 LaBove well, at a surface location 1700 feet South of the North Line and 1000 feet West of the East Line of Section 14 Township 14 South, Range 6 West, has been plugged back and sidetracked to the northwest to a measured depth of 10,662 feet. This work was performed under "Plug and St. L. C. #12". We now propose to plug back to approximately 7000 feet and directionally drill so as to place the hole 225 feet South 50° East of the present location at 8875 feet TVD and drill to 9500 feet TVD.

An-Son holds leases on all of the SE/4 of NE/4 of Section 14 and each lease gives us the right to form a 40-acre unit for oil in the absence of Department of Conservation field rules; such a unit would have the effect of complying with Louisiana Department of Conservation Order No. 29-E.

Enclosed is Department of Conservation Form MD-11R "Application for Work Permit: to cover the plugging back and sidetracking of the hole.

Very truly yours,

An-Son Petroleum Corporation

Mortimer Squires
Mortimer Squires
Operations Manager



MS:GDT:rsm
Encls

DEPARTMENT OF CONSERVATION
STATE OF LOUISIANA

Willew

AFFIDAVIT OF TEST OF CASING IN WELL

DATE WORK DONE June 4, 1962

WELL SERIAL NO. 89294

WORK PERMIT NO. 73882

Lake Charles DISTRICT
(One copy to be filed with the District Office)

NOTE: This Report Will Be Returned If Not Properly Completed And Signed.

Field Wildcat Parish Cameron Sec. 14 Twp. 14S Rge. 6W

Company An-Son Petroleum Corporation Lease La Bove #1 Well No. 1

Size of casing 5-1/2" Weight 17# Make Republic

No. of threads per in. 8 Grade N-80, J-55 Seamless yes New 2nd

If second hand, was pipe tested _____ Describe _____

Depth landed below derrick floor 95 Ft. Sacks of cement 600 sack Pozmix

Size of hole 8-1/2 Ins. Amount of cement left in pipe 31'

Method of cementing Halliburton Cement set in 4 hrs., under 300 psig.

Total depth 9550 Total time set Not Drilled Out hrs.

DETAIL OF PRESSURE TEST BEFORE DRILLING PLUG

Date of test 6-17-62 Gauge pressure of casing 1500 psig.

Pressure at end of 30 minutes 1500 Pressure drop NONE psig.

Test fluid: Water Mud Weight 10.4 Viscosity 36

Remarks: Tested OK

This work was done according to the Rules and Regulations of the Department of Conservation.

WITNESS

Form - Csg. T

(Signed)

An-Son Petroleum Corporation
COMPANY
REPRESENTATIVE
G.C. Durant
RECEIVED
JUN 19 1962
DEPARTMENT OF CONSERVATION
LAKE CHARLES

VERTICAL PROJECTION
SCALE 1"=200'

AN-SON PETROLEUM CORPORATION
LABOVE NO. 1
LITTLE CHENIER FIELD
CAMERON PARISH, LOUISIANA #89294
(SIDE TRACK NO. 1)

N-45°12'21"-W

8000

8400

8800

9200

9600

10000

10400

10600

HORIZONTAL PROJECTION
SCALE 1"=20'

240

200

160

120

80

40

HOMCO

8-15-52

M.D. 0662'
T.V.D. 0632.90'

382.40' → 10662

400

240

200

160

120

80

40

Surface Location

029236
89294

VERTICAL PROJECTION
SCALE 1" = 200'

S-47° 2' -E

AN-SON PETROLEUM CORPORATION
LABOVE NO. 1
LITTLE CHIENIER FIELD
CAMERON PARISH, LOUISIANA #89294

SIDE TRACK NO. 2

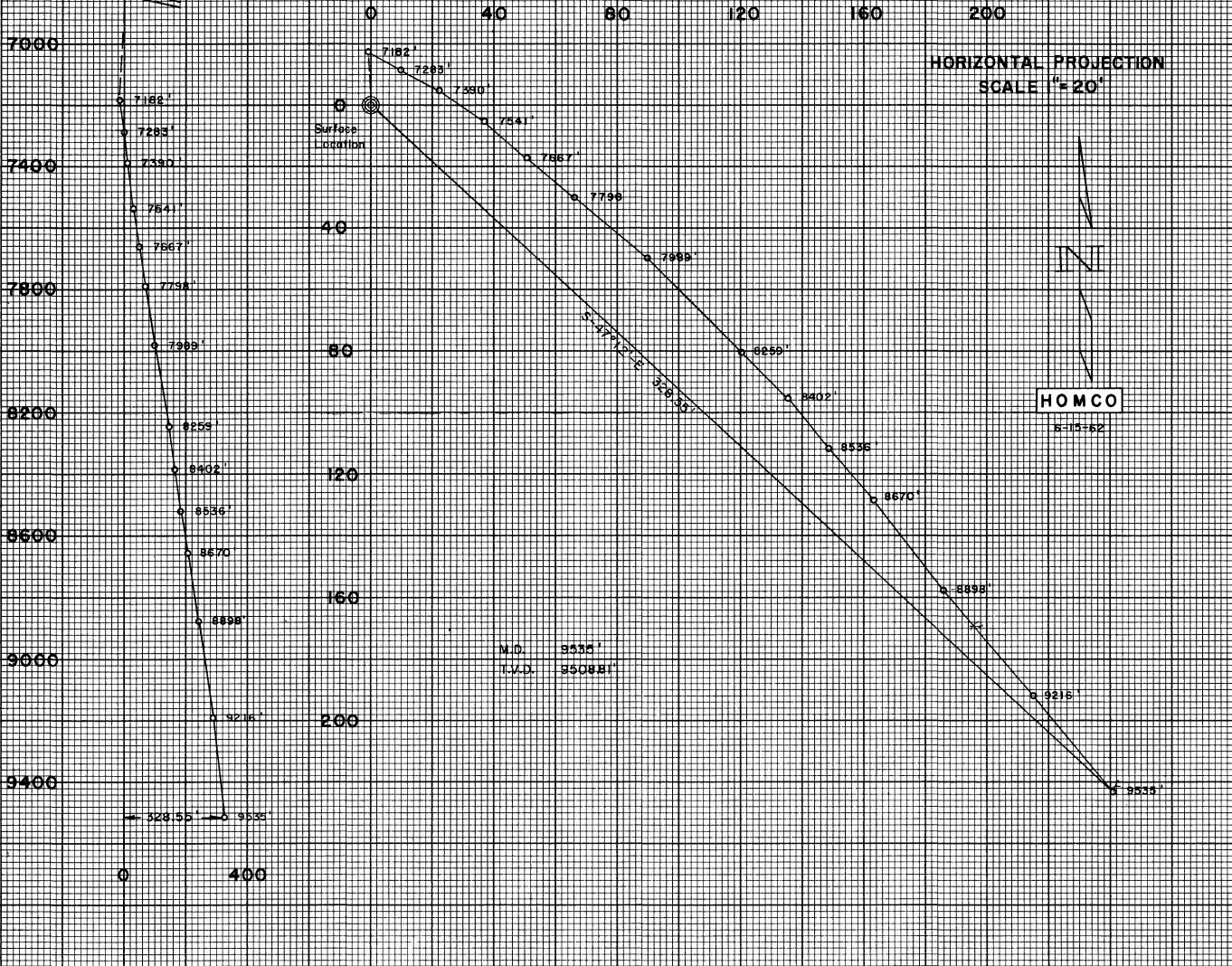

N.D. 9535'
T.V.D. 9508.81'

HOMCO
6-15-52

029237
89294

DIRECTIONAL DRILLING

DATE 6-15-62

COMPANY AN-SON PETROLEUM CORPORATION

WELL LABOVE #1 (Sidetrack #1 and #2)

FIELD ~~LITTLE-CHENIER~~ Wildcat

LOCATION CAMERON PARISH

Serial # 89294

COUNTY Terrebonne # 73882

STATE LOUISIANA

MAGNETIC DECLINATION _____

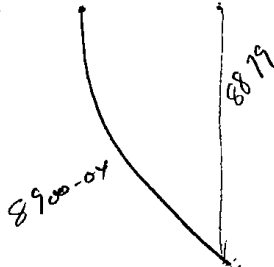

HOMCO

®

HOUSTON OIL FIELD MATERIAL COMPANY, INC.

DIRECTIONAL DRILLING

COMPANY: AN-SON PETROLEUM CORPORATION

DATE: 6-15-62

WELL NO.: ABOVE #1 (Sidetrack #1)

LOCATION LITTLE CHENIER, CAMERON, PARISH, LOUISIANA

PAGE: 1 OF 2

MEASURED DEPTH	COURSE LENGTH	DRIFT ANGLE	TRUE VERTICAL DEPTH	COURSE DEVIATION	DIRECTION OF DEVIATION	TOTAL COORDINATES			
						NORTH	SOUTH	EAST	WEST
8166'			8164.80'		From Previous Survey	45.32		3.72	
8184	18	3°30'	8182.77	1.10	N 40°W	46.17		3.02	
8217	33	3 45	8215.70	2.16	N 52 W	47.50		1.31	
8236	19	4 00	8234.65	1.33	N 63 W	48.10		.13	
8345	109	5 00	8343.24	9.50	N 73 W	50.88			8.96
8458	113	6 15	8455.57	12.31	N 69 W	55.29			20.45
8656	198	8 45	8651.27	30.12	N 65 W	68.02			47.75
8736	80	9 30	8730.17	13.20	N 62 W	74.21			59.41
8956	220	8 00	8948.04	30.62	N 59 W	89.98			85.66
9112	156	6 15	9103.12	16.99	N 55 W	99.73			99.58
9306	194	9 30	9294.46	32.01	N 50 W	120.31			124.10
9412	106	11 15	9398.42	20.68	N 50 W	133.61			139.94
9560	148	11 45	9543.31	30.13	N 48 W	153.77			162.33
9712	152	11 45	9692.12	30.95	N 49 W	174.07			185.69
9892	180	10 45	9868.97	33.57	N 43 W	198.62			208.59
10,083	191	8 30	10,057.87	28.23	N 50 W	216.77			230.22
10,373	290	7 45	10,345.23	39.12	N 38 W	247.59			254.30
10,662	289	5 30	10,632.90	27.69	N 38 W	269.41			271.34
CLOSURE:	Direction ---	N 45°	12' W	Distance ---	382.40'				
Cont. on Page 2									

HOUSTON OIL FIELD MATERIAL COMPANY, INC.

DIRECTIONAL DRILLING

COMPANY: AN-SON PETROLEUM CORPORATION

DATE: 6-15-62

WELL NO.: LABOVE #1 (Sidetrack #2)

LOCATION: LITTLE CHENIER FIELD, CAMERON PARISH, LA.

PAGE: 2 OF 2

MEASURED DEPTH	COURSE LENGTH	DRIFT ANGLE	TRUE VERTICAL DEPTH	COURSE DEVIATION	DIRECTION OF DEVIATION	TOTAL COORDINATES			
						NORTH	SOUTH	EAST	WEST
7182'			7181.36'	From Previous Survey		12.85			.88
7199	17'	5° 30'	7198.28	1.63	S 50° E	16.80		.37	
7283	84	7 15	7281.61	10.60	S 63 E	11.99		9.81	
7390	107	7 30	7387.69	13.96	S 63 E	5.65		22.25	
7541	151	7 00	7537.56	18.41	S 53 E		5.43	36.96	
7667	126	8 15	7662.26	18.08	S 50 E		17.05	50.81	
7798	131	8 45	7791.74	19.93	S 51 E		29.60	66.30	
7989	191	9 15	7980.26	30.70	S 50 E		49.33	89.82	
8259	270	9 15	8246.75	43.39	S 45 E		80.02	120.51	
8402	143	8 45	8388.09	21.75	S 45 E		95.40	135.89	
8536	134	9 00	8520.44	20.96	S 37 E		112.14	148.51	
86									
8670	134	9 30	8652.60	22.11	S 42 E		128.57	163.30	
8898	228	9 15	8877.64	36.64	S 38 E		157.44	185.85	
9216	318	8 15	9192.36	45.63	S 40 E		192.39	215.19	
9535	319	7 15	9508.81	40.26	S 40 E		223.23	241.07	
<p>CLOSURE: Direction --- S 47° 12' E Distance --- 328.55'</p> <p>We certify that to the best of our knowledge and ability this is a true and correct report and that it affords a true and correct representation of the nature and conditions of the well at the time the survey was made.</p>						<p>HOMCO DIRECTIONAL DRILLING ENGINEER: R.F. Varley</p> <p>Subscribed and sworn to before me this 15 day of June A.D., 1962 at Houston, Harris County, Texas.</p>			
<p><i>M. C. Brown</i> Houston Oil Field Material Company, Inc. Directional Drilling Services</p>						<p><i>Louise Reynolds</i> LOUISE REYNOLDS Notary Public, In and for Harris County, Texas My Commission Expires June 1, 1963</p>			

MINERALS DIVISION
DEPARTMENT OF CONSERVATION
STATE OF LOUISIANA

Perf.
L.C.#269

WORK PERMIT

PERMIT TO Perforate DATE June 18, 1962
PARISH Cameron FIELD Wildcat
COMPANY AN-SON PETROLEUM CORPORATION
ADDRESS 810 Saratoga Bldg., New Orleans, La.
WELL NAME LaBove No 1 SEC 14 T 14 S R 6W
WELL PERMIT SERIAL No. 89294 WORK PERMIT No. 73882
LOCATION _____

YOU ARE HEREBY AUTHORIZED TO Perf. 9393-9398' (elm) w/4
Jet Shots per foot and test for production.

PERMIT REQUESTED BY G.C. DURANT TD 9550

for FREDDIE J. BOUDREAU, Act. Dist. Mgr.
AUTHORIZED BY _____
Company Representative



AN-SON PETROLEUM CORPORATION

3814 N. SANTA FE OKLAHOMA CITY 18, OKLAHOMA TELEPHONE JACKSON 5-1525

Reply To: Suite 810 Saratoga Building
New Orleans 12, Louisiana

June 18, 1962

Louisiana Department of Conservation
Post Office Drawer 1767
Lake Charles, Louisiana

Attention: Mr. F.J. Boudreaux

Gentlemen:

Enclosed herewith in duplicate is Form No. MD-11R "Application for Work Permit" for our La Bove #1, Section 14, T14S, R6W, Cameron Parish, Louisiana.

Under this application, we propose to perforate 9393'- 9398' (ELM) with 4 jet shots and to test for production. If test is satisfactory, a Baker Model D Wire Line Production Packer with DR blanking plug will be set at approximately 9360'.

Under separate application we propose to perforate 8900'-8904' w/4 jet shots and to test for production. If test is satisfactory, to complete well as a single zone producer from 9393' - 9398' with perforations at 8900' - 8904' as alternate producing zone. In this regard, we will file an application for dual completion; indicating therein that alternate, rather than dual production is intended.

Your approval of this work as set forth will be appreciated.

Yours very truly,

An-Son Petroleum Corporation

G.C. Durant

GCD/raj
Encl.

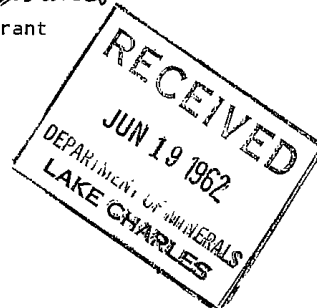

MINERALS DIVISION
DEPARTMENT OF CONSERVATION
STATE OF LOUISIANA

Plug & Perf.
L.C.# 75

WORK PERMIT

PERMIT TO Plug & Perf. DATE June 21, 1962
PARISH Cameron FIELD Wildcat
COMPANY An-Son Petr. Corp.
ADDRESS 810 Saratoga Bldg., New Orleans, La.
WELL NAME La Bove No. 1 SEC 14 T 14S R 6W
WELL PERMIT SERIAL No. 89284 WORK PERMIT No. 73882
LOCATION _____

YOU ARE HEREBY AUTHORIZED TO Set Baker Model D Production
Packer with DR Blanking Plug at approx. 9360 to Blank Off
Perforations 9393-9398'. Perf. 8900-9004' (ELM) w/4 jet
shots and test for production TD 9550'
PERMIT REQUESTED BY E G.C. DURANT
Company Representative

AUTHORIZED BY *Wlee*
for FREDDIE J. BOUDREAU, Act. Dist. Mgr.
District Office

WELL COMPLETION OR RECOMPLETION REPORT

On Scout

Re: Well Serial No. 89294

DEPARTMENT OF CONSERVATION
STATE OF LOUISIANA
LAKE CHARLES DISTRICT

Gentlemen:

This is to advise that the following described well has been (COMPLETED) (~~RECOMPLETED~~) as an (~~Oil~~) (GAS) well and its status is as follows:

Producing Flowing Gas-lifting Pumping Shut-in
Field Little Chemere Parish Cameron Sec. 14 Twp. 14S Rge. 6W
~~Wildcat~~
Company An-Son Petroleum Corporation Base LaBove Well No. 1
Date completed or recompleted June 24 at 8:00 (~~XXX~~) (P. M.)

COMPLETION DATA

Initial production 240 BOPD Gas volume 3714 MCF/Day
Tubing pressure 2800 psig Casing pressure 0 psig
Choke size 16 /64 Positive Adjustable B.S. & W. 0 %
Gas/Oil ratio 15,471:1 CF/Bbl. Gravity 59.8 at 60° A. P. I.
Producing depth: From 8900 Ft. to 8904 Ft. Sidetrack #2 T. D. 9550 Ft.

(Additional clearance is requested for 0 barrels of oil produced on drill-stem or other production tests. (See Section X, Paragraph B, or Order No. 29-B on reverse side.)

(Three (3) copies to be filed with the District Office within three (3) days of date of completion or recompletion (as per Order 29-B, Section X, Paragraph A, Article 1).)

AN-SON PETROLEUM CORPORATION
COMPANY

(Signed)

Maurice Hinds
COMPANY REPRESENTATIVE
Maurice Hinds

RECEIVED
JUN 27 1962
DEPARTMENT OF CONSERVATION
LAKE CHARLES DISTRICT

Form - Comp.

STG-W

DEPARTMENT OF CONSERVATION
STATE OF LOUISIANA

This side is to be used when requesting clearance for oil produced on Drill Stem Test or other Production Tests, made previous to official completion or recompletion.

SECTION X, PARAGRAPH B OF ORDER NO. 29-B

Allowables given to wells for oil produced on drill stem tests, production test and miscellaneous production of oil shall be in accordance with the following rule:

All operators are required, within five days, to file three signed copies of the record of the daily production from the well, showing the number of hours the well produced and the interval of production --- as "from 8:00 A. M., August 5 to 3:00 P. M., August 8, 1952."

T E S T D A T A

<u>Date of Test</u>	<u>Time of Test</u>	<u>Amount of Oil Produced</u>
_____	_____ M. to _____ M.	_____ Barrels
_____	_____ M. to _____ M.	_____ Barrels
_____	_____ M. to _____ M.	_____ Barrels
_____	_____ M. to _____ M.	_____ Barrels
_____	_____ M. to _____ M.	_____ Barrels
_____	_____ M. to _____ M.	_____ Barrels
_____	_____ M. to _____ M.	_____ Barrels
_____	_____ M. to _____ M.	_____ Barrels
_____	_____ M. to _____ M.	_____ Barrels
_____	_____ M. to _____ M.	_____ Barrels

TOTAL _____ BARRELS

The above total barrels of oil were produced from _____ Ft. to _____ Ft.

Remarks: _____

COMPANY

(Signed) _____

COMPANY REPRESENTATIVE

8
June 29, 1962

Mr. Leo Hough, State Geologist
Geological Survey
Box 8847 - University Station
Baton Rouge, Louisiana

Dear Sir:

Find enclosed copy of Electrical Log on each of the following wells:

Am-Son Petr. Corp.
LaBoys No. 1
Cameron Parish, La.

Serial No: 89294
Field: Wildcat
(Sidetr. 1 & 2 included)

The California Co.
C. O. Noble 3 No. 5
Calcasieu Parish, La.

Serial No: 90217
Field: Choupique
(Composite-2" & 5")

Continental Oil Co.
OO#-0768 No. E-3
Cameron, La.

Serial No: 90191
Field: E. Cam. Blk. 64

Fan American Petr. Corp.
Lutcher-Moore No. 1
Vernon, La.

Serial No: 86035
Field: Wildcat

Also find enclosed on the above subject well: Tracer Log, Temperature Log of runs 1-4, a Sonic Log, MicroLogging, and a Gauge Log.

Your very truly,

FREDDIE J. BOUDREAU
Acting District Manager
Lake Charles, Louisiana

EJE/rr

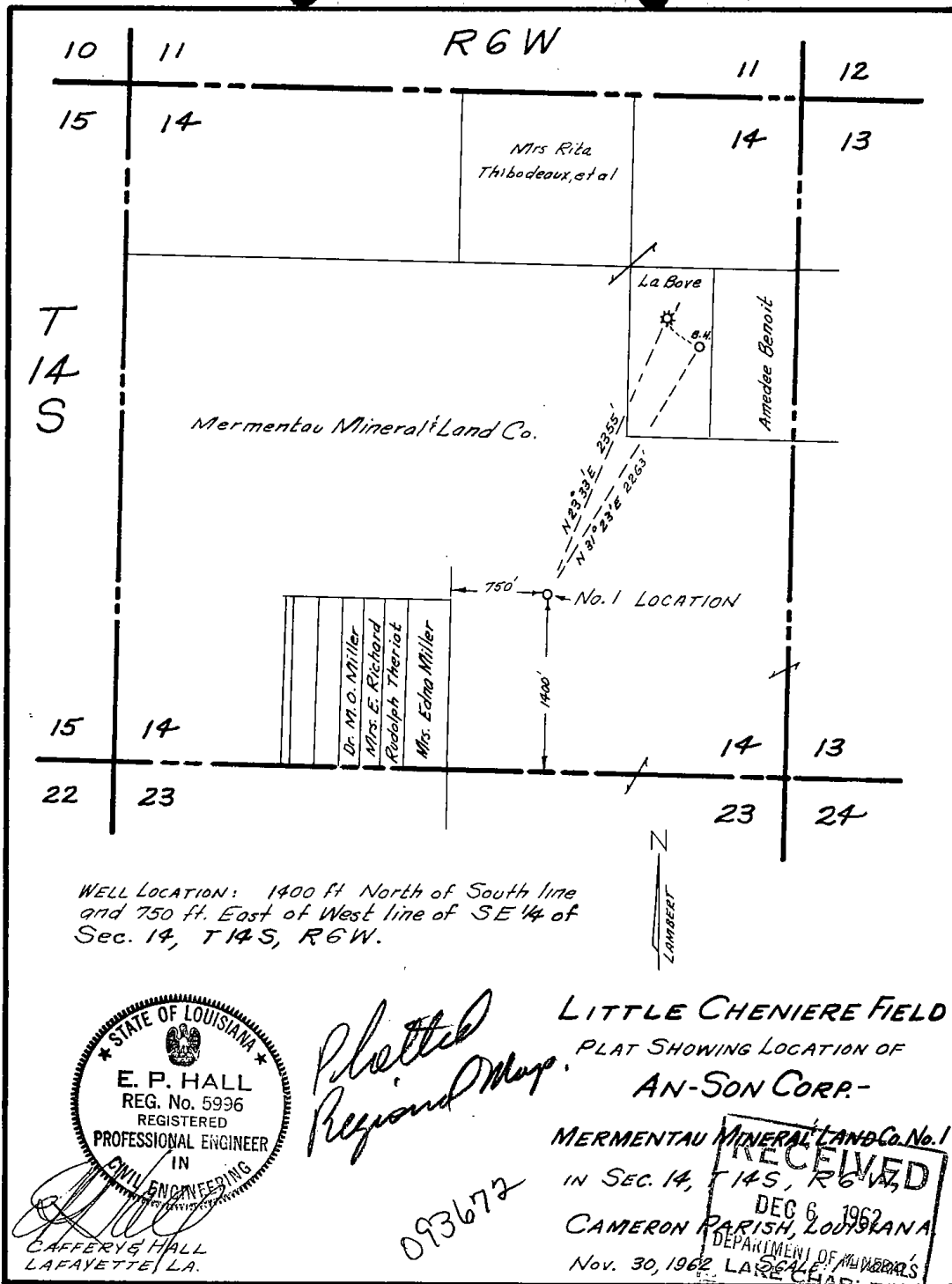

STATE OF LOUISIANA
 E. P. HALL
 REG. No. 5996
 REGISTERED
 PROFESSIONAL ENGINEER
 IN
 CIVIL ENGINEERING

CAFFERY & HALL
 LAFAYETTE, LA.

Plotted Regional Map

093672

LITTLE CHENIERE FIELD
 PLAT SHOWING LOCATION OF
 AN-SON CORP.-

MERMENTAU MINERAL LAND Co. No. 1
 IN SEC. 14, T14S, R6W,
 CAMERON PARISH, LOUISIANA
 Nov. 30, 1962

RECEIVED
 DEC 6 1962
 DEPARTMENT OF REVENUE
 LAKE CHARLES

AN-SON CORPORATION

3814 N. SANTA FE

OKLAHOMA CITY 18, OKLAHOMA

TELEPHONE JACKSON 5-1525

EXPLORATION DIVISION

December 3, 1962

Reply To: 810 Saratoga Bldg.
New Orleans, La.
Telephone JA 2-0361

Louisiana Department of Conservation
P. O. Drawer 1767
Lake Charles, Louisiana

Attention: Mr. F. J. Boudreaux

Gentlemen:

Enclosed herewith in duplicate is Form MD-10-R, "Application for Permit to Drill", and three copies of the location plat for our proposed Mermentau Mineral & Land Co., Well #1, in Section 14-T14S-R6W, Cameron Parish, Louisiana. Also enclosed is our Check #3159 in the amount of \$100.00 to cover the permit fee.

Your approval of this application as submitted will be appreciated.

Yours very truly,

AN-SON CORPORATION



George C. Durant
Office Manager

GCD:rsm
Encls

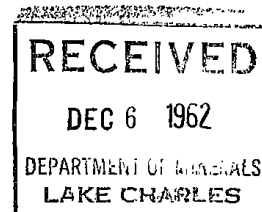

State of Louisiana
DEPARTMENT OF CONSERVATION
Inter Office

Date: 12/7/62

To: Baton Rouge Office
From: Lake Charles District
Att'n: Fritz Spencer

Enclosed herewith please find application from An-Son Corporation
for permit to drill their
Mermentau Mineral & Land Co., Inc. No. 1 Zone: Multiple Miocene
Little Cheniere Field, Cameron Parish.

Also enclosed please find:

Check No. 2649 in the amount of \$ 100.00

Well Location Plat xxx

Well Location Certification xxx

Form A. D. C. _____

Electric Log _____

Schematic Diagram _____

Applicable Department of Conservation Order No. 29-B & E Pending Hearing
Docket No. _____

Remarks & Recommendations:

Recommend approval. Location is 2263' from Bottom Hole Location of An-Son Petr. Corp., LaBove No. 1, shut-in gas well, permitted as Cameron Parish Wildcat. (LaBove No. 1 is located approximately 4850' from Phillips Petr. Co., Miami Corp. No. 2 well, Little Cheniere Field, now P&A.

Yours very truly,

By: Acting District Manager
FREDDIE J. BOUDREAUX

cc: Geological Survey
HEW:jt

LT-1

State of Louisiana

DEPARTMENT OF CONSERVATION

Inter Office

Date: 12/14/62

To: Baton Rouge Office

From: Lake Charles District

Att'n: Fritz Spencer

Enclosed herewith please find application from An-Son Corporation

for permit to and. opr. on their

LaBove No. 1 well Zone: _____

Little Cheniere Field, Cameron Parish .

Also enclosed please find:

Check No. 3395 in the amount of \$ 25.00

Well Location Plat _____

Well Location Certification _____

Form A. D. C. _____

Electric Log _____

Schematic Diagram _____

Applicable Department of Conservation Order No. _____ Pending Hearing
Docket No. _____

Remarks & Recommendations:

Recommend approval. Routine operator change request.

Yours very truly,

By: _____
Acting District Manager
FREDDIE J. BOUDREAU

cc: Geological Survey

WCW:jt

LT-1

MINERALS DIVISION
DEPARTMENT OF CONSERVATION
STATE OF LOUISIANA

P & A
L. C. #37

WORK PERMIT

PERMIT TO Plug & Abandon DATE 1/31/63
PARISH Cameron FIELD _____
COMPANY An-Son Corp.
ADDRESS 810 Saratoga Bldg., New Orleans, 12, La.
WELL NAME Mermontau Mineral & Id. Co. 1 SEC 14 T 14S R 6W
WELL PERMIT SERIAL No. 93672 WORK PERMIT No. _____
LOCATION _____

YOU ARE HEREBY AUTHORIZED TO Plug & Abandon according to rules
and regulations set forth by Dept. of Conservation
Set 200' cement plug (8 1/2" sx. w/2 1/2" CaCl) 2516-2716
(9-5/8" csg. @2624) and set 15 sx cmt. TD 10,577-
plug @surface G. C. DURANT

PERMIT REQUESTED BY _____ Company Representative

AUTHORIZED BY William C. Wilhite
WILLIAM C. WILHITE District Manager
District Office

Willis

DEPARTMENT OF CONSERVATION
STATE OF LOUISIANA

PLUG AND ABANDON REPORT

DATE WORK DONE January 31, 1963

WELL SERIAL NO. 93672
WORK PERMIT NO. 78262

Lake Charles DISTRICT
(Three Copies to be Filed with the District Office)

NOTE: This Report Will be Returned if Not Properly Completed And Signed.

Field Little Chenier Parish Caméron Sec. 14 Twp. 14S Rge. 6W
Company An-Son Corporation Lease Mermentau Mineral & Land Co., Inc. Well No. 1
Total Depth 10,577' Condition of Well Dry and Abandoned

- 1. Surface Casing Size 9-5/8" Depth 2624' Amount Pulled None
- 2. Protection Casing Size None Depth _____ Amount Pulled _____
- 3. Production Casing Size None Depth _____ Amount Pulled _____

CEMENT PLUGS

- 1. Depth 2516' To 2716' No. of Sacks 84 How Placed Western Company
- 2. Depth Surface To _____ No. of Sacks 25 How Placed Poured
- 3. Depth _____ To _____ No. of Sacks _____ How Placed _____

Mud Record: Weight 13.4 Viscosity 52

Remarks: _____

This work was done according to the Rules and Regulations of the Department of Conservation.

WITNESS

An-Son Corporation
COMPANY

G.C. Durant
(Signed) REPRESENTATIVE
G.C. Durant

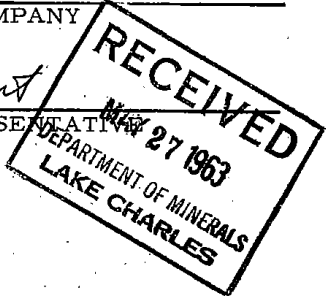

February 19, 1963

Mr. Leo Hough, State Geologist
Geological Survey
Box 8847 - University Station
Baton Rouge, Louisiana

Dear Sir:

Find enclosed copy of Electrical Log on each of the following wells:

✓ An-Son Corporation Serial No: 93672
Mermentau Min. Id. Co., Inc. #1 Field: Little Chenier
Cameron Parish, Louisiana

Gulf Oil Corporation Serial No: 92702
M. P. Erwin "A" #52 Field: East Hackberry
Cameron Parish, La. (SI included)

Shell Oil Company Serial No: 94287
OCS-G-0952 No. 1 Field: E. C. Blk. 189 W/C
Cameron Parish, La.

The operator of this well would appreciate it if this log were kept CONFIDENTIAL. Thank you.

Yours very truly,

WILLIAM C. WILHITE
District Manager
Lake Charles, La.

WCW:rr

State of Louisiana
DEPARTMENT OF CONSERVATION
Inter Office

Date: 12/5/63

To: **Baton Rouge Office**
From: **Lake Charles District**
Att'n: **Fritz Spencer**

Enclosed herewith please find application from An-Spn Corporation
for permit to and name their
8885' SUA; E. T. LaBove Well No. 1 Zone: _____
Little Cheniere Field, Cameron Parish.

Also enclosed please find:

Check No. _____ in the amount of \$ _____

Well Location Plat _____

Well Location Certification _____

Form A. D. C. _____

Electric Log _____

Schematic Diagram _____

Applicable Department of Conservation Order No. _____ Pending Hearing _____
Docket No. _____

Remarks & Recommendations:

Recommend approval. Name change requested to comply with provisions of Ord. 645 effective 12/1/63.

Yours very truly,

By: _____
District Manager
W. C. WILHITE

cc: Geological Survey

WCW:jt
LT-1

POTENTIAL REPORT

Type Well: Oil _____ Gas X Distillate _____

Type Test: Comp. X Recomp. _____ Retest. _____ Regauge _____

Parish CAMERON Field LITTLE CHENIER

Company ANLSON CORP. Serial No. 89294

Well Name & No. 8885'-S.U.A. B.T. LaBOUE No. 1

Location: Sec. 14 Twp. 14S Rge. 6W Flowing X Pump _____

Prod. Horizon 8885' Sd. Perf. Int. 8900' to 8904'

Casing Setting: Size 5 1/2" @ 9550'

Tubing Setting: Size 2" @ 8824' T.D. 9550

Date Completed ONLINE 12-12-63 Date Gauged 12-16-63

Acidize with _____ gals. Elev. of Derr. Floor _____

TEST DATE

T. P. 3150 C. P. 0 Choke Size 12/64th

Closing TK Gge. 2 ft. 1 in. @ 3:30 PM Time

Opening TK Gge. 4 ft. 9 in. @ 11:30 AM Time

Diff. 0 ft. 4 in. 4 Hours (Time)

Tank No. 1 Tank Coef. 2.76

Bbls. per 4 Hrs. 11.04 Est. Bbls. per Day 66

Daily Gas Vol. 4300 M.C.F. G/O Ratio 19.696:1

B.S.&W. 0 % Corrected Gravity 58 Deg. A.P.I.

Witnessed [Signature] Title Agent

Gauged by Ben Holcomb Title agent
Department of Conservation

District Office Lake Charles

Remarks: 2" X 1" O.P. - St. 945# - Diff. 4 1/2"

Flg. Taps Std Chart - Data Colled

12-15-63

MINERALS DIVISION
DEPARTMENT OF CONSERVATION
STATE OF LOUISIANA

Workover
L. C. #34

WORK PERMIT

PERMIT TO Workover DATE 9/2/64
PARISH Cameron FIELD Little Chenier
COMPANY Am An-Son Corp.
ADDRESS 810 Saratoga Bldg., New Orleans, La.
WELL NAME LaBove No. 1 SEC 14 T. 14S R. 6W
WELL PERMIT SERIAL No. 89294 WORK PERMIT No. _____
LOCATION _____

YOU ARE HEREBY AUTHORIZED TO Sq. Perf. 8900-8904, w/Reperforate
8888-93

PERMIT REQUESTED BY MORTIMERSQUERES TD 9550
Company Representative

AUTHORIZED BY W. G. WILHITE
W. G. WILHITE-District Manager
District Office

Permit Verbal *W*

LANE-WELLS COMPANY
A Division of Dresser Industries
COMPLETION SERVICE DATA SHEET

DATE *9-13-64*

Customer *Ans - Sun P.O. Co.* Job Scheduled *8:00* AM
Well No. *Labore #1* Arrived Location *7:00* AM
Field *Little Chenier* On Job *7:00* AM
SO No. *108655* Off Job *9:00* AM
Hrs. Standby *0*

Customer Depth *8872*
Lane-Wells Depth *8890.5*
Zero Point *17' above B.M.F.*
Perm. Ref. Datum *Same*
Top of Cement *_____*

Services Performed on This Set Up: GP _____ K/S PFC _____ R/A _____ B/P _____ PKR _____ Other _____

Subsurface Tools Run *K.S. Gun* Series-Type *NW 8* Size *3 3/8* No. of Runs *1* Fluid *Mud*
Wt.-Vis. *10.2*
Level *fill*
Max. Temp. *_____*

Casing Size *5 1/2* From *2* To *2* Liner Size *2* From *2* To *2* Tubing Size *_____*

Plug-Pkr. Serial No. _____ Top ordered at _____ Top set at _____ Size _____ Kind _____ PO _____

Perforating Zones *20* Holes From *8889.5* To *8892.5* Setting Depths and/or
Perf. Zones Approved By *[Signature]* Title *Contractor*
L-W Crew *[Signature]*
Truck No. *P1631* Dist. *2471* Base *L.C.*

Run No.	Run No.	Run No.	Run No.	Run No.	Run No.
1					
2					
3					
4					
5					
6					
7					
8					
9					
10					
11					
12					
13					
14					
15					
16					
17					
18					
19					
20					
21					
22					
23					
24					
25					

RECEIVED
SEP 15 1964
DEPARTMENT OF MINERALS
LAKE CHARLES

RUNNING TIME		C.C. Depths LW Other					
1)	In From _____ to _____	A.M. P.M.	C.C. Depths This Run				
	Out From _____ to _____	A.M. P.M.					
	Fluid _____						
	In _____ Out _____						
	Holes _____ Total _____						
	Misses _____ Total _____		Closing of firing switch witnessed by _____				
2)	In From _____ to _____	A.M. P.M.	C.C. Depths This Run				
	Out From _____ to _____	A.M. P.M.					
	Fluid _____						
	In _____ Out _____						
	Holes _____ Total _____						
	Misses _____ Total _____		Closing of firing switch witnessed by _____				
3)	In From _____ to _____	A.M. P.M.	C.C. Depths This Run				
	Out From _____ to _____	A.M. P.M.					
	Fluid _____						
	In _____ Out _____						
	Holes _____ Total _____						
	Misses _____ Total _____		Closing of firing switch witnessed by _____				
4)	In From _____ to _____	A.M. P.M.	C.C. Depths This Run				
	Out From _____ to _____	A.M. P.M.					
	Fluid _____						
	In _____ Out _____						
	Holes _____ Total _____						
	Misses _____ Total _____		Closing of firing switch witnessed by _____				
5)	In From _____ to _____	A.M. P.M.	C.C. Depths This Run				
	Out From _____ to _____	A.M. P.M.					
	Fluid _____						
	In _____ Out _____						
	Holes _____ Total _____						
	Misses _____ Total _____		Closing of firing switch witnessed by _____				
6)	In From _____ to _____	A.M. P.M.	C.C. Depths This Run				
	Out From _____ to _____	A.M. P.M.					
	Fluid _____						
	In _____ Out _____						
	Holes _____ Total _____						
	Misses _____ Total _____		Closing of firing switch witnessed by _____				

Mileage From _____ to _____

Mileage From _____ to _____

POTENTIAL REPORT

Type Well: Oil _____ Gas X Distillate _____
Type Test: Comp. X Recomp. X Retest _____ Regauge _____

Parish Cameron Field Little China
Company Amco Corp Serial No. 73882
Well Name & No. La Bore #1
Location: Sec. 14 Twp. 14 Rgd. 6 Flowing X Pump _____
Prod. Horizon _____ Perf. Int. 8885 to 8893
Casing Setting: Size 5 1/2 @ 9550
Tubing Setting: Size 2 @ 8824 T.D. 9550
Date Completed 9/15/64 Date Gauged 9/25/64
Acidize with _____ gals. Elev. of Derr. Floor _____

TEST DATE _____

T. P. 2750 C. P. 0 Choke Size 8 /64th
Closing TK Gge. 3 ft. 1 in. @ 9 Time
Opening TK Gge. 2 ft. 1 1/4 in. @ 7 Time
Diff. 0 ft. 13 1/4 in. 2 Hours (Time)
Tank No. 28687 Tank Coef. 2.76
Bbls. per 2 Hrs. 4.85 Est. Bbls. per Day 58.08
Daily Gas Vol. 600.5 M.C.F. G/O Ratio 39700
B.S.&W. PL % Corrected Gravity 58.9 Deg. A.P.I.

Witnessed Ray Conner Title Owner
Gauged by Richard J. Romero Title Inspector
Department of Conservation
District Office Lake Charles
Remarks 900# 38" 3/4 - 3"

DEPARTMENT OF CONSERVATION
STATE OF LOUISIANA

*N. D.
G. C. L...*

WELL COMPLETION OR RECOMPLETION REPORT

LAKE CHARLES DISTRICT Re: Well Serial No.: 73882

Completed Flowing Operator: An-Son Corporation
 Recompleted Gas-Lifting Well Name: 8885 Ft. SUA; B. T. LaBove #1
 Oil Pumping Well No.: 1, Sec. 14, Twp. 14S, Rge. 6W
 Gas Shut-In Field: Little Chenier
 Parish: Cameron Parish, Louisiana

Date Completed or Recompleted September 15, 1964 at 12:30 ~~(XXXX)~~ (p.m.)

COMPLETION DATA

Initial Production 26 BOPD Gas Volume 1030 MCF/Day
 Tubing Pressure 3100 psig Casing Pressure 0 psig
 Choke Size 8/64 Positive Adjustable B.S.&W. 0 %
 Gas/Oil Ratio 39700 CF/Bbl. Gravity 58.9 at 60° A. P. I.
 Producing Depth: From 8888 Ft. to 8893 Ft. T. D. 9950 Ft.
 Name of Producing Sand: 8885 Ft. Sand

*New Pool *Old Pool List Reason(s) for Pool Classification _____

*As Defined in Statewide Order No. 29-H.

Additional clearance is requested for _____ barrels of oil produced on drill stem or other production tests (See Section X, Paragraph B of Order No. 29-B on reverse side).

Three (3) copies to be filed with the District Office within three (3) days of date of completion or recompletion (as per Order 29-B, Section X, Paragraph A, Article 1).

I hereby certify that the above information is true and correct to the best of my knowledge.

DISTRICT MANAGER ONLY

29-E Compliance - Yes No
 29-E Unit Attached - Yes No

DATE: _____

AN-SON CORPORATION
COMPANY

Mortimer Squires
COMPANY REPRESENTATIVE
Mortimer Squires

Operations Manager
TITLE

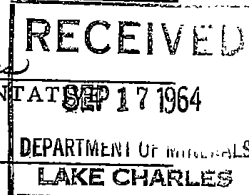

From - Comp.

DEPARTMENT OF CONSERVATION
STATE OF LOUISIANA

This side is to be used when requesting clearance for oil produced on Drill Stem Test or other Production Tests, made previous to official completion or recompletion.

SECTION X, PARAGRAPH B OF ORDER NO. 29-B

Allowables given to wells for oil produced on drill stem tests, production test and miscellaneous production of oil shall be in accordance with the following rule:

All operators are required, within five days, to file three signed copies of the record of the daily production from the well, showing the number of hours the well produced and the interval of production - - - as "from 8:00 A. M., August 5 to 3:00 P. M., August 8, 1952."

<u>Date of Test</u>	<u>T E S T D A T A</u>		<u>Amount of Oil Produced</u>
	<u>Time of Test</u>		
_____	_____ M.	_____ M.	_____ Barrels
_____	_____ M.	_____ M.	_____ Barrels
_____	_____ M.	_____ M.	_____ Barrels
_____	_____ M.	_____ M.	_____ Barrels
_____	_____ M.	_____ M.	_____ Barrels
_____	_____ M.	_____ M.	_____ Barrels
_____	_____ M.	_____ M.	_____ Barrels
_____	_____ M.	_____ M.	_____ Barrels
_____	_____ M.	_____ M.	_____ Barrels
_____	_____ M.	_____ M.	_____ Barrels
TOTAL			_____ BARRELS

The above total barrels of oil were produced from _____ Ft. to _____ Ft.

Remarks: _____

COMPANY (Signed) _____ COMPANY REPRESENTATIVE

W



DEPARTMENT OF CONSERVATION

WELL HISTORY AND WORK RESUME REPORT

FIELD
Little Chenier

SERIAL NO.
89294

PRODUCING INTERVAL
8888 - 8893

RESERVOIR (COMPANY SAND IDENTIFICATION)
8885' Sand

Three typewritten copies of this report must be filed with the District Office of the Department of Conservation in which the well is located within twenty (20) days of the date of completion or recompletion. NOTE: If not properly completed and signed this report will be returned.

LEASE AND WELL DATA

DESIGNATE TYPE OF COMPLETION: NEW WELL RECOMPLETION SAME RESERVOIR DIFFERENT RESERVOIR OIL GAS P&A

OPERATOR
An-Son Corporation

ADDRESS
810 Saratoga Building, New Orleans, Louisiana

LEASE NAME
8885' SUA; B. T. LaBove

WELL NO.
1

PARISH
Cameron

SEC. 14 TWP. 14S RGE. 6W

DATE PERMIT ISSUED
9-2-64

DATE SPUDDED
Workover

TOTAL DEPTH

PBTD

GROUND ELEVATION

CASING HEAD FLANGE ELEVATION

DISTANCE FROM RKB TO CHF

DATE WELL TURNED INTO TANKS

SINGLE, DUAL OR TRIPLE COMPLETION?
Single

NOTE: IF THIS IS A MULTIPLE COMPLETION, FURNISH A SEPARATE REPORT FOR EACH COMPLETION

WAS WELL DIRECTIONALLY DRILLED?

WAS DIRECTIONAL SURVEY MADE?

WERE 3 COPIES FILED WITH THE DEPARTMENT OF CONSERVATION?

DATE FILED

TYPE OF ELECTRICAL OR OTHER LOGS RUN (CIRCLE LOGS FILED WITH DEPT. OF CONSERVATION)

DATE FILED
See original form when well was drilled

6-27-62

CASING, LINER AND TUBING RECORD

CASING SIZE	HOLE SIZE	CASING WEIGHT	DEPTH SET	SACKS CEMENT	TEST PRESSURE	HRS. UNDER PRESSURE	DATE TESTED	NAME OF TEST WITNESS - STATE IF DEPT. AGENT OR OFFSET OPR.
No changes in original setting								
TUBING SIZE: 2" OD	DEPTH OF TUBING: 8823		DEPTH OF PACKER (S): 8823					

INITIAL COMPLETION OR RE-COMPLETION DATA

INITIAL PRODUCTION
26

GAS VOLUME
BOPD 1030 MCF/DAY

CHOKE SIZE
8/64

WELL STATUS
Flowing

TUBING PRESSURE
3100 psig

CASING PRESSURE
-0- psig

GOR
39700

BS & W
-0- %

BHP - (SHUT-IN)
PSI

GRAVITY
58.9 *API 60°F

CONSERVATION AGENT MAKING GAUGE

COMPANY REPRESENTATIVE

DATE GAUGED
9-15-64

PLUG AND ABANDON (P&A) DATA

CASING SIZE	AMOUNT PULLED	CEMENT PLUGS				DATE WORK PERFORMED	NAME OF TEST WITNESS - STATE IF DEPT. AGENT OR OFFSET OPR.
		FROM	TO	SACKS	HOW PLACED		

CERTIFICATE: I, the undersigned, state: That I am employed by An-Son Corporation and that I am authorized to make this report, and that this report was prepared under my supervision and direction and that all facts stated herein are true, correct and complete to the best of my knowledge.

Form WH Signature: Mortimer Squires Title: Operations Manager

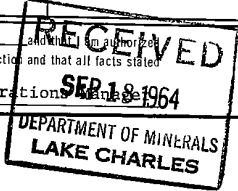

WORK RESUME

List below all work performed under Department of Conservation Work Permits while drilling and completing well.

WORK PERMIT NO.	DATE WORK PERFORMED	SERVICE COMPANY	DESCRIPTION OF WORK
Workover L.C. #34	9/8-13/64	Halliburton and Lane Wells	Squeeze perforations 8900 - 8904' and reperforate 8888 - 8893 for production

List below all important Paleontological or Geological Formation tops, Cap Rock and Salt tops and Salt Overhang bottoms.

FORMATION	DEPTH	FORMATION	DEPTH

*Willard
See page 5 file
Temp. allowable increased
check on well in 12 months
and see what production
conditions are?*

AN-SON CORPORATION

110 SARATOGA BLDG.

NEW ORLEANS, LA. 70112

TELEPHONE 524-2282

December 4, 1964

Willard

Mr. W. C. Wilhite, Manager
Louisiana Department of Conservation
P. O. Box Drawer 1767
Lake Charles, Louisiana

Dear Sir:

Our 8885 Sand Unit "A", B. T. Labove #1, Little Chenier Field, Cameron Parish, Louisiana, has been producing under a gas allowable from perforations at 8888' to 8893'. The tubing pressure from the well has now declined to such a point that it cannot buck gas sales line pressure.

Production gauge taken on December 3, 1964, was as follows:

19 BOPD, FTP - 1000#, 9/64" Choke, Gas 60 MCF, GOR - 3160
BS&W - 86% - Gravity - 49.6° Corr.

It is requested that the well be regauged and reclassified as an oil well to enable its being assigned an oil allowable to enable our fully depleting the present zone of liquid hydrocarbons.

Please note that Conservation Department Order #645 dated November 18, 1963, creating the unit from which the well is now producing provides for the production of gas and liquid hydrocarbons from this unit.

Yours very truly,

AN-SON CORPORATION

Mortimer Squires
Mortimer Squires
Operations Manager

MS/ew

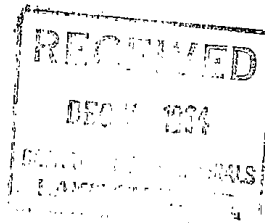

MINERALS DIVISION
DEPARTMENT OF CONSERVATION
STATE OF LOUISIANA

Workover
L. C. #23

WORK PERMIT

PERMIT TO Workover DATE 5/31/66
PARISH Cameron FIELD Little Chenier
COMPANY An-Son Corp.
ADDRESS 810 Saratoga Bldg., New Orleans, La. 70112
WELL NAME LaBeve No. 1 SEC. 14 T. 14S R. 6W
WELL PERMIT SERIAL No. 73882 WORK PERMIT No. _____
LOCATION _____

YOU ARE HEREBY AUTHORIZED TO Abandon perf. 8888 to 8893
and complete in open perf. 9393 to 9398

PERMIT REQUESTED BY WEBB JAY TD 9550
Company Representative

AUTHORIZED BY _____

WILLIAM C. WILHITE

Dist. Lake Charles, La.

July 13, 1966

*WO Norm
1000 MCF
Frank
Wrong*

An-Son Corporation
810 Saratoga Bldg.
New Orleans, Louisiana

Gentlemen:

This office is in receipt of Recompletion Report and Potential Report for your B. T. LaBove No. 1 well, Little Cheniere Field.

Please be advised that the present name of the well 8885' SU A; B. T. LaBove should be changed to B. T. LaBove No. 1 by our form MD-10-R-A including a check for \$25.00 since the 9390' sand is not regulated by a special field order. It will have to be produced on a lease basis until you apply for and a subsequent hearing is held.

In order for you to receive an allowable for the well under Order 29-F it will be necessary for you to submit plats in triplicate outlining the acreage that you wish to assign the well and also have your gas purchaser to submit a nomination.

If we can be of further help please let us know.

Yours very truly,

H. E. WALKER
Acting District Engineer

HEW:jt

POTENTIAL REPORT

Type Well: Oil _____ Gas Distillate _____

Type Test: Comp. _____ Recomp. Retest _____ Regauge _____

Parish CAHERON Field Little Chonier

Company AN-SON CORP Serial No. 89294

Well Name & No. LaBoBe # 1

Location: Sec. 14 Twp. 14S Rge. 6W Flowing Pump _____

Prod. Horiz. 9391 Unit A Perf. Int. 9393 to 9398

Casing Setting: Size 5 1/2 @ 9332

Tubing Setting: Size 2 1/16 @ 9332 T.D. 9950

Date Completed 6-24-66 Date Gauged 6-27-66

Acidize with _____ gals. Elev. of Derr. Floor _____

TEST DATE

T. P. 3100 C. P. 0 Choke Size Adi /64th

Closing TK Gge. 2 ft. 8 3/4 in. @ 4:15 PM Time

Opening TK Gge. 2 ft. 8 in. @ 12:15 PM Time

Diff. 0 ft. 3/4 in. 4 Hours (Time)

Tank No. 28687 Tank Coef. 2.76

Bbls. per 4 Hrs. Est. Bbls. per Day 12

Daily Gas Vol. 1050 M.C.F. G/O Ratio 87500

B.S.&W. 1/10 % Corrected Gravity 53 @ 78 Deg. A.P.I.

Witnessed [Signature] Title Inspector

Gauged by [Signature] Title _____
Department of Conservation

District Office Lake Charles

Remarks: _____

890 @ 28"
3" x 1" O.R

DEPARTMENT OF CONSERVATION
STATE OF LOUISIANA

*Letter 7/13
9-91 22?*

WELL COMPLETION OR RECOMPLETION REPORT

Lake Charles DISTRICT

Re: Well Serial No.: 89294

Completed	<input type="checkbox"/>	Flowing	<input type="checkbox"/>	Operator:	<u>An-Son Corporation</u>
Recompleted	<input checked="" type="checkbox"/>	Gas-Lifting	<input type="checkbox"/>	Well Name:	<u>9391 SU A B. T. LaBove</u>
Oil	<input checked="" type="checkbox"/>	Pumping	<input type="checkbox"/>	Well No.:	<u>1</u> , Sec. <u>14</u> , Twp. <u>14S</u> , Rge. <u>6W</u>
Gas	<input type="checkbox"/>	Shut-In	<input type="checkbox"/>	Field	<u>Little Chenier</u>
				Parish	<u>Cameron</u>

Date Completed or Recompleted June 25, 1966 at 10:00 (a.m.) (~~PM~~)

COMPLETION DATA

Initial Production 12 BOPD Gas Volume 1050 MCF/Day
 Tubing Pressure 3100 psig Casing Pressure 0 psig
 Choke Size adj Positive Adjustable X B.S.&W. 1/10 %
 Gas/Oil Ratio 87:500 CF/Bbl. Gravity 51.2 at 60° A. P. I.
 Producing Depth: From 9393 Ft. to 9398 Ft. T. D. 9550 Ft.
 Name of Producing Sand: 9391 foot SU A

*New Pool *Old Pool List Reason(s) for Pool Classification
New Pool order #645 dated November 18, 1963

*As Defined in Statewide Order No. 29-H.

Additional clearance is requested for No barrels of oil produced on drill stem or other production tests (See Section X, Paragraph B of Order No. 29-B on reverse side).

Three (3) copies to be filed with the District Office within three (3) days of date of completion or recompletion (as per Order 29-B, Section X, Paragraph A, Article 1).

I hereby certify that the above information is true and correct to the best of my knowledge.

DISTRICT MANAGER ONLY

29-E Compliance - Yes No An-Son Corporation
 29-E Unit Attached - Yes No COMPANY
 DATE: June 28, 1966

J. L. Brown
 COMPANY REPRESENTATIVE
 Drilling Superintendent
 TITLE

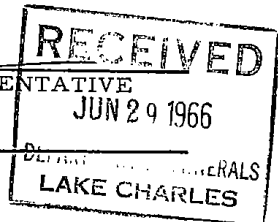

Form - Comp.

State of Louisiana
DEPARTMENT OF CONSERVATION
Inter Office.

Date: 7/19/66

To: Baton Rouge Office
From: Lake Charles District
Att'n: Fritz Spencer

Enclosed herewith please find application from An-Son Corporation
for permit to and, name on their
9391' SU A; B. T. LaBove Well No. 1 Zone: _____
Little Cheniere Field, Cameron Parish.

Also enclosed please find:

Check No. _____ in the amount of \$ _____

Well Location Plat _____

Well Location Certification _____

Form A. D. C. _____

Electric Log _____

Schematic Diagram _____

Applicable Department of Conservation Order No. 645-B Pending Hearing _____
Docket No. _____

Remarks & Recommendations:

**Recommend approval. Name change requested to comply with the provisions of Ord. 645-B.
This amendment is exempt from the normal fee.**

FORMERLY: 8885' SU A; B. T. LaBove Well No. 1, Serial #09294

Yours very truly,

cc: Prod. Audit Section, Baton Rouge, La.

By:

District Manager

W. C. WILHITE

cc: Geological Survey

WGM:jt
LT-1

MINERALS DIVISION
DEPARTMENT OF CONSERVATION
STATE OF LOUISIANA

Pull Csg.
L. C. #1

WORK PERMIT

PERMIT TO Full casing DATE 1/11/67
Cameron FIELD Little Chenier
PARISH An-San Petroleum Corp.
COMPANY
ADDRESS New Orleans, La.
WELL NAME B. T. LaBoys No. 1 SEC 14 T 14S R 6W
WELL PERMIT SERIAL No. 89294 WORK PERMIT No. _____
LOCATION _____

YOU ARE HEREBY AUTHORIZED TO Cut casing @2600 & pull.

PERMIT REQUESTED BY BRYAN WYATE

Company Representative

AUTHORIZED BY *W. C. Wilhite*

W. C. WILHITE-Lake Charles, La.

District Office

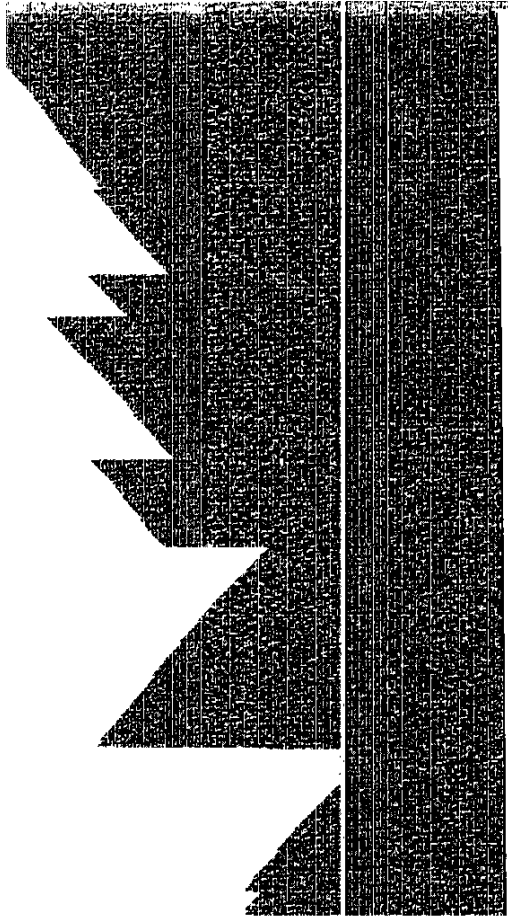

MINERALS DIVISION
DEPARTMENT OF CONSERVATION
STATE OF LOUISIANA

P & A
L. C. #6

WORK PERMIT

PERMIT TO Plug & Abandon DATE 1/11/67
PARISH Cameron FIELD Little Chenier
COMPANY AmSoc Petroleum
ADDRESS New Orleans, La.
WELL NAME B. T. LaBove No. 1 SEC. 14 T. 14S R. 6N
WELL PERMIT SERIAL No. 89294 WORK PERMIT No. _____
LOCATION _____

YOU ARE HEREBY AUTHORIZED TO Set cement plug & 8788 to 8888 &
2550-2700 & 0-20

PERMIT REQUESTED BY BRYAN WYAT TD. 9550

Company Representative

AUTHORIZED BY William B. White
W. C. WILHITE - Lake Charles, La.
District Office



DEPARTMENT OF CONSERVATION
STATE OF LOUISIANA

PLUG AND ABANDON REPORT

DATE WORK DONE Jan 13 1967

WELL SERIAL NO. 79594
WORK PERMIT NO. _____

Lake Charles DISTRICT
(Three Copies to be Filed with the District Office)

NOTE: This Report Will be Returned if Not Properly Completed And Signed.

Field Atala Chenier Parish Cameron Sec. 14 Twp. T14S Rge. R6W
Company American Oil & Gas Lease B-T LaBore Well No. 1
Total Depth 9300 Condition of Well Average

1. Surface Casing	Size <u>9 7/8</u>	Depth <u>2637</u>	Amount Pulled <u>✓</u>
2. Protection Casing	Size <u>5 1/2</u>	Depth <u>9300</u>	Amount Pulled <u>2600</u>
3. Production Casing <u>Small</u>	Size <u>5 1/2</u>	Depth <u>9200</u>	Amount Pulled <u>9200</u>

CEMENT PLUGS

1. Depth <u>8788</u>	To <u>6888</u>	No. of Sacks <u>15</u>	How Placed <u>Rig Pump</u>
2. Depth <u>2550</u>	To <u>2700</u>	No. of Sacks <u>75</u>	How Placed <u>Rig Pump</u>
3. Depth <u>0</u>	To <u>20</u>	No. of Sacks <u>20</u>	How Placed <u>Hand</u>

Mud Record: Weight 10.2 Viscosity _____

Remarks: This work was sub Contracted by American Well Service for Sea Board Well Service.
This work was done according to the Rules and Regulations of the Department of Conservation.

Raymond Lick
WITNESS

Equip. Inc. American Well Service
COMPANY

(Signed) Carl McDowell
REPRESENTATIVE

JAN 16 1967