

Operator
 Lease
RECEIVED
 Description
 MAY 31 1956 Date Plat Drawn
 DEPARTMENT OF CONSERVATION
 MINERAL DIVISION
 LAFAYETTE, LOUISIANA

THE ATLANTIC REFINING COMPANY
 ADELINE SUGAR FACTORY COMPANY
 JEANERETTE
 Section 37, T. 13 S., R. 9 E., St. Mary Parish, La.
 Nov 15, 1946.
 La-1280

Scale: 1" = 1000'

THE ATLANTIC REFINING CO.
 SURVEYING DEPT.
 DALLAS, TEXAS.

Sur. DP08
 Dwn. RAW

Approved:
W. J. Burkert

Date: 11-15-46
 Rev: 5-24-56
A-941

STATE OF TEXAS
COUNTY OF DALLAS

I, W. J. BURKART, Chief Surveyor for the ATLANTIC REFINING COMPANY of Dallas, Texas, being first duly sworn on OATH, STATE THAT I HAVE KNOWLEDGE OF THE FACTS AND MATTER SET FORTH IN THE FOREGOING PLAT AND THAT SAME ARE TRUE AND CORRECT.

W. J. BURKART

SUBSCRIBED AND SWORN TO BEFORE ME THIS 28 DAY OF May 1956. *Barbara Overbeck*
NOTARY PUBLIC IN AND FOR DALLAS COUNTY, TEXAS. ROOM ATLANTIC Bldg., DALLAS, TEXAS. BARBARA OVERBECK

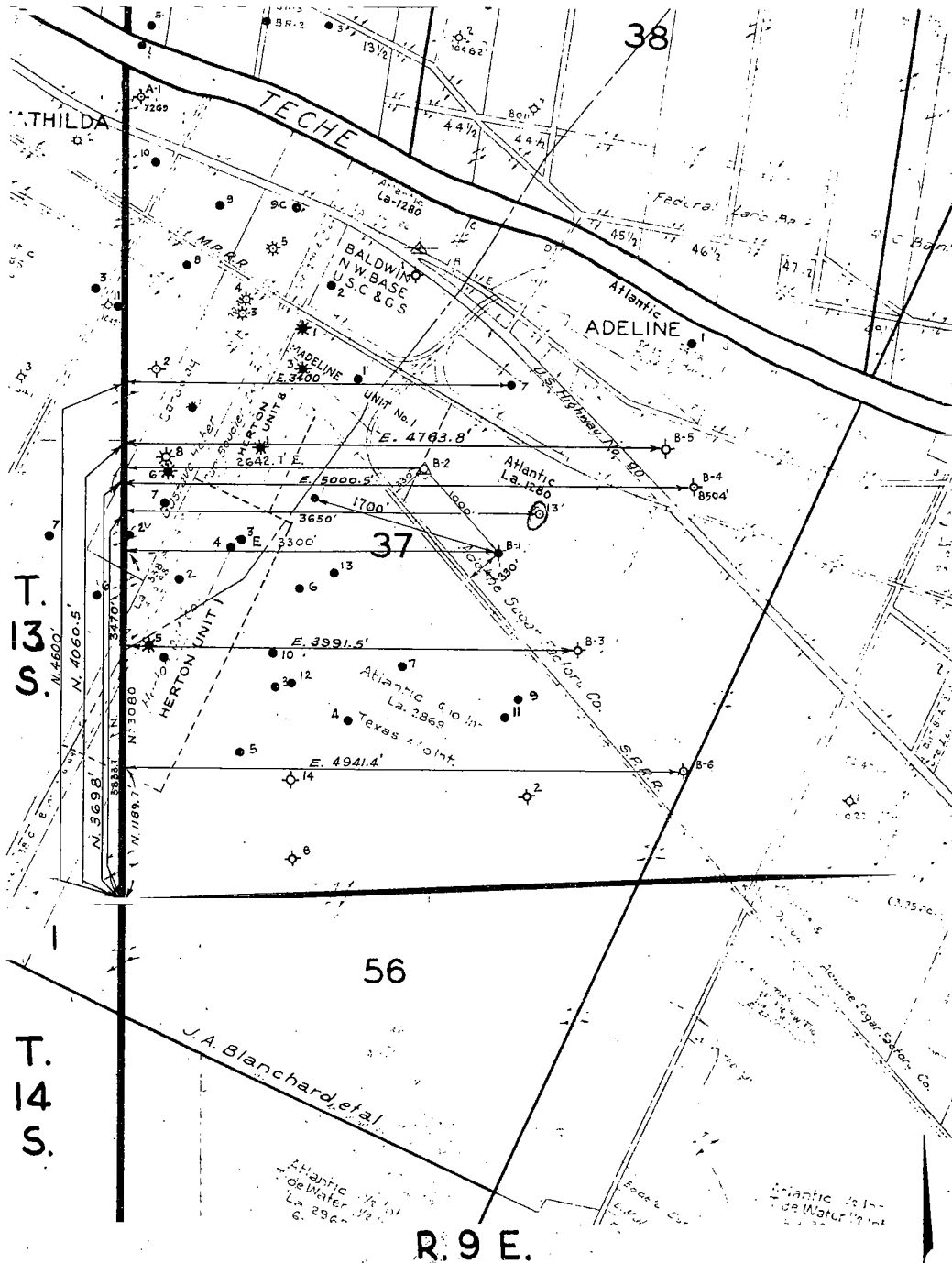

T. 13 S.
T. 14 S.

R. 9 E.

Operator THE ATLANTIC REFINING COMPANY
 Lease ADELINE SUGAR FACTORY COMPANY
 Field JEANERETTE
 Section 37, T. 13 S., R. 9 E., St. Mary Parish, La.
 Date Plan Drawn Nov 15, 1946.
 La-1280



RECEIVED
 Date Plan Drawn
 Nov 23, 1946

DEPARTMENT OF CONSERVATION MINERALS DIVISION		Scale: 1" = 1000'	# 061446
THE ATLANTIC REFINING CO. SURVEYING DEPT. DALLAS, TEXAS.	Sur DPDB Dwn RAW	Approved: <i>W. J. Burkert</i>	Date 11-15-46 Rev. 5-24-56 A-941

June 1, 1956

Mr. T. M. Winfield, Chief Engineer
Minerals Division
Baton Rouge, Louisiana

Dear Mr. Winfield:

Enclosed herewith please find application from The Atlantic Refining Co. for permit to drill their Adeline Sugar Factory Co. #13, Jeanerette Field, St. Mary Parish.

Enclosed also is check No. 5337 for \$50.00 together with well location plat.

Yours very truly,

Frank J. Fava, Jr., Manager
Lafayette District

FJF:fb

Encls.

Mr. T. M. ...
...
...

...
...
...

...

...

...

N^o 46313

DISTRICT OFFICE COPY
DEPARTMENT OF CONSERVATION

\$50.00

PERMIT TO DRILL FOR MINERALS

BATON ROUGE, LA., JUNE 4, 1956

PARISH ST. MARY FIELD JEANERETTE

OPERATOR THE ATLANTIC REFINING COMPANY

ADDRESS P.O. BOX 1346, HOUSTON, TEXAS

LOCATION OF WELL FROM SOUTHWEST CORNER OF SECTION 37, 60 NORTH
3470' ALONG SECTION LINE, THENCE EAST AT RIGHT ANGLES 3650' TO
LOCATION IN SECTION 37.

.Sec. 37, T. 13S, R. 9E

You are hereby authorized to drill ADELINE SUGAR FACTORY CO.

Well No. 13, referred to under application bearing serial No. 61746

dated MAY 29, 1956, signed by [Signature]

This well to be drilled to 8900' #2" SAND zone on surface area of _____ acres.

DRILLING CONTRACTOR _____

[Signature]
STATE OF LOUISIANA
DEPARTMENT OF CONSERVATION

Commissioner, Department of Conservation Chief Engineer, Division of Minerals

3-2-50

PERMIT TO DRIFT FOR MINERS
DEPARTMENT OF CORRELATION

STATE OF MICHIGAN

DEPT

RECEIVED

DEPARTMENT OF CORRELATION
MICHIGAN
DIVISION OF MINES
LANSING, MICHIGAN

[Handwritten signature]

APPROVED

DATE

DEPARTMENT OF CONSERVATION
STATE OF LOUISIANA

AFFIDAVIT OF TEST OF CASING IN WELL

WORK PERMIT NO. _____
WELL SERIAL NO. 61746

DATE WORK DONE 6/17/56

Lafayette, Louisiana
(One copy to be filed with the District Office)

N O T E:

THIS REPORT WILL BE RETURNED IF NOT PROPERLY FILLED IN AND SIGNED

PARISH St. Mary FIELD Jeanerette SEC 37 T.M.P. 13 SRGE 9E

COMPANY The Atlantic Refg. Co LEASE Adeline Sugar Facky Co WELL NO. 13

TOTAL DEPTH 1411

SIZE OF CASING 10-3/4" IN: WT. PER FT. 32.75# #: MAKE National

NO. OF THREADS PER IN. 8RD GRADE H-40 SEAMLESS NEW 2ND

IF SECOND HAND, WAS PIPE TESTED: _____ DESCRIBE _____

DEPTH LANDED BELOW DERRICK FLOOR 1405 FT. SACKS OF CEMENT 800

SIZE OF HOLE 15" IN.: AMOUNT OF CEMENT LEFT IN PIPE 37 1/2'

METHOD OF CEMENTING Halliburton CEMENT SET 12 HOURS UNDER 500 LBS.

PRESSURE _____ TOTAL TIME SET 26 HOURS

DETAIL OF PRESSURE TEST BEFORE DRILLING PLUG

DATE OF TEST: 6/18/ 19 56 . GAUGE PRESSURE ON CASING 1400 LBS.

PRESSURE AT END OF 30 MINUTES 1400 DROP - LBS.

TEST FLUID: WATER MUD _____ LBS. PER GAS; VISCOSITY _____ SEC.

REMARKS: _____

THIS WORK WAS DONE ACCORDING TO THE RULES AND REGULATIONS OF THE DEPARTMENT OF CONSERVATION, MINERALS DIVISION

RECEIVED

SIGNED THE ATLANTIC REFINING COMPANY
COMPANY

WITNESS: _____

JUN 22 1956

DEPARTMENT OF CONSERVATION
MINERALS DIVISION

Charles C. Evans
Representative

Form: Csg. (T)-MD16

LAFAYETTE, LOUISIANA

MINERALS DIVISION
DEPARTMENT OF CONSERVATION
STATE OF LOUISIANA

WORK PERMIT

PERMIT TO Perforate DATE July 6, 1956
PARISH St. Mary FIELD Jeanerette
COMPANY The Atlantic Refining Co.
ADDRESS P. O. Box 1346 Houston, Texas
WELL NAME Adeline Sugar Factory Co. No. 13 SEC. 37 T. 13S R. 9E
WELL PERMIT SERIAL No. 61746 WORK PERMIT No. Perf. L#855
LOCATION _____

YOU ARE HEREBY AUTHORIZED TO Perforate from 3069-3073 for
production.

PERMIT REQUESTED BY C. A. Kinney TD 9508
Company Representative

AUTHORIZED BY _____
Lafayette
District Office

DEPARTMENT OF CONSERVATION
STATE OF LOUISIANA

AFFIDAVIT OF TEST OF CASING IN WELL

WORK PERMIT NO. _____
WELL SERIAL NO. 61746

DATE WORK DONE 7/6/56

Lafayette, Louisiana

(One copy to be filed with the District Office)

N O T E:

THIS REPORT WILL BE RETURNED IF NOT PROPERLY FILLED IN AND SIGNED

PARISH St. Mary FIELD Jeanerette SEC 37 TWP 13 RGE 9E

COMPANY The Atlantic Refg Co LEASE Adeline Sugar Factly Co WELL NO. 13

TOTAL DEPTH 9508

SIZE OF CASING 5 1/2" IN: WT. PER FT. 15.5#; 14# #: MAKE J&L; National

NO. OF THREADS PER IN. 8RD GRADE J-55 SEAMLESS NEW 2ND

IF SECOND HAND, WAS PIPE TESTED: - DESCRIBE _____

DEPTH LANDED BELOW DERRICK FLOOR 3160' FT. SACKS OF CEMENT 500

SIZE OF HOLE 9-7/8" IN.: AMOUNT OF CEMENT LEFT IN PIPE 33'

METHOD OF CEMENTING Halliburton CEMENT SET 2 HOURS UNDER 700 LBS.

PRESSURE _____ TOTAL TIME SET 30 HOURS

DETAIL OF PRESSURE TEST BEFORE DRILLING PLUG

DATE OF TEST: 7/7/ 19 56 . GAUGE PRESSURE ON CASING 1500 LBS.

PRESSURE AT END OF 30 MINUTES 1500 DROP 0 LBS.

TEST FLUID: WATER MUD 10.2 LB. PER GALLON 42 SEC.

REMARKS: _____

RECEIVED
JUL 10 1956

THIS WORK WAS DONE ACCORDING TO THE RULES AND REGULATIONS OF THE DEPARTMENT OF CONSERVATION, MINERALS DIVISION.

DEPARTMENT OF CONSERVATION
MINERALS DIVISION
LAFAYETTE, LOUISIANA
THE ATLANTIC REFINING COMPANY
COMPANY

WITNESS: _____

J. S. Macher
Representative

Form: Csg. (T)-MD16

POTENTIAL REPORT

Type Well: Oil Gas _____ Distillate _____

Type Test: Comp. Recomp. _____ Retest _____ Regauge _____

Parish ST MARY Field JEANERETTE

Company Atlantic Refining Co. Serial No. 61746

Well Name & No. A-11 NE Sugar Fct. #13

Location: Sec. _____ Twp. _____ Rge. _____ Flowing Pump _____

Prod. Horizon _____ Perf. Int. 3069 to 3073

Casing Setting: Size 5 1/2 @ 3126

Tubing Setting: Size 2" @ 2984 T.D. 9508

Date Completed 7-7-56 Date Gauged 10-24-56

Acidize with _____ gals. Elev. of Derr. Floor _____

— TEST DATE —

T. P. 160 C. P. 540 Choke Size open / 64th

Closing TK Gge. 2 ft. 6 in. @ 3:30 Time

Opening TK Gge. 2 ft. 4" in. @ 1:30 Time

Diff. _____ ft. 2 in. 2 Hours (Time)

Tank No. 1 Tank Coef. 1.16

Bbls. Per. 2 Hrs. 2.32 Est. Bbls. Per Day 28

Daily Gas Vol. 825 *M³C.F. G/O Ratio 28600

B.S.&W. 85% % Corrected Gravity 31.3 Deg. A.P.I.

Witnessed [Signature] Title Prod. Foreman

Gauged by [Signature] Title Job I. #2
Department of Conservation

District Office [Signature]

Remarks: _____

* Thousands

DEPARTMENT OF CONSERVATION
STATE OF LOUISIANA

-PERFORATING RECORD -

DATE WORK DONE 7-7-56

WORK PERMIT NO. Perf. L#855
WORK SERIAL NO. 61746

Lafayette, Louisiana
(One Copy to be filed with the District Office)

NOTE

THIS REPORT WILL BE RETURNED IF NOT PROPERLY FILLED IN AND SIGNED

PARISH St. Mary FIELD Jeanerette SEC 37 TWP 13S RGE 9E

COMPANY The Atlantic Refg Co LEASE Adeline Sugar Factory Co. WELL NO. 13

TOTAL DEPTH 9508 NEW OR OLD WELL New

SIZE CASING 5 1/2" DEPTH OF CASING 3160

DEPTH OF PLUG BELOW PERFORATIONS 3126

PERFORATED FROM 3069 TO 3073

NUMBER OF HOLES 16 SIZE OF HOLES Jet

PERFORATING COMPANY Welex TRUCK NUMBER _____

PURPOSE OF PERFORATIONS For production

REMARKS _____

THIS WORK WAS DONE ACCORDING TO THE RULES AND REGULATIONS OF THE DEPARTMENT OF CONSERVATION.

RECEIVED
SIGNED [Signature] THE ATLANTIC REFINING COMPANY
COMPTON COMPANY
JUL 10 1956
DEPARTMENT OF CONSERVATION
MINERALS DIVISION
Representative
LAFAYETTE, LOUISIANA

Form
Perf - MD4

DEPARTMENT OF CONSERVATION
STATE OF LOUISIANA

Lafayette, La. DISTRICT

WELL COMPLETION OR RECOMPLETION REPORT

OIL WELL() Three Copies to be filed with District Office within three (3) days of date of completion or recompletion (as per Order No. 29-A, Section X, Paragraph A, Article 1) COMPLETION() RECOMPLETION()
DIS. WELL()
GAS WELL() PERMIT SERIAL NO. (61746)
PARISH St. Mary FIELD Jeanerette SEC 37 TWP 13S RGE 9E
COMPANY The Atlantic Refg Co LEASE Adeline Sugar Factory Co WELL NO. 13
DRILLING CONTRACTOR C. F. Martin Oil Well Service DATE SPUDDED (~~XXXX~~) 6-16-56
DATE COMPLETED OR RECOMPLETED 7-7 *1956, AT 8 (~~XXX~~) (P.M.)

* Well shut in until gas lift equipment was installed.

COMPLETION DATA

INITIAL PRODUCTION 14.6 BBLs./NET
TUBING PRESSURE 100# #/SQ. IN. GAS FLOWING() SHUT IN()
CASING PRESSURE 0 #/SQ. IN. GA.
CHOKE SIZE open POSITIVE() ADJUSTABLE()
B.S. & W. 85% PERCENT SALT WATER() WASH WATER()
GAS VOLUME _____ MCF/DAY
GAS/OIL RATIO gas lift GF/BBLs.
GRAVITY 31.3 (60degrees A. P. I.)
PRODUCING DEPTH 3069 FT. TO 3073 FT.
PERFORATED YES() NO() BOTTOM TUBING 2977 FT. SIZE 2 IN.
CASING (OIL STRING) SIZE 5 1/2 IN I.D. () O.D. () BOTTOM SEAT 3160 FT.
TOTAL DEPTH DRILLED 5908 FT. DERRICK FLOOR ELEVATION 26.40 FT.
(Additional clearance is requested for _____ barrels of oil produced on drill-stem or other production tests. (See Section X, Paragraph B, of Order No. 29-A on reverse side.)

FORM SDM 1-R

THE ATLANTIC REFINING
COMPANY

DEPARTMENT OF CONSERVATION
COMPANY REPRESENTATIVE
J. F. Crews, Dist. Supervisor
10-25-56
RECEIVED
OCT 24 1956
LOUISIANA

DEPARTMENT OF CONSERVATION
STATE OF LOUISIANA

This side to be used when requesting clearance for oil produced on Drill Stem Test or other Production tests, made previous to official completion or recompletion.

SECTION X, PARAGRAPH B OF ORDER NO. 29-A

Allowables given to wells for oil produced on drill stem tests, production test and miscellaneous production of oil shall be in accordance with the following rule.

All operators are required, within five days, to file three signed copies of the record of the daily production from the well, showing the number of hours the well produced and the interval of production- as "from 8:00 A.M., August 5 To 3:00 P.M., August 8, 1942."

T E S T D A T A

DATE OF TEST	TIME OF TEST	AMOUNT OF OIL PRODUCED
_____	M. TO _____ M.	_____ BARRELS
_____	M. TO _____ M.	_____ BARRELS
_____	M. TO _____ M.	_____ BARRELS
_____	M. TO _____ M.	_____ BARRELS
_____	M. TO _____ M.	_____ BARRELS
_____	M. TO _____ M.	_____ BARRELS
_____	M. TO _____ M.	_____ BARRELS
_____	M. TO _____ M.	_____ BARRELS
_____	M. TO _____ M.	_____ BARRELS
_____	M. TO _____ M.	_____ BARRELS
_____	M. TO _____ M.	_____ BARRELS
_____	M. TO _____ M.	_____ BARRELS
TOTAL		_____ BARRELS

The above total barrels of oil were produced from _____ Ft. to _____ FT.

REMARKS: _____

C O M P A N Y

C O M P A N Y R E P R E S E N T A T I V E

COPY GEOLOGICAL SURVEY

STATE OF LOUISIANA
DEPARTMENT OF CONSERVATION
MINERALS DIVISION

LOG OF WELL

FIELD Jeanerette COMPANY The Atlantic Refining Company

Parish St. Mary Sec. 37 Twp. 13S Rge. 9E Elevation 26.40
Derrick Floor. 26.40
Ground 10.90

From SW corner of Sec 37 go N on Sec line 3470*
Location thence E @ R/A 3650* to location.

Lease Adeline Sugar Factory Co. Well No. 13 Permit No. 46313 Permit Serial No. 61746

The data given herewith is a complete record of the well and all work done thereon as determined from all available records.

Began Drilling 6-16-56, 1956 Completed 7-7-56, 1956
Completed as Oil (X) Gas () Condensate () Dry () Well

OIL AND GAS ZONES	SALT WATER SANDS	FRESH WATER SANDS
From <u>3069</u> to <u>3073</u> feet	In zone of production	From _____ to _____ feet
From _____ to _____ feet	From _____ to _____ feet	From _____ to _____ feet
From _____ to _____ feet	From _____ to _____ feet	From _____ to _____ feet

DRILL STEM TESTS

Depth	Recovery in Stands			Chokes		Lbs. Pressure		Date	Time	Size D. S.	
	Seat	Bottom	Oil	Water	Sd. or Mud	Top	Bottom				Top
			N O N E								

CASING RECORD

Size	Wt. Per Foot	Make	Where Landed	No. of Sks. Cement	Stood Hours	Pressure Test, Lbs.
<u>10-3/4</u>	<u>32.75</u>	<u>National</u>	<u>1405</u>	<u>800</u>	<u>26</u>	<u>1400</u>
<u>5-1/2</u>	<u>15.5;14</u>	<u>J&L, National</u>	<u>3160</u>	<u>500</u>	<u>30</u>	<u>1500</u>

COMPLETION DATA

Liner Size None Weight _____ Length _____ Screen Size _____ Gage _____ Length _____
Casing perforations (prod. depth) from 3069 to 3073 ft. No. of holes _____
Acidized with _____ gallons. Other physical or chemical treatment of well to induce flow _____
Prod. began 10-22, 1956. Making 14.6 bbls./day of 31.3 A. P. I. Gravity Fluid on open choke.
Tub. Pres. 100 lbs./sq. in. Csg. Pres. 0 lbs./sq. in. Gas Vol. _____ M. C. F. Gas Oil Ratio _____
B. S. & W. 85 %. Gas Gravity _____ B. T. U.'s/M. C. F. _____ Gals. Gasoline/M. C. F. _____

WELL DATA

Indicate (yes or no) whether or not the following information was obtained.
Electrical Log Yes Date 6-29, 1956 Straight Hole Survey Yes Type TOTCO
Time Drilling Record _____ Other Types of Hole Survey Yes _____
Core Analysis Yes Depth 8142 to 2200
9138 to 8068 1/2
8794 to 2199

LOCATION OF WELL BOTTOM

Latitude _____ ft. Departure _____ ft. Average Inclination _____
Drilling Contractor C.F. Martin Oil Well Service Signed L.E. Wilson
Date October 23, 1956, 1956 Title L.E. Wilson, Dist. Drlg. Supervisor

Form No. 12-M-R

☆-642

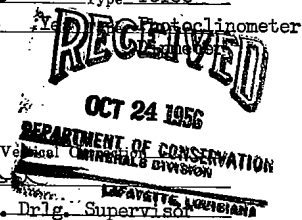

MINERALS DIVISION
DEPARTMENT OF CONSERVATION
STATE OF LOUISIANA

WORK PERMIT

PERMIT TO Squeeze & Perforate DATE 8-14-56
PARISH St. Mary FIELD Jeanerette
COMPANY The Atlantic Refg. Co.
ADDRESS P O Box 602, Lafayette, La.
WELL NAME Adeline Sugar Facky Co. No. 13 SEC 37 T. 13S R. 9E
WELL PERMIT SERIAL No. 61746 WORK PERMIT No. Sq. Perf. L#397
LOCATION _____

YOU ARE HEREBY AUTHORIZED TO Squeeze the present perforations
3069-3073 and reperforate 3069-3073 to shut off salt water.

PERMIT REQUESTED BY L. E. Wilson TD 9508
Company Representative

AUTHORIZED BY _____
Lafayette
District Office

MINERALS DIVISION
DEPARTMENT OF CONSERVATION
STATE OF LOUISIANA

- SQUEEZE AND PERFORATE RECORD -

DATE WORK DONE 8-21-56 WORK PERMIT NO. Sq. Perf. I#397
WELL SERIAL NO. 61746

Lafayette, La.

(One copy to be filed with the District Office)

N O T E:

THIS REPORT WILL BE RETURNED IF NOT PROPERLY FILLED IN AND SIGNED

PARISH St. Mary FIELD Jeanerette SEC 37 TWP 13 RGE 9E
COMPANY TARCO LEASE Adeline Sugar Facky. WELL NO. 13
TOTAL DEPTH 9508 NEW OR OLD WELL NEW
SIZE OF CASING 5 1/2" DEPTH OF CASING 3160
METHOD OF PLACING CEMENT Halliburton
WHERE CEMENT RETAINER SET: DEPTH 3045 FT.
ZONE OF SQUEEZE FROM 3069 TO 3073
NUMBER OF SACKS USED 875 HOURS CEMENT SET 2 1/2
BARRELS OF WATER PUMPED BEFORE CEMENT 5 AFTER 5
BREAKDOWN PRESSURE 400# FINAL PRESSURE 3500#
SQUEEZE JOB DONE BY Tri State
PERFORATED FROM 3069 TO 3073
NUMBER OF HOLES 16 SIZE OF HOLES 1/2"
PERFORATING COMPANY Welex TRUCK NO. _____
REMARKS: Squeeze job done in Six stages

THIS WORK WAS DONE ACCORDING TO THE RULES AND REGULATIONS OF THE DEPARTMENT OF CONSERVATION, MINERALS DIVISION.

SIGNED: THE ATLANTIC REFINING COMPANY
C O M P A N Y

J. E. Wilson

Representative

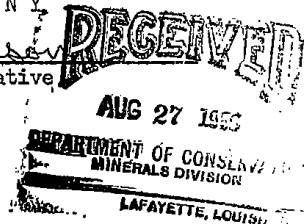

Form
Sq & Perf - ND13
#9403

Jeanerette

COMPANY The Atlantic Refining Co.

FARM Adeline Sugar Factory Co. WELL No. 13 EL.

PARISH St. Mary PERMIT No. 46313

PERMIT ISSUED June 4, 1956 SERIAL No. 61746

LOCATION SEC. 37 T 13S R 9E

PERMIT RENEWED

SPUDED

6-16-56

COMPLETED

DATE	DEPTH	REMARKS:
June 21	2566	10 $\frac{3}{4}$ " at 1408. Sand + shale.
" 28	2910	Shale
July 5	9505	hard mud
" 12		5 $\frac{1}{2}$ " at 3160. Prep for install gas lift buttons.
" 19		Opened well. Well started producing dry gas + sand - now produces sand.
" 26		Attempting to complete attempting the reverse. But
Aug. 2		shut. Testing well to
" 9		Well shut in 8-1-56
" 16		Pending remedial work - sanding wells. To shut
" 23		all salt water.
" 29		Testing wells.
Sept. 6		Testing
" 13		Well shut in.
" 20		" "
" 27		" "

Oct. 4

Well Shut In

" 12

"

" 18

"

" 25

"

Nov. 2

~~8843 Completed 10-1-56~~

~~11 hrs. on 11/64 choke~~

~~TP 2025' @ 500~~

~~TP 11800', G. 1.54~~

~~BstW. 2; Prod. from~~

~~5303-5306~~

9508'

Completed 7-7-56

38 hrs. on open choke

TP 150' @ 540, 60R

25000' G. 31.3; BstW

55; Prod. from 3069

3073.

MINERALS DIVISION
DEPARTMENT OF CONSERVATION
STATE OF LOUISIANA

- ACIDIZE RECORD -

DATE WORK DONE 12-20-56 WORK PERMIT NO. Acid L #224
WELL SERIAL NO. 61746

Lafayette, La.

(One copy to be filed with the District Office)

NOTE:

THIS REPORT WILL BE RETURNED IF NOT PROPERLY FILLED IN AND SIGNED

PARISH St. Mary FIELD Jeanerette SEC 37 TWP 13S RGE 9E

COMPANY The Atlantic Refg. Co. LEASE ADELINE SUGAR FACTORY WELL NO. 13

TOTAL DEPTH 9508' NEW OR OLD WELL Old

SIZE CASING 5 1/2" DEPTH OF CASING 3160

PURPOSE OF ACIDIZE JOB to increase production.

Tubing squeeze with production

ACID: -HOW PLACED equipment in hole PROD. ZONE 3069-3073

GALLONS OF ACID USED 500 KIND mud STRENGTH %

CHARACTER OF FORMATION Sand ACIDIZING COMPANY Dowell

BARRELS OF WATER OR OIL USED BEFORE ACID 10' AFTER 12

INITIAL PRESSURE 500 # BREAKDOWN PRESSURE 700 # FINAL PRESSURE 700 #

REMARKS: _____

THIS WORK WAS DONE ACCORDING TO THE RULES AND REGULATIONS OF THE DEPARTMENT OF CONSERVATION, MINERAL DIVISION.

SIGNED: THE ATLANTIC REFINING COMPANY

COMPANY

Representative

J. F. McCould, Dec 28 1956

Dist. Prod. Foreman, 12-27-56
DEPARTMENT OF CONSERVATION
MINERALS DIVISION

LAFAYETTE, LOUISIANA

Form
Acid - MD2

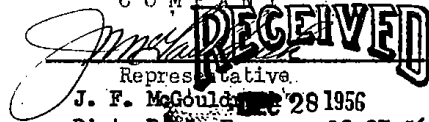

THE UNITED STATES OF AMERICA
DEPARTMENT OF JUSTICE
FEDERAL BUREAU OF INVESTIGATION

WASHINGTON, D. C. 20535

MEMORANDUM FOR THE DIRECTOR, FBI (100-442654) FROM SAC, NEW YORK (100-100000) (P)

RE: [Illegible]

NY 100-100000

[Extremely faint and illegible typed text, likely a memorandum body]

[Illegible stamp or signature]

100-100000-100000
[Illegible text]

100-100000-100000
[Illegible text]

MINERALS DIVISION
DEPARTMENT OF CONSERVATION
STATE OF LOUISIANA

WORK PERMIT

PERMIT TO Acidize DATE 12-26-56
PARISH St. Mary FIELD Jeanerette
COMPANY The Atlantic Refg. Co.
ADDRESS P O Box 602 Lafayette, La.
WELL NAME Adeline Sugar Factory Co. No. 13 SEC 37 T. 13S R. 9E
WELL PERMIT SERIAL No. 61746 WORK PERMIT No. Acid.I.#224
LOCATION _____

YOU ARE HEREBY AUTHORIZED TO Acidize down tubing with
500 gals. mud acid for production.

PERMIT REQUESTED BY J. F. McGouldrick TD 9508'
Company Representative

AUTHORIZED BY _____
Lafayette
District Office

MINERALS DIVISION
DEPARTMENT OF CONSERVATION
STATE OF LOUISIANA

WORK PERMIT

PERMIT TO Plug & Perforate DATE 1-29-57
PARISH St. Mary FIELD Jeanerette
COMPANY The Atlantic Refg. Co.
ADDRESS Box 602 Lafayette, La.
WELL NAME Adeline Sugar Factory Co. No. 13 SEC. 37 T. 13S. R. 9E
WELL PERMIT SERIAL No. 61746 WORK PERMIT No. P.Perf.L#11
LOCATION _____

YOU ARE HEREBY AUTHORIZED TO Set wire line GI bridge plug
at 2225, dump 10' cmt cap to isolate perforation 3069-
3073 Schl. Perforate 2196-2200' Schl. for
production. TD 9508'

PERMIT REQUESTED BY J. F. McGouldrick
Company Representative

AUTHORIZED BY _____

Lafayette
District Office



FORM 923
J. Wallace, Inc.

WELEX JET SERVICES, INC.
1400 E. BERRY ST.
FORT WORTH, TEXAS
WI-3248

PERFORATION LOG

Company ATLANTIC REF. CO. Casing Record 5 1/2" 15 1/2"
 Well & No. ADELIN SUDAR FACT. #13 Holes 32
 Location ST MARY Runs 7
 Depth _____ Truck & Operator 47-404 M.S. FILLER
 Date Perforated 1-29-57 Remarks _____
 Sales Order _____

CO. COLLAR	Welex	
2187.5	2187.5	2196
		2300 — 32 JET SHOTS
	<i>Jeanette</i>	

RECEIVED
 FEB 4 1957
 DEPARTMENT OF CONSERVATION
 MINERALS DIVISION
 LAFAYETTE, LOUISIANA

RESEARCH AND DEVELOPMENT OF
JET PERFORATING AND OTHER JET
PROCESSES FOR THE OIL INDUSTRY

FIELD SERVICE UTILIZING
LATEST DEVELOPMENTS

MINERALS DIVISION
DEPARTMENT OF CONSERVATION
STATE OF LOUISIANA

- PLUG AND PERFORATE RECORD -

DATE WORK DONE January 29, 1957 WORK PERMIT NO. P. Perf. I#11
WELL SERIAL NO. 61746

Lafayette, Louisiana
(One copy to be filed with the District Office)

N O T E:

THIS REPORT WILL BE RETURNED IF NOT PROPERLY FILLED IN AND SIGNED

PARISH St. Mary FIELD Jeanerette SEC 37 TWP 13SRGE9E

COMPANY The Atlantic Refining Co. LEASE Adeline Sugar Factory Co WELL NO. 13

TOTAL DEPTH 9508' NEW OR OLD WELL Old

SIZE OF CASING 5 1/2" DEPTH OF CASING 3160.03

C.I. Bridge Plug
~~XXXXXXXXXXXXXXXXXXXX~~ SET AT 2225'

DEPTH OF PLUG FROM 2225' TO 2212'

NUMBER OF SACKS 2 NUMBER OF HOURS CEMENT SET 12

PURPOSE OF PLUG Isolate Perforations 3069' - 3073' (Schl.)

PLUG JOB DONE BY Welex

PERFORATED FROM 2196' TO 2200' (Schl.)

NUMBER OF HOLES 32 SIZE OF HOLES Jet

PERFORATING COMPANY Welex TRUCK NUMBER _____

REMARKS: _____

THIS WORK WAS DONE ACCORDING TO THE RULES AND REGULATIONS OF THE DEPARTMENT OF CONSERVATION, MINERALS DIVISION.

SIGNED: THE ATLANTIC REFINING COMPANY

J. F. McGouldrick
Representative
District Production Foreman
January 30, 1957

RECEIVED

JAN 31 1957

DEPARTMENT OF CONSERVATION
MINERALS DIVISION
LAFAYETTE, LOUISIANA

Perf - MD7

POTENTIAL REPORT

Type Well: Oil Gas _____ Distillate _____

Type Test: Comp. Recomp. Retest _____ Regauge _____

Parish St Mary Field Jennette

Company Atlantic Refining Serial No. 61746

Well Name & No. Adeline Sugar F. #13

Location: Sec. _____ Twp. _____ Rge. B.L. Flowing Pump

Prod. Horizon _____ Perf. Int. 2196 to 2200

Casing Setting: Size 5 1/2 @ 2225

Tubing Setting: Size 2 1/2 @ 2110 T.D. 2500

Date Completed 2-12 Date Gauged 2-14-57

Acidize with _____ gals. Elev. of Derr. Floor _____

— TEST DATE —

T. P. 100 C. P. 460 Choke Size 21 /64th

Closing TK Gge. 14 ft. 0 in. @ _____ Time

Opening TK Gge. 13 ft. 9 1/4 in. @ 1087 Time

Diff. _____ ft. 2 3/4 in. 3 Hours (Time)

Tank No. 1 Tank Coef. 1.16

Bbls. per 3 Hrs. 3.19 Est. Bbls. per Day 26

Daily Gas Vol. 138 *M³C.F. G/O Ratio 5907

B.S.&W. 68% % Corrected Gravity 30.1 Deg. A.P.I.

Witnessed [Signature] Title Prod. Foreman

Gauged by [Signature] Title pt. 5th
Department of Conservation

District Office [Signature]

Remarks: _____

DEPARTMENT OF CONSERVATION
STATE OF LOUISIANA

Lafayette, La. DISTRICT

WELL-COMPLETION-OR-RECOMPLETION-REPORT

OIL WELL() Three Copies to be filed with district COMPLETION()
 DIS. WELL() Office within three (3) days of date of RECOMPLETION()
 completion or recompletion (as per Order PERMIT
 GAS WELL () No. 29-A, Section X, Paragraph A, Article 1). SERIAL NO.()
 PARISH St. Mary FIELD Jeanerette SEC 37 TWP 13S RGS 9E
 COMPANY THE Atlantic Refining Company ADRIANE SUGAR LEASE FACTORY CO. WELL NO. 13
 DRILLING CONTRACTOR Helsten DATE SPUDDED (OR W.O.) 1-28-57
 DATE COMPLETED OR RECOMPLETED 2/12 1957, AT 7 (A.M.) ()

COMPLETION DATA

INITIAL PRODUCTION 39 OF 1 BBLs./Net
 TUBING PRESSURE 185 OF 300 #SQ. IN. GAS FLOWING () SHUT-IN ()
 CASING PRESSURE 650 OF 1000 #SQ. IN. GA.
 CHOKE 3/4 SIZE POSITIVE () ADJUSTABLE ()
 B. S. & W. 65 PERCENT SALT WATER () WASH WATER ()
 GAS VOLUME Well producing by gas lift MCF/DAY
 GAS/OIL RATIO 1 OF 1 CF/BBLs.
 GRAVITY 31.4 OF 1 (60 DEGREES A. P. - I.)
 PRODUCING DEPTH 2196 FT. TO 2200 FT.
 PERFORATED YES () NO () BOTTOM TUBING 2110 FT. SIZE 1 1/2 IN.
 CASING (OIL STRENG) SIZE 5-1/2 IN I. D. () O. D. () BOTTOMSEAT / FT. 3160
 TOTAL DEPTH DRILLED 9508 FT. DERRICK FLOOR ELEVATION 26.40 FT.

(Additional clearance is requested for 1 barrels of oil produced on drillstem or other production tests. (See Section X, Paragraph B, of Order No. 29-A on reverse side.)

FORM SUM 1-R

RECEIVED
 THE ATLANTIC REFINING COMPANY
 COMPANY
 FEB 15 1957
 DEPARTMENT OF CONSERVATION
 COMPANY REPRESENTATIVE
 J. E. Crowe
 Dist. Supt.
 LAFAYETTE, LOUISIANA
 2-15-57

DEPARTMENT OF CONSERVATION
STATE OF LOUISIANA

This side to be used when requesting clearance for oil produced on Drill Stem Test or other Production tests, made previous to official completion or recompletion.

SECTION X, PARAGRAPH B OF ORDER NO. 29-A

Allowables given to wells for oil produced on drill stem tests, production test and miscellaneous production of oil shall be in accordance with the following rule:

All operators are required, within five days, to file three signed copies of the record of the daily production from the well, showing the number of hours the well produced and the interval of production as "from 8:00 A. M., August 5 to 3:00 P. M., August 6, 1942."

T E S T D A T A

Date of Test	TIME OF TEST	AMOUNT OF OIL PRODUCED
_____	M. TO _____ M.	_____ BARRELS
_____	M. TO _____ M.	_____ BARRELS
_____	M. TO _____ M.	_____ BARRELS
_____	M. TO _____ M.	_____ BARRELS
_____	M. TO _____ M.	_____ BARRELS
_____	M. TO _____ M.	_____ BARRELS
_____	M. TO _____ M.	_____ BARRELS
_____	M. TO _____ M.	_____ BARRELS
_____	M. TO _____ M.	_____ BARRELS
_____	M. TO _____ M.	_____ BARRELS
Total		_____ BARRELS

The above total barrels of oil were produced from _____ Ft. to _____ FT.

Remarks: _____

COMPANY

COMPANY REPRESENTATIVE

STATE OF LOUISIANA
DEPARTMENT OF CONSERVATION

AMEND OPERATOR

Amended Permit..... \$25.00

AMENDED PERMIT TO DRILL FOR MINERALS

SERIAL NO.: **61746** BATON ROUGE, LA., **6-9-56**, 19
PARISH: **St. Mary** FIELD: **Jeanerette**

OPERATOR: **Atlantic Richfield Company**
ADDRESS: **Box 51408 OCS**
Lafayette, La.

WELL NAME: **Adeline Sugar Factory Co.** NO.: **13**
LOCATION OF WELL: Sec. **37** T. **13S** R. **9E** **SAMS.**
***(Oily. The Atlantic Refining Company)**

Zone or Reservoir of proposed completion:

Applicable Department of Conservation Order:

[Signature]
Commissioner

[Signature]
Issuing Authority

Work Permit
STATE OF LOUISIANA DEPARTMENT OF CONSERVATION

Well Name & No. Adeline Sugar Factory Co #13 Sec. 37 T 13S R 9E
Field Jeanerette Parish St. Mary
Permit Serial No. 61746 Work Permit No. R# 1706, 1972

Description of Work (127) Plug and abandon. Set 30 sx cmt plug across
perfs 2196-2200'; cut & pull 5 1/2" csg to greatest possible depth;
set 30 sx cmt plug in 10-3/4" @ point 5 1/2" csg is pulled; set 15 sx
cmt plug in 10-3/4" csg @ surface.

Sand & Reservoir To Be Tested _____ TD 9508'

Operator Atlantic Richfield Company
Address P. O. Box 51408 OCS
City, State & Zip Lafayette, La. 70501 *P+B*

Permit Requested By *S. Melton* Date 9/12/72

Permit Authorized By _____ District *Lafayette* Date 9-13-72

See Instructions On Reverse Side

Form DM-4R Rev.

I N S T R U C T I O N S

A single application will suffice for one, or combinations of, the below operations provided that if more than one operation is requested on one form, such work must be performed consecutively.

If additional applications for Work Permits are necessary on any one well, each should be numbered 1, 2, etc. in the order requested. An original and one copy of this form will suffice for all work with exception of plug and abandon, for which an original and three copies are required.

- | | |
|-------------------------|-----------------------------------------|
| 1. Abandon (Plug & Abd) | 7. Pull Casing |
| 2. Deepen | 8. Change Zone of Selective Completion |
| 3. Perforate | 9. Drill Salt Water Disposal Well |
| 4. Squeeze | 10. Convert to Salt Water Disposal Well |
| 5. Plugback | 11. Drill Product Storage Well |
| 6. Sidetrack | |

NOTICE: To perform any of the above, as well as any other possible operations in Louisiana, without first obtaining a Permit is an infraction of the law and subject to prosecution.

DEPARTMENT OF CONSERVATION
STATE OF LOUISIANA

PLUG AND ABANDON REPORT

DATE WORK DONE 2/27/74

WELL SERIAL NO. 6173
WORK PERMIT NO. 1709.1972

Lafayette DISTRICT
(Three Copies to be Filed with the District Office)

NOTE: This Report Will be Returned if Not Properly Completed And Signed.

Field Jacmaratta 1 Parish St. Mary Sec. 37 Twp. 13S Rge. 9E
Company Atlantic Richfield Lease Adeline Sugar Factory Co. Well No. 13
Total Depth 9503' Condition of Well Depleted

- | | | | |
|----------------------|---------------------|--------------------|----------------------------|
| 1. Surface Casing | Size <u>10 3/4"</u> | Depth <u>1390'</u> | Amount Pulled <u>0</u> |
| 2. Protection Casing | Size _____ | Depth _____ | Amount Pulled _____ |
| 3. Production Casing | Size <u>5 1/2"</u> | Depth <u>3150'</u> | Amount Pulled <u>1800'</u> |

CEMENT PLUGS

- | | | | |
|-----------------------|-----------------|------------------------|--------------------------|
| 1. Depth <u>2600'</u> | To <u>2200'</u> | No. of Sacks <u>33</u> | How Placed <u>Pumped</u> |
| 2. Depth <u>1840'</u> | To <u>1440'</u> | No. of Sacks <u>80</u> | How Placed <u>"</u> |
| 3. Depth <u>0'</u> | To <u>50'</u> | No. of Sacks <u>25</u> | How Placed <u>"</u> |

Mud Record: Weight _____ Viscosity _____

Remarks: Welded 1/2 Steel Plate On Top

This work was done according to the Rules and Regulations of the Department of Conservation.

WITNESS

ATLANTIC RICHFIELD
COMPANY

(Signed)

[Signature]
REPRESENTATIVE

DEPARTMENT OF CONSERVATION
STATE OF LOUISIANA

PLUG AND ABANDON REPORT

DATE WORK DONE 3-1-74

WELL SERIAL NO. 61746
WORK PERMIT NO. L1706-771a

Lafayette DISTRICT
(Three Copies to be Filed with the District Office)

NOTE: This Report Will be Returned if Not Properly Completed And Signed.

Field Jeanerette Parish St. Mary Sec. 37 Twp. 13S Rge. 9E
Company Atlantic Richfield Lease Adeline Sugar Factory Well No. 13
Total Depth 9508' Condition of Well off Production

- | | | | |
|----------------------|-----------------------------------|--------------------|----------------------------|
| 1. Surface Casing | Size <u>10 3/4"</u> | Depth <u>1390'</u> | Amount Pulled <u>4' *</u> |
| 2. Protection Casing | Size _____ | Depth _____ | Amount Pulled _____ |
| 3. Production Casing | Size <u>5 1/2" ^{33#}</u> | Depth <u>3150'</u> | Amount Pulled <u>1500'</u> |

CEMENT PLUGS

RAN. 6751s. 2 3/8"
2-27-74 Depth 2077' To 1802' No. of Sacks 30 How Placed Pumped
RAN 4801s 2 3/8"
2-28-74 Depth 1480' ^{96"} To 1312' ^{72"} No. of Sacks 50 How Placed Pumped
3. Depth 34' To 4' * No. of Sacks 15 How Placed Dumped

Mud Record: Weight 9# S.W. Viscosity _____

Remarks: This P. & A. Done By W. L. Estis Casing (Rig #3)

* cut 10 3/4" @ 4' & welded 1/2" plate on top
This work was done according to the Rules and Regulations of the Department of Conservation.

W. J. St. Blanc
WITNESS
W. J. ST. BLANC
P. O. BOX 73
CHARENTON, LA. 70523

Atlantic Richfield Co.
COMPANY
J. A. Hughes
(Signed) REPRESENTATIVE

6174
130638

3-1-74

La Fayette

St. Mary's
Albany, Ga.
13
130638

130638

130638

130638

130638

130638

130638
130638
130638

130638
130638

130638
130638

#2

* cut 10/1/74
This FPA done by Mr. F. H. ...

130638

130638