

MINERALS DIVISION
DEPARTMENT OF CONSERVATION
STATE OF LOUISIANA

WORK PERMIT

PERMIT TO Convert to Salt Water Disposal DATE _____
PARISH St. Landry FIELD So. Jeanerette
COMPANY Atlantic Int'l. Co.
ADDRESS Galena, Texas
WELL NAME Adeline B NO. 2 SEC. 37 T. 13SR 9E
WELL PERMIT SERIAL NO. 35297 WORK PERMIT NO. _____
LOCATION 3833' N & 2642.7' E of SW Corner of Sec. 37.

YOU ARE HEREBY AUTHORIZED TO Plugback to approximately 1500'
and Perforate for use as a Salt Water Disposal
Well

PERMIT REQUESTED BY R. W. Coburn TD 8277*
Company Representative

AUTHORIZED BY Frank J. Fava, Jr., Mgr.
Lafayette
District Office

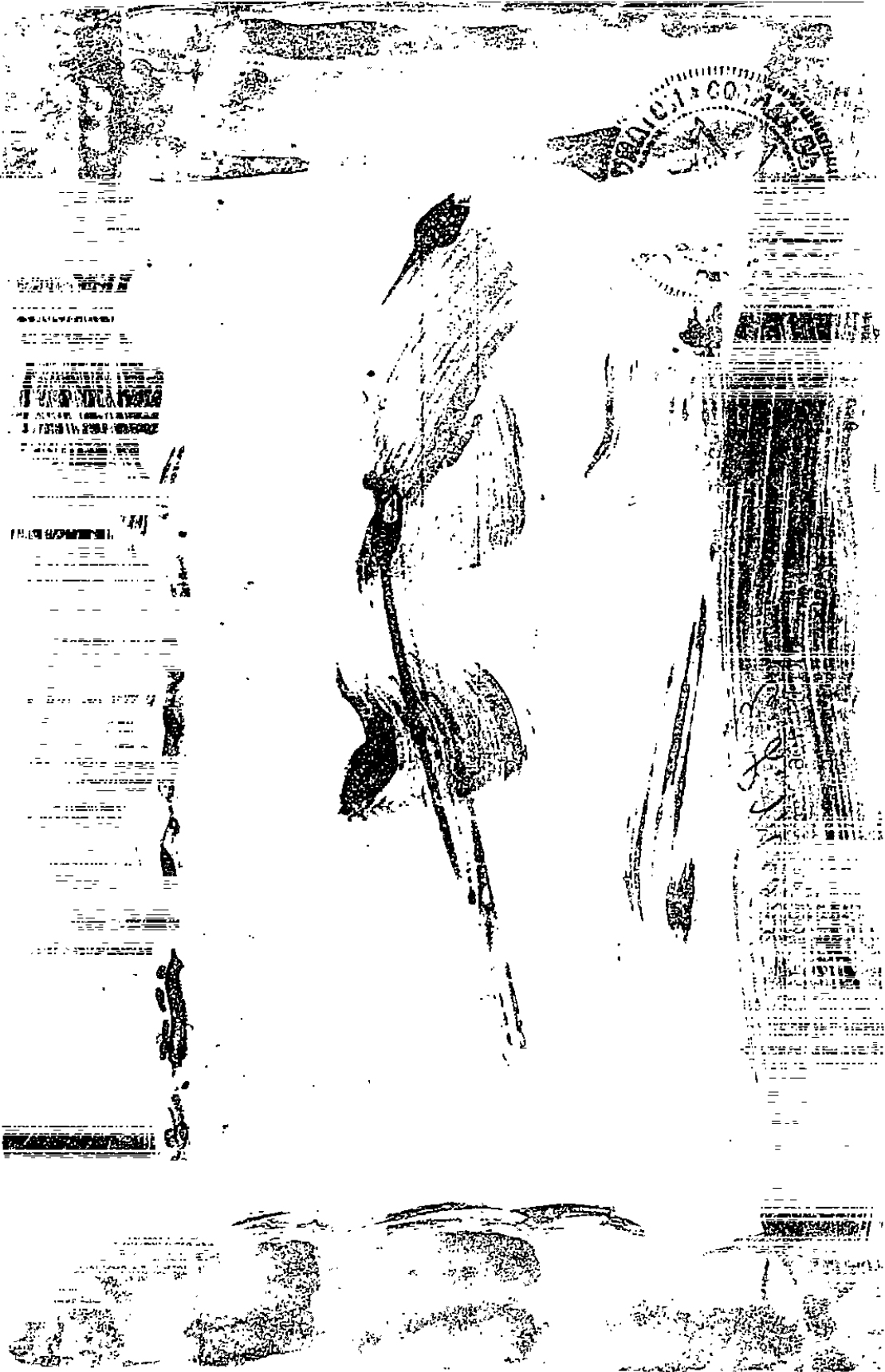

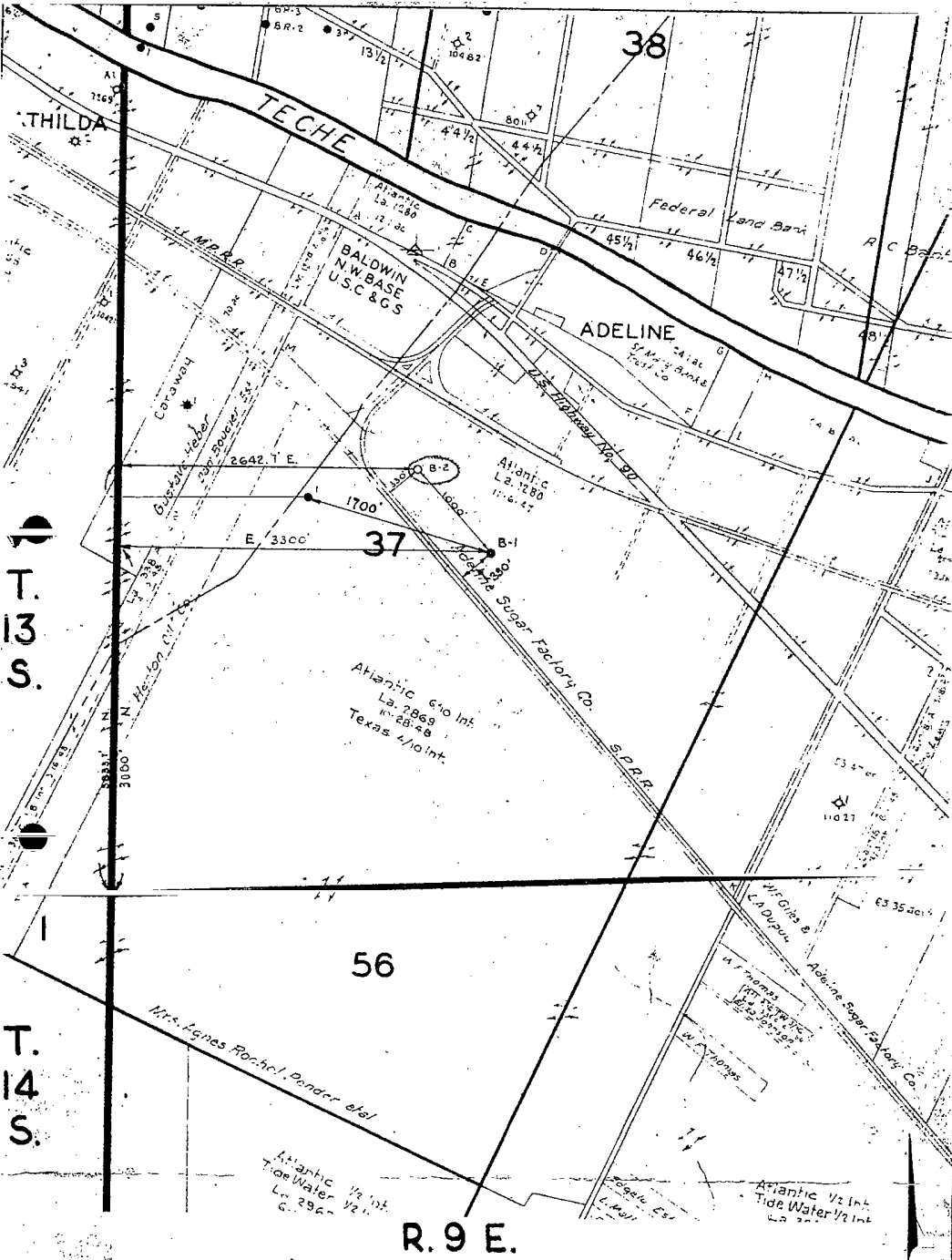

Operator THE ATLANTIC REFINING COMPANY
 Lease ADELINE SUGAR FACTORY COMPANY
 Field JEANERETTE AREA
 Description Section 37, T. 13 S., R. 9 E., St. Mary Parish, La.
 Date Plat Drawn Nov. 15, 1946.

La- 1280

#035297

Scale: 4" = 1000'

THE ATLANTIC REFINING CO.
 SURVEYING DEPT.
 DALLAS, TEXAS.

Sur DP08
 Dwnr. RAW

Approved:
W. J. Burkart

Date: 11-15-46
 Rev. 3-31-48
 A-941

STATE OF TEXAS
COUNTY OF DALLAS

I, W. J. Burkart, a qualified surveyor, regularly employed by the applicant, The Atlantic Refining Company of Dallas, Texas, as Chief Surveyor, hereby certify that the location of The Atlantic Refining Company's Adeline Sugar Factory Co.

(Tract B) Lease, Well No. 2 in South Jeanerette Field

St. Mary Parish, Louisiana is located as follows:

3833.7' N & 2462.7' e of SW Sec. Corner in

Section 37 Township 13-S Range 9-E.

W. J. Burkart CHIEF SURVEYOR,
W. J. BURKART

Subscribed and sworn to before me this the 1st day of April 1948

E. L. Moore
E. L. MOORE, 706 Magnolia Building
Notary Public in and for Dallas County, Texas,
706 Magnolia Bldg., Dallas, Texas

Department of Transportation
Mineral Division
APR 3 1948
LAFAYETTE, LA

April 3, 1948

Mr. T. M. Winfile, Acting Chief Engineer
Minerals Division
Baton Rouge, Louisiana

Dear Mr. Winfile:

Enclosed please find application from
The Atlantic Refining Company for permit to drill
Adeline Sugar Factory Co. (Tract 8), South
Jeanerette Field, St. Mary Parish.

Enclosed also is check No. O 4-201 for
\$50.00 together with duplicate well location plats.

Yours very truly,

Frank J. Fava, Jr., Manager
Lafayette District

FJF:jb

Enc.

MINERALS DIVISION
DEPARTMENT OF CONSERVATION
STATE OF LOUISIANA

WORK PERMIT

PERMIT TO Plug DATE May 20, 1948
PARISH St. Mary FIELD So. Jeanerette
COMPANY The Atlantic Refg. Co.
ADDRESS Box 2819 - Dallas, Texas
WELL NAME Adeline B-2 NO. 2 SEC. 37 T. 135R. 9E
WELL PERMIT SERIAL NO. 35497 WORK PERMIT NO. P.B.-15308
LOCATION 3833' N & 2642.7' E of SW Corner

YOU ARE HEREBY AUTHORIZED TO Plug back to approx. 3200
to test sands - 2 plugs set 50 sax - 7247-7147,
50 Sax 3426-3326.

PERMIT REQUESTED BY R. W. Coburn TD 8277

Company Representative

AUTHORIZED BY Frank J. Fava, Jr., Mgr.
Lafayette
District Office

MINERALS DIVISION
DEPARTMENT OF CONSERVATION
STATE OF LOUISIANA

WORK PERMIT

PERMIT TO Deepen DATE May 20, 1948
PARISH St. Mary FIELD Jeenerette
COMPANY Atlantic Refining Co.
ADDRESS Franklin, La.
WELL NAME Adeline Sugar Factory NO. B-2 SEC. 37 T. 133R 95
WELL PERMIT SERIAL NO. 35297 WORK PERMIT NO. 1459
LOCATION 3833.7' W & 2642.7' E of SW cor. of Sec. 37

YOU ARE HEREBY AUTHORIZED TO Deepen 8600'

PERMIT REQUESTED BY _____ TD _____

Company Representative

AUTHORIZED BY Frank J. Fava, Jr., Mgr.
Lafayette

District Office

MINERALS DIVISION
DEPARTMENT OF CONSERVATION
STATE OF LOUISIANA

- AFFIDAVIT OF TEST OF CASING IN WELL -

DATE WORK DONE May 21, 1948

WORK PERMIT NO. _____
WELL SERIAL NO. 19834

Lafayette, La.

(One copy to be filed with the District Office)

NOTE:

THIS REPORT WILL BE RETURNED IF NOT PROPERLY FILLED IN AND SIGNED

PARISH St. Mary FIELD S. Jeanerette SEC 37 TWP 38 RGE 9E

COMPANY The Atlantic Rfg. Co. LEASE Adeline Sugar "B" WELL NO. 2

TOTAL DEPTH 8276'

SIZE OF CASING 5 1/2 IN.: WT. PER FT. 15.5 #: MAKE National

NO. OF THREADS PER IN. 8 GRADE J-55 SEAMLESS NEW 2ND

IF SECOND HAND, WAS PIPE TESTED? _____ DESCRIBE _____

DEPTH LANDED BELOW DERRICK FLOOR 3290 FT. SACKS OF CEMENT 250

SIZE OF HOLE 9 7/8 IN.: AMOUNT OF CEMENT LEFT IN PIPE 30'

METHOD OF CEMENTING Halliburton CEMENT SET 24 HOURS UNDER 1100 LBS.

PRESSURE _____ TOTAL TIME SET 48 HOURS

DETAIL OF PRESSURE TEST BEFORE DRILLING PLUG

DATE OF TEST: 5-23-1948. GAUGE PRESSURE ON CASING 1000 LBS.

PRESSURE AT END OF THIRTY MINUTES (30) 1000# DROP 0 LBS.

TEST FLUID: WATER MUD _____ LBS. PER GAL: VISCOSITY _____ SEC.

REMARKS: _____

THIS WORK WAS DONE ACCORDING TO THE RULES AND REGULATIONS OF THE DEPARTMENT OF CONSERVATION, MINERALS DIVISION.

SIGNED: THE ATLANTIC REFINING COMPANY Conservation
COMPANY

WITNESS: _____

J. J. Cross
Representative
MAY 25 1948
Mineral Division

Form
Csg. (T)-MD16

MINERALS DIVISION
DEPARTMENT OF CONSERVATION
STATE OF LOUISIANA

- PLUG (PLUG-BACK) RECORD -

DATE WORK DONE 5-21-48 WORK PERMIT NO. PE L #308
WELL SERIAL NO. 35497

Lafayette, La.

NOTE: (One copy to be filed with the District Office)
THIS REPORT WILL BE RETURNED IF NOT PROPERLY FILLED IN AND SIGNED

PARISH St. Mary FIELD S. Jeanerette SEC 37 TWP 13S RGE 0E

COMPANY The Atlantic Refg. Co. LEASE Adeline "B" WELL NO. 2

TOTAL DEPTH 8277 NEW OR OLD WELL New

SIZE CASING 5 1/2 DEPTH OF CASING 3353

CEMENT RETAINER SET AT _____

DEPTH OF PLUG FROM 7147 TO 7247
3326 3426

NUMBER OF SACKS 50 NUMBER OF HOURS CEMENT SET 8

PURPOSE OF PLUG Plug back to test upper zone

PLUG JOB DONE BY Halliburton

METHOD OF PLACING CEMENT Displacement

BARRELS OF WATER BEFORE CEMENT 3 AFTER 5

RESULTS Top plug 3360

PLUG JOB DONE BY Halliburton

REMARKS: _____

THIS WORK WAS DONE ACCORDING TO THE RULES AND REGULATIONS OF THE DEPARTMENT OF CONSERVATION, MINERALS DIVISION.

SIGNED: THE ATLANTIC REFINING COMPANY
C O M P A N Y

Rev. C. C. Coker

Representative
Department of Conservation

Form
P.B. - MD6

MAY 28 1948
LAFAYETTE, LA.

State

MINERALS DIVISION
DEPARTMENT OF CONSERVATION
STATE OF LOUISIANA

-- AFFIDAVIT OF TEST OF CASING IN WELL --

DATE WORK DONE May 21, 1948 WORK PERMIT NO. _____
WELL SERIAL NO. 35497

Lafayette
(One copy to be filed with the District Office)

NOTE:
THIS REPORT WILL BE RETURNED IF NOT PROPERLY FILLED IN AND SIGNED

PARISH St. Mary FIELD So. Jeanerette SEC 37 TWP 13 RGE 9-E
COMPANY The Atlantic Refg. Co. LEASE Adeline "B" WELL NO. 2
TOTAL DEPTH 8277
SIZE OF CASING 5 1/2 IN.: WT. PER FT. 15.5 #: MAKE National
NO. OF THREADS PER IN. 8 GRADE J. SEAMLESS - NEW - 2ND
IF SECOND HAND, WAS PIPE TESTED? - DESCRIBE _____

DEPTH LANDED BELOW DERRICK FLOOR 3353 FT. SACKS OF CEMENT 200
SIZE OF HOLE 9-7/8 IN.: AMOUNT OF CEMENT LEFT IN PIPE 30
METHOD OF CEMENTING P&P CEMENT SET 24 HOURS UNDER 1000. LBS.
PRESSURE _____ TOTAL TIME SET 48 HOURS

DETAIL OF PRESSURE TEST BEFORE DRILLING PLUG

DATE OF TEST: 5-23-1948. GAUGE PRESSURE ON CASING 1000. LBS.
PRESSURE AT END OF THIRTY MINUTES (30) 1000. DROP 0 LBS.
TEST FLUID: WATER X MUD _____ LBS. PER GAL: VISCOSITY _____ SEC.

REMARKS: _____

THIS WORK WAS DONE ACCORDING TO THE RULES AND REGULATIONS OF THE DEPARTMENT OF CONSERVATION, MINERALS DIVISION.

SIGNED: THE ATLANTIC REFINING COMPANY
C O M P A N Y

WITNESS: _____

R. W. Coburn
R. W. COBURN
Representative
Mineral Division

Form
Csg. (T)-MDL6

JUN 2 1948
LAFAYETTE, LA.

Dept of Conservation

MINERALS DIVISION
DEPARTMENT OF CONSERVATION
STATE OF LOUISIANA

- PERFORATE AND SQUEEZE RECORD -

DATE WORK DONE 5-23-48 WORK PERMIT NO Perf. & Sq. #1183
WELL SERIAL NO. 35297

Lafayette
(One copy to be filed with the District Office)

NOTE: THIS REPORT WILL BE RETURNED IF NOT PROPERLY FILLED IN AND SIGNED

PARISH St. Mary FIELD So. Jeanerette SEC 37 TWP 13S RGE 9E

COMPANY The Atlantic Refining Co. LEASE Adeline "B" WELL NO. 2

TOTAL DEPTH 8277 NEW OR OLD WELL New

SIZE OF CASING 5 1/2 DEPTH OF CASING 3323

DEPTH OF PLUG BELOW PERFORATION 40'

PERFORATED FROM 3240 TO 3242

NUMBER OF HOLES 12 SIZE OF HOLES 1/2

PERFORATING COMPANY Lane Wells TRUCK NUMBER _____

METHOD OF PLACING CEMENT Yowell Tool & Baked Retainer- Displacement

WHERE CEMENT RETAINER SET: DEPTH 3216 FT.

BARRELS OF WATER PUMPED BEFORE CEMENT 10 AFTER 3

BREAKDOWN PRESSURE 400-0 LBS. FINAL PRESSURE 900 LBS.

PURPOSE OF SQUEEZE JOB Protect Zone to be tested above

SQUEEZE JOB DONE BY Haliburton, & Baker

REMARKS: 3 stages- # Final Stage used a Baker Model K retainer.

THIS WORK WAS DONE ACCORDING TO THE RULES AND REGULATIONS OF THE DEPARTMENT OF CONSERVATION, MINERALS DIVISION.

Department of Conservation
SIGNED: The Atlantic Refining Company
COMPANY
W. C. Baker JUN 10 1948
LAFAYETTE, LA.
Representative

MINERALS DIVISION
DEPARTMENT OF CONSERVATION
STATE OF LOUISIANA

WORK PERMIT

PERMIT TO Perforate & Squeeze DATE May 24, 1948
PARISH St. Mary FIELD So. Jeanerette
COMPANY The Atlantic Refg. Co.
ADDRESS Box 2819, Dallas, Texas
WELL NAME Adeline B-2 NO. 2 SEC. 37 T. 138 R. 9E
WELL PERMIT SERIAL NO. 35297 WORK PERMIT NO. Perf. & Sq. #1183
LOCATION 3833.7 N & 2642.7' E. of S.W. Corner.

YOU ARE HEREBY AUTHORIZED TO Perforate 3240-42 and squeeze
to protect zone to be tested.

PERMIT REQUESTED BY A. W. Coburn TD 8277'
Company Representative

AUTHORIZED BY Frank J. Pava, Jr., Mgr.
Lafayette
District Office

LANE-WELLS COMPANY

PERFORATING

Job # 21540

District New Iberia Operating Base New Iberia Number Jobs This Trip Two
 Truck No. Lib 169 Operator Y. Gaudin Sales Order No. 425224
 Customer Atlantic Rig Co. Ordered by M. C. Crows Date 5-24-48
 Mileage: From _____ to _____ Miles
 Mileage: From _____ to _____ Miles

PERFORATING INSTRUCTIONS—Given By M. C. Crows
 Name of Well Adeline Sugar Factory Co. No. B-2 Field South Jennerette
 State LA County/Parish St. Mary
 Bullet Size 1 1/2 Holes from _____ to _____ Ft. 10 Holes from 3242 to 3240 Ft. Holes from _____ to _____ Ft.
 Holes from _____ to _____ Ft. Shooting Zone Approved By M. C. Crows

PERMIT + VOUBRE | CONDITIONS OF THIS CONTRACT

TO LANE-WELLS COMPANY:
 You are hereby requested to furnish the service and materials and equipment herein set forth upon the following terms and conditions, to wit:
 The undersigned, as customer, agrees to pay you for the service and/or materials ordered hereunder at the office of Lane-Wells Company, in the City, County, and State from which the invoice originates. Should any account not be paid within the term fixed by the invoice, interest will be charged at the rate of six per cent per annum from the date of such invoice.
 In the event you employ an attorney to enforce any claim of indebtedness against the undersigned customer, said customer agrees to pay all costs of collection and reasonable attorneys' fees which, in no event, shall be less than the sum of \$75.00.
 Because of the uncertain and unknown conditions and the hazards existing in connection with the rendering of your field service, and because of physical conditions existing in an oil well which are not subject to your control, customer agrees that you do not guarantee the results of your service, and that you will not be held liable for injury to persons or property arising from any cause whatsoever in the performance of such field service by you.
 Should any of your instruments, tools, or equipment be lost or destroyed in the rendition of your service, customer agrees to use all reasonable diligence and facilities available to recover the same, and customer agrees to reimburse you for the reasonable value of any instruments, tools, or other personal property that cannot be recovered, or for the cost of repairing any damage to items recovered.
 Customer agrees that any service or services rendered by you hereafter shall be deemed to be rendered on the same terms and conditions as herein set forth.
 Customer agrees that all depth measurements shall be made by it or its employees, and shall be supervised by customer or its employees.
 Customer certifies that it is the owner of the well on which the work herein ordered is to be done; or that it has the full right and authority to order such work done on such well; and that the well in which the work is to be done by you is in proper and suitable condition for the performance of said work.
 Customer further agrees that the terms and conditions herein set forth constitute the entire agreement and that no employee of your company is authorized to alter the terms hereof.

Customer's Order No. _____ Customer Atlantic Rig Co. By J. S. Crouse

NO.	NO.	NO.	NO.	NO.	NO.	NO.
1.						
2.						
3.						
4.						
5.						
6.						
7.						
8.						
9.						
10.						
11.						
12.						
13.						
14.						
15.						
16.						
17.						
18.						
19.						
20.						
21.						
22.						
23.						
24.						
25.						

10 Holes 3240 to 3242

DEPARTMENT OF REVENUE
 MAY 26 1948
 LAFAYETTE, LA

Perforating Data

JOB SCHEDULED..... A.M. P.M. ARRIVED AT Location Landing..... A.M. P.M.

On Job..... A.M. P.M. M. Res. Off Job..... A.M. P.M. M. Res.

Standby Time..... Max. Temp. ° F

New or Old Well New Purpose of Perforating Sealing Kind of Fluid Full 48-35 Level Full

Casing Record 5 1/2" 15th Cemented In 978 Liner Record..... Cemented In.....

Customer's Depth 3267' Measure Method..... Zero Point.....

Lane-Well's Depth..... Size Gun..... No. Controller..... No.

RUNNING TIME	REMARKS
1) In From..... to..... A.M. P.M.	
Out From..... to..... A.M. P.M.	
Fluid.....	
In..... Out.....	
Holes..... Total.....	
2) In From..... to..... A.M. P.M.	
Out From..... to..... A.M. P.M.	
Fluid.....	
In..... Out.....	
Holes..... Total.....	
3) In From..... to..... A.M. P.M.	
Out From..... to..... A.M. P.M.	
Fluid.....	
In..... Out.....	
Holes..... Total.....	
4) In From..... to..... A.M. P.M.	
Out From..... to..... A.M. P.M.	
Fluid.....	
In..... Out.....	
Holes..... Total.....	
5) In From..... to..... A.M. P.M.	
Out From..... to..... A.M. P.M.	
Fluid.....	
In..... Out.....	
Holes..... Total.....	
6) In From..... to..... A.M. P.M.	
Out From..... to..... A.M. P.M.	
Fluid.....	
In..... Out.....	
Holes..... Total.....	
7) In From..... to..... A.M. P.M.	
Out From..... to..... A.M. P.M.	
Fluid.....	
In..... Out.....	
Holes..... Total.....	

MINERALS DIVISION
DEPARTMENT OF CONSERVATION
STATE OF LOUISIANA

WORK PERMIT

PERMIT TO Perforate DATE May 25, 1948
PARISH St. Mary FIELD So. Jeanerette
COMPANY The Atlantic Refg. Co.
ADDRESS Box 2819 - Dallas, Texas
WELL NAME Adeline B. NO. 2 SEC. 37 T. 13S R. 9E
WELL PERMIT SERIAL NO. 35297 WORK PERMIT NO. Perf.-143027
LOCATION 3893.7' N & 2642.7' E of S.W. Corner.

YOU ARE HEREBY AUTHORIZED TO Perforate 3210-12 for test.

TD 8277

PERMIT REQUESTED BY R. W. Coburn

Company Representative

AUTHORIZED BY Frank J. Fava, Jr., Mgr.

Lafayette
District Office

MINERALS DIVISION
DEPARTMENT OF CONSERVATION
STATE OF LOUISIANA

- PERFORATING RECORD -

DATE WORK DONE 5-25-48

WORK PERMIT NO. Perf. -I# 3027
WELL SERIAL NO. 35297

Lafayette

(One Copy to be filed with the District Office)

NOTE:

THIS REPORT WILL BE RETURNED IF NOT PROPERLY FILLED IN AND SIGNED

PARISH St. Mary FIELD So. Jeanerette SEC 37 TWP 13S RGE 9E
COMPANY The Atlantic Refining Co. LEASE Adeline "B" WELL NO. 2
TOTAL DEPTH 8277 NEW OR OLD WELL New
SIZE CASING 5 1/2 DEPTH OF CASING 3323
DEPTH OF PLUG BELOW PERFORATIONS 4'
PERFORATED FROM 3210 TO 3212
NUMBER OF HOLES 12 SIZE OF HOLES 1/2
PERFORATING COMPANY McCullough TRUCK NUMBER _____
PURPOSE OF PERFORATIONS Test for Production

REMARKS: _____

THIS WORK WAS DONE ACCORDING TO THE RULES AND REGULATIONS OF THE DEPARTMENT OF CONSERVATION, MINERALS DIVISION.

SIGNED: The Atlantic Refining Company ^{Department of Conservation}
COMPANY ^{Minerals Division}

W. C. Baker JUN 10 1948
Representative LAFAYETTE, LA.

Form
Perf -MD4

MINERALS DIVISION
DEPARTMENT OF CONSERVATION
STATE OF LOUISIANA

WORK PERMIT

PERMIT TO Perforate DATE May 26, 1948
PARISH St. Mary FIELD So. Jeanerette
COMPANY The Atlantic Refg. Co.
ADDRESS Box 2819, Dallas, Texas
WELL NAME Adeline B-2 NO. 2 SEC. 37T. 13S 9E
WELL PERMIT SERIAL NO. 35297 WORK PERMIT NO. Perf.-L#3026
LOCATION 3833.7'N & 2642.7'E of S.W. Corner

YOU ARE HEREBY AUTHORIZED TO Perforate 3212-3214 for test.

PERMIT REQUESTED BY E. W. Goburn

TD 8277'

Company Representative

AUTHORIZED BY Frank J. Fava, Jr., Mgr.
Lafayette

District Office

MINERALS DIVISION
DEPARTMENT OF CONSERVATION
STATE OF LOUISIANA

- PERFORATING RECORD -

DATE WORK DONE 5-26-48

WORK PERMIT NO Perf.-I# 3026
WELL SERIAL NO. 35297

Lafayette, La.

(One Copy to be filed with the District Office)

NOTE:

THIS REPORT WILL BE RETURNED IF NOT PROPERLY FILLED IN AND SIGNED

PARISH St. Mary FIELD S. Jeanerette SEC 37 TWP 13S RGE 9E

COMPANY The Atlantic Refining Co LEASE Adeline B" WELL NO. 2

TOTAL DEPTH 8277 NEW OR OLD WELL New

SIZE CASING 5 1/2" DEPTH OF CASING 3323

DEPTH OF PLUG BELOW PERFORATIONS 2'

PERFORATED FROM 3212 TO 3214

NUMBER OF HOLES 12 SIZE OF HOLES 1/2

PERFORATING COMPANY McCullough TRUCK NUMBER _____

PURPOSE OF PERFORATIONS Production Test

REMARKS: _____

THIS WORK WAS DONE ACCORDING TO THE RULES AND REGULATIONS OF THE DEPARTMENT OF CONSERVATION, MINERALS DIVISION.

SIGNED: The Atlantic Refining Company
COMPANY

McCullough
Representative

JUN 10 1948
LAFAYETTE, LA

Department of Conservation
Minerals Division

MINERALS DIVISION
DEPARTMENT OF CONSERVATION
STATE OF LOUISIANA

- PERFORATING RECORD -

DATE WORK DONE 5-26-48 WORK PERMIT NO. _____
WELL SERIAL NO. _____

(One Copy to be filed with the District Office)

NOTE:

THIS REPORT WILL BE RETURNED IF NOT PROPERLY FILLED IN AND SIGNED

PARISH S.T. MARY REEF ADLIN SEC _____ TWP _____ RGE _____
COMPANY ATLANTIC LEASE B WELL NO. 2
TOTAL DEPTH 3216 NEW OR OLD WELL NEW
SIZE CASING 5 1/2 DEPTH OF CASING 3216
DEPTH OF PLUG BELOW PERFORATIONS _____
PERFORATED FROM 3210 TO 3212
NUMBER OF HOLES 12 SIZE OF HOLES 1/2
PERFORATING COMPANY MC Cullough Tool Co TRUCK NUMBER 255
PURPOSE OF PERFORATIONS PRODUCTION
REMARKS: _____

THIS WORK WAS DONE ACCORDING TO THE RULES AND REGULATIONS OF THE DEPARTMENT OF CONSERVATION, MINERALS DIVISION.

SIGNED: MC Cullough Tool Co
COMPANY
C. L. [Signature]
Representative, Minerals Division
Department of Conservation

Form
Perf -MD4

JUN 29 1948
LAFAYETTE, LA

MINERALS DIVISION
DEPARTMENT OF CONSERVATION
STATE OF LOUISIANA

- PERFORATING RECORD -

DATE WORK DONE 5-27-48 WORK PERMIT NO. _____
WELL SERIAL NO. _____

(One Copy to be filed with the District Office)

NOTE:

THIS REPORT WILL BE RETURNED IF NOT PROPERLY FILLED IN AND SIGNED

PARISH ST. MARY FIELD ADLINE SEC _____ TWP _____ RGE _____
COMPANY ATLANTIC LEASE SUGAR FACTORY B WELL NO. 2
TOTAL DEPTH 3220 NEW OR OLD WELL old
SIZE CASING 5/2 DEPTH OF CASING 3220
DEPTH OF PLUG BELOW PERFORATIONS _____
PERFORATED FROM 3214 TO 3216
NUMBER OF HOLES 12 SIZE OF HOLES 1/2
PERFORATING COMPANY McCulloch Tool Co TRUCK NUMBER 304
PURPOSE OF PERFORATIONS PRODUCTION
REMARKS: _____

THIS WORK WAS DONE ACCORDING TO THE RULES AND REGULATIONS OF THE DEPARTMENT OF CONSERVATION, MINERALS DIVISION.

SIGNED: McCulloch Tool Co
COMPANY

C. L. L. L.
Representative, Department of Conservation
Mineral Division

Form
Perf -MD4

AUG 11 1948

LANE-WELLS COMPANY

PERFORATING

Number Jobs This Trip ONE

Sales Order No. 21366

District NEW IBERIA Operating Base NEW IBERIA Date 5-27-1945
 Job No. 140 Operator H.L. BERNARDY Parker PARKER Helper R.J. MIRANDA
 Customer ATLANTIC REFINING CO. Ordered by MR JACKS
 Lease: From _____ to _____ Miles
 Lease: From _____ to _____ Miles

PERFORATING INSTRUCTIONS—Given By: MR JACKS

Name of Well ADELING SUGAR FACTORY No. B-2 Field SOUTH JENNIFETTE
 State LA County/Parish S. MARY
 Bullet Size 26 Holes from 3220 to 3215 Ft. Holes from _____ to _____ Ft.
 Holes from _____ to _____ Ft. Shooting Zone Approved By J.H. Parker

CONDITIONS OF THIS CONTRACT

TO LANE-WELLS COMPANY: PERMIT VERRAL.
 You are hereby requested to furnish the service and materials and equipment herein set forth upon the following terms and conditions, to wit:
 The undersigned, as customer, agrees to pay you for the service and/or materials ordered hereunder at the office of Lane-Wells Company, in the City, County, and State from which the invoice originates. Should any account not be paid within the terms fixed by the invoice, interest will be charged at the rate of six per cent per annum from the date of such invoice.
 In the event you employ an attorney to enforce any claim of indebtedness against the undersigned customer, said customer agrees to pay all costs of collection and reasonable attorneys' fees which, in no event, shall be less than the sum of \$75.00.
 Because of the uncertain and unknown conditions and the hazards existing in connection with the rendering of your field service, and because of physical conditions existing in an oil well which are not subject to your control, customer agrees that you do not guarantee the results of your service, and that you will not be held liable for injury to persons or property arising from any cause whatsoever in the performance of such field service by you. Should any of your instruments, tools, or equipment be lost or destroyed in the rendition of your service, customer agrees to use all reasonable diligence and facilities available to recover the same, and customer agrees to reimburse you for the reasonable value of any instruments, tools, or other personal property that cannot be recovered, or for the cost of repairing any damage to items recovered.
 Customer agrees that any service or services rendered by you hereafter shall be deemed to be rendered on the same terms and conditions as herein set forth.
 Customer agrees that all depth measurements shall be made by it or its employees, and shall be supervised by customer or its employees.
 Customer certifies that it is the owner of the well on which the work herein ordered is to be done; or that it has the full right and authority to order such work done on such well; and that the well in which the work is to be done by you is in proper and suitable condition for the performance of said work.
 Customer further agrees that the terms and conditions herein set forth constitute the entire agreement and that no employee of your company is authorized to alter the terms hereof.

Customer's Order No. _____ Customer ATLANTIC REFINING CO By J.H. Parker

NO.	NO.	NO.	NO.	NO.	NO.	NO.
1.						
2.						
3.	26 Holes 3220 to 3215					
4.						
5.						
6.						
7.						
8.						
9.						
10.						
11.						
12.						
13.						
14.						
15.						
16.						
17.						
18.						Departure
19.						MINUTE
20.						JUN 1 1945
21.						LAFAYETTE, LA
22.						
23.						
24.						
25.						

Perforating Data

JOB SCHEDULED..... A.M. ARRIVED AT Location A.M.
 P.M. P.M. Landing..... P.M.

On Job _____ A.M. M. Res. Off Job _____ A.M. M. Res.
 P.M. P.M.

Standby Time _____ Max. Temp. _____ ° F

New or Old Well NEW Purpose of Perforating PRODUCTION Kind of Fluid Mud 9/5-1/2 35° Level FULL

Casing Record 5200. 15" Cemented In 985 Liner Record _____ Cemented In _____

Customer's Depth 3227 Measure Method _____ Zero Point _____

Lane-Wells Depth _____ Size Gun _____ No. _____ Controller _____ No. _____

RUNNING TIME	REMARKS
1) In From _____ to _____ A.M. P.M.	
Out From _____ to _____ A.M. P.M.	
Fluid _____	
In _____ Out _____	
Holes _____ Total _____	
2) In From _____ to _____ A.M. P.M.	
Out From _____ to _____ A.M. P.M.	
Fluid _____	
In _____ Out _____	
Holes _____ Total _____	
3) In From _____ to _____ A.M. P.M.	
Out From _____ to _____ A.M. P.M.	
Fluid _____	
In _____ Out _____	
Holes _____ Total _____	
4) In From _____ to _____ A.M. P.M.	
Out From _____ to _____ A.M. P.M.	
Fluid _____	
In _____ Out _____	
Holes _____ Total _____	
5) In From _____ to _____ A.M. P.M.	
Out From _____ to _____ A.M. P.M.	
Fluid _____	
In _____ Out _____	
Holes _____ Total _____	
6) In From _____ to _____ A.M. P.M.	
Out From _____ to _____ A.M. P.M.	
Fluid _____	
In _____ Out _____	
Holes _____ Total _____	
7) In From _____ to _____ A.M. P.M.	
Out From _____ to _____ A.M. P.M.	
Fluid _____	
In _____ Out _____	
Holes _____ Total _____	

MINERALS DIVISION
DEPARTMENT OF CONSERVATION
STATE OF LOUISIANA

- SQUEEZE JOB RECORD -

DATE WORK DONE 8-27-48 WORK PERMIT NO. Sq. L-707
WELL SERIAL NO. 35297

Lafayette

(One copy to be filed with the District Office)

N O T E:

THIS REPORT WILL BE RETURNED IF NOT PROPERLY FILLED IN AND SIGNED

PARISH St. Mary FIELD So. Jeannerette SEC. 37 TWP. 13 S RGE 9 E
COMPANY The Atlantic Refining LEASE Adeline B WELL NO. 2
TOTAL DEPTH 8277 NEW OR OLD WELL old
SIZE OF CASING 5 1/2 DEPTH OF CASING 3352
METHOD OF PLACING CEMENT Displacement Baker Retainer
WHERE CEMENT RETAINER WAS SET: DEPTH 3188 FT.
ZONE OF SQUEEZE FROM 3210 TO 3220
NUMBER OF SACKS USED 100 HOURS SET 8
BARRELS OF WATER PUMPED BEFORE CEMENT 5 AFTER 2
BREAKDOWN PRESSURE 600 FINAL PRESSURE 800
SQUEEZE JOB DONE BY Halliburton through Baker Model K retainer

REMARKS:

THIS WORK WAS DONE ACCORDING TO THE RULES AND REGULATIONS OF THE DEPARTMENT OF CONSERVATION, MINERALS DIVISION

SIGNED: THE ATLANTIC REFINING COMPANY
C O M P A N Y

Al Baker
REPRESENTATIVE
Department of Conservation
Mineral Division

Form
Sq. - MD12

SEP 2 1948

MINERALS DIVISION
DEPARTMENT OF CONSERVATION
STATE OF LOUISIANA

- PERFORATING RECORD -

DATE WORK DONE 5-28-48

WORK PERMIT NO. Perf.L-3029
WELL SERIAL NO. 35497

Lafayette

(One Copy to be filed with the District Office)

NOTE:

THIS REPORT WILL BE RETURNED IF NOT PROPERLY FILLED IN AND SIGNED

PARISH St. Mary FIELD So. Jeanerette SEC 37 TWP 13S RGE 9E
COMPANY The Atlantic Refining Co LEASE Adeline tract "B" WELL NO. 2
TOTAL DEPTH 8277 NEW OR OLD WELL New
SIZE CASING 5 1/2" DEPTH OF CASING 3323'
DEPTH OF PLUG BELOW PERFORATIONS 7'
PERFORATED FROM 3215' TO 3220'
NUMBER OF HOLES 30 SIZE OF HOLES 1/2
PERFORATING COMPANY Lane Wells TRUCK NUMBER _____
PURPOSE OF PERFORATIONS Production

REMARKS:

THIS WORK WAS DONE ACCORDING TO THE RULES AND REGULATIONS OF THE DEPARTMENT OF CONSERVATION, MINERALS DIVISION.

SIGNED: The Atlantic Refining Company

COMPANY
J. C. Casin
LAFAYETTE, LA
Representative

Department of Conservation

JUN 10 1948

Form
Perf -MD4

MINE
DEPARTMENT
STATE

DIVISION
CONSERVATION
LOUISIANA

WORK PERMIT

PERMIT TO Perforate DATE May 28, 1948
PARISH St. Mary FIELD So. Jennerette
COMPANY The Atlantic Refg. Co.
ADDRESS Box 2819 - Dallas, Texas
WELL NAME Adeline #2 NO. 2 SEC. 37 T. 138 R. 9E
WELL PERMIT SERIAL NO. 35497 WORK PERMIT NO. Perf.-L#3029
LOCATION 3833' W & 2642.7' E. of S.E. Corner.

YOU ARE HEREBY AUTHORIZED TO Perforate 3215-20 and test.

PERMIT REQUESTED BY A. W. Coburn TD 8277'
Company Representative

AUTHORIZED BY Frank J. Fava, Jr., Egr.
Lafayette
District Office

MINERALS DIVISION
DEPARTMENT OF CONSERVATION
STATE OF LOUISIANA

- PULL CASING RECORD -

DATE WORK DONE 8-29-48 WORK PERMIT NO. P.Csg.-L-362
WELL SERIAL NO. 35279

Lafayette

(One copy to be filed with the District Office)

N O T E:

THIS REPORT WILL BE RETURNED IF NOT PROPERLY FILLED IN AND SIGNED

PARISH St. Mary FIELD So. Jeanerette SEC 37 TRACT 9-B

COMPANY The Atlantic Refining LEASE Adaline B WELL NO. 2

TOTAL DEPTH 8277 NEW OR OLD WELL old

(1) PRODUCTION CASING (OIL STRING) SIZE 5 1/2 DEPTH 3352

(2) PROTECTION CASING (INTER-MEDIATE STRING) SIZE _____ DEPTH _____

(3) SURFACE CASING: SIZE 10 3/4 DEPTH 2085

MUD RECORD:- WEIGHT 10.5 VISCOSITY 45

- CASING PULLED -

(1) PRODUCTION CASING 2179 FT. CEMENT PLUG FROM 2281 TO 1952

(2) PROTECTION CASING _____ FT. CEMENT PLUG FROM _____ TO _____

(3) SURFACE CASING _____ FT. CEMENT PLUG FROM _____ TO _____

REMARKS: Cement plug placed in top of 5 1/2 and up in 10 3/4"

(Note: /See Section 17 -Paragraph C of Order 29)

THIS WORK WAS DONE ACCORDING TO THE RULES AND REGULATIONS OF THE DEPARTMENT OF CONSERVATION, MINERALS DIVISION.

SIGNED: THE ATLANTIC REFINING COMPANY
C O M P A N Y

R. L. Baker
Representative

Form
P.Csg - MD10

Department of Conservation
Mineral Division

SEP 2 1948

MINERALS DIVISION
DEPARTMENT OF CONSERVATION
STATE OF LOUISIANA

- PLUG AND PERFORATE RECORD -

DATE WORK DONE 8-29-48, 8-30-48 WORK PERMIT NO. P&Perf.L-132
WELL SERIAL NO. 35297

Lafayette

(One copy to be filed with the District Office)

N O T E:

THIS REPORT WILL BE RETURNED IF NOT PROPERLY FILLED IN AND SIGNED

PARISH St. Mary FIELD So. Jeanerette SEC 37 TWP 3 SRGD E

COMPANY The Atlantic Refining LEASE Adeline B WELL NO. 2

TOTAL DEPTH 8277 NEW OR OLD WELL old

SIZE OF CASING 5 1/2 DEPTH OF CASING 3352

CEMENT RETAINER SET AT _____

DEPTH OF PLUG FROM 1952 TO 2276

NUMBER OF SACKS 115 NUMBER OF HOURS CEMENT SET 8

PURPOSE OF PLUG Plug top at 5 1/2" and bottom at 10 3/4" after salvaging 5 1/2"

PLUG JOB DONE BY Mc Cullough

PERFORATED FROM _____ TO _____

NUMBER OF HOLES _____ SIZE OF HOLES _____

PERFORATING COMPANY _____ TRUCK NUMBER _____

REMARKS: _____

THIS WORK WAS DONE ACCORDING TO THE RULES AND REGULATIONS OF THE DEPARTMENT OF CONSERVATION, MINERALS DIVISION.

SIGNED: THE ATLANTIC REFINING COMPANY
C O M P A N Y

W. L. Cullough

Representative Department of Conservation
Mineral Division

SEP 2 1948

Perf - MD7

June 7, 1948

SERIAL NO. 35497

Mr. T. M. Winfield, Acting Chief Engineer
Minerals Division
Baton Rouge, Louisiana

Dear Mr. Winfield:

Enclosed herewith please find completion report filed by Atlantic Refining Company showing recent completion of their Adeline "B" #2 well, South Jeanerette Field, St. Mary Parish.

Same was completed as a gas well and shut in.

Yours very truly,

Frank J. Fava, Jr., Manager
Lafayette District

FJF:jb

Enc.

160

MINERALS DIVISION
DEPARTMENT OF CONSERVATION
STATE OF LOUISIANA
LAFAYETTE DISTRICT

WELL COMPLETION OR RECOMPLETION REPORT

OIL WELL ()	<p style="text-align: center;">NOTE</p> <p>One copy to be filed with District Office within three (3) days of date of completion or recompletion (as per Order No. 29-A, Section X, Paragraph A, Article 1.)</p>	COMPLETION (<input checked="" type="checkbox"/>)
DIS. WELL ()		RECOMPLETION ()
GAS WELL (<input checked="" type="checkbox"/>)		PERMIT SERIAL NO. <u>35497</u>

PARISH St. Mary FIELD So. Jeanerette SEC. 37 TWP. 13-S RING. 9-E
 COMPANY The Atlantic Refining Company Adeline "B" WELL NO. 2
 DRILLING CONTRACTOR Southern Six DATE SPUNDED (OR W.O.) 4-19-48
 DATE COMPLETED OR RECOMPLETED 5-30 19 48, AT 5:30 A.M. P.M.

COMPLETION DATA:

INITIAL PRODUCTION 0 BBL./DAY (NET)
 TUBING PRESSURE 1275 #/SQ. IN. GA. FLOWING () SHUT IN ()
 CASING PRESSURE 666 #/SQ. IN. GA.
 CHOKE SIZE 1/4 POSITIVE () ADJUSTABLE ()
 B. S. & W. --- PERCENT SALT WATER () WASH WATER ()
 GAS VOLUME 1000 MCF/DAY
 GAS/OIL RATIO --- CF/BBL.
 GRAVITY --- (60° A.P.I.)
 PRODUCING DEPTH 3210 FT. TO 3220 FT.
 PERFORATED YES () NO () BOTTOM TUBING 3204 FT. SIZE 2 IN.
 CASING (OIL STRING) SIZE 5 1/2 IN. I.D. () O.D. () BOTTOM SEAT --- FT.
 TOTAL DEPTH DRILLED 8277 FT. DERRICK FLOOR ELEVATION --- FT.

Additional clearance is requested for _____ barrels of oil produced on drill-stem or other production tests. (See Section X, Paragraph B, of Order No. 29-A on reverse side.)

THE ATLANTIC REFINING COMPANY

COMPANY

JUN 2 1948

L. R. A. COBURN
COMPANY REPRESENTATIVE

FORM - SDM - 1-R
(Over)

MINERALS DIVISION
DEPARTMENT OF CONSERVATION
STATE OF LOUISIANA

This side to be used when requesting clearance for oil produced on Drill Stem Test or other production tests; made previous to official completion or recompletion.

Section X, Paragraph B of Order No. 29-A

Allowables given to wells for oil produced on drill stem tests, production test and any miscellaneous production of oil shall be in accordance with the following rule:

All operators are required, within five days, to file three signed copies of the record of the daily production from the well, showing the number of hours the well produced and the interval of production; as "from 8:00 A.M., August 5th, to 3:00 P.M., August 8th, 1942."

DATE OF TEST	T E S T D A T A TIME OF TEST	AMOUNT OF OIL PRODUCED
_____ 19	_____ .M. TO _____ .M.	_____ BARRELS
_____ 19	_____ .M. TO _____ .M.	_____ BARRELS
_____ 19	_____ .M. TO _____ .M.	_____ BARRELS
_____ 19	_____ .M. TO _____ .M.	_____ BARRELS
_____ 19	_____ .M. TO _____ .M.	_____ BARRELS
_____ 19	_____ .M. TO _____ .M.	_____ BARRELS
_____ 19	_____ .M. TO _____ .M.	_____ BARRELS
_____ 19	_____ .M. TO _____ .M.	_____ BARRELS
_____ 19	_____ .M. TO _____ .M.	_____ BARRELS
_____ 19	_____ .M. TO _____ .M.	_____ BARRELS
_____ 19	_____ .M. TO _____ .M.	_____ BARRELS
TOTAL:		_____ BARRELS

The above total barrels of oil was produced from _____ Ft. to _____ Ft.

REMARKS:

_____ COMPANY

_____ COMPANY REPRESENTATIVE

#6830

#035932

STATE OF TEXAS
COUNTY OF DALLAS

I, W. J. Burkart, a qualified surveyor, regularly employed by the applicant, The Atlantic Refining Company of Dallas, Texas, as Chief Surveyor, hereby certify that

the location of The Atlantic Refining Company's Joseph A. Blanchard

Lease, Well No. 4 in South Jeannerette Field

St. Mary Parish, Louisiana is located as follows:

1600' N & 1995' E of SW Section Corner

Section 37 Township 13S Range 9E

W. J. Burkart CHIEF SURVEYOR
W. J. BURKART

Subscribed and sworn to before me this the 25th day of June 1948



E. L. Moore
E. L. MOORE, 706 Magnolia Building, Dallas, Texas
Notary Public in and for the State of Texas, Dallas County, Texas

MINERALS DIVISION
DEPARTMENT OF CONSERVATION
STATE OF LOUISIANA

WORK PERMIT

PERMIT TO Plug & Perforate DATE 8-26-48
PARISH St. Mary FIELD So. Jeanerette
COMPANY Atlantic Refg. Co.
ADDRESS Dallas, Texas
WELL NAME Adeline "B" NO. 2 SEC. 37 T. 13S R. 9E
WELL PERMIT SERIAL NO. 35297 WORK PERMIT NO. P. & Perf. I#192
LOCATION 3833.7' N & 2642.7' E of SE Sec. Corner.

YOU ARE HEREBY AUTHORIZED TO Plug back to approximately 1700'
and Perforate 1450 to 1600 w/1000 shots.

PERMIT REQUESTED BY R. W. Coburn TD 8277'
Company Representative

AUTHORIZED BY Frank J. Tava, Jr., Mgr.
Lafayette
District Office

MINERALS DIVISION
DEPARTMENT OF CONSERVATION
STATE OF LOUISIANA

WORK PERMIT

PERMIT TO Full Casing DATE 9-26-48
PARISH St. Mary FIELD So. Jeanette
COMPANY Atlantic Refg. Co.
ADDRESS Galien, Texas
WELL NAME Adelina #5* NO. 2 SEC. 37 T. 13R R. 9E
WELL PERMIT SERIAL NO. 95279 WORK PERMIT NO. P. Cas 14962
LOCATION 3833.7' N & 2642.7' E of SE Cor. Cor.

YOU ARE HEREBY AUTHORIZED TO Full approximately 2000' of 5 1/2
csg. Plug w/cst. in top of section left in hole.

PERMIT REQUESTED BY E. V. Coburn TD 8277*

Company Representative

AUTHORIZED BY Frank J. Fava, Jr., Mgr.
Jeanette

District Office

MINERALS DIVISION
DEPARTMENT OF CONSERVATION
STATE OF LOUISIANA

WORK PERMIT

PERMIT TO Squeeze DATE 8-26-48
PARISH St. Mary FIELD So. Jeanerette
COMPANY The Atlantic Refg. Co.
ADDRESS Dallas, Texas
WELL NAME Adeline "g" NO. 2 SEC. 37 T. 138 R. 92
WELL PERMIT SERIAL NO. 35297 WORK PERMIT NO. 59-14707
LOCATION 3893.7' N & 2642.7' E of SW Sec. Cor.

YOU ARE HEREBY AUTHORIZED TO Squeeze 320-20 thru Baker Non-
Retrievable Retainer.

PERMIT REQUESTED BY R. W. Coburn TD 8277*

Company Representative

AUTHORIZED BY Frank J. Fava, Jr., Jr., Mgr.
Lafayette

District Office

MINERALS DIVISION
DEPARTMENT OF CONSERVATION
STATE OF LOUISIANA

- PERFORATING RECORD -

DATE WORK DONE 8-30-48

WORK PERMIT NO. _____
WELL SERIAL NO. _____

(One Copy to be filed with the District Office)

NOTE:

THIS REPORT WILL BE RETURNED IF NOT PROPERLY FILLED IN AND SIGNED

PARISH ST. MARY FIELD ADELINE SEC _____ TWP _____ RGE _____
COMPANY ATLANTIC LEASE ADELINE WELL NO. B2
TOTAL DEPTH PLUG 1950 NEW OR OLD WELL old
SIZE CASING 10 3/4 DEPTH OF CASING 92.45
DEPTH OF PLUG BELOW PERFORATIONS 350 FT
PERFORATED FROM 1450 TO 1600
NUMBER OF HOLES 1000 SIZE OF HOLES 1/2
PERFORATING COMPANY McCullough Tool Co TRUCK NUMBER 387
PURPOSE OF PERFORATIONS S-W. D

REMARKS:

THIS WORK WAS DONE ACCORDING TO THE RULES AND REGULATIONS OF THE DEPARTMENT OF CONSERVATION, MINERALS DIVISION.

SIGNED: McCullough Tool Co
E. J. [Signature]
Representative 1948

Form
Perf -MD4

RECEIVED
I. F. CONSERVATION
MINERALS DIVISION
LOUISIANA

MINERALS DIVISION
DEPARTMENT OF CONSERVATION
STATE OF LOUISIANA

- AFFIDAVIT OF TEST OF CASING IN WELL -

DATE WORK DONE 4-23-48 WORK PERMIT NO. _____
WELL SERIAL NO. 35297

Lafayette, La.
(One copy to be filed with the District Office)

NOTE:

THIS REPORT WILL BE RETURNED IF NOT PROPERLY FILLED IN AND SIGNED

PARISH St. Mary FIELD South Jeanerette SEC 37 TWP 13 SRGE 9E

COMPANY The Atlantic Refining Co. LEASE Adeline Sugar Fact. Tract WELL NO. 2

TOTAL DEPTH 2110' "B"

SIZE OF CASING 10 3/4 IN.: WT. PER FT. 40.5 #: MAKE Nat'l

NO. OF THREADS PER IN. 8R GRADE H-40 SEAMLESS NEW 2ND

IF SECOND HAND, WAS PIPE TESTED? _____ DESCRIBE _____

DEPTH LANDED BELOW DERRICK FLOOR 2084 FT. SACKS OF CEMENT 800

SIZE OF HOLE 15 IN.: AMOUNT OF CEMENT LEFT IN PIPE 5 feet

METHOD OF CEMENTING Halliburton CEMENT SET 36 HOURS UNDER 800 LBS.

PRESSURE _____ TOTAL TIME SET 40 HOURS

DETAIL OF PRESSURE TEST BEFORE DRILLING PLUG

DATE OF TEST: 4-23- 1948. GAUGE PRESSURE ON CASING 1175 LBS.

PRESSURE AT END OF THIRTY MINUTES (30) 1175 DROP None LBS.

TEST FLUID: WATER MUD _____ LBS. PER GAL: VISCOSITY _____ SEC.

REMARKS: _____

THIS WORK WAS DONE ACCORDING TO THE RULES AND REGULATIONS OF THE DEPARTMENT OF CONSERVATION, MINERALS DIVISION.

SIGNED: THE ATLANTIC REFINING COMPANY

WITNESS: _____

COMPANY REPRESENTATIVE

H. C. Sanders
Representative

APR 26 1948

LAFAYETTE, LA.

Work Permit

STATE OF LOUISIANA DEPARTMENT OF CONSERVATION

Well Name & No. Adeline Sugar Factory B-2 SWD Sec. 37 T 13S R 9E

Field Jeanerette Parish St. Mary

Permit Serial No. 35497 035297 Work Permit No. 2771284, 1981

Description of Work Set 150' cement plug above perfs 1450-1600. Set 30' cement plug at surface. Cut off casing below ground level and weld on plate to P&A. No casing to be salvaged.

Sand & Reservoir To Be Tested N/A TD 8297'

Operator ARCO ~~Oil and Gas Company~~ ^{O & G Co Div. Gulf Rich Co}

Address P. O. Box 51408

City, State & Zip Lafayette, Louisiana 70505

Permit Requested By *R. M. Whaley* Date 12/23/81
R. M. Whaley

Permit Authorized By *R. M. Whaley* District Lafayette Date 12-28-81

See Instructions On Reverse Side

Form DM-4R Rev.

STATE OF LOUISIANA
OFFICE OF CONSERVATION
PLUG AND ABANDON REPORT

WORK PERMIT NO. L# 1284, 1981

WELL SERIAL NO. 035297

DATE WORK FINISHED (MM-DD-YY) 01/26/82

Lafayette DISTRICT
(Three Copies to be Filed with the District Office)

NOTE: This Report Will Be Returned If Not Properly Completed And Signed.

Field Teanette Parish St. Mary Sec. 37 Twp. 135 Rge. 9E

Operator Arco Oil & Gas Co. - Div. of Atl. Rich CODE
0295 Well Name Abeline Super Factory Co. "B" Well No. 2 SWD

Total Depth 297 Condition of Well _____

CHECK APPROPRIATE BOX:

- 29 DRY HOLE
 30 FORMERLY PRODUCTIVE WELL

	CASING SIZE	AMOUNT PULLED	CEMENT PLUGS			
			FROM	TO	SACKS	HOW PLACED
301	<u>10 3/4"</u>	<u>NONE</u>	<u>8'</u>	<u>110'</u>	<u>50</u>	<u>GRAPEO</u>
302						
303						
304						

Mud Record: Weight _____ Viscosity _____

Remarks: _____

This work was done according to the Rules and Regulations of the Office of Conservation.

WITNESS

ARCO OIL & GAS Co.
OPERATOR

(Signed) J. A. Hughes
REPRESENTATIVE