

R 9 E

THE ATLANTIC REFINING COMPANY  
P. O. Box 1408 - OCS  
Lafayette, Louisiana

APPLICATION FOR PERMIT TO DRILL:  
Adeline Sugar Factory Company No. 15

**CONFIDENTIAL**

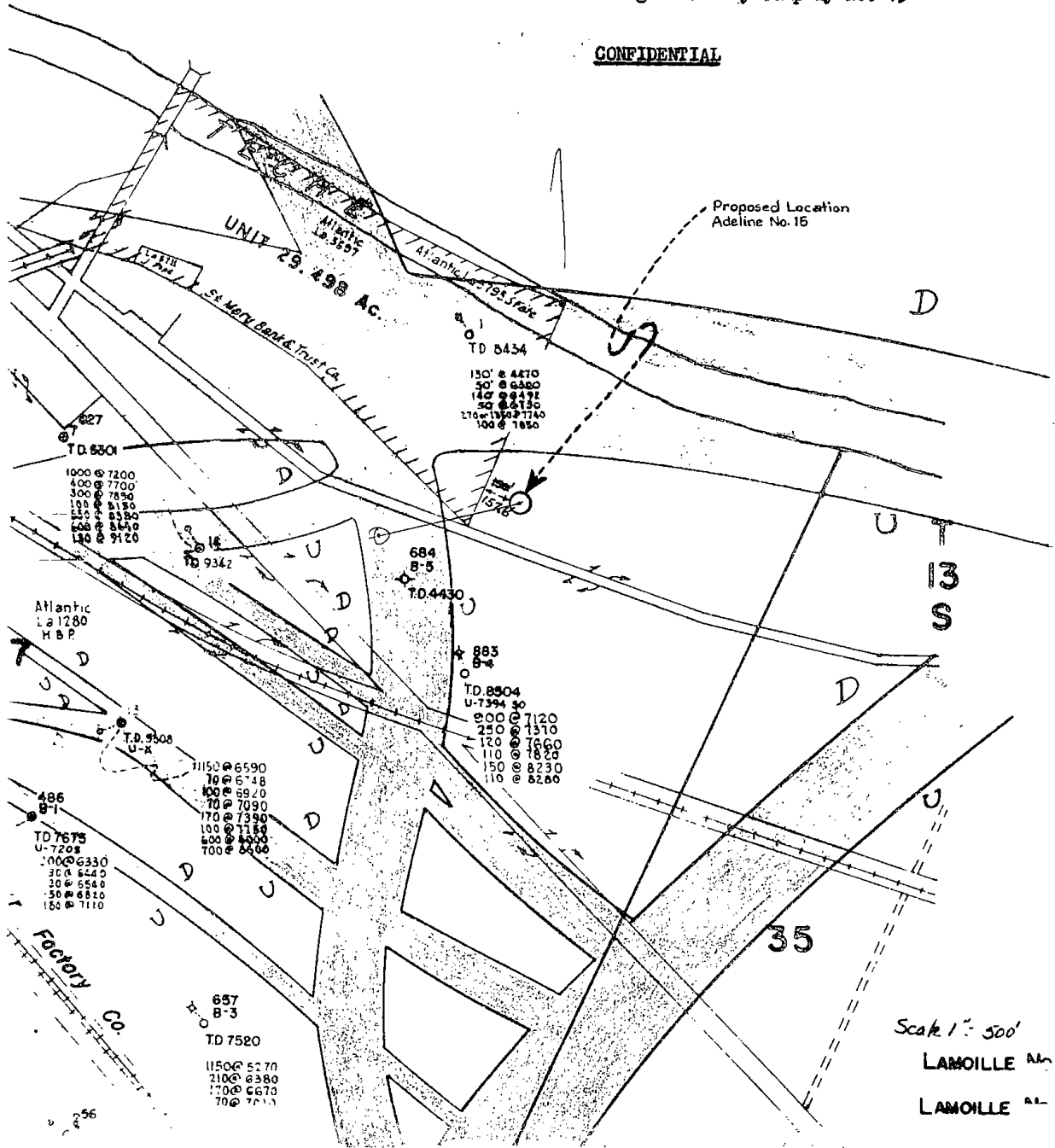

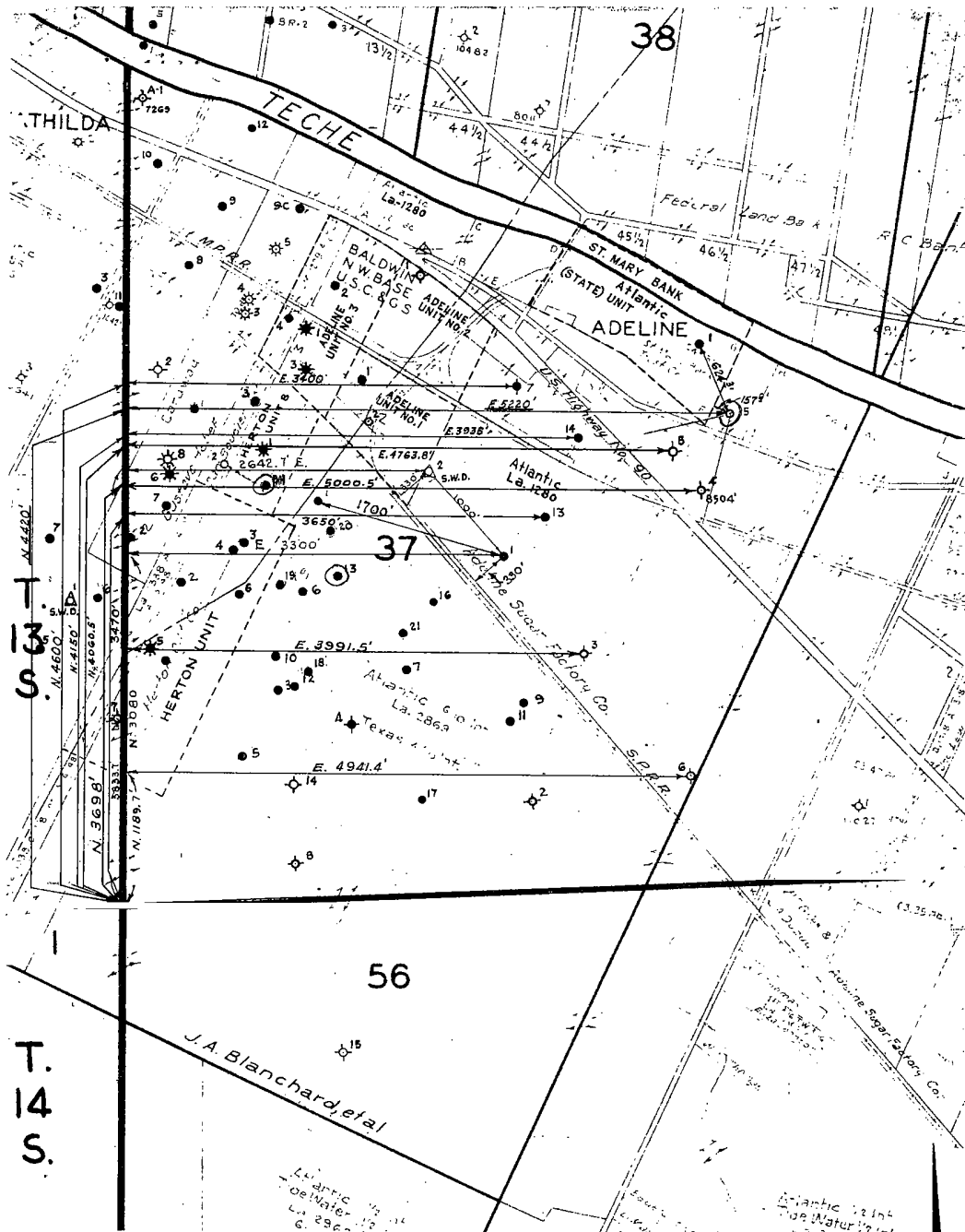

T. 13 S.

R. 9 E.

Operator THE ATLANTIC REFINING COMPANY  
 Lease ADELINE SUGAR FACTORY COMPANY  
 Field JEANERETTE  
 Description Section 37, T. 13 S., R. 9 E., St. Mary Parish, La.  
 Date Plat Drawn Nov. 15, 1946.



La-1280

Scale: 1" = 1000'

#067503

THE ATLANTIC REFINING CO.  
 SURVEYING DEPT.  
 DALLAS, TEXAS.

Sur. DPOB  
 Dwn. RAW

Approved: *W. J. Burkert*

Date: 11-15-46  
 Rev. 8-16-37  
 A-941



THE ATLANTIC REFINING COMPANY  
INCORPORATED 1870  
PETROLEUM PRODUCTS

August 19, 1957

DOMESTIC PRODUCING DEPARTMENT  
SOUTH LOUISIANA REGION  
WM. B. MOORE, MANAGER  
WM. C. ALLBRIGHT, JR., LAND MANAGER  
D. E. BOOTH, OPERATIONS MANAGER  
B. M. CHOATE, EXPLORATION MANAGER  
C. A. KINNEY, DRILLING MANAGER

MAILING ADDRESS  
P. O. BOX 1408  
OIL CENTER STATION  
LAFAYETTE, LOUISIANA

Mr. Frank J. Fava, Dist. Mgr.  
Department of Conservation  
Minerals Division  
Oil Center Station  
Lafayette, Louisiana

Dear Mr. Fava:

Attached you will find an application for permit to drill our Adeline Sugar Factory Company Well No. 15 at the following location:

From the southwest corner of Section 37, T-13-S, R-9-E, go north along section line 4420' thence east at right angles 5220' to location in Section 37, Jeanerette Field, St. Mary Parish, La.

You will note from the lease plat that this location lies a distance of 157.6' from the St. Mary Bank State Unit lease line which is not in conformance with Paragraph 2 of Statewide Order No. 29-E.

We ask your approval of the permit for the drilling of this well based on Paragraph 3 of the exceptions to Statewide Order No. 29-E.

In addition to the lease plat you will find a plat which depicts the faulting in the area of the Adeline Sugar Factory Company No. 15 upon which we base this request.

The objective in the Adeline Sugar Factory Company No. 15 is the "U" Sand. The St. Mary Bank State Unit Well No. 1 is producing from the "T" Sand. The Herton Unit 'B' Well No. 2 and J. A. Blanchard Well No. 13 are both producing from the "U" Sand and are 4100' and 3700' respectively from the Adeline Sugar Factory Company No. 15 well.

Yours very truly,

THE ATLANTIC REFINING COMPANY

C. A. Kinney, Drilling Manager  
South Louisiana Region

CAK:rr  
enclosures

August 20, 1957

Mr. T. M. Winfield, Chief Engineer  
Minerals Division  
Baton Rouge, Louisiana

Dear Mr. Winfield:

Enclosed herewith please find application from The Atlantic Refining Company for permit to drill their Adeline Sugar Factory Company No. 15, Jeanerette Field, St. Mary Parish.

Enclosed also is check No. 6000 for \$50.00 together with well location plat.

It appears to me from the plat showing the structure surrounding this proposed location that this reservoir could be classified as a complex faulted reservoir and it is my opinion that Atlantic should be granted this permit.

Atlantic has requested that we keep the plat showing structure confidential.

Yours very truly,

Frank J. Fava, Jr., Manager  
Lafayette District

FJF:ml

Encls.

1971

Dear Mr. [Name],

I am writing to you regarding the [Project Name] which is currently in progress. The [Project Name] is a [Project Description] and is being conducted by [Organization Name].

The [Project Name] is a [Project Description] and is being conducted by [Organization Name]. The [Project Name] is a [Project Description] and is being conducted by [Organization Name].

I am writing to you regarding the [Project Name] which is currently in progress. The [Project Name] is a [Project Description] and is being conducted by [Organization Name].

The [Project Name] is a [Project Description] and is being conducted by [Organization Name]. The [Project Name] is a [Project Description] and is being conducted by [Organization Name].

I am writing to you regarding the [Project Name] which is currently in progress. The [Project Name] is a [Project Description] and is being conducted by [Organization Name].

The [Project Name] is a [Project Description] and is being conducted by [Organization Name]. The [Project Name] is a [Project Description] and is being conducted by [Organization Name].

Yours very truly,

[Name]  
[Title]

1971

[Name]

August 20, 1957

Mr. F. A. Bankston, District Production Engineer  
Union Oil Company of California  
800 Prudential Building  
Houston 25, Texas

Dear Mr. Bankston:

Enclosed herewith please find copy of amendment to Order No. 29-D. This amendment requires that 100 per cent agreement of all parties having interest, in well to be assigned, be obtained.

Yours very truly,

Frank J. Fava, Jr., Manager  
Lafayette District

FJF:ml

Encl.

CONFIDENTIAL

CONFIDENTIAL - SECURITY INFORMATION  
This document contains information that is exempt from release under the Freedom of Information Act, 5 U.S.C. 552, because its disclosure could be injurious to the national defense.

CONFIDENTIAL - SECURITY INFORMATION  
This document contains information that is exempt from release under the Freedom of Information Act, 5 U.S.C. 552, because its disclosure could be injurious to the national defense.

Very truly yours,

John Edgar Hoover  
Director

CONFIDENTIAL

CONFIDENTIAL

52074

DISTRICT OFFICE COPY  
DEPARTMENT OF CONSERVATION

\$50.00

PERMIT TO DRILL FOR MINERALS

BATON ROUGE, LA., August 1957, 19 57

PARISH Orleans FIELD Bayou Lafourche  
OPERATOR John A. ...  
ADDRESS ...  
LOCATION OF WELL ...  
Sec. 25, T. 27N, R. 6E

You are hereby authorized to drill ...  
Well No. 75, referred to under application bearing serial No. ...  
dated ..., 1957, signed by ...

This well to be drilled to ... zone on surface area of ... acres

DRILLING CONTRACTOR ...

*John B. ...*  
Commissioner, Department of Conservation

STATE OF LOUISIANA  
DEPARTMENT OF CONSERVATION

Chief Engineer, Division of Mineral Resources

DEPARTMENT OF CONSERVATION

August 23, 1957

The Atlantic Refining Company  
Box 1408, Oil Center Station  
Lafayette, Louisiana

Gentlemen:

Your application for permit to drill your Adeline Sugar Factory Company Well No.15, located in Section 37, Township 13 South, Range 9 East, Jeanerette Field, St. Mary Parish, Louisiana, has been approved this day.

We wish to advise that since the location of the proposed well is less than 300 feet from the lease line, it will be necessary for you to file with the District Office three (3) copies of a directional survey of this well to the total depth upon completion before an allowable can be assigned to it, said copies to be certified by a duly authorized representative of the company doing the work.

Yours very truly,

JOHN B. HUSSEY, Commissioner  
Department of Conservation

By J. W. Hecker  
J. W. Hecker  
Petroleum Engineer

awt

cc: Mr. Frank J. Fava, Jr.  
Lafayette District Manager

RECEIVED

AUG 26 1957

DEPARTMENT OF CONSERVATION  
MINERALS DIVISION  
LAFAYETTE, LOUISIANA

DEPARTMENT OF CONSERVATION  
STATE OF LOUISIANA

AFFIDAVIT OF TEST OF CASING IN WELL

DATE WORK DONE 9-18-57

WORK PERMIT NO. 52074  
WELL SERIAL NO. 67503

Lafayette, La.  
(One copy to be filed with the District Office)

NOTE:

THIS REPORT WILL BE RETURNED IF NOT PROPERLY FILLED IN AND SIGNED

PARISH St. Mary FIELD Jeanerette SEC 37 TWP 13S RGE 9E

COMPANY The Atlantic Refining Co. LEASE ADELINE SUGAR FACTORY WELL NO. 15  
CO.

TOTAL DEPTH 1032

SIZE OF CASING 9-5/8" IN.: FT. PER FT. 40# #MAKE -

NO. OF THREADS PER IN. 8R GRADE N-80 SEAMLESS NEW 2ND X

IF SECOND HAND, WAS PIPE TESTED No DESCRIBE \_\_\_\_\_

DEPTH LANDED BELOW DERRICK FLOOR 998.05 FT. SACKS OF CEMENT 700

SIZE OF HOLE 13-3/4 IN.: AMOUNT OF CEMENT LEFT IN PIPE 30'

METHOD OF CEMENTING Halliburton CEMENT SET 12 HOURS UNDER 500 LBS.

PRESSURE \_\_\_\_\_ TOTAL TIME SET 24 HOURS

DETAIL OF PRESSURE TEST BEFORE DRILLING PLUG

DATE OF TEST: 9-19 19. 57 . GAUGE PRESSURE ON CASING 1150 LBS.

PRESSURE AT END OF 30 MINUTES 1150 DROP Zero LBS.

TEST FLUID: WATER \_\_\_\_\_ MUD 9.6 LBS. PER GAS: VISCOSITY 38 SEC.

REMARKS: \_\_\_\_\_

THIS WORK WAS DONE ACCORDING TO THE RULES AND REGULATIONS OF THE DEPARTMENT OF CONSERVATION, MINERALS DIVISION.

SIGNED THE ATLANTIC REFINING COMPANY

COMP.

WITNESS: \_\_\_\_\_

Form; Csg. (T)-MD16

S.E.W.  
L. E. Wilson REPRESENTATIVE  
Dist. Drlg. Supr  
9-20-57



UNITED STATES DEPARTMENT OF JUSTICE  
FEDERAL BUREAU OF INVESTIGATION

MEMORANDUM FOR THE DIRECTOR

DATE: 10/15/54

TO: SAC, NEW YORK (100-100000)

FROM: SAC, NEW YORK (100-100000)

SUBJECT: [Illegible]

[The body of the memorandum contains several paragraphs of text that are extremely faint and illegible due to the quality of the scan. The text appears to be a standard report format with multiple lines of information.]

[The bottom section of the memorandum contains a signature line and possibly a date, which are also illegible.]



MINERALS DIVISION  
DEPARTMENT OF CONSERVATION  
STATE OF LOUISIANA

WORK PERMIT

PERMIT TO Plugback & Sidetrack DATE 10-1-57  
PARISH St. Mary FIELD Jeanerette  
COMPANY The Atlantic Refg. Co.  
ADDRESS P OBox 602 Lafayette, La.  
WELL NAME Adeline Sugar Fcty. Co. No. 15 SEC. 37 T. 13S R. 9E  
WELL PERMIT SERIAL No. 67503 WORK PERMIT No. Pb.S.L.#37  
LOCATION \_\_\_\_\_

YOU ARE HEREBY AUTHORIZED TO Set plug from 4998-4800  
and sidetrack to a point 575' S 76° 30' W of surface  
location at a TVD of 7250 thence drill to a TD of  
8100' TVD TD 8300'

PERMIT REQUESTED BY L. E. Wilson  
Company Representative

AUTHORIZED BY \_\_\_\_\_

Lafayette  
District Office

DEPARTMENT OF CONSERVATION  
STATE OF LOUISIANA

-PLUG BACK AND SIDE-TRACK RECORD -

DATE WORK DONE 10-12-57 WORK PERMIT NO. Fb.S.I.#37  
WORK SERIAL NO. 67503

Lafayette, La.

(One copy to be filed with the District Office)

N O T E:

THIS REPORT WILL BE RETURNED IF NOT PROPERLY FILLED IN AND SIGNED

PARISH St. Mary FIELD Jeanerette SEC 37 TWP 13S RGE 9E

COMPANY The Atlantic Refining Co. LEASE Adeline Sugar Fctry Co. WELL NO. 15

TOTAL DEPTH 8214 NEW OR OLD WELL New

SIZE OF CASING 9-5/8" DEPTH OF CASING 998

CEMENT RETAINER SET AT -

DEPTH OF PLUG FROM 4998 TO 4800

NUMBER OF SACKS 100 NUMBER OF HOURS CEMENT SET 24

PURPOSE OF PLUG To sidetrack

PLUG JOB DONE BY Halliburton

DEPTH WHIPSTOCK SET (IF USED) 4870

WINDOW CUT IN CASING FROM - TO -

WHERE SIDETRACK (IF NOT THRU CASING) 4870

DEGREES OFF VERTICAL BEFORE SIDETRACKING 1° AFTER 13°

REMARKS: 670.58' S 77.5° W of surface location. Copies of directional

survey will be forwarded at a later date.

(Note: see section 16 - Order 29)

THIS WORK WAS DONE ACCORDING TO THE RULES AND REGULATIONS OF THE DEPARTMENT OF CONSERVATION.

SIGNED: THE ATLANTIC REFINING COMPANY

COMPANY

Charles A. Evans  
C.C. Evans Representative  
Dist. Drlg. Supr.  
10-17-57

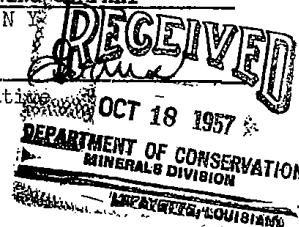

Form  
P.B. & S.-MDS

MINERALS DIVISION  
DEPARTMENT OF CONSERVATION  
STATE OF LOUISIANA

- PLUG (PLUG-BACK) RECORD -

DATE WORK DONE 10-15-57

WORK PERMIT NO. \_\_\_\_\_  
WELL SERIAL NO. 67503

Lafayette, La.  
(One copy to be filed with the District Office)

**N O T E:**

THIS REPORT WILL BE RETURNED IF NOT PROPERLY FILLED IN AND SIGNED

PARISH St. Mary FIELD Jeanerette SEC 37 TWP 13S R. 9E

COMPANY The Atlantic Refining Co. LEASE Adeline Sugar Fctry Co. WELL NO. 15

TOTAL DEPTH 8214 NEW OR OLD WELL New

SIZE CASING 9-5/8" DEPTH OF CASING 998

CEMENT RETAINER SET AT -

DEPTH OF PLUG FROM 7850 TO 7699

NUMBER OF SACKS 100 NUMBER OF HOURS CEMENT SET -

PURPOSE OF PLUG To abandon lower portion of hole

PLUG JOB DONE BY Halliburton

METHOD OF PLACING CEMENT Displacement

BARRELS OF WATER BEFORE CEMENT 5 AFTER 1

RESULTS Satisfactory

PLUG JOB DONE BY Halliburton

REMARKS: Calculated top of cement 7650, actual top 7699\*

THIS WORK WAS DONE ACCORDING TO THE RULES AND REGULATIONS OF THE DEPARTMENT OF CONSERVATION, MINERALS DIVISION.

SIGNED: THE ATLANTIC REFINING COMPANY

C.C. Evans Representative  
Dist. Drlg. Supr.  
10-17-57

**RECEIVED**  
OCT 18 1957  
DEPARTMENT OF CONSERVATION  
MINERALS DIVISION  
LAFAYETTE, LOUISIANA

# DIRECTIONAL DRILLING

67583 #

DATE 10-16-57

COMPANY THE ATLANTIC REFINING COMPANY

WELL ADELINE SUGAR FACTORY CO. #15

FIELD JEANERETTE FIELD,

LOCATION \_\_\_\_\_

COUNTY ST. MARY PARISH,

STATE LOUISIANA

MAGNETIC DECLINATION \_\_\_\_\_



## HOUSTON OIL FIELD MATERIAL COMPANY, INC.

### DIRECTIONAL DRILLING

COMPANY: THE ATLANTIC REFINING COMPANY

DATE: 10-16-57

WELL NO.: ADELINE SUGAR FACTORY CO.#15 LOCATION: JEANERETTE FIELD,  
ST. MARY PARISH, LOUISIANA

PAGE: 1 OF 3

	MEASURED DEPTH	COURSE LENGTH	DRIFT ANGLE	TRUE VERTICAL DEPTH	COURSE DEVIATION	DIRECTION OF DEVIATION	TOTAL COORDINATES			
							NORTH	SOUTH	EAST	WEST
	4800			4799.52	PREVIOUS SURVEY			13.09	21.97	
	4870	70	1°00'	4869.51	1.22	S 56 E		13.77	22.98	
	4885	15	5 00	4884.45	1.31	N 39 W		12.75	22.15	
	4902	17	5 00	4901.39	1.48	N 36 W		11.55	21.28	
	4926	24	6 30	4925.24	2.72	N 44 W		9.59	19.39	
	4953	27	6 30	4952.07	3.06	N 31 W		6.97	17.81	
	4971	18	6 00	4969.97	1.88	N 77 W		6.55	15.98	
	4992	21	6 15	4990.85	2.29	N 85 W		6.35	13.70	
	5047	55	7 00	5045.44	6.70	West		6.35	7.00	
	5114	67	7 45	5111.83	9.04	N 83 W		5.25		1.97
	5173	59	8 45	5170.14	8.98	N 83 W		4.16		10.88
	5235	62	8 45	5231.42	9.43	N 82 W		2.85		20.22
	5265	30	9 15	5261.03	4.82	N 83 W		2.26		25.00
	5295	30	9 30	5290.62	4.95	N 82 W		1.57		29.90
	5359	64	10 00	5353.65	11.11	N 80 W	.36			40.84
	5412	53	10 15	5405.80	9.43	N 79 W	2.16			50.09
	5425	13	10 15	5418.59	2.31	S 88 W	2.08			52.40
	5450	25	10 15	5443.19	4.45	S 87 W	1.85			56.84
	5506	56	10 30	5498.25	10.21	S 80 W	.07			66.90
	5604	98	13 30	5593.54	22.88	S 84 W		2.32		89.66
	5696	92	15 45	5682.09	24.97	S 84 W		4.93		114.49

Continued on page 2

## HOUSTON OIL FIELD MATERIAL COMPANY, INC.

### DIRECTIONAL DRILLING

COMPANY: THE ATLANTIC REFINING COMPANY

WELL NO.: ADELIN SUGAR FACTORY CO. #15

LOCATION: JEANERETTE FIELD,  
ST. MARY PARISH, LOUISIANA.

DATE: 10-16-57

PAGE: 2 OF 3

	MEASURED DEPTH	COURSE LENGTH	DRIFT ANGLE	TRUE VERTICAL DEPTH	COURSE DEVIATION	DIRECTION OF DEVIATION	TOTAL COORDINATES			
							NORTH	SOUTH	EAST	WEST
	5790	94	17°00'	5771.98	27.48	S 84 W		7.80		141.82
	5886	96	16 30	5864.03	27.27	S 87 W		9.22		169.05
	5978	92	16 30	5952.24	26.13	S 89 W		9.67		195.18
	6096	118	16 00	6065.67	32.52	West		9.67		227.70
	6127	31	15 30	6095.54	8.28	S 77 W		11.53		235.76
	6162	35	15 00	6129.35	9.06	S 75 W		13.88		244.51
	6197	35	14 45	6163.20	8.91	S 75 W		16.19		253.12
	6255	58	16 00	6218.95	15.99	S 75 W		20.33		268.57
	6347	92	17 30	6306.69	27.66	S 73 W		28.41		295.02
	6410	63	18 45	6366.35	20.25	S 77 W		32.97		314.75
	6471	61	18 15	6424.28	19.10	S 78 W		36.94		333.43
	6539	68	18 30	6488.77	21.58	S 75 W		42.53		354.27
	6620	81	18 15	6565.70	25.37	S 76 W		48.67		378.89
	6650	30	18 15	6534.19	9.39	S 75 W		51.10		387.96
	6742	92	16 45	6682.29	26.51	S 74 W		58.41		413.44
	6828	86	16 00	6764.96	23.70	S 72 W		65.74		435.98
	6925	97	15 45	6858.32	26.33	S 72 W		73.87		461.02
	7016	91	15 30	6946.01	24.32	S 71 W		81.78		484.01
	7110	94	16 00	7036.37	25.91	S 70 W		90.04		508.36
	7202	92	15 45	7124.92	24.97	S 68 W		99.99		531.51

Continued on page 3

## HOUSTON OIL FIELD MATERIAL COMPANY, INC.

### DIRECTIONAL DRILLING

COMPANY: THE ATLANTIC REFINING COMPANY,

WELL NO.: ADELINE SUGAR FACTORY CO.#15 LOCATION: JEANERETTE FIELD,  
ST. MARY PARISH, LOUISIANA

DATE: 10-16-157

PAGE: 3 OF 3

	MEASURED DEPTH	COURSE LENGTH	DRIFT ANGLE	TRUE VERTICAL DEPTH	COURSE DEVIATION	DIRECTION OF DEVIATION	TOTAL COORDINATES			
							NORTH	SOUTH	EAST	WEST
	7330	128	14°00'	7249.12	30.96	S 69 W		111.08		560.42
	7569	239	10 30	7484.13	43.55	S 68 W		127.40		600.80
	7933	364	6.00	7846.13	38.04	S 67 W		142.27		635.82
	8210	277	4:00	8122.46	19.33	S 67 W		149.82		653.61
<p><b>CLOSURE:</b> Direction----S 77° 05' W Distance-----670.58'</p> <p><b>HOMCO OPERATOR:</b> D. R. Adkins</p> <p>We certify that to the best of our knowledge and ability this is a true and correct report and that it affords a true and correct representation of the nature and conditions of the well at the time the survey was made.</p>										
<p><i>D. R. Adkins</i></p> <hr/> <p>Houston Oil Field Material Company, Inc. Directional Drilling &amp; Well Survey</p>							<p>Subscribed and sworn to before me this <u>17<sup>th</sup></u> day of <u>October</u> A. D. 1957, at Houston, Harris County, Texas.</p> <p><i>Dated Simpson Jr.</i></p> <hr/> <p>DATE: H. SIMPSON, JR. Notary Public, in and for Harris County, Texas My Commission Expires June 1, 1959</p>			

MINERALS DIVISION  
DEPARTMENT OF CONSERVATION  
STATE OF LOUISIANA

WORK PERMIT

PERMIT TO Plugback DATE 10-17-57  
PARISH St. Mary FIELD Jeanerette  
COMPANY The Atlantic Refg. Co.  
ADDRESS P O Box 602 Lafayette, La.  
WELL NAME Adeline Sugar Fcty. Co. No. 15 SEC. 37 T. 13S 9E  
WELL PERMIT SERIAL No. 67503 WORK PERMIT No. Plug.L#110  
LOCATION \_\_\_\_\_

YOU ARE HEREBY AUTHORIZED TO Set plug from 7850-7650 with 100  
sx cmt to abandon lower portion of hole.

PERMIT REQUESTED BY L. E. Wilson TD 8214  
Company Representative

AUTHORIZED BY \_\_\_\_\_  
Lafayette  
District Office

DEPARTMENT OF CONSERVATION  
STATE OF LOUISIANA

AFFIDAVIT OF TEST OF CASING IN WELL

DATE WORK DONE 10-17-57

WORK PERMIT NO. 52074  
WELL SERIAL NO. 67503

Lafayette, La.  
(One copy to be filed with the District Office)

N O T E:

THIS REPORT WILL BE RETURNED IF NOT PROPERLY FILLED IN AND SIGNED

PARISH St. Mary FIELD Jeanerette SEC 37 TWP 13 RGE 9E  
COMPANY The Atlantic Refining Co. LEASE Adeline Sugar Factory WELL NO. 15  
Co.

TOTAL DEPTH 8214

SIZE OF CASING 5 1/2" IN: WT. PER FT. 14, 15.5, 17# #MAKE Pitts. National

NO. OF THREADS PER IN. 8 Rd GRADE J-55 SEAMLESS X NEW X 2ND

IF SECOND HAND, WAS PIPE TESTED \_\_\_\_\_ DESCRIBE \_\_\_\_\_

DEPTH LANDED BELOW DERRICK FLOOR 7616.71 FT. SACKS OF CEMENT 425

SIZE OF HOLE 8-3/4" IN.: AMOUNT OF CEMENT LEFT IN PIPE 30'

METHOD OF CEMENTING Halliburton CEMENT SET 12 HOURS UNDER 500 LBS.

PRESSURE \_\_\_\_\_ TOTAL TIME SET 24 HOURS

DETAIL OF PRESSURE TEST BEFORE DRILLING PLUG

DATE OF TEST: 10-18 19. 57. GAUGE PRESSURE ON CASING 1000 LBS.

PRESSURE AT END OF 30 MINUTES 1000 DROP Zero LBS.

TEST FLUID: WATER X MUD \_\_\_\_\_ LBS. PER GAS: VISCOSITY \_\_\_\_\_ SEC.

REMARKS: \_\_\_\_\_

THIS WORK WAS DONE ACCORDING TO THE RULES AND REGULATIONS OF THE DEPARTMENT OF CONSERVATION, MINERALS DIVISION.

SIGNED THE ATLANTIC REFINING COMPANY

WITNESS: \_\_\_\_\_

Form; Csg. (T)-MD16

**RECEIVED**  
OCT 22 1957  
L.E. Wilson  
Dist. Drlg. Supr  
10-21-57  
DEPARTMENT OF CONSERVATION  
DIVISION  
LAFAYETTE, LOUISIANA



DEPARTMENT OF CONSERVATION  
STATE OF LOUISIANA

-PERFORATING RECORD-

DATE WORK DONE 10-19-57

WORK PERMIT NO. \_\_\_\_\_

WORK SERIAL NO. 67503

Lafayette, La.

(One Copy to be filed with the District Office)

N O T E:

THIS REPORT WILL BE RETURNED IF NOT PROPERLY FILLED IN AND SIGNED

PARISH St. Mary FIELD Manerette SEC. 37 TWP. 13S RGE. 08

COMPANY The Atlantic Refg. Co. LEASE Adeline Sugar Factory Co. WELL NO. 15

TOTAL DEPTH 8214 NEW OR OLD WELL New

SIZE CASING 5-1/2" DEPTH OF CASING 7617

DEPTH OF PLUG BELOW PERFORATIONS 7568

PERFORATED FROM 7539 TO 7544

NUMBER OF HOLES 20 SIZE OF HOLES Jet

PERFORATING COMPANY Welox TRUCK NUMBER \_\_\_\_\_

PURPOSE OF PERFORATIONS For production

REMARKS \_\_\_\_\_

THIS WORK WAS DONE ACCORDING TO THE RULES AND REGULATIONS OF THE DEPARTMENT OF CONSERVATION.

SIGNED THE ATLANTIC REFINING COMPANY  
C O M P A N Y

Form  
Perf - MD4

J. E. Wilson  
L. E. Wilson Representing  
Dist. Drlg. Supr.  
10-21-57

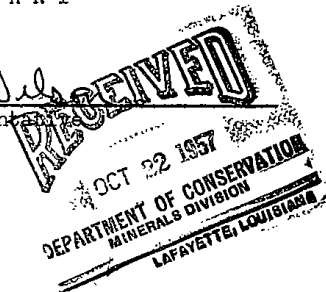



**COPY GEOLOGICAL SURVEY**

STATE OF LOUISIANA  
DEPARTMENT OF CONSERVATION  
MINERALS DIVISION

LOG OF WELL

FIELD Jacquerette COMPANY The Atlantic Refining Company

Parish St. Mary Sec. 37 Twp. 13S Rge. 9E Elevation 26.79  
Derrick Floor 26.79  
Ground 14.39

Location From the SW cor. of Sec. 37, T13S, R9E go N alg. 400' line 4420' thence E @ B/A 5220'

Lease Adeline Sugg. Pcty Co. No. 15 Permit No. 52074 Permit Serial No. 67503

The data given herewith is a complete record of the well and all work done thereon as determined from all available records.

Began Drilling 3 AM 9-18, 19 57 Completed 2:30 PM 10-19, 19 57  
Completed as Oil ( ) Gas (X) Condensate ( ) Dry ( ) Well

<b>OIL AND GAS ZONES</b>	<b>SALT WATER SANDS</b>	<b>FRESH WATER SANDS</b>
From <u>7539</u> to <u>7544</u> feet	In zone of production	From _____ to _____ feet
From _____ to _____ feet	From _____ to _____ feet	From _____ to _____ feet
From _____ to _____ feet	From _____ to _____ feet	From _____ to _____ feet

DRILL STEM TESTS.

Depth	Recovery in Stands			Chokes		Lbs. Pressure		Date	Time	Size D. S.	
	Seat	Bottom	Oil	Water	Sd. or Mud	Top	Bottom				Top
				NONE							

CASING RECORD

Size	Wt. Per Foot	Make	Where Landed	No. of Sks. Cement	Stood Hours	Pressure Test, Lbs.
<u>9-5/8</u>	<u>40</u>	<u>-</u>	<u>998.05</u>	<u>700</u>	<u>24</u>	<u>1150</u>
<u>5-1/2</u>	<u>14, 15.5, 17</u>	<u>National, Lone Star &amp; Republic</u>	<u>7616.71</u>	<u>425</u>	<u>24</u>	<u>1000</u>

COMPLETION DATA

Liner Size \_\_\_\_\_ Weight \_\_\_\_\_ Length \_\_\_\_\_ Screen Size \_\_\_\_\_ Gage \_\_\_\_\_ Length \_\_\_\_\_  
Casing perforations (prod. depth) from \_\_\_\_\_ to \_\_\_\_\_ ft. No. of holes \_\_\_\_\_  
Acidized with \_\_\_\_\_ gallons. Other physical or chemical treatment of well to induce flow \_\_\_\_\_  
Prod. began 10-19, 19 57 Making \_\_\_\_\_ bbls./day of 54.5 A. P. I. Gravity Fluid on 1/4 choke.  
Tub. Pres. 2790 lbs./sq. in. Csg. Pres. 0 lbs./sq. in. Gas Vol. 4100 M. C. F. Gas Oil Ratio \_\_\_\_\_  
B. S. & W. \_\_\_\_\_ % Gas Gravity \_\_\_\_\_ B. T. U.'s/M. C. F. \_\_\_\_\_ Gals. Gasoline/M. C. F. \_\_\_\_\_

WELL DATA

Indicate (yes or no) whether or not the following information was obtained.

Electrical Log Yes Date 10-14, 19 57 Straight Hole Survey Yes Type TOTCO  
Time Drilling Record No Other Types of Hole Survey Yes Type HOMO  
Core Analysis Yes Depth 3944 to 7598  
7716 to 8129  
6752 to 8073

Latitude 670.58' S Departure 7705' ft. W Average Inclination 18° Vertical Correction 67.54'  
Drilling Contractor Grey Wolf Drilg. Co. Signed S. E. Wells DEPARTMENT OF CONSERVATION  
Date 10-22-57, 19 \_\_\_\_\_ Title Dist. Drilg. Supt. MINERALS DIVISION  
LAFAYETTE, LOUISIANA

Form No. 12-M-R

DEPARTMENT OF CONSERVATION  
STATE OF LOUISIANA

Lafayette, La. DISTRICT

WELL COMPLETION OR RECOMPLETION REPORT

OIL WELL ( ) Three copies to be filed with District COMPLETION (  )  
DIS. WELL ( ) Office within three (3) days of date of RECOMPLETION ( )  
GAS WELL (  ) completion or recompletion (as per Order No. 29-A, Section X, Paragraph A, Article 1.) PERMIT SERIAL NO. ( )

PARISH St. Mary FIELD Jeanerette SEC 37 TWP 13S RGE 9E  
COMPANY The Atlantic Refining Co. LEASE Adeline Sugar Entry Co. WELL NO. 15  
DRILLING CONTRACTOR Grey Wolf Drlg. Co. DATE SPUDED (~~9-18-57~~) 9-18-57  
DATE COMPLETED OR RECOMPLETED \*\* 19  , AT    (A.M.) (P.M.)

COMPLETION DATA

INITIAL PRODUCTION 82 BBL./DAY (NET)  
TUBING PRESSURE 2790 #/SQ. IN. GAS FLOWING ( ) SHUT IN ( )  
CHOKE    SIZE 1/4 POSITIVE  ADJUSTABLE     
B.S. & W. .1 PERCENT SALT WATER ( ) WASH WATER ( )  
GAS VOLUME 7100 MCF/DAY  
GAS/OIL RATIO 50000/1 GF/BBL.  
GRAVITY 54.5 (60 degrees A. P. I.)  
PRODUCING DEPTH 7539 FT. TO 7544 FT.  
PERFORATED    YES (  ) NO ( ) BOTTOM TUBING 7473 FT. SIZE 2" IN.  
CASING (OIL STRING) SIZE 5-1/2 IN I.D. ( ) O.D. (  ) BOTTOM SEAT 7617 FT.  
TOTAL DEPTH DRILLED 8214 FT. DERRICK FLOOR ELEVATION 26.79 FT.

(Additional clearance is requested for    barrels of oil produced on drill-stem or other production tests. (see Section X, Paragraph B, of Order No. 29-A on reverse side.)

\*\* Gas well shut-in pending increased market.

FORM SDM 1-R

THE ATLANTIC REFINING COMPANY  
**RECEIVED**  
OCT 24 1957  
J.F. McGouldrick  
COMPANY REPRESENTATIVE OF CONSERVATION  
DEPARTMENT OF CONSERVATION  
MINERALS DIVISION  
Dist. Prod. Foreman, 10-22-57  
LAFAYETTE, LOUISIANA





MINERALS DIVISION  
DEPARTMENT OF CONSERVATION  
STATE OF LOUISIANA

WORK PERMIT

PERMIT TO Perforate DATE 9-23-59  
PARISH St. Mary FIELD Jeanerette  
COMPANY The Atlantic Refg. Co.  
ADDRESS Lafayette, La.  
WELL NAME Adeline Sugar Factory Co. No. 15 SEC 37 T. 13S 9E  
WELL PERMIT SERIAL No. 67503 WORK PERMIT No. Perf.L#735  
LOCATION \_\_\_\_\_

YOU ARE HEREBY AUTHORIZED TO Add perforations 7532  
to 7536' EL. and 7549-7555' EL. to present interval  
7539-7544' EL.

PERMIT REQUESTED BY \_\_\_\_\_ TD 8214  
J. F. McGouldrick  
Company Representative

AUTHORIZED BY \_\_\_\_\_  
Lafayette  
District Office

**PERFORATING DATA SHEET**

*PERMIT VERBAW*

LANE-WELLS COMPANY

Number Jobs This Trip *ONE LOAD*

District: *N.I.* Operating Base: *N.I.* Date: *9-23-59* S. O. # *42930*  
 Truck No. *313* Operator: *H. SMITH* Helper: *MADON-VIATOR*  
 Customer: *ATLANTIC RICE CO.* Authorized Agent: *MR HALL*  
 Name of Well: *ATLANTIC SUGAR FACTORY* No. *15* Field: *TRINIDAD*  
 State: *LA* County/Parish: *ST MARY*

Job Scheduled: \_\_\_\_\_ A.M. Arrived At \_\_\_\_\_ A.M.  
 P.M. Location Landing \_\_\_\_\_ P.M.  
 On Job: \_\_\_\_\_ A.M. M. Res. Off Job \_\_\_\_\_ A.M.  
 P.M. P.M. M. Res. \_\_\_\_\_ P.M.

Standby Time \_\_\_\_\_ Max. Temp \_\_\_\_\_ ° F.  
 New or Old Well: *OLD* Purpose of Perforating: *PROD* Kind of Fluid: *CELLULOSIC* Level: *FULL*  
 Casing Record: *5 1/2-17"* Cemented In: *8 1/2* Liner Record \_\_\_\_\_ Cemented In \_\_\_\_\_  
 Customer's Depth: *7562* Measure Method: *STM* Zero Point: *14.5 AGU. TURKIN HAUSSER*  
 Lane-Wells Depth \_\_\_\_\_ Size Gun: *1 1/8* No. \_\_\_\_\_ No. \_\_\_\_\_ Type: *SMALL JET* Controller No. \_\_\_\_\_ No. \_\_\_\_\_  
 Bullet Size: *12* Holes from: *7538* to *7534 9/16* Holes from \_\_\_\_\_ to \_\_\_\_\_ Ft.  
 Holes from \_\_\_\_\_ to \_\_\_\_\_ Ft. Shooting Zones Approved By: *J.G. Marshall* Title \_\_\_\_\_

	Run No.	Run No.	Run No.	Run No.	Run No.	Run No.
1						
2				<i>16 Below</i>	<i>7538-7534</i>	
3						
4						
5						
6						
7						
8						
9						
10						
11						
12						
13						
14						
15						
16						
17						
18						
19						
20						
21						
22						
23						
24						
25						
26						
27						
28						
29						
30						

**RECEIVED**  
 SEP 25 1959  
 DEPARTMENT OF CONSERVATION  
 MINERALS DIVISION  
 LAFAYETTE, LOUISIANA

RUNNING TIME			REMARKS
1)	In From _____ to _____	A.M. P.M.	
	Out From _____ to _____	A.M. P.M.	
	Fluid _____		
	In _____ Out _____		
	Holes _____ Total _____		
	Misses _____ Total _____		
2)	In From _____ to _____	A.M. P.M.	
	Out From _____ to _____	A.M. P.M.	
	Fluid _____		
	In _____ Out _____		
	Holes _____ Total _____		
	Misses _____ Total _____		
3)	In From _____ to _____	A.M. P.M.	
	Out From _____ to _____	A.M. P.M.	
	Fluid _____		
	In _____ Out _____		
	Holes _____ Total _____		
	Misses _____ Total _____		
4)	In From _____ to _____	A.M. P.M.	
	Out From _____ to _____	A.M. P.M.	
	Fluid _____		
	In _____ Out _____		
	Holes _____ Total _____		
	Misses _____ Total _____		
5)	In From _____ to _____	A.M. P.M.	
	Out From _____ to _____	A.M. P.M.	
	Fluid _____		
	In _____ Out _____		
	Holes _____ Total _____		
	Misses _____ Total _____		
6)	In From _____ to _____	A.M. P.M.	
	Out From _____ to _____	A.M. P.M.	
	Fluid _____		
	In _____ Out _____		
	Holes _____ Total _____		
	Misses _____ Total _____		
Mileage: From _____ to _____			
Mileage: From _____ to _____			



WORK RESUME

List below all work performed under Department of Conservation Work Permits while drilling and completing well.

WORK PERMIT NO.	DATE WORK PERFORMED	SERVICE COMPANY	DESCRIPTION OF WORK
Perf.L #735	9-23-59	Lane Wells	Add perfs 7532-7536' EL and <del>7549-7553</del> EL to present perfs 7539-7544', EL.

List below all important Paleofaunal or Geological Formation tops, Cap Rock and Salt tops and Salt Overhang bottoms.

FORMATION	DEPTH	FORMATION	DEPTH

MINERALS DIVISION  
DEPARTMENT OF CONSERVATION  
STATE OF LOUISIANA

**Plug & WORK PERMIT**

PERMIT TO **Perforate** DATE **10-26-60**  
PARISH **St. Mary** FIELD **Jeannerette**  
COMPANY **The Atlantic Refg. Co.**  
ADDRESS **Lafayette, La.**  
WELL NAME **Adeline Sugar Factory Co.** No. **15** SEC. **37** T. **13S** R. **9E**  
WELL PERMIT SERIAL No. **67503** WORK PERMIT No. **Pl.Perf.L#118**  
LOCATION \_\_\_\_\_

YOU ARE HEREBY AUTHORIZED TO **Isolate perf. 7539-44'**  
**& 7532-36' EL w/Bridge Plug & 10' Cmt Cap. Perf. for**  
**production 6744-55' EL.**

PERMIT REQUESTED BY **J. F. Crews** TD **8214**  
Company Representative

AUTHORIZED BY **Lafayette**  
District Office

SUBSURFACE COMPLETION SERVICE, INC.

DATE 10-27-60 S.O. 215 TRUCK H-4 ENGR Gray  
 COMPANY The Atlantic Refining Company  
 WELL Adeline Sugar Factory Well No. 15 FIELD Jeanerette  
 COUNTY St. Mary STATE Louisiana  
 LOCATION \_\_\_\_\_  
 PERMANENT DATUM OR ZERO 14.28' Above T.H.F. ELEV. \_\_\_\_\_  
 DRILLING MEASURED FROM 14.28' Above T.H.F. ELEV. \_\_\_\_\_  
 G.L. ELEV. \_\_\_\_\_ D.F. ELEV. \_\_\_\_\_ COMPANY DEPTH 7450+  
 BIT SIZE CSG. 5-1/2 14-17 SET AT 8400+ LINER \_\_\_\_\_ TO \_\_\_\_\_  
 TYPE FLUID Salt Water LEVEL Full

MEASURE RECORD

TOOL USED \_\_\_\_\_ STRETCH AT \_\_\_\_\_ : \_\_\_\_\_ = \_\_\_\_\_  
 TOOL USED \_\_\_\_\_ STRETCH AT \_\_\_\_\_ : \_\_\_\_\_ = \_\_\_\_\_

	RUN NO. 1		RUN NO. 2		RUN NO. 3		RUN NO. 4	
LAST FLAG								
FIRST FLAG								
DIFFERENCE								
	Reset		Reset		Reset		Reset	
BOTTOM	In	Out	In	Out	In	Out	In	Out

PERFORATING DATA

44 Holes from 6757 to 6746 , \_\_\_\_\_ Holes from \_\_\_\_\_ to \_\_\_\_\_ , \_\_\_\_\_ Holes from \_\_\_\_\_ to \_\_\_\_\_

	RUN NO. 1		RUN NO. 2		RUN NO. 3		RUN NO. 4	
	Gun to CCL	Ft.	Gun to CCL	Ft.	Gun to CCL	Ft.	Gun to CCL	Ft.
	Log	Perf.	Log	Perf.	Log	Perf.	Log	Perf.
Collar No. 1								
Collar No. 2								
Collar No. 3								
Collar Reset								
Last Shot								
First Shot								
Odometer								

DEPARTING  
 NOV 2 1960  
 STATE OF LOUISIANA  
 MINERAL INDUSTRY  
 LAFAYETTE, LOUISIANA



Department of Conservation  
MINERALS DIVISION

WELL HISTORY AND WORK RESUME REPORT

FIELD	Jeanerette
SERIAL NO.	67503
PRODUCING INTERVAL	6744-6755' EL
RESERVOIR (COMPANY SAND IDENTIFICATION)	MM Sand

Three typewritten copies of this report must be filed with the District Office of the Department of Conservation in which the well is located within twenty (20) days of the date of completion or recompletion. NOTE: If not properly completed and signed, this report will be returned.

LEASE AND WELL DATA

DESIGNATE TYPE OF COMPLETION: NEW WELL <input type="checkbox"/> RECOMPLETION <input checked="" type="checkbox"/> SAME RESERVOIR <input type="checkbox"/> DIFFERENT RESERVOIR <input checked="" type="checkbox"/> OIL <input checked="" type="checkbox"/> GAS <input type="checkbox"/> P&A <input type="checkbox"/>	
OPERATOR	ADDRESS
The Atlantic Refining Company	P. O. Box 2368, Lafayette, La.
LEASE NAME	WELL NO.
ADELINE SUGAR FACTORY COMPANY	15
PARISH	DATE PERMIT ISSUED
St. Mary	-
SEC. 37 TWP. 13S RGE. 9E	PBTD
DATE SPUDDED	TOTAL DEPTH
10-23-60	8214
GROUND ELEVATION	CASING HEAD FLANGE ELEVATION
-	-
DATE WELL TURNED INTO TANKS	SINGLE, DUAL OR TRIPLE COMPLETION?
DATE COMP. 10-27-60	Single
NOTE: IF THIS IS A MULTIPLE COMPLETION, FURNISH A SEPARATE REPORT FOR EACH COMPLETION	DATE FILED
WAS WELL DIRECTIONALLY DRILLED?	WERE 3 COPIES FILED WITH THE DEPARTMENT OF CONSERVATION?
-	-
TYPE OF ELECTRICAL OR OTHER LOGS RUN (CIRCLE LOGS FILED WITH DEPT. OF CONSERVATION)	DATE FILED
-	-

CASING, LINER AND TUBING RECORD

CASING SIZE	HOLE SIZE	CASING WEIGHT	DEPTH SET	SACKS CEMENT	TEST PRESSURE	HRS. UNDER PRESSURE	DATE TESTED	NAME OF TEST WITNESS - STATE IF DEPT. AGENT OR OFFSET OPR.
TUBING SIZE: 2	DEPTH OF TUBING: 6706	DEPTH OF PACKER (SI): 6706						

INITIAL COMPLETION OR RE-COMPLETION DATA

INITIAL PRODUCTION	GAS VOLUME	CHOKE SIZE	WELL STATUS
			Shut In
TUBING PRESSURE	CASING PRESSURE	GOR	BS & W
psig	psig		%
GRAVITY	CONSERVATION AGENT MAKING GAUGE	COMPANY REPRESENTATIVE	DATE GAUGED
*API 60°F			DATE COMP. 10-27-60

PLUG AND ABANDON (P&A) DATA

CASING SIZE	AMOUNT PULLED	CEMENT PLUGS				DATE WORK PERFORMED	NAME OF TEST WITNESS - STATE IF DEPT. AGENT OR OFFSET OPR.
		FROM	TO	SACKS	HOW PLACED		

CERTIFICATE: I, the undersigned, state: That I am employed by The Atlantic Ref. Co. and that I am authorized to make this report, and that this report was prepared under my supervision and direction and that all facts stated herein are true, correct and complete to the best of my knowledge.

Form WH

Signature: J. F. McGouldrick Title: Sr. Production Foreman

J. F. McGouldrick, 11-22-60

DEPARTMENT OF CONSERVATION  
MINERALS DIVISION  
LAFAYETTE, LOUISIANA

WORK RESUME

List below all work performed under Department of Conservation Work Permits while drilling and completing well.

WORK PERMIT NO.	DATE WORK PERFORMED	SERVICE COMPANY	DESCRIPTION OF WORK
Pl. Perf. L#118	10-27-60	Subco	Isolate perfs 7539-44' and 7532-36' EL with bridge plug and 10' cement cap. Perforate for production 6744-55' EL.
Sq. Perf L#255	11-10-60	"	Squeeze perfs 6744-55' and reperforate 6744-55'.

List below all important Paleofaunal or Geological Formation tops, Cap Rock and Salt tops and Salt Overhang bottoms.

FORMATION	DEPTH	FORMATION	DEPTH

SUBSURFACE COMPLETION SERVICE, INC.

DATE 11-10-60 S.O. 565 TRUCK H-6 ENGR Guidry  
 COMPANY Atlantic Refining Company  
 WELL Adline Sugar Factory No. 15 FIELD Adline  
 COUNTY St. Mary STATE Louisiana  
 LOCATION \_\_\_\_\_  
 PERMANENT DATUM OR ZERO 14.28' Above Tubing Hanger ELEV. \_\_\_\_\_  
 DRILLING MEASURED FROM \_\_\_\_\_ ELEV. \_\_\_\_\_  
 G.I. ELEV. \_\_\_\_\_ D.F. ELEV. \_\_\_\_\_ COMPANY DEPTH 7435'  
 BIT SIZE \_\_\_\_\_ CSG. 5-1/2" 17# SET AT \_\_\_\_\_ LINER \_\_\_\_\_ TO \_\_\_\_\_  
 TYPE FLUID Salt Water LEVEL Full

MEASURE RECORD

TOOL USED \_\_\_\_\_ STRETCH AT \_\_\_\_\_ : \_\_\_\_\_ = \_\_\_\_\_  
 TOOL USED \_\_\_\_\_ STRETCH AT \_\_\_\_\_ : \_\_\_\_\_ = \_\_\_\_\_

	RUN NO. 1		RUN NO. 2		RUN NO. 3		RUN NO. 4	
LAST FLAG								
FIRST FLAG								
DIFFERENCE								
BOTTOM	Reset		Reset		Reset		Reset	
	In	Out	In	Out	In	Out	In	Out

PERFORATING DATA

44 Holes from 6757 to 6746 , \_\_\_\_\_ Holes from \_\_\_\_\_ to \_\_\_\_\_ , \_\_\_\_\_ Holes from \_\_\_\_\_ to \_\_\_\_\_

	RUN NO. 1		RUN NO. 2		RUN NO. 3		RUN NO. 4	
	Gun to CCL	Ft.	Gun to CCL	Ft.	Gun to CCL	Ft.	Gun to CCL	Ft.
Collar No. 1	Log	Perf.	Log	Perf.	Log	Perf.	Log	Perf.
Collar No. 2								
Collar No. 3								
Collar Reset								
Last Shot	<u>6746</u>							
First Shot	<u>6757</u>							
Odometer	<u>6757.5</u>							

**RECEIVED**  
 NOV 15 1960  
 DEPARTMENT OF CONSERVATION  
 MINERALS DIVISION  
 LAFAYETTE, LOUISIANA

MINERALS DIVISION  
DEPARTMENT OF CONSERVATION  
STATE OF LOUISIANA

WORK PERMIT

PERMIT TO Plug & Abandon DATE 12-9-60  
PARISH St. Mary FIELD Jeanerette  
COMPANY The Atlantic Refg. Co.  
ADDRESS Lafayette, La.  
WELL NAME Adeline Sugar Factory Co. No. 15 SEC. 37 T. 138 R. 9E  
WELL PERMIT SERIAL No. 67503 WORK PERMIT No. Abd. L#332  
LOCATION \_\_\_\_\_

YOU ARE HEREBY AUTHORIZED TO Set 20 ex cut plug  
across perfs 6746-57'; 50 ex cut plug at 981' in  
9-5/8" cag. & top plug of 15 ex at surface.

PERMIT REQUESTED BY D. T. Melton TD 8214  
Company Representative

AUTHORIZED BY \_\_\_\_\_

Lafayette  
District Office

DEPARTMENT OF CONSERVATION  
STATE OF LOUISIANA

PLUG AND ABANDON REPORT

DATE WORK DONE January 6, 1961

WELL SERIAL 67503 **67503**  
WORK PERMIT NO. ADD. 17322

Lafayette, La. DISTRICT  
(Three Copies to be Filed with the District Office)

NOTE: This Report Will Be Returned If Not Properly Completed And Signed.

Field Jeanerette Parish St. Mary Sec. 15 Twp. 138 Rge. 9E  
Company The Atlantic Refining Lease Adeline Well No. 15  
Total Depth 8214' Condition of Well Dry

- |                      |                    |                   |                          |
|----------------------|--------------------|-------------------|--------------------------|
| 1. Surface Casing    | Size _____         | Depth _____       | Amount Pulled _____      |
| 2. Protection Casing | Size <u>9 5/8"</u> | Depth <u>981'</u> | Amount Pulled _____      |
| 3. Production Casing | Size <u>5 1/2"</u> | Depth <u>7600</u> | Amount Pulled <u>995</u> |

CEMENT PLUGS

- |                      |                |                        |                        |
|----------------------|----------------|------------------------|------------------------|
| 1. Depth <u>6200</u> | To <u>6400</u> | No. of Sacks <u>20</u> | How Placed <u>pump</u> |
| 2. Depth <u>1045</u> | To <u>945</u>  | No. of Sacks <u>46</u> | How Placed <u>pump</u> |
| 3. Depth <u>0</u>    | To <u>20</u>   | No. of Sacks <u>15</u> | How Placed <u>hand</u> |

Mud Record: Weight 8.7 Viscosity Brine

Remarks: \_\_\_\_\_

This work was done according to the Rules and Regulations of the Department of Conservation.

Raul Ortiz - Driver  
WITNESS

The Atlantic Refining Company  
COMPANY

( Signed )

Bryan W. Gots  
REPRESENTATIVE

700 40 150