

205761

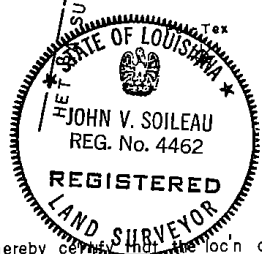
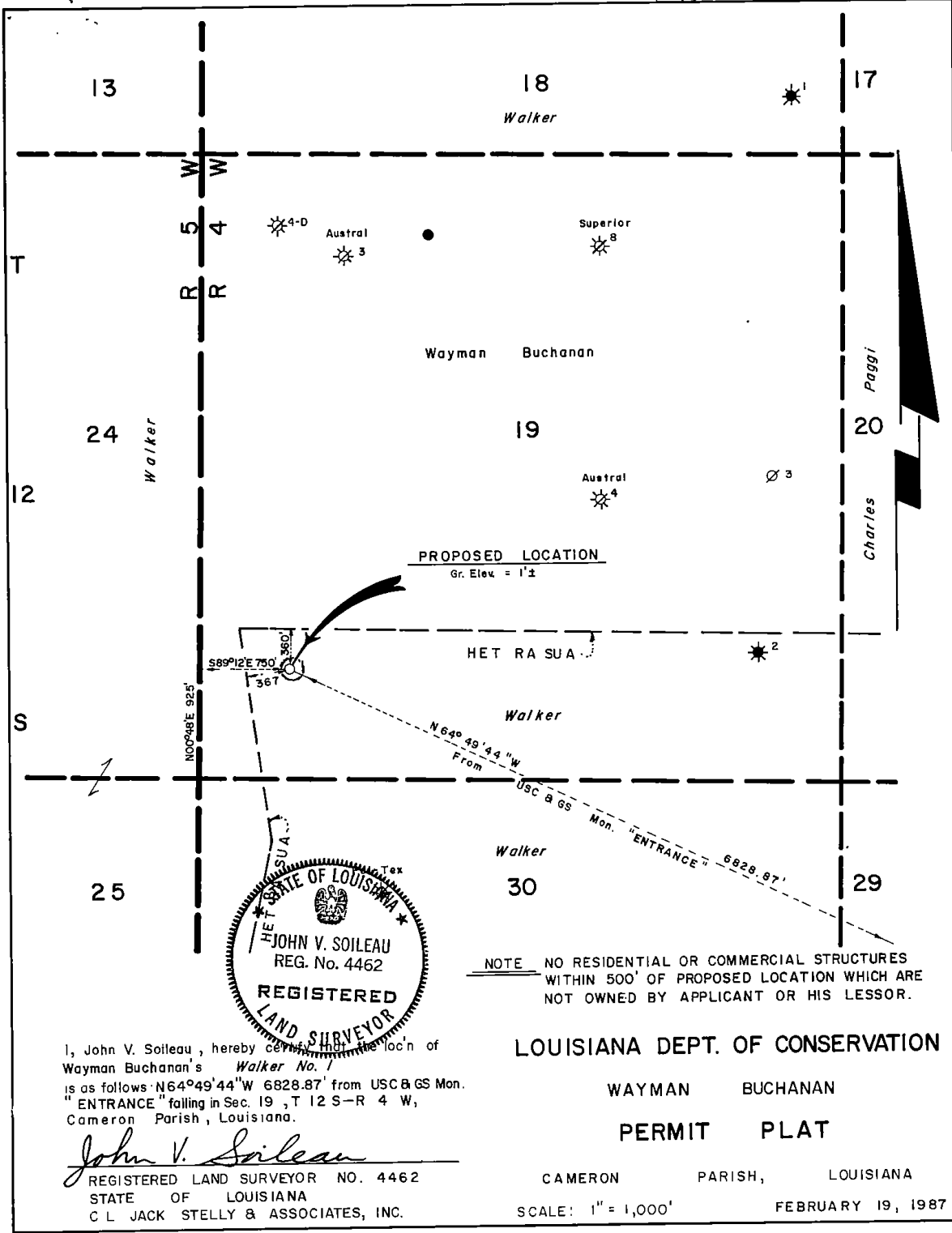

I, John V. Soileau, hereby certify that the loc'n of Wayman Buchanan's Walker No. 1 is as follows: N64°49'44"W 6828.87' from USC & GS Mon. "ENTRANCE" falling in Sec. 19, T 12 S-R 4 W, Cameron Parish, Louisiana.

John V. Soileau
 REGISTERED LAND SURVEYOR NO. 4462
 STATE OF LOUISIANA
 C L JACK STELLY & ASSOCIATES, INC.

NOTE NO RESIDENTIAL OR COMMERCIAL STRUCTURES WITHIN 500' OF PROPOSED LOCATION WHICH ARE NOT OWNED BY APPLICANT OR HIS LESSOR.

LOUISIANA DEPT. OF CONSERVATION

WAYMAN BUCHANAN

PERMIT PLAT

CAMERON PARISH, LOUISIANA

SCALE: 1" = 1,000'

FEBRUARY 19, 1987

STATE OF LOUISIANA
OFFICE OF CONSERVATION

Inter Office

Date: April 23, 1987

To: Mr. W. J. Clark

From: Mr. Gerard LeBlanc

Attn: Mr. W. J. Clark

Enclosed herewith please find application from WAYMAN W. BUCHANAN
_____ for permit to drill
their Walker #1, LAKESIDE Field
_____ Cameron Parish, Louisiana. Zone _____

Also enclosed please find:

Check No. 17301 in the amount of \$ 200.00 (COPY).

Well location plat

_____ Well location certification

29-B
29-E
113-Series

_____ Form A.D.C.
_____ Electric Log
_____ Schematic diagram
_____ (Dual) structure map if well does not comply with existing Orders
_____ (Selective-Onshore) structure map showing reservoir limits
_____ (Selective-Offshore) letter(s) of no objection from offset operators

Applicable Department of Conservation Order No. _____.

Pending Hearing, Docket No. _____.

Remarks & Recommendations:

Inclinal or directional survey required. Shall comply with Statewide Order 29-E. Shall comply with Order 29-B. Shall comply with 113 series of orders.

GEL:ps
Encls

By *Gerard LeBlanc*
District Manager

cc: Geological Oil & Gas Division
Prod. Audit (for Amended Permits only)

LT-1



EDWIN W. EDWARDS
GOVERNOR
B. JIM PORTER
SECRETARY

DEPARTMENT OF NATURAL RESOURCES
OFFICE OF CONSERVATION

HERBERT W. THOMPSON
ASSISTANT SECRETARY
AND
COMMISSIONER

April 23, 1987

WAYMAN W. BUCHANAN
Attn: Don Delaney
Petroleum Commerce Building, Suite 444
San Antonio, TX 78205

Gentlemen:

We have processed and forwarded to Baton Rouge for final approval your application to drill the: Walker #1, LAKESIDE, Cameron.

Statewide Order No. 29-B issued by the Commissioner of Conservation on July 19, 1943 required:

1. No well shall be drilled, nor shall the drilling of a well be commenced, before a permit for such well has been issued by the Office of Conservation.
2. A progress report shall be filed, either written or by telephone, with the district office by TUESDAY of each week. Include rig name & number and rig telephone number on initial report.
3. No well shall commence drilling below surface casing until a sign has been posted on the derrick and subsequently on the well.
4. The completion report must be filed within three (3) days after date of completion. The electrical logs (Composite 1"=100') must be filed in duplicate ten days after the completion of the well. The well history (WH-1) must be filed in triplicate twenty days after the completion of the well on forms provided by this department.
5. IN THE EVENT YOU USE A CONSULTANT OR A DRILLING CONTRACTOR ON A TURNKEY BASIS, PLEASE SEE THAT HE IS FURNISHED A COPY OF THESE INSTRUCTIONS.
6. Contact Joe Durham, Oil & Gas Inspector for the Office of Conservation at telephone (318)824-3837 in Jennings, Louisiana for further information.

Yours very truly,

Gerard LeBlanc, District Manager
Lafayette District

GEL:jcl

cc:

FORM MD 13-R

WELL FILE COPY

PERMIT TO DRILL FOR MINERALS

PERMIT \$200.00
Multiple Zone Processing

STATE OF LOUISIANA
OFFICE OF CONSERVATION
ATT

Send To Lafayette/29 Date April 24, 1987
Serial No. Ser#205761 API # 1702322333
Parish Cameron 012 Field Lakeside 5772

Operator Wayman W. Buchanan 0848
Address Petroleum Commerce Bldg., Suite 444
City & State San Antonio, TX 78205
Well Name Walker No. 1
Location Sec 19, T12S, R4W
N 64°49'44" W 6828.87' fr USC&GS Mon. "Entrance" falling in Sec 19.
X=1,528,370.58' Y=481,683.48'

Zone of Reservoir of Proposed Completion PTD 12,500'
Applicable Order of Conservation Order Any productive sand
29B, 29E, 113 Series

Herbert W. Thompson
COMMISSIONER

[Signature]
ISSUING AUTHORITY

193231

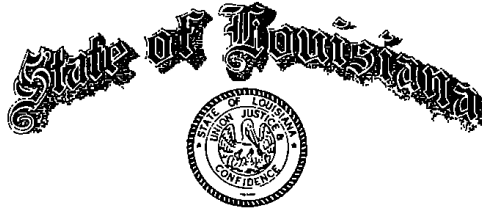

EDWIN W. EDWARDS
GOVERNOR
B. JIM PORTER
SECRETARY

DEPARTMENT OF NATURAL RESOURCES
OFFICE OF CONSERVATION

HERBERT W. THOMPSON
ASSISTANT SECRETARY
AND
COMMISSIONER

APRIL 24, 1987

WAYMAN W. BUCHANAN
PETROLEUM COMMERCE BLDG.
SUITE 444
SAN ANTONIO, TX 78205

RE: CAMERON PARISH
LAKESIDE FIELD
WALKER NO. 1
SER NO. 205761

GENTLEMEN:

THE ABOVE APPLICATION FOR PERMIT TO DRILL IS BEING ISSUED WITH THE UNDERSTANDING THAT YOU WILL FURNISH THE APPROPRIATE DISTRICT MANAGER WITH INCLINATION AND/OR DIRECTIONAL SURVEY DATA AS PROOF THAT THE WELL HAS BEEN DRILLED IN COMPLIANCE WITH THE PROVISIONS OF THE STATEWIDE ORDER NO. 29-B, SECTION XVIII, DATED MARCH 1, 1967.

IN ADDITION, THIS WELL CANNOT BE COMPLETED IN ANY POOL IN WHICH THE LOCATION DOES NOT CONFORM WITH THE PROVISIONS OF STATEWIDE ORDER NO 29-E, NOR WILL THERE BE A COMPLETION IN ANY SAND WHICH IS NOT IN COMPLIANCE WITH THE PROVISIONS OF OFFICE OF CONSERVATION ORDERS OF THE 113 SERIES.

VERY TRULY YOURS,

HERBERT W. THOMPSON, COMMISSIONER
OFFICE OF CONSERVATION

BY

A handwritten signature in black ink, appearing to read 'W. J. Clark', is written over a horizontal dashed line.

WILLIAM J. CLARK
PETROLEUM ENGINEER SUPERVISOR 1

WJC:SM

CC: GERARD LEBLANC
LAFAYETTE, (ACTING) DIST. MGR.

LOUISIANA OFFICE OF CONSERVATION PERMIT SECTION

WELL COMPLETION OR RECOMPLETION REPORT

29-E COMPLIANCE	YES	NO
29-E UNIT ATTACHED	YES	NO
O.C. USE ONLY		

DISTRICT Lafayette

CODE NUMBERS:	DATE <u>9/25/87</u>	<input type="checkbox"/> 1 - ON-SHORE	
<u>012</u> ✓	PARISH <u>Cameron</u>	<input checked="" type="checkbox"/> 3 - OFF-SHORE	
<u>5772</u> ✓	FIELD <u>Lakeside</u>	SEC. <u>19</u> T <u>12S</u> R <u>4W</u>	OC ORDER NO. _____
<u>2978</u> ✓	OPERATOR <u>Hydrocarbon Management, Inc.</u>		
	WELL NAME <u>Walker</u>	NO. <u>1</u>	SERIAL NO. <u>205761</u>
	RESERVOIR <u>10,100' Stray Sand</u>	COMPLETION DATE <u>9/21/87</u>	TIME <input type="checkbox"/> AM <input type="checkbox"/> PM

IMPORTANT: IS A FORM MD-10-R-A BEING FILED WITH THIS REPORT? IF NO, EXPLAIN YES NO

REMARKS: _____

COMPLETION DATA:

* TYPE COMPLETION	PRIMARY PRODUCT	PRIMARY PRODUCT CHANGE?	PRODUCING METHOD	STATUS OF WELL
<input type="checkbox"/> 1 - ORIG. COMP. <input checked="" type="checkbox"/> 2 - RE-COMP.	<input type="checkbox"/> 1 - OIL <input checked="" type="checkbox"/> 2 - GAS <input type="checkbox"/> 3 - DRY GAS	<input type="checkbox"/> 1 - YES <input checked="" type="checkbox"/> 2 - NO	<input type="checkbox"/> F - FLOWING <input type="checkbox"/> GL - GAS LIFT <input checked="" type="checkbox"/> P - PUMPING	<input type="checkbox"/> 1 <input type="checkbox"/> 0 SEE REVERSE SIDE FOR CODE

Correction *

* IF THIS IS A RE-COMPLETION SPECIFY: SAME RESERVOIR DIFFERENT RESERVOIR

INITIAL PROD. <u>30</u> BOPD	GAS VOLUME <u>1563</u> MCF/DAY	FLOWING TUBING PRESSURE <u>2138</u> PSIG	SHUT-IN TUBING PRESSURE <u>2683</u> PSIG	CASING PRESSURE <u>0</u> PSIG
CHOKE SIZE <u>13</u> / <u>64</u> "	WATER PROD. <u>6</u> BPD	BS & W <u>0</u> %	GOR <u>52100:1</u> CF/BBL	GRAVITY <u>.6131</u> API AT 60°F

PERFORATIONS 10,029' - 10,034' * TOTAL DEPTH 10,226'

CLEARANCE & CERTIFICATION:

ADDITIONAL CLEARANCE IS REQUESTED FOR _____ BBLs. OF OIL PRODUCED ON DRILL-STEM OR OTHER PRODUCTION TEST: (SEE SECTION X PARAGRAPH B OF ORDER 29-B ON REVERSE SIDE).

CERTIFICATION

I HEREBY CERTIFY THAT THE ABOVE INFORMATION IS TRUE AND CORRECT TO THE BEST OF MY KNOWLEDGE.

INSTRUCTIONS

(THREE (3) COPIES TO BE FILED WITH THE DISTRICT OFFICE WITHIN THREE (3) DAYS OF DATE OF COMPLETION OR RECOMPLETION (AS PER ORDER 29-B, SECTION X, PARAGRAPH A, ARTICLE 1).)

[Signature]

 SIGNATURE
 Hydrocarbon Management, Inc.
 OPERATOR
 Operations Manager

 TITLE

29-E COMPLIANCE	YES	NO
29-E UNIT ATTACHED	YES	NO
O.C. USE ONLY		

STATE OF LOUISIANA
OPERATION
PERMIT SECTION
WELL COMPLETION OR RECOMPLETION REPORT

DISTRICT Lafayette

CODE NUMBERS:	DATE <u>9-25-87</u>	<input type="checkbox"/> 1 - ON-SHORE
<u>012</u>	PARISH <u>Cameron</u>	<input type="checkbox"/> 3 - OFF-SHORE
<u>5772</u>	FIELD <u>Lakeside</u>	SEC. <u>19</u> T <u>12S</u> R <u>4W</u>
<u>0848</u>	OPERATOR <u>Wayman W. Buchanan</u>	OC ORDER NO. _____
WELL NAME <u>Walker</u>	NO. <u>1</u>	SERIAL NO. <u>205761</u>
RESERVOIR <u>10,100' Stray Sand</u>	COMPLETION DATE <u>9-21-87</u>	TIME <input type="checkbox"/> AM <input type="checkbox"/> PM
<i>Apud: 8-2-87</i>		

IMPORTANT: IS A FORM MD-10-R-A BEING FILED WITH THIS REPORT? IF NO, EXPLAIN YES NO

REMARKS: _____

COMPLETION DATA:

* TYPE COMPLETION	PRIMARY PRODUCT	PRIMARY PRODUCT CHANGE?	PRODUCING METHOD	STATUS OF WELL
<input type="checkbox"/> 1 - ORIG. COMP. <input type="checkbox"/> 2 - RE-COMP.	<input type="checkbox"/> 1 - OIL <input type="checkbox"/> 2 - GAS <input type="checkbox"/> 3 - DRY GAS	<input type="checkbox"/> 1 - YES <input type="checkbox"/> 2 - NO	<input type="checkbox"/> F - FLOWING <input type="checkbox"/> G L - GAS LIFT <input type="checkbox"/> P - PUMPING	<input type="checkbox"/> 3 <input type="checkbox"/> 6 SEE REVERSE SIDE FOR CODE
* IF THIS IS A RE-COMPLETION SPECIFY: SAME RESERVOIR <input type="checkbox"/> DIFFERENT RESERVOIR <input type="checkbox"/>				
<u>30</u> BOPD INITIAL PROD.	<u>1563</u> MCF/DAY GAS VOLUME	<u>2138</u> PSIG FLOWING TUBING PRESSURE	<u>2683</u> PSIG SHUT-IN TUBING PRESSURE	<u>0</u> PSIG CASING PRESSURE
<u>13/64"</u> CHOKER SIZE	<input type="checkbox"/> 1 - POSITIVE <input type="checkbox"/> 2 - ADJUST	<u>6</u> BPD WATER PROD.	<u>0</u> % BS & W	<u>52100:1</u> CF/BBL GOR
PERFORATIONS <u>10,024' - 10,034'</u>				TOTAL DEPTH <u>10,226'</u>

CLEARANCE & CERTIFICATION:

ADDITIONAL CLEARANCE IS REQUESTED FOR _____ BBLs. OF OIL PRODUCED ON DRILL-STEM OR OTHER PRODUCTION TEST: (SEE SECTION X PARAGRAPH B OF ORDER 29-B ON REVERSE SIDE).

CERTIFICATION

I HEREBY CERTIFY THAT THE ABOVE INFORMATION IS TRUE AND CORRECT TO THE BEST OF MY KNOWLEDGE.



 SIGNATURE

 OPERATOR

 TITLE

INSTRUCTIONS

(THREE (3) COPIES TO BE FILED WITH THE DISTRICT OFFICE WITHIN THREE (3) DAYS OF DATE OF COMPLETION OR RECOMPLETION (AS PER ORDER 29-B, SECTION X, PARAGRAPH A, ARTICLE 1).)

OFFICE OF CONSERVATION
STATE OF LOUISIANA

This side is to be used when requesting clearance for oil produced on Drill Stem Test or other Production Tests, made previous to official completion or recompletion.

SECTION X, PARAGRAPH B OF ORDER NO. 29-B

Allowables given to wells for oil produced on drill stem tests, production test and miscellaneous production of oil shall be in accordance with the following rule:

All operators are required within five days, to file three signed copies of the record of the daily production from the well, showing the number of hours the well produced and the interval of production --- as "from 8:00 A.M., August 5 to 3:00 P.M., August 8, 1952."

<u>T E S T D A T A</u>		
<u>Date of Test</u>	<u>Time of Test</u>	<u>Amount of Oil Produced</u>
_____	_____ M. to _____ M.	_____ Barrels
_____	_____ M. to _____ M.	_____ Barrels
_____	_____ M. to _____ M.	_____ Barrels
_____	_____ M. to _____ M.	_____ Barrels
_____	_____ M. to _____ M.	_____ Barrels
TOTAL _____		BARRELS

The above total barrels of oil were produced from _____ Ft. to _____ Ft.

Remarks: _____

OPERATOR (Signed) OPERATOR REPRESENTATIVE

CODES TO USE IN REPORTING STATUS OF WELL

- 10 Active
- 33 Inactive-Future Utility (does not include waiting on pipeline or market)
- 36 Inactive waiting on pipeline
- 37 Inactive waiting on market



OFFICE OF CONSERVATION
WELL HISTORY AND WORK RESUME REPORT

FIELD
Lakeside

SERIAL NO
205761

PRODUCING INTERVAL
10,024' - 10,034'

RESERVOIR (COMPANY SAND IDENTIFICATION)
10,100' Stray Sand

Three typewritten copies of this report must be filed with the District Office of the Office of Conservation in which the well is located within twenty (20) days of the date of completion. NOTE: If not properly completed and signed this report will be returned.

LEASE AND WELL DATA

CHECK APPROPRIATE BOXES

NEW WELL
 RECOMPLETION
 P & A

31 INACTIVE DRY HOLE FUT. UTIL.
 32 INACTIVE DRY HOLE NO FUT. UTIL.
 36 INACTIVE WAITING ON PIPELINE
 37 INACTIVE WAITING ON MARKET

PRODUCT
 OIL
 GAS
 OTHER

IF RECOMPLETION
 SAME RESERVOIR
 DIFFERENT RESERVOIR

DATE COMP. RECOMP. OR P & A
M D Y

OPERATOR
Wayman W. Buchanan

CODE
0848

ADDRESS
**444 Petroleum Commerce Bldg.
San Antonio, TX 78205**

WELL NAME
Walker

WELL NO.
1

PARISH
Cameron

SEC. **19** TWP **12S** RGE **4W**

DATE PERMIT ISSUED
9/16/87

DATE SPUNDED
M D Y
8-2-87

DATE READY TO PRODUCE*
9-21-87

TOTAL DEPTH
12,505'

PBTD
10,226'

GROUND ELEVATION
2'

CASING HEAD FLANGE ELEVATION
8'

DISTANCE FROM RKB TO CHF
33.2'

DATE WELL TURNED INTO TANKS

SINGLE, DUAL OR TRIPLE COMPLETION?
dual

NOTE: IF THIS IS A MULTIPLE COMPLETION, FURNISH A SEPARATE REPORT FOR EACH COMPLETION

WAS WELL DIRECTIONALLY DRILLED?
no

WAS DIRECTIONAL SURVEY MADE?
no

WERE 3 COPIES FILED WITH THE OFFICE OF CONSERVATION?

DATE FILED

TYPE OF ELECTRICAL OR OTHER LOGS RUN (CIRCLE LOGS FILED WITH OFFICE OF CONSERVATION)
triple combo log - CBL

DATE FILED
with this report

CASING, LINER AND TUBING RECORD

C	CASING SIZE	HOLE SIZE	CASING WEIGHT	DEPTH SET		SACKS CEMENT	TEST PRESSURE	HOURS UNDER PRESSURE	DATE TESTED (MM DD YY)	NAME OF TEST WITNESS - STATE IF CONSERVATION AGENT OR OFFSET OPERATOR	
				FROM	TO						
101	10 3/4	14 3/4	40.5	surf	2500	1050	1525		8-4-87	Steve Stevens	
102	7 5/8	9 7/8	33.7	surf	10,500	710	2700		8-14-87	Steve Stevens	
103											
104											
105											
TUBING SIZE		2 3/8		DEPTH OF TUBING		9910		DEPTH OF PACKER(S)		9910	

INITIAL COMPLETION OR RE-COMPLETION DATA

INITIAL PRODUCTION
30

GAS VOLUME
BOPD **1563**

GOR
MCF/DAY **52,100**

CHOKE SIZE
CF/88L **13** /64"

PRODUCING METHOD
flowing

FLOWING TUBING PRESSURE
PSIG **2138**

SHUT-IN TUBING PRESSURE
PSIG **2683**

CASING PRESSURE
PSIG **0**

WATER PRODUCTION
BPD **6**

BS&W
%

GRAVITY
.6131

BHP (SHUT-IN)
PSIG **3542**

COMPANY REPRESENTATIVE
Steve Stevens

DATE GAUGED
9-22-87

PLUG AND ABANDON (P & A) DATA

CASING SIZE	AMOUNT PULLED	CEMENT PLUGS				DATE WORK PERFORMED	NAME OF TEST WITNESS - STATE IF CONSERVATION AGENT OR OFFSET OPERATOR
		FROM	TO	SACKS	HOW PLACED		

CERTIFICATE: I, the undersigned, state that I am employed by **Wayman W. Buchanan** and that I am authorized to make this report, and that this report was prepared under my supervision and direction and that all facts stated herein are true, correct and complete to the best of my knowledge.

Signature: *[Signature]* Title: **Operations Manager**

*Date well is equipped to produce, but due to no available market, no pipe line connection, etc., the well has been shut-in.

WORK RESUME

List below all work performed under Office of Conservation Work Permits while drilling and completing well

WORK PERMIT NO	DATE WORK PERFORMED	SERVICE COMPANY	DESCRIPTION OF WORK
L3246-87	9-12-87	Schlumberger	Perforate for production: 10,029 - 10,034'

List below all important Paleofaunal or Geological Formation tops, Cap Rock and Salt Overhang bottoms.

FORMATION	DEPTH	FORMATION	DEPTH

RECEIVED
 OCT 05 1987
 DEPT. OF CONSERVA
 WELL FILES
 BATON ROUGE, LA.

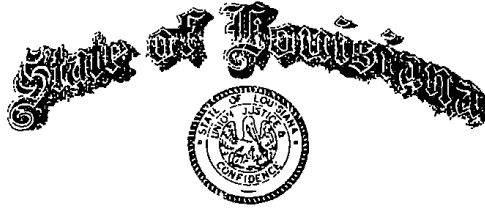

205761

EDWIN W. EDWARDS
GOVERNOR
B. JIM PORTER
SECRETARY

DEPARTMENT OF NATURAL RESOURCES

HERBERT W. THOMPSON
ASSISTANT SECRETARY
AND
COMMISSIONER

OFFICE OF CONSERVATION
INJECTION AND MINING DIVISION

December 10, 1987

Wayman W. Buchanan
P. O. Box 397
Schriever, LA 70395

ATTN: Glenn Bergeron

RE: WELL WALKER
SERIAL 205761 WELL NO 001
FIELD LAKESIDE.
PARISH CAMERON SEC/TWN/RNG 019/12S/04W
APPL NO 005353
FOR Annular Disposal

Gentlemen:

This Office has reviewed the Radioactive Tracer Survey run on the above referenced well.

We find the survey demonstrates well integrity and hereby give temporary approval for annular injection. Only water produced from this well may be injected into the annulus of this well. No injection of water produced elsewhere is allowed. The Office of Conservation must be contacted 30 days in advance of the expiration date, which is one year (December 10, 1988) from the date of this letter, to obtain approval for continued disposal.

Attached, for your information, are reporting requirements relating to injection in the above referenced well.

Sincerely,

HERBERT W. THOMPSON, COMMISSIONER
Office Of Conservation

A handwritten signature in cursive script that reads 'James H. Welsh'.

James H. Welsh, Director
Injection And Mining Division

CC: Lake Charles

Attachments

ANNULAR DISPOSAL REPORTING REQUIREMENTS

A reasonable estimate of the amount of salt water injected annually into the disposal well must be reported to the Injection and Mining Division at the address below and a copy sent to the appropriate Conservation District Office. This report is to be filed on Form UIC-10 during the first quarter of the next calendar year.

Office of Conservation
Injection & Mining Division
P.O. Box 94275
Baton Rouge, LA 70804-9275

CONSERVATION
USE ONLY

~~XX~~ Change

8711 Effective
yymm

AMENDMENT ACTION

- 0.0.0 PARISH
- 0.3.4 FIELD
- 0.8.0 OPERATOR
- 0.1.6 LSE-UN
- 0.1.6 UN-LSE
- 0.1.6 LSE-LSE
- 0.1.6 UN-UN
- 0.1.4 WELL NO.
- 5.2.1 LOCATION

FORM MD-15-R
(R 2-1976)

AMENDED PERMIT TO DRILL FOR MINERALS

STATE OF LOUISIANA
DEPARTMENT OF CONSERVATION
Amended Permit \$75.00

205761 Serial No. L Date January 12, 1988

CURRENT CODES

012 PARISH Cameron
 5772 FIELD Lakeside
 2978 OPERATOR Hydrocarbon Mgmt., Inc.*
 ADDRESS 444 Petroleum Commerce Bldg.
 CITY & STATE San Antonio, TX 78205

FORMER CODES

0848

205761 WELL NAME Walker No. 1

LOCATION OF WELL: Sec. 19 T 12S R 4W Former Well No.
*Wayman W. Buchanan

Applicable Department of Conservation Order

Herbert W. Thompson
Commissioner

[Signature]
Issuing Authority

WELL FILE COPY

No. 109019 A

out to Phil
Jo Sen

STATE OF LOUISIANA
OFFICE OF CONSERVATION
LOUISIANA STATE POTENTIAL REPORT

District LACAYETTE INPUT TYPE
 Field Lake Side 1 - OC Only
 Parish Cameron Hydrocarbon Mgmt Code 2 2 - Original
 Operator WATSON BOURGEOIS Code 0948 3 - Correction
 Sec. 19 TWP. 12 RGE. 4W Test Date 1 / 29 / 88
 12 Mo. Day Yr.

TYPE OF WELL TYPE OF TEST PRODUCING METHOD
 1-OIL 1- COMPLETION F-FLOWING
 2-GAS 2-RECOMPLETION P-PUMPING
 18 19 3-RETEST 20 G-GASLIFT

WELL SERIAL NO.	WELL NAME	WELL NO.	NAME OF RESERVOIR
205761	Walker	1	10 100 STRAY SAND

TOTAL DEPTH	PERFORATED INTERVAL FROM TO	CHOKE /64"	OIL BBL/DAY	COND. BBL/DAY	GAS MCF/DAY	GAS/OIL RATIO CF/BBL
10226	10024 10034	9.5	-	15	1250 MCF	83333/1
33 PBD	38 43	48	51	57	63	69

API GRAV. @60°F.	WATER BBL/DAY	BS&W%	FLOWING PRES. (PSIG)	CASING PRES. (PSIG)	DATE OF COMPLETION MO. DAY YR.
51	0	110	2400	50	11 20 87
76	80	86	89	95	101 on line

PERMIT SECTION

CLOSE TANK / METER GAUGE 2 3/4" @ 9am TIME
 OPEN TANK / METER GAUGE 0000" @ 9am TIME
 DIFFERENCE 2 3/4 in HOURS
 TANK / METER NO. 91750 TANK COEF. 5.41

STATIC PRES. 615 DIFFERENTIAL PRES. 53 LINE SIZE 2"
 PLATE SIZE 1 COEFFICIENT " METER SPRING & DIFF. RANGE 1500 X 100
 REMARKS _____

WITNESSED BY Joe Jones GAUGED BY C. C. Bourgeois
 TITLE _____ TITLE _____



EDWIN W. EDWARDS
GOVERNOR
B. JIM PORTER
SECRETARY

DEPARTMENT OF NATURAL RESOURCES

OFFICE OF CONSERVATION

Date March 17, 1988

HERBERT W. THOMPSON
ASSISTANT SECRETARY
AND
COMMISSIONER

Office of Conservation
Attn: Mr. W. J. Clark
P.O. Box 94275 Capitol Station
Baton Rouge, La. 70804-9275

Dear Mr. Clark:

Enclosed herewith please find application from

Hydrocarbon Mgmt., Inc. for permit to amend their
well name from Walker #1 to
9950 RA SUA;Walker #1, Serial # 205761,
Field Lakeside, Parish Cameron.

 Check No forwarded under separate cover to the accounting
section in Baton Rouge, La. A copy of this check is
attached.

1/19/88 The effective date of this change.

GAS The Product of this well.

 A Copy of location plat is attached.

X No fee required for this change. Change being made per
Office of Conservation Order # 113-0.

Yours very truly,
Gerard E. LeBlanc
Gerard E. LeBlanc, Manager
Lafayette District

GEL

Encls.

CC: Audit Section
Baton Rouge, La.

DEPT. OF CONSERVATION
USE ONLY

Change
 Correction
8801 Effective Date
yy/mm
9999 End Date
yy/mm

AMENDMENT ACTION

- 0.0.9 [1] PARISH
- 0.3.4 [2] FIELD
- 0.3.5 [3] OPERATOR
- ~~0.1.6~~ [4] LSE-UN
- 0.1.6 [5] UN-LSE
- 0.1.6 [6] LSE-LSE
- 0.1.6 [7] UN-UN
- 0.1.4 [8] WELL NO.
- 5.2.1 [9] LOCATION

FORM MD-15 RC
(11-2-1976)

AMENDED PERMIT TO DRILL FOR MINERALS (CORRECTED)

STATE OF LOUISIANA
DEPARTMENT OF CONSERVATION
Amended Permit (Corrected)

205761 Serial No L Date March 24, 1988

CURRENT CODES

012 PARISH Cameron

5772 FIELD Lakeside

2978 OPERATOR Hydrocarbon Mgmt., inc.

ADDRESS 444 Petroleum Commerce Bldg.

CITY & STATE San Antonio, TX 78205

FORMER CODES

610152 WELL NAME 9950 RA SUA;Walker* No 1 205761

LOCATION OF WELL: Sec. 19 T 12S R 4W Former Well No

Location same. *Walker

Applicable Department of Conservation Order 113-0

Jos Salcedo Commissioner de *J. Feluk* Issuing Authority

No. A-C

WELL FILE COPY



OFFICE OF CONSERVATION
WELL HISTORY AND WORK RESUME REPORT

FIELD
Lakeside

SERIAL NO.
205761

PRODUCING INTERVAL
10,029' - 10,034'

RESERVOIR (COMPANY SAND IDENTIFICATION)
10,100' Stray Sand

Three typewritten copies of this report must be filed with the District Office of the Office of Conservation in which the well is located within twenty (20) days of the date of completion. NOTE: If not properly completed and signed this report will be returned.

LEASE AND WELL DATA

CHECK APPROPRIATE BOXES

NEW WELL Correction

RECOMPLETION

P & A

31 INACTIVE DRY HOLE FUT. UTIL.

32 INACTIVE DRY HOLE NO FUT. UTIL.

36 INACTIVE WAITING ON PIPELINE

37 INACTIVE WAITING ON MARKET

PRODUCT

OIL

GAS

OTHER

IF RECOMPLETION

SAME RESERVOIR

DIFFERENT RESERVOIR

DATE COMP. RECOMP. OR P & A M D Y

OPERATOR
Hydrocarbon Management, Inc.

CODE
2978

ADDRESS
**444 Petroleum Commerce Bldg.
San Antonio, TX 78205**

WELL NAME
Walker

WELL NO.
1

PARISH
Cameron

SEC. **19** TWP. **12S** RGE. **4W**

DATE PERMIT ISSUED
9/16/87

DATE SPUNDED
8/2/87

DATE READY TO PRODUCE*
9/21/87

TOTAL DEPTH
12,505'

PBTD
10,226'

GROUND ELEVATION
2'

CASING HEAD FLANGE ELEVATION
8'

DISTANCE FROM RKB TO CHF
33.2'

DATE WELL TURNED INTO TANKS
11/20/88

SINGLE, DUAL OR TRIPLE COMPLETION?
dual

NOTE: IF THIS IS A MULTIPLE COMPLETION, FURNISH A SEPARATE REPORT FOR EACH COMPLETION

WAS WELL DIRECTIONALLY DRILLED? **no**

WAS DIRECTIONAL SURVEY MADE? **no**

WERE 3 COPIES FILED WITH THE OFFICE OF CONSERVATION?

DATE FILED

TYPE OF ELECTRICAL OR OTHER LOGS RUN (CIRCLE LOGS FILED WITH OFFICE OF CONSERVATION)

Triple combo log - CBL

DATE FILED
9/25/87

CASING, LINER AND TUBING RECORD

C	CASING SIZE	HOLE SIZE	CASING WEIGHT	DEPTH SET		SACKS CEMENT	TEST PRESSURE	HOURS UNDER PRESSURE	DATE TESTED (MM DD YY)	NAME OF TEST WITNESS - STATE IF CONSERVATION AGENT OR OFFSET OPERATOR	
				FROM	TO						
101	10 3/4	14 3/4	40.5	surf	2500	1050	1525		8/4/87	Steve Stevens	
102	7 5/8	9 7/8	33.7	surf	10,500	710	2700		8/14/87	Steve Stevens	
103											
104											
105											
TUBING SIZE		2 3/8		DEPTH OF TUBING		9910		DEPTH OF PACKER(S)		9910	

INITIAL COMPLETION OR RE-COMPLETION DATA

INITIAL PRODUCTION

30 BOPD

GAS VOLUME

1563 MCF/DAY

GOR

52,100 CF/BBL

CHOKE SIZE

13/64"

PRODUCING METHOD

flowing

FLOWING TUBING PRESSURE

2138 psig

SHUT-IN TUBING PRESSURE

2683 psig

CASING PRESSURE

0

WATER PRODUCTION

6 BPD

BS&W

%

GRAVITY

.6131

BHP (SHUT-IN)

3542 psig

COMPANY REPRESENTATIVE

Steve Stevens

DATE GAUGED

9/22/87

PLUG AND ABANDON (P & A) DATA

CASING SIZE	AMOUNT PULLED	CEMENT PLUGS				DATE WORK PERFORMED	NAME OF TEST WITNESS - STATE IF CONSERVATION AGENT OR OFFSET OPERATOR
		FROM	TO	SACKS	HOW PLACED		

Hydrocarbon Management

CERTIFICATE: I, the undersigned, state that I am employed by **Hydrocarbon Management, Inc.** and that I am authorized to make this report, and that this report was prepared under my supervision and direction and that all facts stated herein are true, correct and complete to the best of my knowledge.

Signature: *[Signature]* Title: **Operations Manager**

*Date well is equipped to produce, but due to no available market, no pipe line connection, etc., the well has been shut-in.

WORK RESUME

List below all work performed under Office of Conservation Work Permits while drilling and completing well.

WORK PERMIT NO.	DATE WORK PERFORMED	SERVICE COMPANY	DESCRIPTION OF WORK
L3246-87	9/12/87	Schlumberger	Perforate for production: 10,029 - 10,034'

List below all important Paleofaunal or Geological Formation tops, Cap Rock and Salt Overhang bottoms.

FORMATION	DEPTH	FORMATION	DEPTH
		<p style="text-align: center;"> RECEIVED MAY 09 1988 DEPT. OF CONSERVATION LAFAYETTE, LOUISIANA </p>	

STATE OF LOUISIANA
OFFICE OF CONSERVATION
AMENDED PERMIT TO DRILL FOR MINERALS

(CORRECTED)

205761 SERIAL NO DATE 08/10/94 EFFECTIVE 03/12/94

CURRENT CODES

012 PARISH	CAMERON	DISTRICT LAFAYETTE
5772 FIELD	LAKESIDE	
2978 OPERATOR	HYDROCARBON MGMT., INC.	
2 PRODUCT	12500 SAN PEDRO AVE.	
MA	SUITE 550	
	SAN ANTONIO, TEXAS	78216

3-205761 WELL NAME WALKER	NO. 001
LOCATION OF WELL SEC 019 T 12S R 04W	
FORMER WELL NAME: 9950 RA SUA;WALKER	2-610152

APPLICABLE OFFICE OF CONSERVATION ORDER

H. W. THOMPSON

FELIX J. BOUDREAUX

COMMISSIONER

ISSUING AUTHORITY

WELL FILE



EDWIN W. EDWARDS
GOVERNOR

JOHN F. ALES
SECRETARY

DEPARTMENT OF NATURAL RESOURCES
May 13, 1994

H. W. THOMPSON
COMMISSIONER AND
ASSISTANT SECRETARY

OFFICE OF CONSERVATION
ATTN: PERMIT SECTION
P. O Box 94275
BATON ROUGE, LA 70804-9275

Dear Mr Boudreaux:

Enclosed herewith please find application from **Hydrocarbon Management, Inc.** for permit to amend their well name from 9950 RA SUA;Walker to Walker #001, Serial # 205761, Lakeside Field, Cameron Parish.

Check No. forwarded under separate cover to the Accounting Section in Baton Rouge.

03-12-94 The effective date of this change.

gas The product of this well.

Voluntary Unit Affidavit and Plat attached.

X A copy of location plat is attached.

Attachment for Mr. Boudreaux.

X No fee required for this change. Change being made per Office of Conservation Order No.

Yours very truly,

A handwritten signature in cursive script that reads "John E. Caldwell, Jr.".

John E Caldwell. Jr., Manager (Acting)
Lafayette District

JEC:mbv
Encls.
cc: Prod Audit/Anita Hebert
Baton Rouge, LA

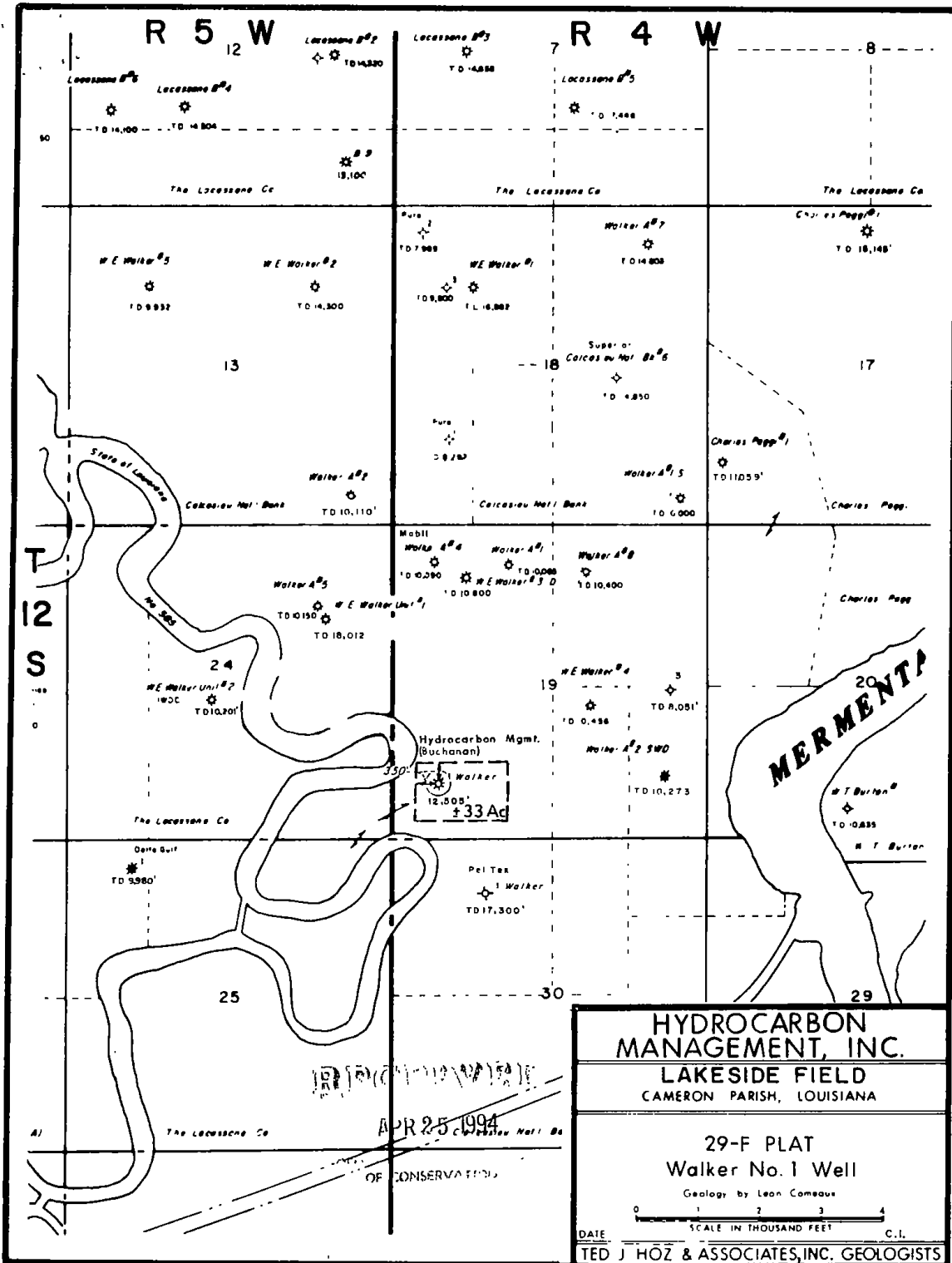

29-E COMPLIANCE	YES	NO
29-E UNIT ATTACHED	YES	NO
O.C. USE ONLY		

STATE OF LOUISIANA
OFFICE OF CONSERVATION
WELL COMPLETION OR RECOMPLETION REPORT

DISTRICT LAFAYETTE

CODE NUMBERS: <u>012</u>	DATE <u>04/20/94</u>	<input type="checkbox"/> 1 - ON-SHORE
<u>5972</u>	PARISH <u>CAMERON</u>	<input checked="" type="checkbox"/> 3 - OFF-SHORE
<u>8778</u>	FIELD <u>LAKESIDE</u>	SEC. <u>19</u> T <u>12-S</u> R <u>4-W</u>
<u>11617</u>	OPERATOR <u>HYDROCARBON MANAGEMENT, INC.</u>	OC ORDER NO. _____
<u>11617</u>	WELL NAME <u>WALKER</u>	NO. <u>1</u> SERIAL NO. <u>205761</u>
	RESERVOIR <u>LOWER 9800'</u>	COMPLETION DATE <u>03/12/94</u> TIME <u>12:30</u> <input type="checkbox"/> AM <input checked="" type="checkbox"/> PM

IMPORTANT: IS A FORM MD-10-R-A BEING FILED WITH THIS REPORT? IF NO, EXPLAIN YES NO

REMARKS: NOT REQUIRED

COMPLETION DATA:

* TYPE COMPLETION	PRIMARY PRODUCT	PRIMARY PRODUCT CHANGE?	PRODUCING METHOD	STATUS OF WELL
<input checked="" type="checkbox"/> 1 - ORIG COMP. <input type="checkbox"/> 2 - RE-COMP.	<input checked="" type="checkbox"/> 1 - OIL <input type="checkbox"/> 2 - GAS <input type="checkbox"/> 3 - DRY GAS	<input checked="" type="checkbox"/> 1 - YES <input type="checkbox"/> 2 - NO	<input type="checkbox"/> F - FLOWING <input type="checkbox"/> GL - GAS LIFT <input type="checkbox"/> P - PUMPING	<input type="checkbox"/> 1 <input type="checkbox"/> 0 SEE REVERSE SIDE FOR CODE

* IF THIS IS A RE-COMPLETION SPECIFY: SAME RESERVOIR DIFFERENT RESERVOIR

<u>1</u> INITIAL PROD. BOPD	<u>700</u> GAS VOLUME MCF/DAY	<u>1275</u> FLOWING TUBING PRESSURE PSIG	<u>1625</u> SHUT-IN TUBING PRESSURE PSIG	_____ CASING PRESSURE PSIG
<u>1G /64"</u> CHOKE SIZE	<input checked="" type="checkbox"/> 1 - POSITIVE <input type="checkbox"/> 2 - ADJUST	<u>2</u> WATER PROD. BPD	_____ BS & W %	<u>700,000</u> GOR CF/BBL
				<u>55.9</u> API AT 60°F GRAVITY

PERFORATIONS 9960 - 9963' TOTAL DEPTH 12,505'

CLEARANCE & CERTIFICATION:

ADDITIONAL CLEARANCE IS REQUESTED FOR _____ BBLs OF OIL PRODUCED ON DRILL-STEM OR OTHER PRODUCTION TEST: (SEE SECTION X PARAGRAPH B OF ORDER 29-B ON REVERSE SIDE).

CERTIFICATION

I HEREBY CERTIFY THAT THE ABOVE INFORMATION IS TRUE AND CORRECT TO THE BEST OF MY KNOWLEDGE.

RECEIVED

MAY 23 1994

INSTRUCTIONS

THREE (3) COPIES TO BE FILED WITH THE DISTRICT OFFICE WITHIN THREE (3) DAYS OF DATE OF COMPLETION OR RECOMPLETION (AS PER ORDER 29-B, SECTION X, PARAGRAPH A, ARTICLE 1).

Colman J. Krueger
SIGNATURE
HYDROCARBON MANAGEMENT, INC.
OPERATOR
PRODUCTION ADMINISTRATOR
TITLE

STATE OF LOUISIANA
OFFICE OF CONSERVATION
AMENDED PERMIT TO DRILL FOR MINERALS

...\$105.00

205761 SERIAL NO DATE 09/09/98 EFFECTIVE 08/01/98

CURRENT CODES

012 PARISH	CAMERON	DISTRICT LAFAYETTE
5772 FIELD	LAKESIDE	
3466 OPERATOR	LINDER OIL CO. A PARTNERSHIP	
2 PRODUCT	1800 CAROL SUE AVENUE	
LN000085 MA	SUITE 6	
	GRETNA, LA	70056

3-205761 WELL NAME WALKER NO. 006
LOCATION OF WELL SEC 019 T 12S R 04W
FORMER OPERATOR NAME: ALEGRE ENERGY, INC. A122
FORMER WELL NUMBER: 001

APPLICABLE OFFICE OF CONSERVATION ORDER 29B

PHILIP N. ASPRODITES

TODD KEATING

COMMISSIONER OF CONSERVATION

ISSUING AUTHORITY

WELL FILE

STATE OF LOUISIANA
OFFICE OF CONSERVATION
AMENDED PERMIT TO DRILL FOR MINERALS

(CORRECTED)

205761 SERIAL NO.

DATE 10/31/2000

EFFECTIVE 01/01/2001

CURRENT CODE

12 PARISH CAMERON
5772 FIELD LAKESIDE
3466 OPERATOR LINDER OIL CO. A PARTNERSHIP
20 PRODUCT 1800 CAROL SUE AVENUE
SUITE 6
GRETNA, LA 70056-0000

LAFAYETTE DISTRICT

7-303569 WELL NAME WALKER
LOCATION OF WELL SEC 019 T 12S R 04W M W
FORMER WELL NAME:WALKER 006

NO. 006

3-205761

APPLICABLE OFFICE OF CONSERVATION ORDERS:

PHILIP N. ASPRODITES

TODD KEATING

COMMISSIONER OF CONSERVATION

ISSUING AUTHORITY

WELL FILE