

C. L. JACK STELLY & ASSOCIATES, INC. LAFAYETTE, LA. 70505

| INVOICE NUMBER | INVOICE DATE | DESCRIPTION | GROSS | DISCOUNT | NET AMOUNT |
|----------------|--------------|---|-------|----------|------------|
| | | WAYMAN W. BUCHANAN, INC. WALKER NO. 2 SEC. 19, T12S - R4W LAKESIDE FIELD CAMERON PARISH, LA | | | |

| | | |
|---|--------------|--------------------------------------|
| C. L. JACK STELLY & ASSOCIATES, INC. P. O. BOX 53353 LAFAYETTE, LA 70505 | | No. 19097 8440 652 |
| DATE | CHECK NUMBER | AMOUNT |
| May 17, 1988 | 19097 | 500.00 |
| Five hundred dollars and no cent | | |
| PAY TO THE ORDER OF La. Department of Conservation | | C. L. JACK STELLY & ASSOCIATES, INC. |
| FIRST NATIONAL BANK LAFAYETTE, LOUISIANA | | <i>C. L. Jack Stelly</i> |
| ⑈019097⑈ ⑈065200405⑈ ⑈0165288⑈ | | |

208325

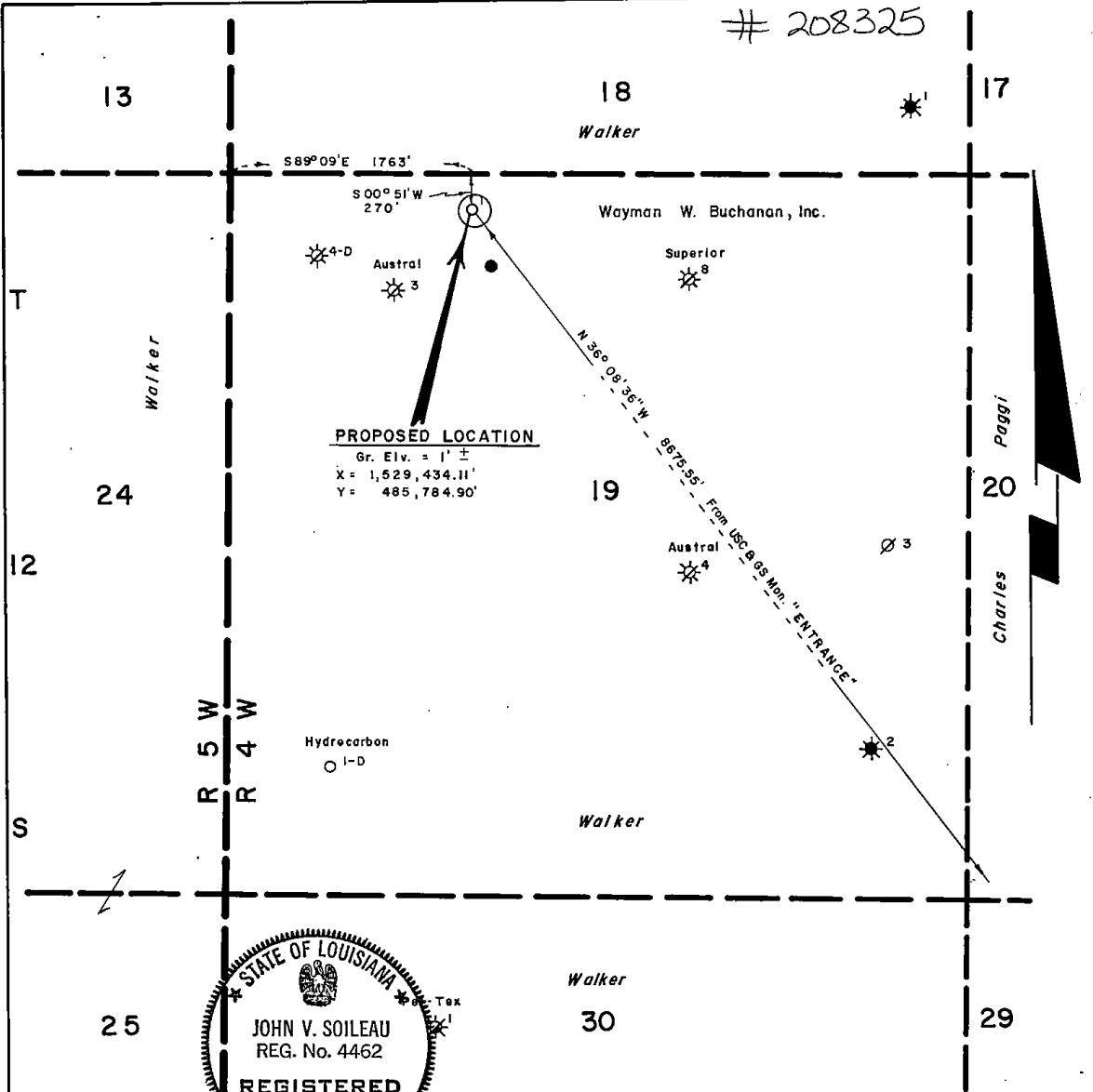

PROPOSED LOCATION
 Gr. Elev. = 1' ±
 X = 1,529,434.11'
 Y = 485,784.90'



NOTE: NO RESIDENTIAL OR COMMERCIAL STRUCTURES WITHIN 500' OF PROPOSED LOCATION WHICH ARE NOT OWNED BY APPLICANT OR HIS LESSOR.

I, John V. Soileau, hereby certify that the loc'n. of Wayman W. Buchanan, Inc.'s Walker No. 1 is as follows: N 36° 08' 36" W 8675.55' from USC & GS Mon. "ENTRANCE" falling in Sec. 19, T 12 S - R 4 W, Cameron Parish, Louisiana.

John V. Soileau
 REGISTERED LAND SURVEYOR NO. 4462
 STATE OF LOUISIANA
 C.L. JACK STELLY & ASSOCIATES, INC.

LOUISIANA DEPT. OF CONSERVATION

WAYMAN W. BUCHANAN, INC.

PERMIT PLAT

CAMERON PARISH, LOUISIANA

Scale: 1" = 1,000'

MAY 17, 1988

PERMIT TO DRILL FOR MINERALS

\$500
PERMIT ~~\$200.00~~
Multiple Zone Processing

STATE OF LOUISIANA
OFFICE OF CONSERVATION

ATT

Send To Lafayette/19 Date May 18, 1988
Serial No. Ser#208325 APT#1702322412
Parish Cameron 012 Field Lakeside 5772

Operator Wayman W. Buchanan, Inc. 2533
Address Petroleum Commerce Bldg., Ste 444
City & State San Antonio, TX 78205
Well Name Walker No.1

Location Sec 19, T12S, R.
N 36 deg 08' 36" W 8675.55' fr USC&GS Mon "ENTRANCE" falling
in Sec 19, T12S, R4W. X=1,529,434.11 Y=485,784.90

PTD 10,200'

Zone or Reservoir of Proposed Completion Any Productive Sd
Applicable Office of Conservation Order 29B, 29E, 113 Series

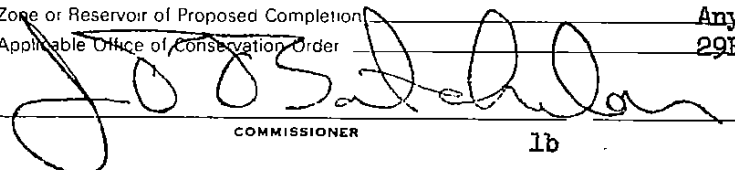
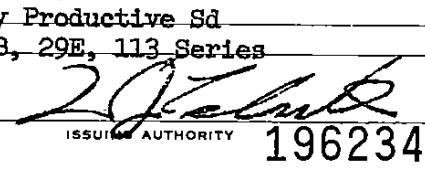
 COMMISSIONER
 ISSUING AUTHORITY

1b

196234

STATE OF LOUISIANA
OFFICE OF CONSERVATION

Inter Office

Date: May 18, 1988

To: W. J. Clark
From: Gerard E. LeBlanc, Manager
Attn: W. J. Clark

Enclosed herewith please find application from Wayman W. Buchanan, Inc.
_____ for permit to drill
their Walker #1, Lakeside Field
Cameron Parish, Louisiana. Zone _____

Also enclosed please find:

Check No. 19097 in the amount of \$ 500.00.

XX Well location plat
_____ Well location certification

_____ Form A.D.C.
_____ Electric Log
_____ Schematic diagram
_____ (Dual) structure map if well does not comply with existing Orders
_____ (Selective-Onshore) structure map showing reservoir limits
_____ (Selective-Offshore) letter(s) of no objection from offset operators

29-B-1 Letter
29-E Letter
29-E Unit Letter
Comply w/ 113 Series Letter

Applicable Department of Conservation Order No. 29-B, 29-E, 113 Series.

Pending Hearing, Docket No. _____.

Remarks & Recommendations: **ROUTINE; INCLINATIONAL OR DIRECTIONAL SURVEY REQUIRED.**

By GE LeBlanc-RCH
District Manager

cc: Geological Oil & Gas Division
Prod. Audit (for Amended Permits only)

LT-1



State of Louisiana

DEPARTMENT OF NATURAL RESOURCES

BUDDY ROEMER
GOVERNOR

RAYMOND W. STEPHENS, JR.
SECRETARY

MAY 18, 1988

WAYMAN W. BUCHANAN, INC.
PETROLEUM COMMERCE BLDG.
SUITE 444
SAN ANTONIO, TX 78205

RE: CAMERON PARISH
LAKESIDE FIELD
WALKER NO. 1
SER NO. 208325

GENTLEMEN:

WE ARE ISSUING PERMIT TO DRILL FOR THE ABOVE REFERENCED WELL WITH THE UNDERSTANDING THAT YOU WILL FURNISH THE APPROPRIATE DISTRICT MANAGER WITH A DIRECTIONAL SURVEY AS PROOF THAT THE WELL HAS BEEN DRILLED IN COMPLIANCE WITH THE PROVISIONS OF STATEWIDE ORDER NO. 29-B, SECTION XVIII, PARAGRAPH 3, DATED MARCH 1, 1967.

IN ADDITION, THERE CAN BE NO COMPLETION IN ANY POOL IN WHICH THE LOCATION IS NOT IN COMPLIANCE WITH THE PROVISIONS OF STATEWIDE ORDER NO. 29-E. IN THE EVENT THE WELL IS A PRODUCER, NO ALLOWABLE WILL BE ASSIGNED UNTIL A SUITABLE UNIT HAS BEEN FORMED IN COMPLIANCE WITH THE PROVISIONS OF STATEWIDE ORDER NO. 29-E.

ALSO, THERE CAN BE NO COMPLETION IN ANY RESERVOIR WHICH IS NOT IN COMPLIANCE WITH THE PROVISIONS OF THE LOUISIANA OFFICE OF CONSERVATION ORDERS OF THE 113 SERIES, FOR THE ABOVE CAPTIONED FIELD AND PARISH.

VERY TRULY YOURS,

J. PATRICK BATCHELOR, COMMISSIONER
OFFICE OF CONSERVATION

BY

A handwritten signature in cursive script, appearing to read "W. J. Clark", written over a horizontal line.

WILLIAM J. CLARK
PETROLEUM ENGINEER SUPERVISOR 1

WJC:SM

CC: GERARD LEBLANC
LAFAYETTE, (ACTING) DIST. MGR
OFFICE OF CONSERVATION P.O. BOX 94275 BATON ROUGE, LOUISIANA 70804-9275

AN EQUAL OPPORTUNITY EMPLOYER



BUDDY ROEMER
GOVERNOR

State of Louisiana

DEPARTMENT OF NATURAL RESOURCES
OFFICE OF CONSERVATION
P. O. BOX 51285
LAFAYETTE, LA. 70505

RAYMOND W. STEPHENS, JR.
SECRETARY

May 18, 1988

Wayman W. Buchanan, Inc.
Petroleum Commerce Building, Suite 444
San Antonio, TX 78205

ATTN: Don Delaney

GENTLEMEN:

We have processed and forwarded to Baton Rouge for final approval your application to drill the: Walker #1, Lakeside Field, Cameron Parish

Statewide Order No. 29-B issued by the Commissioner of Conservation of July 19, 1943 required:

1. No well shall be drilled, nor shall the drilling of a well be commenced, before a permit for such well has been issued by the Office of Conservation.
2. A progress report shall be filed, either written or by telephone, with the district office by TUESDAY of each week. INCLUDE RIG NAME & NUMBER AND RIG TELEPHONE NUMBER ON INITIAL REPORT!
3. No well shall commence drilling below surface casing until a sign has been posted on the derrick and subsequently on the well.
4. The completion report must be filed within three (3) days after date of completion. The electric logs (Composite 1" = 100') must be filed in duplicate ten (10) days after the completion of the well. The well history (WH-1) must be filed in triplicate twenty (20) days after the completion of the well on forms provided by this department.
5. IN THE EVENT YOU USE A CONSULTANT OR A DRILLING CONTRACTOR ON A TURNKEY BASIS, PLEASE SEE THAT HE IS FURNISHED A COPY OF THESE INSTRUCTIONS!
6. Contact Joe Durham, Conservation Enforcement Agent for the Office of Conservation at telephone 318-824-3837 or at P.O. Box 112 Jennings, LA 70546 for further information.

Yours very truly,

Gerard LeBlanc - RdH
Gerard LeBlanc, District Manager
Lafayette District

GEL:jcl

cc:

LAFAYETTE DISTRICT OFFICE 106 CALCO BOULEVARD LAFAYETTE, LOUISIANA 70503
AN EQUAL OPPORTUNITY EMPLOYER



OFFICE OF CONSERVATION
WELL HISTORY AND WORK RESUME REPORT

FIELD
Lakeside 5772

SERIAL NO
208325

PRODUCING INTERVAL

RESERVOIR (COMPANY SAND IDENTIFICATION)

Three typewritten copies of this report must be filed with the District Office of the Office of Conservation in which the well is located within twenty (20) days of the date of completion: NOTE: If not properly completed and signed this report will be returned.

LEASE AND WELL DATA

CHECK APPROPRIATE BOXES

NEW WELL

RECOMPLETION

P & A

31 INACTIVE DRY HOLE FUT. UTIL.

32 INACTIVE DRY HOLE NO FUT. UTIL.

36 INACTIVE WAITING ON PIPELINE

37 INACTIVE WAITING ON MARKET

PRODUCT

OIL

GAS

OTHER

IF RECOMPLETION

SAME RESERVOIR

DIFFERENT RESERVOIR

DATE COMP. RECOMP. OR P & A M D Y
6/9/88

OPERATOR
Wayman W. Buchanan Inc.

CODE
2533

ADDRESS
444 Petroleum Commerce Bldg. San Antonio, TX 78205

WELL NAME
Walker

WELL NO
1

PARISH
Cameron

SEC **19** TWP **12S** RGE **4W**

DATE PERMIT ISSUED
5/18/88

DATE SPUNDED
5/25/88

DATE READY TO PRODUCE*

TOTAL DEPTH
10,200'

PSTO

GROUND ELEVATION

CASING HEAD FLANGE ELEVATION

DISTANCE FROM RKB TO CHF

DATE WELL TURNED INTO TANKS

SINGLE, DUAL OR TRIPLE COMPLETION?

NOTE: IF THIS IS A MULTIPLE COMPLETION, FURNISH A SEPARATE REPORT FOR EACH COMPLETION

WAS WELL DIRECTIONALLY DRILLED?
no

WAS DIRECTIONAL SURVEY MADE?

WERE 3 COPIES FILED WITH THE OFFICE OF CONSERVATION?

DATE FILED

TYPE OF ELECTRICAL OR OTHER LOGS RUN (CIRCLE LOGS FILED WITH OFFICE OF CONSERVATION)

DATE FILED

Triple Combo Log with this report

CASING, LINER AND TUBING RECORD

| C | CASING SIZE | HOLE SIZE | CASING WEIGHT | DEPTH SET | | SACKS CEMENT | TEST PRESSURE | HOURS UNDER PRESSURE | DATE TESTED (MM DD YY) | NAME OF TEST WITNESS - STATE IF CONSERVATION AGENT OR OFFSET OPERATOR |
|-----|-------------|-----------|---------------|-----------|-------|--------------|---------------|----------------------|------------------------|---|
| | | | | FROM | TO | | | | | |
| 101 | 16" | | | 0 | 150' | | | | | |
| 102 | 10 3/4" | 14 3/4" | 40.5# | 0 | 2510' | 1380 | 1500# | 30 min | 5/27/88 | |
| 103 | | | | | | | | | | |
| 104 | | | | | | | | | | |
| 105 | | | | | | | | | | |

TUBING SIZE DEPTH OF TUBING DEPTH OF PACKER(S)

INITIAL COMPLETION OR RE-COMPLETION DATA

INITIAL PRODUCTION GAS VOLUME GDR CHOKE SIZE PRODUCING METHOD

BOPD MCF/DAY CF/BBL /84"

FLOWING TUBING PRESSURE SHUT-IN TUBING PRESSURE CASING PRESSURE WATER PRODUCTION BS&W

BHP (SHUT-IN) COMPANY REPRESENTATIVE DATE GAUGED

*API#60° F

PLUG AND ABANDON (P & A) DATA

| CASING SIZE | AMOUNT PULLED | CEMENT PLUGS | | | | DATE WORK PERFORMED | NAME OF TEST WITNESS - STATE IF CONSERVATION AGENT OR OFFSET OPERATOR |
|------------------------------------|---------------|--------------|-------|-------|------------|---------------------|---|
| | | FROM | TO | SACKS | HOW PLACED | | |
| 10 3/4" | 0 | 10,048' | 9043' | 760 | drill pipe | 6/7/88 | Steve Stephens |
| 10 3/4" | | 9000' | 8000' | 812 | drill pipe | 6/7/88 | Steve Stephens |
| Halco mud disposal pkr set @ 2450' | | | | | | | |

CERTIFICATE: I, the undersigned, state: That I am employed by **Wayman W. Buchanan Inc.** I am authorized to make this report, and that this report was prepared under my supervision and direction and that all facts stated herein are true, correct and complete to the best of my knowledge.

Signature: *[Signature]* Title: **Operations Manager**

*Date well is equipped to produce, but due to no available market, no pipe line connection, etc., the well has been shut-in.

WORK RESUME

List below all work performed under Office of Conservation Work Permits while drilling and completing well.

| WORK PERMIT NO. | DATE WORK PERFORMED | SERVICE COMPANY | DESCRIPTION OF WORK |
|-----------------|---------------------|-----------------|--|
| L1308,88 | 6/7/88 - 6/9/88 | Halliburton | Place cmt plug from 10,034' - 8,751'. Set mud disposal pkr @ 2,450'. Install dry hole tree & retain well for future use. |

List below all important Paleofaunal or Geological Formation tops, Cap Rock and Salt Overhang bottoms.

| FORMATION | DEPTH | FORMATION | DEPTH |
|-----------|-------|-----------|-------|
| | | | |

RECEIVED
 JUN 20 1988
 DEPT. OF CONSERVATION
 MONROE, LOUISIANA

JUN 20 1988
 DEPT. OF CONSERVATION
 MONROE, LOUISIANA

Mobil

PCO-193 TRAY (10-85)

1001283

PAY TO THE ORDER OF

MOBIL EXPLORATION & PRODUCING U.S. INC.
HOUSTON, TEXAS

DATE June 10, 1988

E012-197943

60-166/319

CHECK NUMBER
E012-197943

Office of Conservation
State of Louisiana

AMOUNT
\$150.00**

PHILADELPHIA NATIONAL BANK
CHESTER PA

James J. Cotton
NOT VALID FOR AN AMOUNT OF
\$****2,000 OR MORE UNLESS
MANUALLY COUNTERSIGNED.

⑈197943⑈ ⑆031901660⑆ 0033⑈1897⑈



7-18-88 11200A
THE BSN COMPANY

Mobil

FCO-183 TROY (10-88)

100283

PAY TO
THE
ORDER OF

MOBIL EXPLORATION & PRODUCING U.S. INC.
HOUSTON, TEXAS

DATE June 10, 1988

E012-197943

60-166/319

CHECK NUMBER
E012-197943

Office of Conservation
State of Louisiana

AMOUNT
\$150.00**

PHILADELPHIA NATIONAL BANK
CHESTER PA

Diane S. Catter
NOT VALID FOR AN AMOUNT OF
\$****2,000 OR MORE UNLESS
MANUALLY COUNTERSIGNED.

⑈197943⑈ ⑆031901660⑆ 0033⑈1897⑈





UIC-14

APPLICATION FOR ANNULAR DISPOSAL OF RESERVE PIT FLUIDS (Waste fluids produced during drilling or workovers)

OPERATOR: *MOBIL E&P NORTH AMERICA, INC. ADDRESS: P. O. BOX 51108, OCS
 WELL NAME & NO: WALKER B. NO. 1 LAFAYETTE, LA 70505
 SERIAL NO: 208325
 FIELD: LAKESIDE
 LOCATION: Sec. 19 T 12S R 4W CONTACT: SYDNIE M. DURAND (Name)
 PARISH: CAMERON (318) 988-5409 (Phone)

* * * * *

- 1) Method of disposal: a) Surface Casing Annulus Disposal Interval(s) 2450'
 b) Open hole
 c) Perforation
 d) Other, Explain _____
- 2) Operating Data: a) Estimated volume to be disposed: 50,000 Barrels
 b) Maximum injection pressure: 2,000 psi
- 3) Depth of Base of the Underground Source of Drinking Water: 1,200 Feet
- 4) Schematic Diagram of Well:

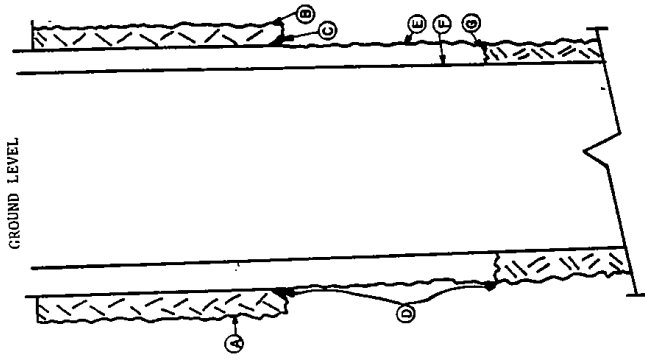

- A.) USDW - ± 1200'
- B.) SURFACE HOLE DIAMETER - 14-3/4"
- C.) SURFACE CSG - 10-3/4" @ 2510' W/
1380 SXS CLASS H CMT
- D.) DISPOSAL ZONE - 2450 +
- E.) LONGSTRING HOLE DIA. - OPEN HOLE
- F.) OPEN HOLE
- G.) TOP OF CEMENT - TO SURFACE

I, SYDNIE M. DURAND, E & R DEPARTMENT,
 (Name of Company Official) (Title)
 hereby certify that this application has been prepared under my supervision, and that all information contained herein is accurate and complete to the best of my knowledge, and that injection of waste fluids will not begin until approval from the Office of Conservation is granted.

SIGNATURE *Sydney Durand* DATE JUNE 28, 1988

| | | |
|----------------------------|---|---------------------|
| FOR CONSERVATION USE ONLY | | |
| USDW <u>900</u> ft. | | |
| Surf. Csg. <u>2510</u> ft. | Approval By <u><i>Sydney Durand</i></u> | Date <u>7-12-88</u> |
| | (Type or Print) | |

Drilling
eff 7/1/88

STATE OF LOUISIANA
OFFICE OF CONSERVATION
APPLICATION TO AMEND PERMIT TO DRILL FOR MINERALS

AMENDMENT ACTION: OPERATOR WELL NO. LOCATION

WELL NAME: LSE TO UN UN TO LSE LEASE UNIT

SERIAL # 208325 DATE 6-17-88 PSH CAMERON

FIELD LAKESIDE

OPERATOR MORIL E&P NORTH AMERICA, INC.

ADDRESS P. O. BOX 51108 - LAFAYETTE, LA 70505

WELL NAME WALKER B.

LOCATION OF WELL: SEC. 19 T 12S R 4W N 36° 08' 36" W

8475.55' FR USCGS MON. "ENTRANCE" FALLING IN SEC 17 T12S,

RAW X = 1,527,434.11 & Y = 485,784.90 Same

PRODUCT: OIL GAS

OPERATOR WAYMAN W. BUCHANAN, INC.

WELL NAME WALKER NO. 1

APPLICABLE DEPARTMENT OF CONSERVATION ORDER

BY *[Signature]* PHONE: A/C 318 981-5409

APPLICANT'S SIGNATURE & WITH NEPUS ACTING AS AGENT

ZONE OF COMPLETION:

APPROVED BY: *[Signature]* DATE July 12 19 88

MGR., DIST. OFFICE

APPROVED BY: *[Signature]* DATE 7-12-88

ISSUING AUTHORITY

| CODE NOS. | |
|-------------------|-------------------------------------|
| 012 | <input checked="" type="checkbox"/> |
| 5772 | <input checked="" type="checkbox"/> |
| 4072 | <input checked="" type="checkbox"/> |
| 208325 | |
| 2533 | <input checked="" type="checkbox"/> |
| 208325 | |



BUDDY ROEMER
GOVERNOR

State of Louisiana

DEPARTMENT OF NATURAL RESOURCES

July 12, 1988

RAYMOND W. STEPHENS, JR
SECRETARY

W. J. Clark
Office of Conservation
P.O. Box 94275 Capitol Station
Baton Rouge, La. 70804-9275

Dear Mr. Clark:

Enclosed herewith please find application to change the operator from Wayman W Buchanan Inc to Mobil E&P North America Inc and the well name from Walker # 1 to Walker B # 1, Lakeside field, Cameron Parish, Serial # 208325.

Enclosed also please find a copy of check # E012-197943 in the amount of \$150.00. The effective date of this change is 7-11-88 and this well is drilling, the product has not been established yet.

Yours very truly,

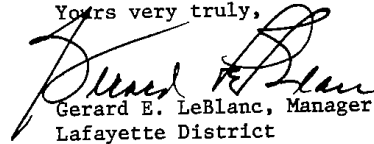
Gerard E. LeBlanc, Manager
Lafayette District

GEL;rr

Encls.

CC. Audit Section
Baton Rouge, La.

LAFAYETTE DISTRICT OFFICE 106 CALCO BOULEVARD LAFAYETTE, LOUISIANA 70503
AN EQUAL OPPORTUNITY EMPLOYER



BUDDY ROEMER
GOVERNOR

State of Louisiana

DEPARTMENT OF NATURAL RESOURCES

July 12, 1988

RAYMOND W. STEPHENS, JR
SECRETARY

W. J. Clark
Office of Conservation
P.O. Box 94275 Capitol Station
Baton Rouge, La. 70804-9275

Dear Mr. Clark:

Enclosed herewith please find application to change the operator from Wayman W Buchanan Inc to Mobil E&P North America Inc and the well name from Walker # 1 to Walker B # 1, Lakeside field, Cameron Parish, Serial # 208325.

Enclosed also please find a copy of check # E012-197943 in the amount of \$150.00. The effective date of this change is 7-11-88 and this well is drilling, the product has not been established yet.

Yours very truly,

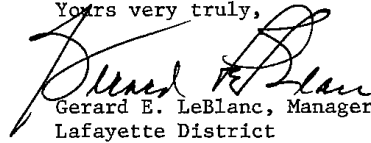
Gerard E. LeBlanc, Manager
Lafayette District

GEL;rr

Encs.

CC. Audit Section
Baton Rouge, La.

LAFAYETTE DISTRICT OFFICE 106 CALCO BOULEVARD LAFAYETTE, LOUISIANA 70503

AN EQUAL OPPORTUNITY EMPLOYER

- DEPT. OF CONSERVATION
USE ONLY

FORM MD-15-R
(R 2-1978)

AMENDED PERMIT TO DRILL FOR MINERALS

STATE OF LOUISIANA
DEPARTMENT OF CONSERVATION
Amended Permit \$150.00 ~~XXXXXX~~

~~XXX~~ Change

208325 Serial No. L Date July 18, 1988

8807 Effective
yy mm

CURRENT CODES

012 PARISH Cameron
5772 FIELD Lakeside
4072 OPERATOR Mobil E&P North America Inc.*
ADDRESS P.O. Box 51108
CITY & STATE Lafayette, LA 70505

FORMER CODES



2533

AMENDMENT ACTION

- 0.0.0 PARISH
- 0.3.4 FIELD
- ~~0.0.0~~ OPERATOR
- 0.1.6 LSE-UN
- 0.1.6 UN-LSE
- ~~0.0.0~~ LSE-LSE
- 0.1.6 UN-UN
- 0.1.4 WELL NO.
- 0.2.1 LOCATION

WELL NAME Walker B** No. 1
LOCATION OF WELL: Sec. 19 T. 12S R. 4W Former Well No.
*WAYMAN W. BUCHANAN, INC.
**WALKER

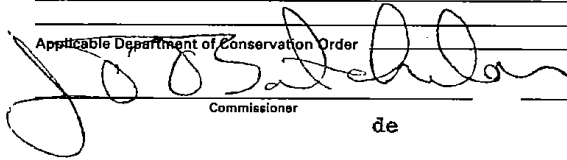
Applicable Department of Conservation Order

 Commissioner
 Issuing Authority

No. 112019 A

W/ F. L. (C) 2V

STATE OF LOUISIANA
OFFICE OF CONSERVATION
PLUG AND ABANDON REPORT

WORK PERMIT NO. LP#1107-89 WELL SERIAL NO. 208325
DATE WORK FINISHED (MM-DD-YY) 10-01-8

LAFAYETTE DISTRICT
(Three Copies to be Filed with the District Office)

NOTE: This Report Will Be Returned If Not Properly Completed And Signed:

Field LAKESIDE Parish CAMERON Sec. 19 Twp. 12S Rge. 4W

Operator MOBIL E&P NO AMERICA CODE-
4072 Well Name WALKER Well No. B-1

Total Depth 10,200' Condition of Well NO FUTURE UTILITY. WELL.

P&A'd 10-1-89

CHECK APPROPRIATE BOX:

- 29 DRY HOLE
 30 FORMERLY PRODUCTIVE WELL

| | CASING SIZE | AMOUNT PULLED | CEMENT PLUGS | | | |
|-----|-------------|---------------|--------------|-------|-------|----------------|
| | | | FROM | TO | SACKS | HOW PLACED |
| 301 | 10-3/4" | 0' | 2610' | 2400' | 115 | PUMPED 9/30/89 |
| 302 | 10-3/4" | 0 | 150' | 50' | 58 | PUMPED 10/1/89 |
| 303 | | | | | | |
| 304 | | | | | | |

Mud Record: Weight <9.0 PPG Viscosity _____

Remarks: TAGGED T.O.C. @ 2400'. CUT THE 10-3/4" AND 16" CSG'S 15' BELOW
MUDLINE. CLEANED LOCATION.

This work was done according to the Rules and Regulations of the Office of Conservation.

A. BAILEY
WITNESS

*MOBIL E&P NORTH AMERICA, INC.
OPERATOR

PERMIT SECTION (Signed)

Hydne Curran
REPRESENTATIVE
E & R DEPARTMENT

Work Permit

STATE OF LOUISIANA DEPARTMENT OF CONSERVATION

Well Name & No. WALKER B NO. 1 Sec. 19 T 12S R 4W
Field LAKESIDE Parish CAMERON
Permit Serial No. 208325 Work Permit No. LP# 1107-89

Description of Work SO. CEMENT ABOVE & BELOW SUMP PACKER SET AT 2450' TOC 2400'.
SPOT A 100' CEMENT PLUG IN 10-3/4" FROM 150-50' CUT ALL STRINGS 15' BELOW
MUD LINE. P&A ACCORDING TO RULES & REGULATIONS

Sand & Reservoir To Be Tested P&A TD 10,200'

Operator *NOBIL E&P NORTH AMERICA, INC.
Address P. O. BOX 51108
City, State & Zip LAFAYETTE, LA 70505-1108

Permit Requested By *Sydney Durand* Date 9-14-89

Original Signed By: *G. E. LeBlanc*
Permit Authorized By G. E. LeBlanc District *Raf* Date 9-16-89

* WITH MEPUS ACTING AS AGENT.

See Instructions On Reverse Side

Form DM-4R Rev.

PERMIT SECTION

INSTRUCTIONS

A single application will suffice for one, or combinations of, the below operations provided that if more than one operation is requested on one form, such work must be performed consecutively.

If additional applications for Work Permits are necessary on any one well, each should be numbered 1, 2, etc. in the order requested. An original and one copy of this form will suffice for all work with exception of plug and abandon, for which an original and three copies are required.

1. Abandon (Plug & Abd)
2. Deepen
3. Perforate
4. Squeeze
5. Plugback
6. Sidetrack
7. Pull Casing
8. Change Zone of Selective Completion
9. Drill Salt Water Disposal Well
10. Convert to Salt Water Disposal Well
11. Drill Product Storage Well

RECEIVED

SEP 15 1980

Lafayette District Office

NOTICE: To perform any of the above, as well as any other possible operations in Louisiana, without first obtaining a Permit is an infraction of the law and subject to prosecution.



OFFICE OF CONSERVATION
WELL HISTORY AND WORK RESUME REPORT

FIELD
LAKESIDE

SERIAL NO.
208325

PRODUCING INTERVAL
P&A

RESERVOIR (COMPANY SAND IDENTIFICATION)

Three typewritten copies of this report must be filed with the District Office of the Office of Conservation in which the well is located within twenty (20) days of the date of completion. NOTE: If not properly completed and signed this report will be returned.

LEASE AND WELL DATA

CHECK APPROPRIATE BOXES

NEW WELL
 RECOMPLETION
 P & A

31 INACTIVE DRY HOLE FUT. UTIL.
 32 INACTIVE DRY HOLE NO FUT. UTIL.
 36 INACTIVE WAITING ON PIPELINE
 37 INACTIVE WAITING ON MARKET

PRODUCT
 OIL
 GAS
 OTHER

IF RECOMPLETION
 SAME RESERVOIR
 DIFFERENT RESERVOIR

DATE COMP. REPORT
 P & A
 M D Y

10-01-89

OPERATOR
MOBIL E&P NORTH AMERICA, INC.

CODE
4072

ADDRESS
P. O. BOX 51108 - LAFAYETTE, LA 70505

WELL NAME
WALKER "B"

WELL NO
1

PARISH
CAMERON

SEC. **19** TWP. **12S** RGE. **4W**

DATE PERMIT ISSUED
7-18-88

DATE SPUNDED
9-30-89

DATE READY TO PRODUCE*
-

TOTAL DEPTH
10,200

PBTD.
9000'

GROUND ELEVATION
-

CASING HEAD FLANGE ELEVATION
-

DISTANCE FROM RKB TO CHF
-

DATE WELL TURNED INTO TANKS
-

SINGLE, DUAL OR TRIPLE COMPLETION?
-

NOTE: IF THIS IS A MULTIPLE COMPLETION, FURNISH A SEPARATE REPORT FOR EACH COMPLETION

WAS WELL DIRECTIONALLY DRILLED?
NO

WAS DIRECTIONAL SURVEY MADE?
-

WERE 3 COPIES FILED WITH THE OFFICE OF CONSERVATION?
-

DATE FILED
-

TYPE OF ELECTRICAL OR OTHER LOSS RUN (CIRCLE LOSS FILED WITH OFFICE OF CONSERVATION)
(TRIPLE COMBO LOG)

DATE FILED
6-9-89

CASING, LINER AND TUBING RECORD

| NO. | CASING SIZE | HOLE SIZE | CASING WEIGHT | DEPTH SET | | SACKS CEMENT | TEST PRESSURE | HOURS UNDER PRESSURE | DATE TESTED (MM DD YY) | NAME OF TEST WITNESS - STATE IF CONSERVATION AGENT OR OFFSET OPERATOR |
|-----|-------------|-----------|---------------|-----------|------|--------------|---------------|----------------------|------------------------|---|
| | | | | FROM | TO | | | | | |
| 101 | 16 | | | 0 | 150 | DRIVEN | | | | |
| 102 | 10-3/4 | 14-3/4 | 40.5 | 0 | 2510 | 1380 | 1500 | 1/2 | 5-27-88 | |
| 103 | | | | | | | | | | |
| 104 | | | | | | | | | | |
| 105 | | | | | | | | | | |

TUBING SIZE: _____ DEPTH OF TUBING: _____ DEPTH OF PACKER(S): _____

INITIAL COMPLETION OR RE-COMPLETION DATA

INITIAL PRODUCTION

GAS VOLUME
BOPD _____ MCF/DAY _____

GOR _____

CHOKER SIZE _____

PRODUCING METHOD _____

FLOWING TUBING PRESSURE _____

SHUT-IN TUBING PRESSURE _____

CASING PRESSURE _____

WATER PRODUCTION _____

BS&W _____

GRAVITY _____

BHP (SHUT-IN) _____

COMPANY REPRESENTATIVE _____

DATE GAUGED _____

*API60" F _____

PLUG AND ABANDON (P & A) DATA

| CASING SIZE | AMOUNT PULLED | CEMENT PLUGS | | | HOW PLACED | DATE WORK PERFORMED | NAME OF TEST WITNESS - STATE IF CONSERVATION AGENT OR OFFSET OPERATOR |
|-------------|---------------|--------------|------|-------|------------|---------------------|---|
| | | FROM | TO | SACKS | | | |
| 10-3/4 | 0 | 10048 | 9043 | 760 | DRILL PIPE | 6-7-88 | STEVE STEPHENS |
| 10-3/4 | 0 | 9000 | 8000 | 812 | DRILL PIPE | 6-7-88 | STEVE STEPHENS |
| 10-3/4 | 0 | 2610 | 2400 | 115 | PUMPED | 9-30-89 | A. BAILEY |
| 10-3/4 | 0 | 150 | 50 | 58 | PUMPED | 10-1-89 | A. BAILEY |

MOBIL E&P NORTH AMERICA, INC.

CERTIFICATE: I, the undersigned, state that I am employed by _____ and that I am authorized to make this report, and that this report was prepared under my supervision and direction and that all facts stated herein are true, correct and complete to the best of my knowledge.

Signature: *[Signature]* Title: **E & R DEPARTMENT**

* Date well is equipped to produce, but due to no available market, no pipe line connection, etc., the well has been shut-in.

* WITH NEPUS ACTING AS AGENT.



OFFICE OF CONSERVATION
WELL HISTORY AND WORK RESUME REPORT

FIELD
LAKESIDE

SERIAL NO.
208325

PRODUCING INTERVAL
PCD

RESERVOIR (COMPANY SAND IDENTIFICATION)

Three typewritten copies of this report must be filed with the District Office of the Office of Conservation in which the well is located within twenty (20) days of the date of completion. NOTE: If not properly completed and signed this report will be returned.

LEASE AND WELL DATA

CHECK APPROPRIATE BOXES

NEW WELL

RECOMPLETION

P & A

31 INACTIVE DRY HOLE FUT. UTIL.

32 INACTIVE DRY HOLE NO FUT. UTIL.

36 INACTIVE WAITING ON PIPELINE

37 INACTIVE WAITING ON MARKET

PRODUCT

OIL

GAS

OTHER

IF RECOMPLETION

SAME RESERVOIR

DIFFERENT RESERVOIR

DATE COMP. RECOMPL.
O P R A
M D Y
10-01-89

OPERATOR
MOBIL E&P NORTH AMERICA, INC.

CODE
4072

ADDRESS
P. O. BOX 51108 - LAFAYETTE, LA 70505

WELL NAME
WALKER "B"

WELL NO.
1

PARISH
CAMERON

SEC. **19** TWP. **12S** RGE. **4W**

DATE PERMIT ISSUED
7-18-88

DATE SPUNDED
9-30-89

DATE READY TO PRODUCE*

TOTAL DEPTH
10,200

PSTD
9000'

GROUND ELEVATION

CASING HEAD FLANGE ELEVATION

DISTANCE FROM RKB TO CHF

DATE WELL TURNED INTO TANKS

SINGLE, DUAL OR TRIPLE COMPLETION?

NOTE: IF THIS IS A MULTIPLE COMPLETION, FURNISH A SEPARATE REPORT FOR EACH COMPLETION.

WAS WELL DIRECTIONALLY DRILLED? **NO**

WAS DIRECTIONAL SURVEY MADE?

WERE 3 COPIES FILED WITH THE OFFICE OF CONSERVATION?

DATE FILED

TYPE OF ELECTRICAL OR OTHER LOGS RUN (CIRCLE LOGS FILED WITH OFFICE OF CONSERVATION)
(TRIPLE COMBO LOG)

DATE FILED
6-9-89

CASING, LINER AND TUBING RECORD

| C | CASING SIZE | HOLE SIZE | CASING WEIGHT | DEPTH SET | | SACKS CEMENT | TEST PRESSURE | HOURS UNDER PRESSURE | DATE TESTED (MM DD YY) | NAME OF TEST WITNESS - STATE IF CONSERVATION AGENT OR OFFSET OPERATOR |
|-----|-------------|-----------|---------------|-----------|------|--------------|---------------|----------------------|------------------------|---|
| | | | | FROM | TO | | | | | |
| 101 | 16 | | | 0 | 150 | DRIVEN | | | | |
| 102 | 10-3/4 | 14-3/4 | 40.5 | 0 | 2510 | 1380 | 1500 | 1/2 | 5-27-88 | |
| 103 | | | | | | | | | | |
| 104 | | | | | | | | | | |
| 105 | | | | | | | | | | |

TUBING SIZE: DEPTH OF TUBING: DEPTH OF PACKER(S):

INITIAL COMPLETION OR RE-COMPLETION DATA

INITIAL PRODUCTION

GAS VOLUME

GOR

CHOKER SIZE

PRODUCING METHOD

BOPD

MCF/DAY

CF/BBL

/64"

FLOWING TUBING PRESSURE

SHUT-IN TUBING PRESSURE

CASING PRESSURE

WATER PRODUCTION

BS&W

%

GRAVITY

BHP (SHUT-IN)

COMPANY REPRESENTATIVE

DATE GAUGED

API#60 F

PLUG AND ABANDON (P & A) DATA

| CASING SIZE | AMOUNT PULLED | CEMENT PLUGS | | | | DATE WORK PERFORMED | NAME OF TEST WITNESS - STATE IF CONSERVATION AGENT OR OFFSET OPERATOR |
|-------------|---------------|--------------|------|-------|------------|---------------------|---|
| | | FROM | TO | SACKS | HOW PLACED | | |
| 10-3/4 | 0 | 10048 | 9043 | 760 | DRILL PIPE | 6-7-88 | STEVE STEPHENS |
| 10-3/4 | 0 | 9000 | 8000 | 812 | DRILL PIPE | 6-7-88 | STEVE STEPHENS |
| 10-3/4 | 0 | 2610 | 2400 | 115 | PUMPED | 9-30-89 | A. BAILEY |
| 10-3/4 | 0 | 150 | 50 | 58 | PUMPED | 10-1-89 | A. BAILEY |

CERTIFICATE: I, the undersigned, state: That I am employed by **MOBIL E&P NORTH AMERICA, INC.** and that I am authorized to make this report, and that this report was prepared under my supervision and direction and that all facts stated herein are true, correct and complete to the best of my knowledge.

Signature: *[Signature]* Title: **E & R DEPARTMENT**

*Date well is equipped to produce, but due to no available market, no pipe line connection, etc., the well has been shut-in.

* WITH MEFUS ACTING AS AGENT.

WORK RESUME

List below all work performed under Office of Conservation Work Permits while drilling and completing well.

| WORK PERMIT NO. | DATE WORK PERFORMED | SERVICE COMPANY | DESCRIPTION OF WORK |
|-----------------|----------------------------|---------------------------|--|
| LP#1107-89 | 9-30-89 THRU 10-1-89 | TURNER WELL SERVICE | SQ. CEMENT ABOVE & BELOW SUMP PACKER SET AT 2450' TOC 2400'. SPOT A 100' CEMENT PLUG IN 10-3/4" FROM 150-50'. CUT ALL STRINGS 15' BELOW MUDLINE. P&A ACCORDING TO RULES & REGULATIONS. |

List below all important Paleofaunal or Geological Formation tops, Cap Rock and Salt Overhang bottoms

| FORMATION | DEPTH | FORMATION | DEPTH |
|-----------|-------|-----------|-------|
| | | | |

RECEIVED
OCT 09 1989
Lafayette District Office
Lafayette, Louisiana

STATE OF LOUISIANA
OFFICE OF CONSERVATION
REPORT OF PROOF OF APPARENT DEVIATION

SERIAL NO. 208325

OPERATOR Wayman W. Buchanan, Inc. DISTRICT Lafayette

FIELD Lakeside PARISH Cameron

WELL NAME & NO. Walker #1 SEC. 19 T 12S R 4W

| Degrees Deviation | Deviation Factor | DEGREES DEVIATION | DEPTH FROM SURFACE | LENGTH OF INTERVAL | DEVIATION FACTOR | DEVIATION OF INTERVAL | CUMULATIVE APPARENT DEVIATION | REMARKS |
|----------------------|---------------------|----------------------|--------------------------|--------------------------|---------------------|-----------------------------|-------------------------------------|---------|
| ¼ | .00436 | 1 1/2° | 889' | 889' | .00873 | 7.76' | 7.76' | |
| ¼ | .00873 | | | | | | | |
| ¼ | .01309 | 2° | 1,990' | 1,101' | .03490 | 38.42' | 46.18' | |
| 1 | .01745 | 1 3/4° | 2,512' | 522' | .03054 | 15.94' | 62.12' | |
| 1¼ | .02182 | 1° | 3,494' | 982' | .01745 | 17.14' | 79.26' | |
| 1¼ | .02618 | | | | | | | |
| 1¼ | .03054 | 1 3/4° | 4,480' | 986' | .03054 | 30.11' | 109.37' | |
| 2 | .03490 | 3/4° | 5,465' | 985' | .01309 | 12.89' | 122.26' | |
| 2¼ | .03926 | | | | | | | |
| 2½ | .04362 | 2° | 6,454' | 989' | .03490 | 34.52' | 156.78' | |
| 2¾ | .04798 | | | | | | | |
| 3 | .05234 | 4° | 7,432' | 978' | .06976 | 68.23' | 225.01' | |
| 3¼ | .05669 | 3 1/2° | 8,412' | 980' | .06105 | 59.83' | 284.84' | |
| 3½ | .06105 | | | | | | | |
| 3¾ | .06540 | 3 3/4° | 8,951' | 539' | .06540 | 35.25' | 320.09' | |
| 4 | .06976 | 2 3/4° | 9,658' | 707' | .04798 | 33.92' | 354.01' | |
| 4¼ | .07411 | 1 1/4° | 10,198' | 540' | .02182 | 11.78' | 365.79' | |
| 4½ | .07846 | | | | | | | |
| 4¾ | .08281 | | | | | | | |
| 5 | .08716 | | | | | | | |
| 5¼ | .09150 | | | | | | | |
| 5½ | .09585 | | | | | | | |
| 5¾ | .10019 | | | | | | | |
| 6 | .10453 | | | | | | | |
| 6¼ | .10887 | | | | | | | |
| 6½ | .11320 | | | | | | | |
| 6¾ | .11754 | | | | | | | |
| 7 | .12187 | | | | | | | |
| 7¼ | .12620 | | | | | | | |
| 7½ | .13053 | | | | | | | |
| 7¾ | .13485 | | | | | | | |
| 8 | .13917 | | | | | | | |
| 8¼ | .14349 | | | | | | | |
| 8½ | .14781 | | | | | | | |
| 8¾ | .15212 | | | | | | | |
| 9 | .15643 | | | | | | | |
| 9¼ | .16074 | | | | | | | |
| 9½ | .16505 | | | | | | | |
| 9¾ | .16935 | | | | | | | |
| 10 | .17365 | | | | | | | |

Certified as Being True & Correct by Elaine M. Krueger Title Production Analyst Date 12/14/89

Elaine M. Krueger

THREE (3) SIGNED COPIES
OF THIS REPORT SHOULD BE SUBMITTED WITH FORM WH ON ALL WELLS, EXCEPT AS NOTED ON THE
REVERSE SIDE.

SEE INSTRUCTIONS ON REVERSE SIDE

I N S T R U C T I O N S

This report shall be typewritten only and filed in triplicate as an attachment to the Well History and Work Resume Report (Form WH).

The tabulation, set apart in the blocked section on the left is for easy reference, and the three blank columns located between the double lines are for convenience in calculations. All blank columns should be completed so that all work may be easily checked.

In the first two columns record the Degrees Deviation and the Depth from Surface at which such deviation was recorded.

The Length of Interval for any particular Depth from Surface is obtained by subtracting the previous Depth from Surface from that particular point.

The only exception being the first Length of Interval which is equal to its Depth from Surface.

The Deviation Factor may be obtained from the tabulation on the left. Multiply the Length of Interval by the respective Deviation Factor to obtain the Deviation of Interval.

Cumulative Apparent Deviation is a running summation of Deviation of Interval values and the final figure in the Cumulative Apparent Deviation

Column should be equal to the sum of all the individual Deviation of Interval figures and will be the apparent resultant lateral deviation of the hole at Total Depth.

If a Directional Survey determining the bottom of the hole is filed with the Commissioner of Conservation upon completion of the well, it shall not be

necessary to furnish the Inclination Survey data.

LA FAYETTE, LOUISIANA

OFFICE OF CONSERVATION

RECEIVED
DEC 19 1989

RECEIVED
DEC 21 1989
Office of
Well
Baton Rouge