

No. 035422

DEPARTMENT OF CONSERVATION
PERMIT TO DRILL FOR MINERALS

BATON ROUGE, LA, DECEMBER 29, 1953

PARISH CAMERON FIELD WILDCAT
OPERATOR FOREST OIL CORPORATION
ADDRESS 1229 MILAN BUILDING, SAN ANTONIO, TEXAS
LOCATION OF WELL _____

670.3' EAST AND 650' SOUTH OF THE NW/CORNER
_____ OF Sec. 29, T. 15-S, R. 5-W

You are hereby authorized to drill DR. M. O. MILLER
Well No. 2, referred to under application bearing serial No. 50882
dated DECEMBER 21, 1953, signed by JOHN C. WILLIS
This well to be drilled to 14,000' zone on surface area of _____ acres
DRILLING CONTRACTOR _____

STATE OF LOUISIANA
DEPARTMENT OF CONSERVATION

John B. Hursey
Commissioner Department of Conservation

A. J. Harrison
Office Manager Division of Minerals

T15S, R5W

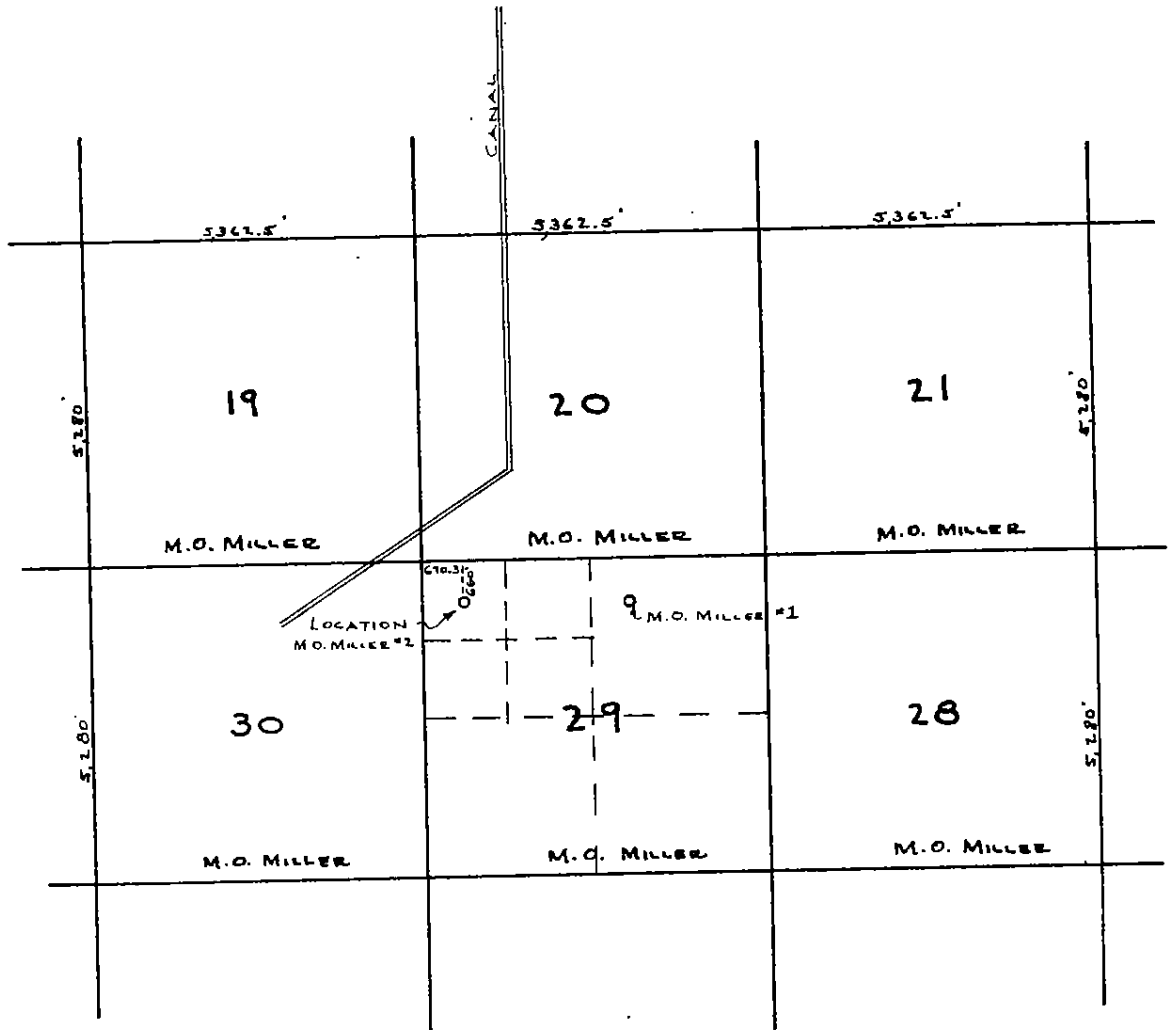

LOCATION OF
FOREST OIL CORP. #2 M.O.
MILLER WELL, IN SEC. 29,
T15S, R5W
CAMERON PARISH, LA.

I hereby certify that the location of
Forest Oil Corp. #2 M.O. Miller well is:
670.3' East thence 660' South of NW
cor. of Sec. 29, T15S, R5W, Cameron Psh., La.;
being also 2683.8' West of M.O. Miller Wall #1

Dec. 1, 1953

1"=2,000'

G. K. Pratt, Surveyor, C.E. #799

F O R E S T O I L C O R P O R A T I O N



Heymann's Oil Center . Lafayette, Louisiana

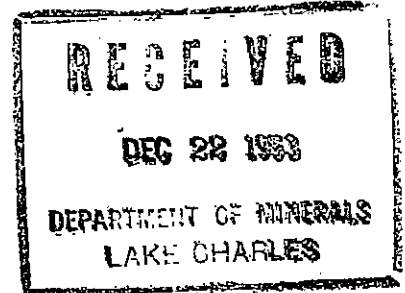

December 21, 1953

Department of Conservation
Division of Minerals
Schindler Building
Ryan St.
Lake Charles, Louisiana

Gentlemen:

Enclosed is an application for permit to drill
Dr. M. O. Miller #2 and a check for the amount of \$50.00.

Yours truly,

John C. Willis

John C. Willis

JCW:mmb

Enclosure

XXXXXXXXXXXXXXXXXXXX
LAKE CHARLES, LA.
December 23, 1953

Ms. Ma

Mr. Thos. M. Winfield, Chief Eng.
Department of Conservation
State Capitol Building
Baton Rouge, Louisiana

Dear Sir:

Find enclosed check for \$50.00 covering permit fee,
application of Forest Oil Corporation to drill their
Dr. M.O. Miller #2, Wildcat, Cameron Parish, Louisiana.

Yours very truly,

ARSENE P. EDWARDS
District Manager
Lake Charles, La.

APE:lml

Encl.

[Handwritten signature]

DEPARTMENT OF CONSERVATION
STATE OF LOUISIANA

RECEIVED
MAR 13 1954
DEPARTMENT OF MINERALS
WORK PERMIT NO. CHARLES
WELL SERIAL NO. 36422

- AFFIDAVIT OF TEST OF CASING IN WELL -

DATE WORK DONE 2-28-54

(One copy to be filed with the District Office)

NOTE:

THIS REPORT WILL BE RETURNED IF NOT PROPERLY FILLED IN AND SIGNED

PARISH Cameron FIELD Crest Lake SEC. 29 TWP 15 RGE 5

COMPANY Forest Oil Corp LEASE MOM WELL NO. 2

TOTAL DEPTH 2530

SIZE OF CASING 10 3/4 IN: WT. PER FT. 45 #: MAKE Youngstown

NO. OF THREADS PER IN. 7 GRADE 55 SEAMLESS NEW 2ND

IF SECOND HAND, WAS PIPE TESTED? _____ DESCRIBE _____

DEPTH LANDED BELOW DERRICK FLOOR 350 FT. SACKS OF CEMENT 1900

SIZE OF HOLE 15 IN.: AMOUNT OF CEMENT LEFT IN PIPE _____

METHOD OF CEMENTING 1608 CEMENT SET 12 HOURS UNDER 500 LBS.

PRESSURE _____ TOTAL TIME SET 72 HOURS

DETAIL OF PRESSURE TEST BEFORE DRILLING PLUG

DATE OF TEST: 2-28-1954 GAUGE PRESSURE ON CASING 1800 LBS.

PRESSURE AT END OF THIRTY MINUTES(30) 1700 DROP 200 LBS.

TEST FLUID: WATER MUD _____ LBS. PER GAS: _____ VISCOSITY _____ SEC.

REMARKS: 36422 - MOM - 2

THIS WORK WAS DONE ACCORDING TO THE RULES AND REGULATIONS OF THE DEPARTMENT OF CONSERVATION, MINERALS DIVISION.

WITNESS: _____ SIGNED: Forest Oil Corp.
COMPANY

Clarence Combs
Representative



DEPARTMENT OF CONSERVATION
STATE OF LOUISIANA

AFFIDAVIT OF TEST OF CASING IN WELL

WORK PERMIT NO. 35422
WELL SERIAL NO. 50882

DATE WORK DONE 4-17-54

(One copy to be filed with the District Office)

NOTE:

THIS REPORT WILL BE RETURNED IF NOT PROPERLY FILLED IN AND SIGNED

PARISH Cadiz FIELD Grand Chenier SEC. 29 TWP 15 RGE 5
COMPANY Forest Oil Corp. LEASE M O Miller WELL NO. 2
TOTAL DEPTH 12490
SIZE OF CASING 5 1/2 IN: WT. PER FT. 204.17 #: MAKE Spang
NO. OF THREADS PER IN. 8 GRADE 780 SEAMLESS NEW 2ND
IF SECOND HAND, WAS PIPE TESTED: _____ DESCRIBE _____

DEPTH LANDED BELOW DERRICK FLOOR 1489 FT. SACKS OF CEMENT 1200
SIZE OF HOLE 9 7/8 IN.: AMOUNT OF CEMENT LEFT IN PIPE 55'
METHOD OF CEMENTING HPB CEMENT SET 12 HOURS UNDER 1400 LBS.
PRESSURE _____ TOTAL TIME SET 7 1/2 HOURS

DETAIL OF PRESSURE TEST BEFORE DRILLING PLUG

DATE OF TEST: 4-19-54. GAUGE PRESSURE ON CASING 1500 LBS.
PRESSURE AT END OF 30 MINUTES 1500 DROP none LBS.
TEST FLUID: WATER MUD _____ LBS. PER GAS: _____ VISCOSITY _____ SEC.

REMARKS: Blowout Preventer Made
Valve

THIS WORK AS DONE ACCORDING TO THE RULES AND REGULATIONS OF THE DEPARTMENT OF CONSERVATION, MINERALS DIVISION.

WITNESS: Sam J. [Signature] SIGNED: Forest Oil Corp. COMPANY
Inspector Clarence [Signature] Representative

WORK PERMIT

PERMIT TO Squeeze DATE May 4, 1954
PARISH Cameron FIELD Crab Lake
COMPANY Forest Oil Corp.
ADDRESS 1229 Milam Bldg., San Antonio, Texas
WELL NAME Dr. M. O. Miller No. 2 SEC. 29 T. 15S R. 5W
WELL PERMIT SERIAL No. 50882 WORK PERMIT No. 35422
LOCATION 670.3' E and 660' S of the NW corner.

YOU ARE HEREBY AUTHORIZED TO To squeeze open hole from
12,489' to 12,550' thru cement retainer set at
12,475'.

PERMIT REQUESTED BY John C. Willis TD 12,550'
Company Representative

AUTHORIZED BY
ARSENE P. EDWARDS
Lake Charles, La. District Office

DEPARTMENT OF CONSERVATION
STATE OF LOUISIANA

MAY 10 1954
DEPARTMENT OF MINERALS
LAKE CHARLES

- PERFORATE AND SQUEEZE RECORD -

DATE WORK DONE 5-5-54

WORK PERMIT NO. 50882

WORK SERIAL NO. L.C. #50

(One copy to be filed with the District Office)

N O T E:

THIS REPORT WILL BE RETURNED IF NOT PROPERLY FILLED IN AND
SIGNES

PARISH Cameron FIELD Crab Lake SEC. 29 TWP. 15 SRGE 5W

COMPANY Forest Oil Corp. LEASE Dr. M. O. Miller WELL NO. 2

TOTAL DEPTH 12,858' NEW OR OLD WELL New

SIZE CASING 5 1/2" OD DEPTH OF CASING 12,489'

DEPTH OF PLUG BELOW PERFORATION 12,550' (open hole)

PERFORATED FROM None TO _____

NUMBER OF HOLES - SIZE OF HOLES -

PERFORATION COMPANY - TRUCK NUMBER -

METHOD OF PLACING CEMENT Pump

WHERE CEMENT RETAINER SET: DEPTH 12,475' FT.

BARRELS OF WATER PUMPED BEFORE CEMENT 5 AFTER 5

BREAKDOWN PRESSURE 1800 LBS. FINAL PRESSURE 3400 LBS.

PURPOSE OF SQUEEZE JOB Squeeze open hole below casing.

SQUEEZE JOB DONE BY Halliburton Oil Well Cementing Company

REMARKS: Squeeze was done in open hole below casing & above open hole
cement plug.

THIS WORK WAS DONE ACCORDING TO THE RULES AND REGULATIONS OF THE
DEPARTMENT OF CONSERVATION DIVISION.

SIGNED: FOREST OIL CORPORATION
C O M P A N Y

Wallace H. Brown
Representative

WORK PERMIT

PERMIT TO Perforate DATE May 4, 1954
PARISH Cameron FIELD Crab Lake
COMPANY Forest Oil Corp.
ADDRESS 1229 Milam Bldg., San Antonio, Texas
WELL NAME Dr. M. O. Miller No. 2 SEC. 29 T. 15S R. 5W
WELL PERMIT SERIAL No. 50882 WORK PERMIT No. 35422
LOCATION 670.3' E and 660' S of the NW corner.

YOU ARE HEREBY AUTHORIZED TO Perforate zone 12,451 - 12,455'
with 4 holes/ft. by Schlumberger Electric Log, and drill
stem test this zone.

PERMIT REQUESTED BY John C. Willis TD 12,475'
Company Representative

AUTHORIZED BY
ARSENE P. EDWARDS
Lake Charles, La. District Office

DEPARTMENT OF CONSERVATION
STATE OF LOUISIANA

- PERFORATING RECORD -

RECEIVED
MAY 19 1954
DEPARTMENT OF MINERALS
LAKE CHARLES

DATE WORK DONE 5-5-54

WORK PERMIT NO. 50882
WORK SERIAL NO. L.C. #173

(One copy to be filed with the District Office)

NOTE:

THIS REPORT WILL BE RETURNED IF NOT PROPERLY FILLED IN AND SIGNED

PARISH Cameron FIELD Crab Lake SEC 29 TWP 15S RGE 5W

COMPANY Forest Oil Corp LEASE Dr. M. O. Miller WELL NO. 2

TOTAL DEPTH 12,858' NEW OR OLD WELL New

SIZE CASING 5 1/2" OD DEPTH OF CASING 12,489'

DEPTH OF PLUG BELOW PERFORATIONS 12,475'

PERFORATED FROM 12,451' TO 12,455'

NUMBER OF HOLES 16 SIZE OF HOLES 1/2"

PERFORATING COMPANY Lane Wells TRUCK NUMBER 402

PURPOSE OF PERFORATIONS To test zone.

REMARKS: _____

THIS WORK WAS DONE ACCORDING TO THE RULES AND REGULATIONS OF THE DEPARTMENT OF CONSERVATION.

SIGNED: FOREST OIL CORPORATION.
COMPANY

Wallace H Brown
Representative

WORK PERMIT

PERMIT TO Plugback DATE May 4, 1954
PARISH Cameron FIELD Crab Lake
COMPANY Forest Oil Corp.
ADDRESS 1229 Milam Bldg., San Antonio, Texas
WELL NAME Dr. M. O. Miller No. 2 SEC. 29 T. 15S R. 5W
WELL PERMIT SERIAL No. 50882 WORK PERMIT No. 35422
LOCATION 670.3' E and 660' S of the NW corner.

YOU ARE HEREBY AUTHORIZED TO To set cement plug in open
hole from 12,858' to 12,550'.

PERMIT REQUESTED BY John C. Willis to TD 12,858'
Company Representative

AUTHORIZED BY
ARSENE P. EDWARDS
Lake Charles, District Office

MINERALS DIVISION
DEPARTMENT OF CONSERVATION
STATE OF LOUISIANA

- PLUG(PLUG-BACK) RECORD -

DATE WORK DONE 5-4-54

WORK PERMIT NO. 50882
WORK SERIAL NO. L.C. #40

RECEIVED

MAY 19 1954

DEPARTMENT OF MINERALS

LAKE CHARLES

(One copy to be filed with the District Office)

NOTE:

THIS REPORT WILL BE RETURNED IF NOT PROPERLY FILLED IN AND SIGNED

PARISH Cameron FIELD Crab Lake SEC 29 TWP 15 SRCE 5W

COMPANY Forest Oil Corp. LEASE Dr. M. O. Miller WELL NO. 2

TOTAL DEPTH 12,858' NEW OR OLD WELL New

SIZE CASING 5 1/2" OD DEPTH OF CASING 12,489'

CEMENT RETAINER SET AT None

DEPTH OF PLUG FROM 12,550' TO 12,858'

NUMBER OF SACKS 37 NUMBER OF HOURS CEMENT SET 18

PURPOSE OF PLUG Plug open hole.

PLUG JOB DONE BY Halliburton Oil Well Cementing Company

METHOD OF PLACING CEMENT Pump truck.

BARRELS OF WATER BEFORE CEMENT 5 AFTER 2 1/2

RESULTS Received good plug. No flow back.

PLUG JOB DONE BY Halliburton Oil Well Cementing Company

REMARKS: _____

THIS WORK WAS DONE ACCORDING TO THE RULES AND REGULATIONS OF THE DEPARTMENT OF CONSERVATION, MINERALS DIVISION.

SIGNED FOREST OIL CORPORATION
COMPANY

Wallace H. Brown
Representative

WORK PERMIT

PERMIT TO Plug & Squeeze DATE May 6, 1954
PARISH Cameron FIELD Crab Lake
COMPANY Forest Oil Corp.
ADDRESS 1229 Milam Bldg., San Antonion, Texas
WELL NAME Dr. M. O. Miller No. 2 SEC. 29 T. 15S. 5W
WELL PERMIT SERIAL No. 50882 WORK PERMIT No. 35422
LOCATION 670.3' E and 660' S of the NW corner.

YOU ARE HEREBY AUTHORIZED TO To set cement retainer at
12,420' and squeeze off perforations 12,451' - 12,455'.

PERMIT REQUESTED BY John C. Willis TD 12,475'
Company Representative

AUTHORIZED BY ARSENE P. EDWARDS
Lake Charles, La. Office

DEPARTMENT OF CONSERVATION
STATE OF LOUISIANA

- PERFORATE AND SQUEEZE RECORD

RECEIVED

MAY 19 1954

DEPARTMENT OF MINERALS
LAKE CHARLES

DATE WORK DONE 5-6-54

WORK PERMIT NO. 50882
WORK SERIAL NO. L.C. #25

(One copy to be filed with the District Office)

N O T E:

THIS REPORT WILL BE RETURNED IF NOT PROPERLY FILLED IN AND
SIGNES

PARISH Cameron FIELD Crab Lake SEC. 29 TWP 15S RGE 5W
COMPANY Forest Oil Corp. LEASE Dr. M. O. Miller WELL NO. 2
TOTAL DEPTH 12,858' NEW OR OLD WELL New
SIZE CASING 5 1/2" OD DEPTH OF CASING 12,489'
DEPTH OF PLUG BELOW PERFORATION 12,475'
PERFORATED FROM 12,451' TO 12,455'
NUMBER OF HOLES 16 SIZE OF HOLES 1/2"
PERFORATION COMPANY Lane Wells TRUCK NUMBER 402
METHOD OF PLACING CEMENT Pump
WHERE CEMENT RETAINER SET: DEPTH 12,420' FT.
BARRELS OF WATER PUMPED BEFORE CEMENT 5 AFTER 5
BREAKDOWN PRESSURE 5800 LBS. FINAL PRESSURE 5200 LBS.
PURPOSE OF SQUEEZE JOB Plug off formation open for test
SQUEEZE JOB DONE BY Halliburton Oil Well Cementing Company
REMARKS: _____

THIS WORK WAS DONE ACCORDING TO THE RULES AND REGULATIONS OF THE
DEPARTMENT OF CONSERVATION DIVISION.

SIGNED: FOREST OIL CORPORATION
C O M P A N Y

Wallace H. Brown
Representative

WORK PERMIT

PERMIT TO Perforate DATE May 6, 1954
PARISH Cameron FIELD Crab Lake
COMPANY Forest Oil Corp.
ADDRESS 1229 Milam Bldg., San Antonio, Texas
WELL NAME Dr. M. O. Miller No. 2 SEC. 29 T. 15S R. 5W
WELL PERMIT SERIAL No. 50882 WORK PERMIT No. 35422
LOCATION 870.3' E and 660' S of the NW corner.

~~9925~~ ARE HEREBY AUTHORIZED TO To perforate zone 9918' -
9925' by Schlumberger and drill stem test.

PERMIT REQUESTED BY John C. Willis TD 11,420'
Company Representative

AUTHORIZED BY
ARSENE P. EDWARDS
Lake Charles, La District Office

WORK PERMIT

PERMIT TO Perforate DATE May 6, 1954
PARISH Cameron FIELD Crab Lake
COMPANY Forest Oil Corp.
ADDRESS 1229 Milam Bldg., San Antonio, Texas
WELL NAME Dr. M. O. Miller No. 2 SEC. 29 T. 15S R. 5W
WELL PERMIT SERIAL No. 50882 WORK PERMIT No. 35422
LOCATION 670.3' E & 600' S of the NW corner.

YOU ARE HEREBY AUTHORIZED TO Perforate 11,144' - 11,152'
by Schlumberger with 4 holes/Ft., perforating for
production, and drill stem test.

PERMIT REQUESTED BY John C. Willis TD 11,420'
Company Representative

AUTHORIZED BY
ARSENE P. EDWARDS
Lake Charles, La. office

WORK PERMIT

PERMIT TO Perforate & Squeeze May 6, 1954
PARISH Cameron FIELD Crab Lake
COMPANY Forest Oil Corp.
ADDRESS 1229 Milan Bldg., San Antonio, Texas
WELL NAME Dr. M. C. Miller No. 2 SEC. 29 T. 15S R. 5W
WELL PERMIT SERIAL No. 50882 WORK PERMIT No. 35422
LOCATION 670.3' E and 660' S of the NW corner.

YOU ARE HEREBY AUTHORIZED TO To perforate 11,184' by Sch-
lumberger with 4 holes and squeeze thru cement retain-
er set at 11,170'.

TD 11,420'
PERMIT REQUESTED BY John C. Willis
Company Representative

AUTHORIZED BY _____
ARSENE P. EDWARDS
Lake Charles, La., Office

PERMIT VERISAT
LANE-WELLS COMPANY

PERFORATING DATA SHEET

Number Jobs This Trip one-land

District So. wa. Operating Base L.C. Date 5-7-54 S. O. # 77725
 Truck No. 08 Operator Chapman Helper Boyd
 Customer Forest Oil Corp. Authorized Agent Mr. Brown
 Name of Well Dr. M.O. Milling No. 2 Field Crab Lake
 State wa. County/Parish Cameron

Job Scheduled 10:00 - 5-7-54 A.M. Arrived At Location Landing 9:00 - 5-7-54 A.M. P.M.

On Job 70/100 M. Res. Off Job 70/100 M. Res. A.M. P.M.

Standby Time See note on back side Max. Temp. 70/100 ° F.

New or Old Well New Purpose of Perforating Squeeze Kind of Fluid Mud Level Full

Casing Record 5 1/2" 30" Cemented In 3/8" Liner Record None Cemented In None

Customer's Depth 12210 Measure Method Strain Zero Point 1' above rotary

Lane-Wells Depth 4 Size Gun 2" No. 4-169 No. 167 Type 4 way S. Gun Controller No. 167 No. 167

K.S. Bullet Size 4 Holes from 11132 to 11132 Ft. Holes from 11132 to 11132 Ft. Shooting Zones Approved By: [Signature] Title [Title]

	Run No.	Run No.	Run No.	Run No.	Run No.	Run No.
1						
2						
3						
4						
5						
6						
7						
8						
9						
10						
11						
12						
13						
14						
15						
16						
17						
18						
19						
20						
21						
22						
23						
24						
25						
26						
27						
28						
29						
30						

RECEIVED
MAY 13 1954
DEPARTMENT OF MINERALS
LAKE CHARLES

RUNNING TIME:			REMARKS
1)	In From _____ to _____	A.M. P.M.	
	Out From _____ to _____	A.M. P.M.	
	Fluid _____		
	In _____ Out _____		
	Holes _____ Total _____		
	Misses _____ Total _____		
2)	In From _____ to _____	A.M. P.M.	
	Out From _____ to _____	A.M. P.M.	
	Fluid _____		
	In _____ Out _____		
	Holes _____ Total _____		
	Misses _____ Total _____		
3)	In From _____ to _____	A.M. P.M.	
	Out From _____ to _____	A.M. P.M.	
	Fluid _____		
	In _____ Out _____		
	Holes _____ Total _____		
	Misses _____ Total _____		
4)	In From _____ to _____	A.M. P.M.	
	Out From _____ to _____	A.M. P.M.	
	Fluid _____		
	In _____ Out _____		
	Holes _____ Total _____		
	Misses _____ Total _____		
5)	In From _____ to _____	A.M. P.M.	
	Out From _____ to _____	A.M. P.M.	
	Fluid _____		
	In _____ Out _____		
	Holes _____ Total _____		
	Misses _____ Total _____		
6)	In From _____ to _____	A.M. P.M.	
	Out From _____ to _____	A.M. P.M.	
	Fluid _____		
	In _____ Out _____		
	Holes _____ Total _____		
	Misses _____ Total _____		

Mileage: From _____ to _____
Mileage: From _____ to _____

DEPARTMENT OF CONSERVATION
STATE OF LOUISIANA

- PERFORATE AND SQUEEZE RECORD

DATE WORK DONE 5-8-54

WORK PERMIT NO. 50882
WORK SERIAL NO. L.C. #80

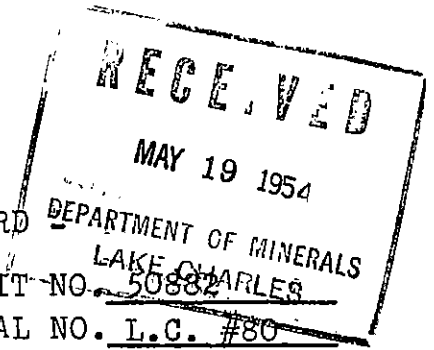

(One copy to be filed with the District Office)

N O T E:

THIS REPORT WILL BE RETURNED IF NOT PROPERLY FILLED IN AND
SIGNES

PARISH Cameron FIELD Crab Lake SEC. 29 TWP. 15 SRGE 5W
COMPANY Forest Oil Corp. LEASE Dr. M. O. Miller WELL NO. 2
TOTAL DEPTH 12,858' NEW OR OLD WELL New
SIZE CASING 5½" OD DEPTH OF CASING 12,489'
DEPTH OF PLUG BELOW PERFORATION 12,420'
PERFORATED FROM 11,184' TO 11182
NUMBER OF HOLES 4 SIZE OF HOLES ½"
PERFORATION COMPANY Lane Wells TRUCK NUMBER 402
METHOD OF PLACING CEMENT Halliburton Oil Well Cementing Company
WHERE CEMENT RETAINER SET: DEPTH 11,170' FT.
BARRELS OF WATER PUMPED BEFORE CEMENT 5 AFTER 5
BREAKDOWN PRESSURE 3500 LBS. FINAL PRESSURE 5600 LBS.
PURPOSE OF SQUEEZE JOB Shut off possible water & insure cement around casing.
SQUEEZE JOB DONE BY Halliburton Oil Well Cementing Company
REMARKS: _____

THIS WORK WAS DONE ACCORDING TO THE RULES AND REGULATIONS OF THE
DEPARTMENT OF CONSERVATION DIVISION.

SIGNED: FOREST OIL CORPORATION
C O M P A N Y

Wallace H. Brown
Representative

DEPARTMENT OF CONSERVATION
STATE OF LOUISIANA

- PERFORATING RECORD -

RECEIVED
MAY 19 1954
DEPARTMENT OF MINERALS
LAKE CHARLES
WORK PERMIT NO. 50882
WORK SERIAL NO. LC #174

DATE WORK DONE 5-8-54

(One copy to be filed with the District Office)

NOTE:

THIS REPORT WILL BE RETURNED IF NOT PROPERLY FILLED IN AND SIGNED

PARISH Cameron FIELD Crab Lake SEC 29 TWP 15S RGE 5W

COMPANY Forest Oil Corporation OPERATOR Dr. M. O. Miller WELL NO. 2

TOTAL DEPTH 12,858' NEW OR OLD WELL New

SIZE CASING 5 1/2" OD DEPTH OF CASING 12,489'

DEPTH OF PLUG BELOW PERFORATIONS 11,173 Ft.

PERFORATED FROM 11,144' TO 11,152'

NUMBER OF HOLES 32 SIZE OF HOLES 1/2"

PERFORATING COMPANY Lane Wells TRUCK NUMBER 402

PURPOSE OF PERFORATIONS To test sand.

REMARKS:

THIS WORK WAS DONE ACCORDING TO THE RULES AND REGULATIONS OF THE DEPARTMENT OF CONSERVATION.

SIGNED: Forest Oil Corporation
COMPANY
Wallace H. Brown
Representative

WORK PERMIT

PERMIT TO Perf. & Squeeze DATE May 10, 1954
PARISH Cameron FIELD Wildcat
COMPANY Forest Oil Corp.
ADDRESS 1229 Milam Bldg., San Antonio, Texas
WELL NAME Dr. H. O. Miller No. 2 SEC. 29 T. 15S R. 5W
WELL PERMIT SERIAL No. 50882 WORK PERMIT No. _____
LOCATION 670.3' East and 600' South of the NW corner.

YOU ARE HEREBY AUTHORIZED TO To perforate & Squeeze at 9942.

PERMIT REQUESTED BY Wallace H. Brown, Eng. TD 12,858'
Company Representative

AUTHORIZED BY _____
ARSENE P. EDWARDS
District Manager District Office

DEPARTMENT OF CONSERVATION
STATE OF LOUISIANA

- PERFORATE AND SQUEEZE RECORD -

DATE WORK DONE 5-11-54

WORK PERMIT NO. 56882
WORK SERIAL NO. 445

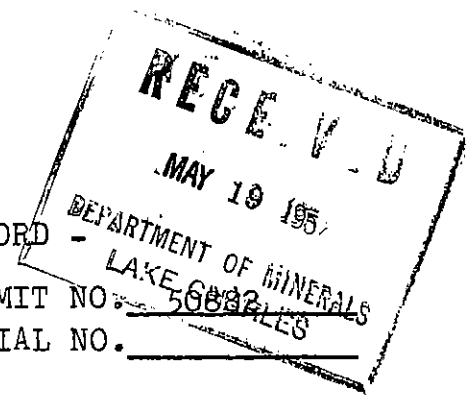

(One copy to be filed with the District Office)

N O T E:

THIS REPORT WILL BE RETURNED IF NOT PROPERLY FILLED IN AND
SIGNES

PARISH Cameron FIELD Crab Lake SEC. 29 TWP. 15 SRGE 5W

COMPANY Forest Oil Corp. LEASE Dr. M. O. Miller WELL NO. 2

TOTAL DEPTH 12,858' NEW OR OLD WELL New

SIZE CASING 5 1/2" OD DEPTH OF CASING 12,489'

DEPTH OF PLUG BELOW PERFORATION 10,977'

PERFORATED FROM 9942' TO 9915'

NUMBER OF HOLES 4 SIZE OF HOLES 1/2"

PERFORATION COMPANY Lane Wells TRUCK NUMBER 402

METHOD OF PLACING CEMENT Pump

WHERE CEMENT RETAINER SET: DEPTH 9930' FT.

BARRELS OF WATER PUMPED BEFORE CEMENT 5 AFTER 5

BREAKDOWN PRESSURE 5000 LBS. FINAL PRESSURE 5700 LBS.

PURPOSE OF SQUEEZE JOB Shut off possible water & insure cement around casing.

SQUEEZE JOB DONE BY Halliburton Oil Well Cementing Company

REMARKS: _____

THIS WORK WAS DONE ACCORDING TO THE RULES AND REGULATIONS OF THE
DEPARTMENT OF CONSERVATION DIVISION.

SIGNED: FOREST OIL CORPORATION
C O M P A N Y

Wallace H. Brown
Representative

PERFORATING DATA SHEET

LANE-WELLS COMPANY

Number Jobs This Trip 1

District So La Operating Base L.C. Date 5-11-54 S.O. # 211277
 Truck No. 4412 Operator E. D. Bennett Helper T. J. ...
 Customer Forest Oil Corp Authorized Agent ...
 Name of Well M.O. ... No. 2 Field ...
 State La. County/Parish ...

Job Scheduled _____ A.M. Arrived At _____ Location _____ A.M.
 P.M. Landing _____ P.M.
 On Job _____ A.M. Off Job _____ A.M.
 P.M. M. Res. P.M. M. Res.

Standby Time _____ Max. Temp. _____ ° F.
 New or Old Well New Purpose of Perforating ... Kind of Fluid 3.2-5.5 Level 7 in 12
 Casing Record 5 7/8" 200' Cemented In ... Liner Record _____ Cemented In _____
 Customer's Depth 10,987 Measure Method ... Zero Point 1 A.R.
 Lane-Wells Depth _____ Size Gun _____ No. _____ No. _____ Type _____ Controller No. _____ No. _____
 Bullet Size 4 Holes from 989 to _____ Ft. Holes from _____ to _____ Ft.
 Holes from _____ to _____ Ft. Shooting Zones Approved By: ... Title _____

	Run No.	Run No.	Run No.	Run No.	Run No.	Run No.
1						
2						
3						
4						
5						
6						
7						
8						
9						
10						
11						
12						
13						
14						
15						
16						
17						
18						
19						
20						
21						
22						
23						
24						
25						
26						
27						
28						
29						
30						

RECEIVED

MAY 15 1954

DEPARTMENT OF MINERALS

LAKE CHARLES

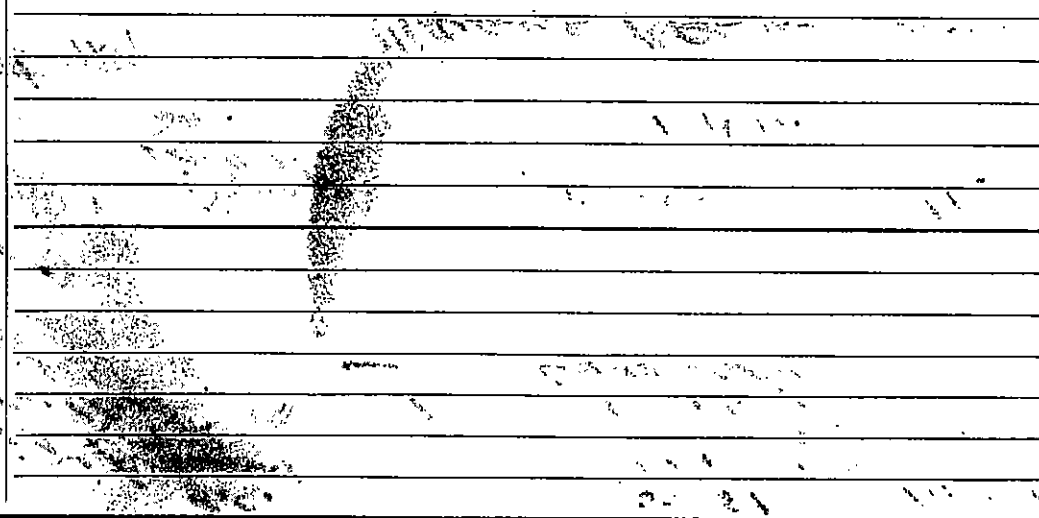
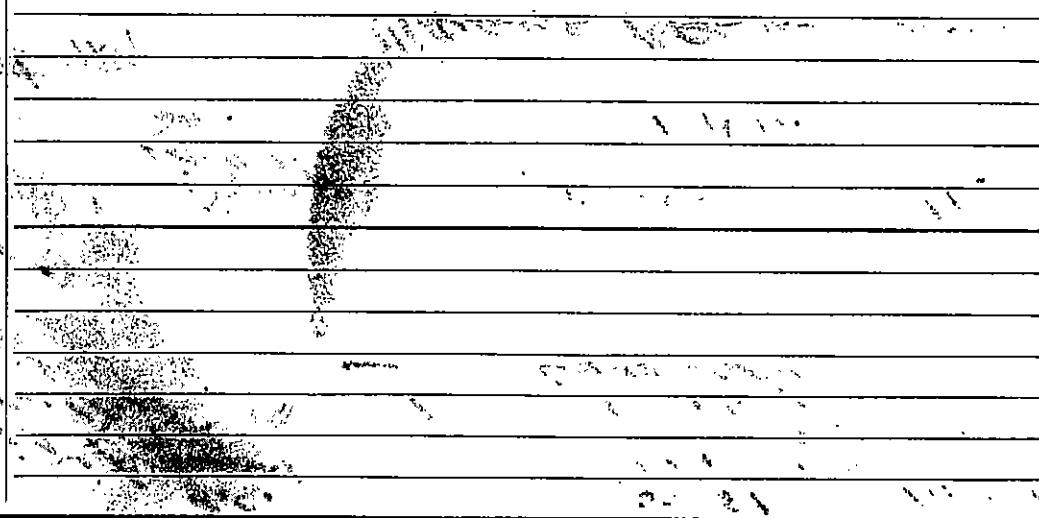
RUNNING TIME	REMARKS
1) In From _____ to _____ A.M. P.M. Out From _____ to _____ A.M. P.M. Fluid _____ In _____ Out _____ Holes _____ Total _____ Misses _____ Total _____	
2) In From _____ to _____ A.M. P.M. Out From _____ to _____ A.M. P.M. Fluid _____ In _____ Out _____ Holes _____ Total _____ Misses _____ Total _____	
3) In From _____ to _____ A.M. P.M. Out From _____ to _____ A.M. P.M. Fluid _____ In _____ Out _____ Holes _____ Total _____ Misses _____ Total _____	
4) In From _____ to _____ A.M. P.M. Out From _____ to _____ A.M. P.M. Fluid _____ In _____ Out _____ Holes _____ Total _____ Misses _____ Total _____	
5) In From _____ to _____ A.M. P.M. Out From _____ to _____ A.M. P.M. Fluid _____ In _____ Out _____ Holes _____ Total _____ Misses _____ Total _____	
6) In From _____ to _____ A.M. P.M. Out From _____ to _____ A.M. P.M. Fluid _____ In _____ Out _____ Holes _____ Total _____ Misses _____ Total _____	

Mileage: From _____ to _____
 Mileage: From _____ to _____

WORK PERMIT

PERMIT TO Perforate DATE May 11, 1954
PARISH Cameron FIELD Wildcat
COMPANY Forest Oil Corp.
ADDRESS 1229 Milam Bldg., San Antonio, Texas
WELL NAME Dr. M. O. Miller No. 2 SEC. 29 T. 15S R. 5W
WELL PERMIT SERIAL No. 50882 WORK PERMIT No. _____
LOCATION 670.3' East and 600' South of NW corner

YOU ARE HEREBY AUTHORIZED TO To perforate 9918' to 9925' by
Schlumberger with 4 holes per ft. Perforate for Prod. and
DST

TD 12858'

PERMIT REQUESTED BY John C. Willis
Company Representative

AUTHORIZED BY _____

ARSENE P. EDWARDS
District Office
District Manager

WORK PERMIT

PERMIT TO Plugback DATE May 11, 1954
PARISH Cameron FIELD Wildcat
COMPANY Forest Oil Corp.
ADDRESS 1229 Milam Bldg., San Antonio, Texas
WELL NAME Dr. M. O. Miller No. 2 SEC. 29 T. 15S R. 5W
WELL PERMIT SERIAL No. 50882 WORK PERMIT No. _____
LOCATION 670.3' East & 600' South of the NW corner

YOU ARE HEREBY AUTHORIZED TO Set Model "K" bridge plug at
10,990'. Dump 13' cement on top of plug

PERMIT REQUESTED BY John C. Willis TD 12,853'
Company Representative

AUTHORIZED BY
ARSENE P. EDWARDS
District Manager District Office

DEPARTMENT OF CONSERVATION
STATE OF LOUISIANA

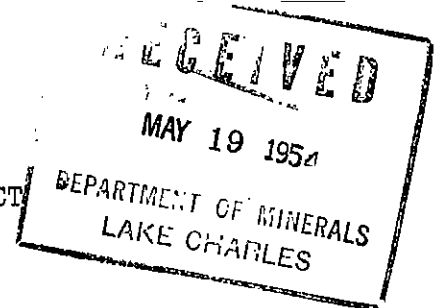

-----DISTRICT-----

WELL COMPLETION OR RECOMPLETION REPORT

OIL WELL() ' One copy to be filed with District Office ' COMPLETION(X)
' within three (3) days of date of completion ' RECOMPLETION
Dis. Well() ' or recompletion (as per Order No. 29-A ' ()
' Section X, Paragraph A, Article 1). ' Permit
GAS WELL(X) ----- Serial No. 50882

PARISH Cameron FIELD ^{W.C.} Crab Lake / SEC 29 TWP 15S RNG 5W

COMPANY Forest Oil Corp. LEASE Dr. M. O. WELL NO 2

DRILLING CONTRACTOR Winn Hawkins DATE SPUDED (OR W.O.) 2-21-54
Miller

DATE COMPLETED OR RECOMPLETED 5-15 19 54, AT 8:00 A.M. P.M.

C O M P L E T I O N D A T A :

INITIAL PRODUCTION _____ BBLs./ (NET)
TUBING PRESSURE 3625 #/SQ. IN. GAS FLOWING(X) SHUT IN()
CASING PRESSURE Packer Set #/SC. IN. GA.
CHOKE _____ SIZE 1/8" POSITIVE(X) ADJUSTABLE()
B.S. &W. None PERCENT SALT WATER(None) WASH WATER(None)
GAS VOLUME 1,250 MCF/DAY
GAS/OIL RATIO 50,000 CF/BBLs
GRAVITY 50.2 (60° A.P.I.)
PRODUCING DEPTH 9918 FT. TO 9925 FT.
PERFORATED YES(X) NO() BOTTOM TUBING 9880 FT. SIZE 2-3/8 IN.
CASING(OIL STRING) SIZE 5 1/2 IN. I.D. (4.9) O.D. (5 1/2) BOTTOM SEAT 12,489 FT.
TOTAL DEPTH DRILLED 12,858 FT. DERRICK FLOOR ELEVATION 18 FT.

(Additional clearance is requested for _____ barrels of oil produced on
drillstem or other production tests. (See Section X, Paragraph B, of Order No.
29-A On reverse side.)

FORM 3DM-1R
(Over)

FOREST OIL CORPORATION
COMPANY
Wallas H Brown
COMPANY REPRESENTATIVE

This side to be used when requesting clearance for oil produced on Drill Stem Test or other production tests: made previous to official completion or recompletion.

Section X, Paragraph B of Order No.29--A

Allowables given to wells for oil produced on drill stem tests, production test and miscellaneous production of oil shall be in accordance with the following rule:

All operators are required, with in five days, to file three signed copies of the record of the daily production from the well, showing the number of hours the well produced and the interval of production: as "from 8:00 A.M., August 5 to 3:00 P.M., August 8, 1942."

T E S T D A T A

DATE OF TEST	TIME OF TEST	AMOUNT OF OIL PRODUCED
_____ 19 ____	_____ .M. TO _____ .M.	_____ BARRELS
_____ 19 ____	_____ .M. TO _____ .M.	_____ BARRELS
_____ 19 ____	_____ .M. TO _____ .M.	_____ BARRELS
_____ 19 ____	_____ .M. TO _____ .M.	_____ BARRELS
_____ 19 ____	_____ .M. TO _____ .M.	_____ BARRELS
_____ 19 ____	_____ .M. TO _____ .M.	_____ BARRELS
_____ 19 ____	_____ .M. TO _____ .M.	_____ BARRELS
_____ 19 ____	_____ .M. TO _____ .M.	_____ BARRELS
_____ 19 ____	_____ .M. TO _____ .M.	_____ BARRELS
_____ 19 ____	_____ .M. TO _____ .M.	_____ BARRELS

TOTAL: _____
_____ BARRELS

The above total barrels of oil was produced from _____ Ft. to _____ Ft.

REMARKS. _____

MINERALS DIVISION
DEPARTMENT OF CONSERVATION
STATE OF LOUISIANA

- PLUG(PLUG-BACK) RECORD -

DATE WORK DONE 5-17-54

RECEIVED
MAY 19 1954
DEPARTMENT OF MINERALS
WORK PERMIT NO. 50882
WORK SERIAL NO. LC 037 #46

(One copy to be filed with the District Office)

NOTE:

THIS REPORT WILL BE RETURNED IF NOT PROPERLY FILLED IN AND SIGNED

PARISH Cameron FIELD Crab Lake SEC 29 TWP 15 SRCE 5W

COMPANY Forest Oil Corp. LEASE Dr. M. O. Miller WELL NO. 2

TOTAL DEPTH 12,858' NEW OR OLD WELL New

SIZE CASING 5 1/2" DEPTH OF CASING 12,489'

CEMENT RETAINER SET AT 10,990'

DEPTH OF PLUG FROM 10,990' TO 10,977'

NUMBER OF SACKS 2 NUMBER OF HOURS CEMENT SET 24

PURPOSE OF PLUG Separate sand @ 11,144' - 11,152' from 9918' - 9925'.

PLUG JOB DONE BY Lane Wells

METHOD OF PLACING CEMENT Dump boiler

BARRELS OF WATER BEFORE CEMENT - AFTER -

RESULTS _____

PLUG JOB DONE BY Lane Wells

REMARKS: _____

THIS WORK WAS DONE ACCORDING TO THE RULES AND REGULATIONS OF THE DEPARTMENT OF CONSERVATION, MINERALS DIVISION.

SIGNED FOREST OIL CORPORATION
COMPANY

Walter H. Brown
Representative

May 19, 1954

Mr. Thos. N. Winfield, Chief Eng.
Department of Conservation
State Capital Building
Baton Rouge, Louisiana

Dear Sir:

Find enclosed copy of Log of Well and Schlumberger of
Forest Oil Corporation's Dr. H. O. Miller No. 2, Wildcat,
Cameron Parish, Louisiana. Serial No. 50832.

Yours very truly,

ARSENIE P. EDWARDS
District Manager
Lake Charles, La.

APB:dab

Encl.

2 cc: State Geologist
Baton Rouge, La.

May 26, 1954

Forest Oil Corporation
Station 2, Box 1401
Lafayette, Louisiana

Gentlemen:

GAS CLEARANCE

This will be your authority to produce your gas well, Dr. W. C. Miller #2, Wildcat, Cameron Parish, Louisiana at the rate of 2500 MCF per day effective May 27, for the month of May, 1954.

No gas from this well may be flared and immediate notice of any cessation of market must be given this office. Liquid hydrocarbons produced from this well are legal and must be reported on statewide production Form R-1, revised. Serial No. 30862.

Yours very truly,

JAMES P. HOWARDS
District Manager
Lake Charles, La.

APR 26 1954

cc: No authorized transporter
cc: Department of Conservation, Baton Rouge, La.
cc: Department of Interior, Lafayette, La.

P
DEPARTMENT OF CONSERVATION

September 18, 1956

C
O
P
Y

Mr. Thos. M. Winfield, Chief Engr.
Department of Conservation
State Capitol Building
Baton Rouge, Louisiana

Dear Sir:

Find enclosed copy of Log of Well of Forest Oil Corporation's
Dr. M. O. Miller No. 2, Crab Lake Field, Cameron Parish, Louisiana.
Serial No. 50882.

Yours very truly,

ARSENE P. EDWARDS
District Manager
Lake Charles, La.

APE:dsg

Encl.

2 cc: State Geologist
Baton Rouge, La.

MINERALS DIVISION
DEPARTMENT OF CONSERVATION
STATE OF LOUISIANA

Workover
L. C. #17

WORK PERMIT

PERMIT TO Workover DATE April 14, 1964
PARISH Cameron FIELD Crab Lake
COMPANY Forest Oil Corp.
ADDRESS P. O. Box 1125 OCS, Lafayette, La.
WELL NAME Dr. M. O. Miller No. 2 SEC 29 T 15s R 5w
WELL PERMIT SERIAL No. 50882 WORK PERMIT No. _____
LOCATION _____

YOU ARE HEREBY AUTHORIZED TO Squeeze off present perms. 9918-26'
Mill out retainers at 9930' and 10990'. Test perf. 11, 144-152'
If test satisfactory, recomplete. Subject to cancellation
of allowable. TD 12858'

PERMIT REQUESTED BY JOHN C. WILLIS
Company Representative

AUTHORIZED BY *W. G. White*
WILLIAM G. WHITE
Lake Charles, La.
District Office

MINERALS DIVISION
DEPARTMENT OF CONSERVATION
STATE OF LOUISIANA

Squeeze
L. C., #39
#1

WORK PERMIT

PERMIT TO Squeeze DATE April 23, 1964
PARISH Cameron FIELD Crab Lake
COMPANY Forest Oil Corp.
ADDRESS P. O. Box 1125 OGS, Lafayette, La.
WELL NAME M. O. Miller No. 2 SEC. 29 T. 15s R. 5w
WELL PERMIT SERIAL No. 35422 WORK PERMIT No. _____
LOCATION _____

YOU ARE HEREBY AUTHORIZED TO Squeeze perf. 9918-25' w/15 sxs.
cement.

PERMIT REQUESTED BY JOHN C. WILLIS TD 12858'
Company Representative

AUTHORIZED BY WILLIAM C. WILHITE
Lake Charles, La.
District Office

MINERAL DIVISION
DEPARTMENT OF CONSERVATION
STATE OF LOUISIANA

Perf.
L.C.#155

WORK PERMIT

PERMIT TO Perforate DATE April 27, 1964
PARISH Cameron FIELD Crab Lake
COMPANY Forest Oil Corp.
ADDRESS P. O. Box 1125 OCS, Lafayette, La.
WELL NAME M. O. Miller No. 2 SEC. 29 T. 15s R. 5w
WELL PERMIT SERIAL No. 50882 WORK PERMIT No. _____
LOCATION _____

YOU ARE HEREBY AUTHORIZED TO Perf. 11142-47' w/4 shots/ft.
by E.L. for test.

PERMIT REQUESTED BY JOHN C. WILLIS TD 12858'
Company Representative

AUTHORIZED BY *Willis*
WILLIAM C. WILHITE
Lake Charles, La.
District Office

MINERAL DIVISION Squeeze
DEPARTMENT OF CONSERVATION L. C. #42 #2
STATE OF LOUISIANA

WORK PERMIT

PERMIT TO Squeeze DATE April 27, 1964
PARISH Cameron FIELD Crab Lake
COMPANY Forest Oil Corp.
ADDRESS P. O. Box 1125 OCS, Lafayette, La.
WELL NAME M. O. Miller No. 2 SEC. 29 T. 15 R. 5w
WELL PERMIT SERIAL No. 50882 WORK PERMIT No. _____
LOCATION _____

YOU ARE HEREBY AUTHORIZED TO Squeeze perf. 11144-52' w/40 sxs.
cement.

PERMIT REQUESTED BY JOHN C. WILLIS TD 12858'
Company Representative

AUTHORIZED BY *Willis*
WILLIAM C. WILHITE
Lake Charles, La.
District Office

LANE-WELLS COMPANY
A Division of Dresser Industries
COMPLETION SERVICE DATA SHEET

Permittable. ✓

DATE

Customer EXIST c/o Job Scheduled 4-27 200 AM
Well No. Dr M.D. Miller #2 Arrived Location 7-20 12⁰⁰ AM
Field Grab Lake On Job 4-27 530 PM
SO No. 103755 Off Job 4-27 730 PM

Customer Depth 12000
Lane-Well Depth 11170 TDH
Zero Point 18' A.H. U.H.F.
Perm. Ref. Datum D.H.F.

Hrs. Standby _____

Top of Cement _____

Services Performed on This Set Up: GP K/S _____ PFC _____ R/A _____ B/P _____ PKR _____ Other _____

Subsurface Tools Run M.S. Series-Type N.C.F. Size 3 5/8 No. of Runs 1 Fluid S/W
Wt.-Vis. FULL
Level _____
Max. Temp. _____

Casing Size 5.5 From S&F To TD. Liner Size _____ From _____ To _____ Tubing Size _____

Plug-Pkr. Serial No. _____ Top ordered at _____ Top set at _____ Size _____ Kind _____ PO _____

Perforating Zones 20 Holes From 11173 To 11138 Setting Depths and/or
Perf. Zones Approved By John Gray Title _____
L-W Crew Hil-Field White
Truck No. P-1029 Dist. LC Base Lake Charles

	Run No.	Run No.	Run No.	Run No.	Run No.	Run No.
1	1					
2						
3						
4						
5						
6						
7						
8						
9						
10						
11						
12						
13						
14						
15						
16						
17						
18						
19						
20						
21						
22						
23						
24						
25						

RECEIVED
APR 23 1964
DEPARTMENT OF MINERALS
LAKE CHARLES

RUNNING TIME		C.C. Depths	LW	Other			
1) In From _____ to _____	A.M. P.M.	C.C. Depths This Run					
Out From _____ to _____	A.M. P.M.						
Fluid _____							
In _____ Out _____							
Holes _____ Total _____							
Misses _____ Total _____	Closing of firing switch witnessed by _____						
2) In From _____ to _____	A.M. P.M.	C.C. Depths This Run					
Out From _____ to _____	A.M. P.M.						
Fluid _____							
In _____ Out _____							
Holes _____ Total _____							
Misses _____ Total _____	Closing of firing switch witnessed by _____						
3) In From _____ to _____	A.M. P.M.	C.C. Depths This Run					
Out From _____ to _____	A.M. P.M.						
Fluid _____							
In _____ Out _____							
Holes _____ Total _____							
Misses _____ Total _____	Closing of firing switch witnessed by _____						
4) In From _____ to _____	A.M. P.M.	C.C. Depths This Run					
Out From _____ to _____	A.M. P.M.						
Fluid _____							
In _____ Out _____							
Holes _____ Total _____							
Misses _____ Total _____	Closing of firing switch witnessed by _____						
5) In From _____ to _____	A.M. P.M.	C.C. Depths This Run					
Out From _____ to _____	A.M. P.M.						
Fluid _____							
In _____ Out _____							
Holes _____ Total _____							
Misses _____ Total _____	Closing of firing switch witnessed by _____						
6) In From _____ to _____	A.M. P.M.	C.C. Depths This Run					
Out From _____ to _____	A.M. P.M.						
Fluid _____							
In _____ Out _____							
Holes _____ Total _____							
Misses _____ Total _____	Closing of firing switch witnessed by _____						

Mileage: From _____ to _____

Mileage: From _____ to _____

#4

MINERALS DIVISION
DEPARTMENT OF CONSERVATION
STATE OF LOUISIANA

Plugback
L. C. #25

WORK PERMIT

PERMIT TO Plug (Plugback) DATE April 28, 1964
PARISH Cameron FIELD Crab Lake
COMPANY Forest Oil Corp.
ADDRESS P. O. Box 11225 OCS, Lafayette, La.
WELL NAME M. O. Miller No. 2 SEC 29 T. 15s R. 5w
WELL PERMIT SERIAL No. 50882 WORK PERMIT No. _____
LOCATION _____

YOU ARE HEREBY AUTHORIZED TO Set cast iron bridge plug @11,100
w/10' cmt. on top.

TD 12858'

PERMIT REQUESTED BY JOHN C. WILLIS
Company Representative

AUTHORIZED BY *Willis*
WILLIAM C. WILHITE
Lake Charles La.
District Office

#5

MINERALS DIVISION
DEPARTMENT OF CONSERVATION
STATE OF LOUISIANA

Perf.
L. C. #156

WORK PERMIT

PERMIT TO Perforate DATE April 28, 1964
PARISH Cameron FIELD Crab Lake
COMPANY Forest Oil Corp.
ADDRESS P. O. Box 1125 OCS, Lafayette, La.
WELL NAME M. O. Miller No. 2 SEC 29 T. 15a 15s
WELL PERMIT SERIAL No. 50882 WORK PERMIT No. _____
LOCATION _____

YOU ARE HEREBY AUTHORIZED TO Perf. 9905-15' w/4 shots/ft.
by E. L. forttest.

TD 12858'

PERMIT REQUESTED BY JOHN C. WILLIS
Company Representative

AUTHORIZED BY *Willis*
WILLIAM C. WILHITE
Lake Charles, La.
District Office

LANE-WELLS COMPANY
A Division of Dresser Industries
COMPLETION SERVICE DATA SHEET

DATE

Customer FLYERS OIL Job Scheduled 4-28 5:00 ~~AM~~ ~~PM~~
Well No. Dr. M. D. Miller #2 Arrived Location 4-28 4:00 ~~AM~~ ~~PM~~
Field Grab Lake On Job 4-28 6:10 ~~AM~~ ~~PM~~
SO No. 108758 Off Job 4-25 6:50 ~~AM~~ ~~PM~~

Customer Depth 11090
Lane-Wells Depth 11090
Zero Point 18. Above B.H.F.
Perm. Ref. Datum B.H.F.
Top of Cement _____

Hrs. Standby _____

Services Performed on This Set Up: GP _____ K/S PFC _____ R/A _____ B/P _____ PKR _____ Other _____

Subsurface Tools Run KB Series-Type HCF Size 3 7/8 No. of Runs 1 Fluid SW
Wt.-Vis. _____
Level Full
Max. Temp. _____

Casing Size 3.5 From Surf To T.D. Liner Size _____ From _____ To _____ Tubing Size _____

Plug-Pkr. Serial No. _____ Top ordered at _____ Top set at _____ Size _____ Kind _____ PO _____

Perforating Zones 24 Holes From 9916 To 9910 Setting Depths and/or
Perf. Zones Approved By W. Am. King Title _____
L-W Crew Stitchfield White
Truck No. 1029 Dist. 110 Base Lake Charles

	Run No. 1	Run No.	Run No.	Run No.	Run No.	Run No.
1	9916 17					
2	24					
3	main holes					
4						
5						
6						
7						
8						
9						
10						
11						
12						
13						
14						
15						
16						
17						
18						
19						
20						
21						
22						
23						
24						
25						

APR 20 1964
FILED
LAW OFFICES

RUNNING TIME

RUNNING TIME		C.C. Depths LW Other					
1)	In From _____ to _____	A.M. P.M.	C.C. Depths This Run				
	Out From _____ to _____	A.M. P.M.					
	Fluid _____						
	In _____ Out _____						
	Holes _____ Total _____						
	Misses _____ Total _____		Closing of firing switch witnessed by _____				
2)	In From _____ to _____	A.M. P.M.	C.C. Depths This Run				
	Out From _____ to _____	A.M. P.M.					
	Fluid _____						
	In _____ Out _____						
	Holes _____ Total _____						
	Misses _____ Total _____		Closing of firing switch witnessed by _____				
3)	In From _____ to _____	A.M. P.M.	C.C. Depths This Run				
	Out From _____ to _____	A.M. P.M.					
	Fluid _____						
	In _____ Out _____						
	Holes _____ Total _____						
	Misses _____ Total _____		Closing of firing switch witnessed by _____				
4)	In From _____ to _____	A.M. P.M.	C.C. Depths This Run				
	Out From _____ to _____	A.M. P.M.					
	Fluid _____						
	In _____ Out _____						
	Holes _____ Total _____						
	Misses _____ Total _____		Closing of firing switch witnessed by _____				
5)	In From _____ to _____	A.M. P.M.	C.C. Depths This Run				
	Out From _____ to _____	A.M. P.M.					
	Fluid _____						
	In _____ Out _____						
	Holes _____ Total _____						
	Misses _____ Total _____		Closing of firing switch witnessed by _____				
6)	In From _____ to _____	A.M. P.M.	C.C. Depths This Run				
	Out From _____ to _____	A.M. P.M.					
	Fluid _____						
	In _____ Out _____						
	Holes _____ Total _____						
	Misses _____ Total _____		Closing of firing switch witnessed by _____				

Mileage: From _____ to _____

Mileage: From _____ to _____

#6

MINERALS DIVISION
DEPARTMENT OF CONSERVATION
STATE OF LOUISIANA

J.C #158
perf.

WORK PERMIT

PERMIT TO Perforate DATE 4/29/64
PARISH Cameron FIELD Crab Lake
COMPANY ~~Proctor~~ Forest Oil Corp.
ADDRESS P. O. Box 1125, OCS, Lafayette, La.
WELL NAME M. O. Miller No. 2 SEC 29 T. 15S R. 5W
WELL PERMIT SERIAL No. 50882 WORK PERMIT No. _____
LOCATION _____

YOU ARE HEREBY AUTHORIZED TO Perf. 9,915-21' w/4 shots/ft.
by E. L. FOR test.

PERMIT REQUESTED BY JOHN C. WILLIS TD 12,858'
Company Representative

AUTHORIZED BY 
W. C. WILHITE - District Manager - Lake Charles
District Office

MINERALS DIVISION
DEPARTMENT OF CONSERVATION Perf. & Sq.
STATE OF LOUISIANA L. C. #70

WORK PERMIT

PERMIT TO Perforate & Squeeze DATE 4/30/64
PARISH Cameron FIELD Crab Lake
COMPANY FOREST OIL CORP.
ADDRESS P. O. Box 1125, OCS, Lafayette, La.
WELL NAME M. O. Miller No. 2 SEC. 29 T 15S R 5W
WELL PERMIT SERIAL No. 50882 WORK PERMIT No. _____
LOCATION _____

YOU ARE HEREBY AUTHORIZED TO Perf. 10,980' by E. L. & Sq.
with 35 sacks cement.

PERMIT REQUESTED BY JOHN C. WILLIS TD 12,858
Company Representative

AUTHORIZED BY _____
W. C. WILHITE - District Manager - Lake Charles
District Office

#7

MINERALS DIVISION
DEPARTMENT OF CONSERVATION
STATE OF LOUISIANA

Squeeze
L. C. #2x 47

WORK PERMIT

PERMIT TO Squeeze DATE 4/30/64
PARISH Cameron FIELD Crab Lake
COMPANY ~~XXXXXXXXXXXXXXXXXXXX~~ FOREST OIL CORPORATION
ADDRESS P. O. Box 1125, OCS, Lafayette, Louisiana
WELL NAME M. O. Miller No. 2 SEC. 29 T. 15S R. 5W
WELL PERMIT SERIAL No. 50882 WORK PERMIT No. _____
LOCATION _____

YOU ARE HEREBY AUTHORIZED TO Squeeze perfs. 9905-21' with
35 sxs. cement.

PERMIT REQUESTED BY JOHN C. WILLIS TD 12,858'
Company Representative

AUTHORIZED BY (Signature)
W. C. WILHITE District Manager
District Office

Jerrint Verba

LANE-WELLS COMPANY
 A Division of Dresser Industries
 COMPLETION SERVICE DATA SHEET
 4/30/64
DATE

Customer FORREST Oil Co Job Scheduled _____ AM
 Well No. DR. M. D. MILLER #2 Arrived Location _____ PM
 Field CRAB LAKE On Job _____ AM
 SO No. 103790 Off Job _____ PM
 Hrs. Standby _____ Top of Cement _____

Customer Depth 11090
 Lane-Well Depth 11090
 Zero Point _____
 Perm. Ref. Datum _____

Services Performed on This Set Up: GP _____ K/S _____ PFC _____ R/A _____ B/P _____ PKR _____ Other _____

Subsurface Tools Run _____ Series-Type _____ Size _____ No. of Runs _____ Fluid SIW
 _____ _____ _____ _____ Wt.-Vis. _____
 _____ _____ _____ _____ Level FULL
 _____ _____ _____ _____ Max. Temp. _____

Casing Size 5 1/2 From _____ To _____ Liner Size _____ From _____ To _____ Tubing Size _____
 Set at _____

Plug-Pkr. Serial No. _____ Top ordered at _____ Top set at _____ Size _____ Kind _____ PO _____

Perforating Zones _____ Holes From 10976 To 10975 Setting Depths and/or
 _____ Perf. Zones Approved By J. J. [Signature] Title _____
 _____ L-W Crew LANDRY WHITE
 _____ Truck No. P1029 Dist. L.C. Base L.C.

	Run No. <u>1</u>	Run No.	Run No.	Run No.	Run No.	Run No.
1	<u>10976 = 77</u>					
2						
3						
4						
5						
6						
7						
8						
9						
10						
11						
12						
13						
14						
15						
16						
17						
18						
19						
20						
21						
22						
23						
24						
25						

RECEIVED
 MAY 1 1964
 DEPARTMENT OF MINERALS
 LAKE CHARLES

RUNNING TIME

1)		A.M.	C.C. Depths						
In From _____ to _____		P.M.	LW Other						
Out From _____ to _____		A.M.	C.C. Depths						
Fluid _____		P.M.	This Run						
In _____ Out _____									
Holes _____ Total _____									
Misses _____ Total _____									
			Closing of firing switch witnessed by _____						
2)		A.M.	C.C. Depths						
In From _____ to _____		P.M.	This Run						
Out From _____ to _____		A.M.							
Fluid _____		P.M.							
In _____ Out _____									
Holes _____ Total _____									
Misses _____ Total _____									
			Closing of firing switch witnessed by _____						
3)		A.M.	C.C. Depths						
In From _____ to _____		P.M.	This Run						
Out From _____ to _____		A.M.							
Fluid _____		P.M.							
In _____ Out _____									
Holes _____ Total _____									
Misses _____ Total _____									
			Closing of firing switch witnessed by _____						
4)		A.M.	C.C. Depths						
In From _____ to _____		P.M.	This Run						
Out From _____ to _____		A.M.							
Fluid _____		P.M.							
In _____ Out _____									
Holes _____ Total _____									
Misses _____ Total _____									
			Closing of firing switch witnessed by _____						
5)		A.M.	C.C. Depths						
In From _____ to _____		P.M.	This Run						
Out From _____ to _____		A.M.							
Fluid _____		P.M.							
In _____ Out _____									
Holes _____ Total _____									
Misses _____ Total _____									
			Closing of firing switch witnessed by _____						
6)		A.M.	C.C. Depths						
In From _____ to _____		P.M.	This Run						
Out From _____ to _____		A.M.							
Fluid _____		P.M.							
In _____ Out _____									
Holes _____ Total _____									
Misses _____ Total _____									
			Closing of firing switch witnessed by _____						

Mileage: From _____ to _____

Mileage: From _____ to _____

MINERAL DIVISION
DEPARTMENT OF CONSERVATION
STATE OF LOUISIANA

Perf.
L. C. #159

WORK PERMIT

PERMIT TO Perforate DATE May 1, 1964
PARISH Cameron FIELD Crab Lake
COMPANY Forest Oil Corp.
ADDRESS P. O. Box 1125 OCS Lafayette, La.
WELL NAME M. O. Miller No 2 SEC 29 T 15s R 5w
WELL PERMIT SERIAL No 35422 WORK PERMIT No _____
LOCATION _____

YOU ARE HEREBY AUTHORIZED TO Perf. 10996-11003' w/4 shots/ft.
by E. L. for test.

PERMIT REQUESTED BY JOHN C. WILLIS TD 12858'
Company Representative

AUTHORIZED BY WILLIAM C. WILHITE
Lake Charles, La.
District Office

Permit Verbal

LANE-WELLS COMPANY
A Division of Dresser Industries
COMPLETION SERVICE DATA SHEET

5/1/64
DATE

Customer FOREST OIL CORP Job Scheduled _____ AM
Well No. M.O. MILLER #2 Arrived Location _____ PM
Field CAMB LAKE On Job _____ AM
SO No. 103791 Off Job 3:30 - 5/1 _____ PM
Hrs. Standby _____ Top of Cement _____

Customer Depth 11090
Lane-Well Depth TDIR 11030
Zero Point _____
Perm. Ref. Datum _____

Services Performed on This Set Up: GP _____ K/S _____ PFC _____ R/A _____ B/P _____ PKR _____ Other _____

Subsurface Tools Run _____ Series-Type _____ Size _____ No. of Runs _____ Fluid SLW
Wt.-Vis. _____
Level FULL
Max. Temp. _____

Casing Size 5 1/2 From _____ To _____ Liner Size _____ From _____ To _____ Tubing Size _____
Set at _____

Plug-Pkr. Serial No. _____ Top ordered at _____ Top set at _____ Size _____ Kind _____ PO _____

Perforating Zones 28 Holes From 10998 To 10991 Setting Depths and/or
Perf. Zones Approved By John E. ... Title _____
L-W Crew BRADSHAW BRADSHAW
Truck No. D1029 Dist. J. E. Base J. E.

Run No.	Run No.	Run No.	Run No.	Run No.	Run No.
1	<u>10998 = 99</u>				
2					
3					
4					
5					
6					
7					
8					
9					
10					
11					
12					
13					
14					
15					
16					
17					
18					
19					
20					
21					
22					
23					
24					
25					

RECEIVED
MAY 4 1964
DEPT. OF ...

RUNNING TIME

RUNNING TIME		C.C. Depths LW Other					
1)	In From _____ to _____ Out From _____ to _____ Fluid _____ In _____ Out _____ Holes _____ Total _____ Misses _____ Total _____	A.M. P.M. A.M. P.M.	C.C. Depths This Run				
		Closing of firing switch witnessed by _____					
2)	In From _____ to _____ Out From _____ to _____ Fluid _____ In _____ Out _____ Holes _____ Total _____ Misses _____ Total _____	A.M. P.M. A.M. P.M.	C.C. Depths This Run				
		Closing of firing switch witnessed by _____					
3)	In From _____ to _____ Out From _____ to _____ Fluid _____ In _____ Out _____ Holes _____ Total _____ Misses _____ Total _____	A.M. P.M. A.M. P.M.	C.C. Depths This Run				
		Closing of firing switch witnessed by _____					
4)	In From _____ to _____ Out From _____ to _____ Fluid _____ In _____ Out _____ Holes _____ Total _____ Misses _____ Total _____	A.M. P.M. A.M. P.M.	C.C. Depths This Run				
		Closing of firing switch witnessed by _____					
5)	In From _____ to _____ Out From _____ to _____ Fluid _____ In _____ Out _____ Holes _____ Total _____ Misses _____ Total _____	A.M. P.M. A.M. P.M.	C.C. Depths This Run				
		Closing of firing switch witnessed by _____					
6)	In From _____ to _____ Out From _____ to _____ Fluid _____ In _____ Out _____ Holes _____ Total _____ Misses _____ Total _____	A.M. P.M. A.M. P.M.	C.C. Depths This Run				
		Closing of firing switch witnessed by _____					

Mileage: From _____ to _____
Mileage: From _____ to _____

MINERALS DIVISION
DEPARTMENT OF CONSERVATION
STATE OF LOUISIANA
Per.f. & Sq.
L. C. #75

WORK PERMIT #9

PERMIT TO Perf. & Squeeze DATE May 2, 1964
PARISH Cameron FIELD Crab Lake
COMPANY Forest Oil Corp.
ADDRESS P. O. Box 1125 CCS, Lafayette, La.
WELL NAME O. Miller No. 2 SEC. 29 T. 15s R. 5W
WELL PERMIT SERIAL No. 50882 WORK PERMIT No. _____
LOCATION _____

YOU ARE HEREBY AUTHORIZED TO Perf. 8722-23' and squeeze
with 95 sacks.

PERMIT REQUESTED BY JOHN C. WILLIS TDI 128581
Company Representative

AUTHORIZED BY *[Signature]*
WILLIAM G. WILLIAMS
Lake Charles, La.
District Office

MINERALS DIVISION
DEPARTMENT OF CONSERVATION
STATE OF LOUISIANA

Perf.
L. C. #166

WORK PERMIT

PERMIT TO Perforate DATE May 2, 1964
PARISH Cameron FIELD Crab Lake
COMPANY Forest Oil Corp.
ADDRESS P. O. Box 1125 OCS, Lafayette, La.
WELL NAME M. O. Miller No. 2 SEC. 29 T. 15 R. 5W
WELL PERMIT SERIAL No. 50882 WORK PERMIT No. _____
LOCATION _____

YOU ARE HEREBY AUTHORIZED TO Perf. 8714-20' with 4 shots/ft.
E. L. for test.

PERMIT REQUESTED BY JOHN C. WILLIS TD. 12858'
Company Representative

AUTHORIZED BY *W. Wilhite*
WILLIAM C. WILHITE
Lake Charles, La.
District Office

MINERALS DIVISION
DEPARTMENT OF CONSERVATION
STATE OF LOUISIANA

Squeeze
L. C. #48
#10

WORK PERMIT

PERMIT TO Squeeze DATE May 2, 1964
PARISH Cameron FIELD Crab Lake
COMPANY Forest Oil Corp.
ADDRESS P. O. Box 1125 OCS, Lafayette, La.
WELL NAME M. O. Miller No. 2 SEC. 29 T. 15s R. 5w
WELL PERMIT SERIAL No. 50882 WORK PERMIT No. _____
LOCATION _____

YOU ARE HEREBY AUTHORIZED TO Squeeze perf. 10996-11003' with
35 sacks cmt.

PERMIT REQUESTED BY JOHN C. WILLIS TD 12858'
Company Representative

AUTHORIZED BY *Willis*
WILLIAM C. WILHITE
Lake Charles, La.
District Office

Permit Verdal

LANE-WELLS COMPANY
A Division of Dresser Industries
COMPLETION SERVICE DATA SHEET

5/2/64
DATE

Customer FOREST OIL CORP Job Scheduled _____ AM
Well No. R10 MILLER # 2 Arrived Location _____ PM
Field CRAB LAKE On Job _____ AM
SO No. 103792 Off Job _____ PM
Hrs. Standby _____

Customer Depth 11090
Lane-Well Depth 9000 T.D.P.R.
Zero Point _____
Perm. Ref. Datum _____
Top of Cement _____

Services Performed on This Set Up: GP _____ K/S PFC _____ R/A _____ B/P _____ PKR _____ Other _____

Subsurface Tools Run _____ Series-Type _____ Size _____ No. of Runs _____ Fluid S/W
Wt.-Vis. _____
Level FULL
Max. Temp. _____

Casing Size 5 1/2 From _____ To _____ Liner Size _____ From _____ To _____ Tubing Size _____
Set at _____

Plug-Pkr. Serial No. _____ Top ordered at _____ Top set at _____ Size _____ Kind _____ PO _____

Perforating Zones 4 Holes From 8718 To 8717 Setting Depths and/or
Perf. Zones Approved By John Knox Title _____
L-W Crew HANDRY & CHARBELL
Truck No. 11029 Dist. L. E. Base L. E.

Run No.	Run No.	Run No.	Run No.	Run No.	Run No.
1					
2					
3					
4					
5					
6					
7					
8					
9					
10					
11					
12					
13					
14					
15					
16					
17					
18					
19					
20					
21					
22					
23					
24					
25					

RECEIVED
MAY 5 1964
LAKE CHARLES

RUNNING TIME

RUNNING TIME		C.C. Depths LW Other					
1)	In From _____ to _____ Out From _____ to _____ Fluid _____ In _____ Out _____ Holes _____ Total _____ Misses _____ Total _____	A.M. P.M. A.M. P.M.	C.C. Depths This Run				
		Closing of firing switch witnessed by _____					
2)	In From _____ to _____ Out From _____ to _____ Fluid _____ In _____ Out _____ Holes _____ Total _____ Misses _____ Total _____	A.M. P.M. A.M. P.M.	C.C. Depths This Run				
		Closing of firing switch witnessed by _____					
3)	In From _____ to _____ Out From _____ to _____ Fluid _____ In _____ Out _____ Holes _____ Total _____ Misses _____ Total _____	A.M. P.M. A.M. P.M.	C.C. Depths This Run				
		Closing of firing switch witnessed by _____					
4)	In From _____ to _____ Out From _____ to _____ Fluid _____ In _____ Out _____ Holes _____ Total _____ Misses _____ Total _____	A.M. P.M. A.M. P.M.	C.C. Depths This Run				
		Closing of firing switch witnessed by _____					
5)	In From _____ to _____ Out From _____ to _____ Fluid _____ In _____ Out _____ Holes _____ Total _____ Misses _____ Total _____	A.M. P.M. A.M. P.M.	C.C. Depths This Run				
		Closing of firing switch witnessed by _____					
6)	In From _____ to _____ Out From _____ to _____ Fluid _____ In _____ Out _____ Holes _____ Total _____ Misses _____ Total _____	A.M. P.M. A.M. P.M.	C.C. Depths This Run				
		Closing of firing switch witnessed by _____					

Mileage: From _____ to _____
Mileage: From _____ to _____

LANE-WELLS COMPANY
A Division of Dresser Industries
COMPLETION SERVICE DATA SHEET

Permit Variable, *Wally*

Customer Forest Oil Job Scheduled 07. 07. 1964 ~~AM~~ PM Customer Depth 9100
Well No. M.C. Miller #2 Arrived Location 1-4- 7:00 ~~AM~~ PM Lane-Wells Depth 9060 TDR
Field Grab Lake On Job 5-4- 9:00 ~~AM~~ PM Zero Point 17' Above H.H.F.
SO No. 103793 Off Job 1-4 12:00 ~~AM~~ PM Perm. Ref. Datum B.H.F.

Hrs. Standby _____ Top of Cement _____

Services Performed on This Set Up: GP _____ K/S PFC _____ R/A B/P _____ PKR _____ Other _____

Subsurface Tools Run G/H Series-Type 702 Size 3 5/8 No. of Runs 1 Fluid slu
Wt.-Vis. _____
Level FUN
Max. Temp. _____

Casing Size 8.5 From SURF To T.D. Liner Size _____ From _____ To _____ Tubing Size _____

Plug-Pkr. Serial No. _____ Top ordered at _____ Top set at _____ Size _____ Kind _____ PO _____

Perforating Zones 24 Holes From 5717 To 12711 Setting Depths and/or
Perf. Zones Approved By [Signature] Title Toolman
L-W Crew H. J. Field Randy Hardy
Truck No. P-1029 Dist. LC Base Lake Charles

Run No.	Run No.	Run No.	Run No.	Run No.	Run No.
1					
2					
3					
4					
5					
6					
7					
8					
9					
10					
11					
12					
13					
14					
15					
16					
17					
18					
19					
20					
21					
22					
23					
24					
25					

RECEIVED
MAY 5 1964
DEPARTMENT OF MINERALS
LAKE CHARLES

RUNNING TIME

1)						
In From _____ to _____	A.M.	C.C. Depths				
	P.M.	This Run				
Out From _____ to _____	A.M.					
	P.M.					
Fluid _____						
In _____ Out _____						
Holes _____ Total _____						
Misses _____ Total _____						
		Closing of firing switch witnessed by _____				
2)						
In From _____ to _____	A.M.	C.C. Depths				
	P.M.	This Run				
Out From _____ to _____	A.M.					
	P.M.					
Fluid _____						
In _____ Out _____						
Holes _____ Total _____						
Misses _____ Total _____						
		Closing of firing switch witnessed by _____				
3)						
In From _____ to _____	A.M.	C.C. Depths				
	P.M.	This Run				
Out From _____ to _____	A.M.					
	P.M.					
Fluid _____						
In _____ Out _____						
Holes _____ Total _____						
Misses _____ Total _____						
		Closing of firing switch witnessed by _____				
4)						
In From _____ to _____	A.M.	C.C. Depths				
	P.M.	This Run				
Out From _____ to _____	A.M.					
	P.M.					
Fluid _____						
In _____ Out _____						
Holes _____ Total _____						
Misses _____ Total _____						
		Closing of firing switch witnessed by _____				
5)						
In From _____ to _____	A.M.	C.C. Depths				
	P.M.	This Run				
Out From _____ to _____	A.M.					
	P.M.					
Fluid _____						
In _____ Out _____						
Holes _____ Total _____						
Misses _____ Total _____						
		Closing of firing switch witnessed by _____				
6)						
In From _____ to _____	A.M.	C.C. Depths				
	P.M.	This Run				
Out From _____ to _____	A.M.					
	P.M.					
Fluid _____						
In _____ Out _____						
Holes _____ Total _____						
Misses _____ Total _____						
		Closing of firing switch witnessed by _____				

Mileage: From _____ to _____

Mileage: From _____ to _____

#13

MINERALS DIVISION **Squeeze**
DEPARTMENT OF CONSERVATION L. C. #50
STATE OF LOUISIANA

WORK PERMIT

PERMIT TO Squeeze DATE May 5, 1964
PARISH Cameron FIELD Crab Lake
COMPANY Forest Oil Corp.
ADDRESS P. O. Box 1125 OGS, Lafayette, La.
WELL NAME M. O. Miller No. 2 SEC 29 T 15s R 5w
WELL PERMIT SERIAL No. 50882 WORK PERMIT No. _____
LOCATION _____

YOU ARE HEREBY AUTHORIZED TO Squeeze perms. 8714-20' with 55
sacks cmt.

PERMIT REQUESTED BY JOHN C. WILLIS TD 12858'
Company Representative

AUTHORIZED BY *Willis*
WILLIAM C. WHITE
Lake Charles, La.
District Office

#12

Acidize
L. #54

MINERALS DIVISION
DEPARTMENT OF CONSERVATION
STATE OF LOUISIANA

WORK PERMIT

PERMIT TO Acidize DATE May 5, 1964
PARISH Cameron FIELD Crab Lake
COMPANY Forest Oil Corp.
ADDRESS P. O. Box 1125 OCS, Lafayette, La.
WELL NAME M. O. Miller No. 2 SEC. 29 T. 15s R. 5w
WELL PERMIT SERIAL No. 50882 WORK PERMIT No. _____
LOCATION _____

YOU ARE HEREBY AUTHORIZED TO Acidize perfs. 8714-20' with 500
gas. mud acid with 300 cu. ft./bbls. Nitrogen

PERMIT REQUESTED BY JOHN C. WILLIS TD. 12858'
Company Representative

AUTHORIZED BY *Willie*
WILLIAM C. WILHITE
Lake Charles, La.
District Office

MINERALS DIVISION
DEPARTMENT OF CONSERVATION
STATE OF LOUISIANA

Perf.
L. C. #181

WORK PERMIT #15

PERMIT TO Perforate DATE May 7, 1964
PARISH Cameron FIELD Crab Lake
COMPANY Forest Oil Corp.
ADDRESS P. O. Box 1125 OCS, Lafayette, La.
WELL NAME M. O. Miller No. 2 SEC 29 T. 15s R. 5w
WELL PERMIT SERIAL No. 50882 WORK PERMIT No. _____
LOCATION _____

YOU ARE HEREBY AUTHORIZED TO Perf. 9919221' with 4 shots/ft. by
E. L. for comp.

PERMIT REQUESTED BY JOHN C. WILLIS TD 12858'
Company Representative

AUTHORIZED BY *Willis*
WILLIAM C. WILHITE
Lake Charles, La.
District Office

MINERALS DIVISION Squeeze
DEPARTMENT OF CONSERVATION L. C. #52 #14
STATE OF LOUISIANA

WORK PERMIT

PERMIT TO Squeeze DATE May 7, 1964
PARISH Cameron FIELD Crab Lake
COMPANY Forest Oil Corp.
ADDRESS P. O. Box 1125 OCS, Lafayette, La.
WELL NAME M. O. Miller No. 2 SEC 29 T 15s R 5w
WELL PERMIT SERIAL No. 50882 WORK PERMIT No. _____
LOCATION _____

YOU ARE HEREBY AUTHORIZED TO Squeeze perms. 9905-25' with 35
sxs. cmt.

PERMIT REQUESTED BY JOHN C. WILLIS TD 12858'
Company Representative

AUTHORIZED BY *Willis*
WILLIAM C. WILHITE
Lake Charles, La.
District Office

Perm. A. Keibal

LANE-WELLS COMPANY
A Division of Dresser Industries
COMPLETION SERVICE DATA SHEET

5-1-64
DATE

Customer Forest Oil Corp Job Scheduled 6:00 ~~5:00~~ ~~AM~~ PM
Well No. Miller #2 Arrived Location 5:30 ~~AM~~ PM
Field Coral Forks On Job 6:00 ~~AM~~ PM
SO No. 103796 Off Job 8:00 ~~AM~~ PM

Customer Depth 10,000'
Lane-Well Depth T.D.P. 9920
Zero Point 18' above P.M.F.
Perm. Ref. Datum Same
Top of Cement _____

Hrs. Standby 1/2

Services Performed on This Set Up: GP _____ K/S PFC _____ R/A _____ B/P _____ PKR _____ Other _____

Subsurface Tools Run 11.56m Series-Type 1117 Size 3 1/8" No. of Runs 1 Fluid Water
Wt.-Vis. _____
Level _____
Max. Temp. _____

Casing Size 5 1/2" From _____ To _____ Liner Size _____ From _____ To _____ Tubing Size _____
Set at _____

Plug-Pkr. Serial No. _____ Top ordered at _____ Top set at _____ Size _____ Kind _____ PO _____

Perforating Zones 8 Holes From 9917 To 9915 Setting Depths and/or
Perf. Zones Approved By John E. Jones Title _____
L-W Crew _____
Truck No. 1089 Dist. 2001 Base L.C.

Run No.	Run No.	Run No.	Run No.	Run No.	Run No.
1					
2					
3					
4					
5					
6					
7					
8					
9					
10					
11					
12					
13					
14					
15					
16					
17					
18					
19					
20					
21					
22					
23					
24					
25					

RECEIVED
MAY 11 1964
DEPARTMENT OF REVENUE
LAKE CHARLES

RUNNING TIME		C.C. Depths LW Other					
1)	In From _____ to _____	A.M. P.M.	C.C. Depths This Run				
	Out From _____ to _____	A.M. P.M.					
	Fluid _____						
	In _____ Out _____						
	Holes _____ Total _____						
	Misses _____ Total _____		Closing of firing switch witnessed by _____				
2)	In From _____ to _____	A.M. P.M.	C.C. Depths This Run				
	Out From _____ to _____	A.M. P.M.					
	Fluid _____						
	In _____ Out _____						
	Holes _____ Total _____						
	Misses _____ Total _____		Closing of firing switch witnessed by _____				
3)	In From _____ to _____	A.M. P.M.	C.C. Depths This Run				
	Out From _____ to _____	A.M. P.M.					
	Fluid _____						
	In _____ Out _____						
	Holes _____ Total _____						
	Misses _____ Total _____		Closing of firing switch witnessed by _____				
4)	In From _____ to _____	A.M. P.M.	C.C. Depths This Run				
	Out From _____ to _____	A.M. P.M.					
	Fluid _____						
	In _____ Out _____						
	Holes _____ Total _____						
	Misses _____ Total _____		Closing of firing switch witnessed by _____				
5)	In From _____ to _____	A.M. P.M.	C.C. Depths This Run				
	Out From _____ to _____	A.M. P.M.					
	Fluid _____						
	In _____ Out _____						
	Holes _____ Total _____						
	Misses _____ Total _____		Closing of firing switch witnessed by _____				
6)	In From _____ to _____	A.M. P.M.	C.C. Depths This Run				
	Out From _____ to _____	A.M. P.M.					
	Fluid _____						
	In _____ Out _____						
	Holes _____ Total _____						
	Misses _____ Total _____		Closing of firing switch witnessed by _____				

Mileage: From _____ to _____

Mileage: From _____ to _____

DEPARTMENT OF CONSERVATION
STATE OF LOUISIANA

LC

WELL COMPLETION OR RECOMPLETION REPORT

Lake Charles DISTRICT Re: Well Serial No.: 50882

Completed	<input type="checkbox"/>	Flowing	<input checked="" type="checkbox"/>	Operator:	<u>Forest Oil Corporation</u>
Recompleted	<input checked="" type="checkbox"/>	Gas-Lifting	<input type="checkbox"/>	Well Name:	<u>Dr. M. O. Miller</u>
Oil	<input type="checkbox"/>	Pumping	<input type="checkbox"/>	Well No.:	<u>2</u> , Sec. <u>29</u> , Twp. <u>15S</u> , Rge. <u>5 W</u>
Gas	<input checked="" type="checkbox"/>	Shut-In	<input type="checkbox"/>	Field	<u>Crab Lake</u>
				Parish	<u>Cameron</u>

Date Completed or Recompleted May 13, 1964 at 1:00 (~~XXXX~~) (p.m.)

COMPLETION DATA

Initial Production 3 BOPD Gas Volume 200 MCF/Day

Tubing Pressure 1050 psig Casing Pressure _____ psig

Choke Size 24/64" Positive Adjustable _____ B.S.&W. 0 %

Gas/Oil Ratio 57,143 CF/Bbl. Gravity 49.5 at 60° A. P. I.

Producing Depth: From 9,919 Ft. to 9,921 Ft. T. D. 12,858 Ft.

Name of Producing Sand: C-F Sand

*New Pool *Old Pool List Reason(s) for Pool Classification _____
Previously completed in this zone.

*As Defined in Statewide Order No. 29-H.

Additional clearance is requested for _____ barrels of oil produced on drill stem or other production tests (See Section X, Paragraph B of Order No. 29-B on reverse side).

Three (3) copies to be filed with the District Office within three (3) days of date of completion or recompletion (as per Order 29-B, Section X, Paragraph A, Article 1).

I hereby certify that the above information is true and correct to the best of my knowledge.

DISTRICT MANAGER ONLY

29-E Compliance - Yes _____ No _____
29-E Unit Attached - Yes _____ No _____

DATE: _____

FOREST OIL CORPORATION
COMPANY
John C. Mills
COMPANY REPRESENTATIVE
District Production Supt.
TITLE

RECEIVED
MAY 25 1964
DEPT. OF CONSERVATION
LAKE CHARLES

DEPARTMENT OF CONSERVATION
STATE OF LOUISIANA

This side is to be used when requesting clearance for oil produced on Drill Stem Test or other Production Tests, made previous to official completion or recompletion.

SECTION X, PARAGRAPH B OF ORDER NO. 29-B

Allowables given to wells for oil produced on drill stem tests, production test and miscellaneous production of oil shall be in accordance with the following rule:

All operators are required within five days, to file three signed copies of the record of the daily production from the well, showing the number of hours the well produced and the interval of production --- as "from 8:00 A. M., August 5 to 3:00 P. M., August 8, 1952."

<u>Date of Test</u>	<u>TEST DATA</u> <u>Time of Test</u>	<u>Amount of Oil Produced</u>
_____	_____ M. to _____ M.	_____ Barrels
_____	_____ M. to _____ M.	_____ Barrels
_____	_____ M. to _____ M.	_____ Barrels
_____	_____ M. to _____ M.	_____ Barrels
_____	_____ M. to _____ M.	_____ Barrels
_____	_____ M. to _____ M.	_____ Barrels
_____	_____ M. to _____ M.	_____ Barrels
_____	_____ M. to _____ M.	_____ Barrels
_____	_____ M. to _____ M.	_____ Barrels
_____	_____ M. to _____ M.	_____ Barrels
TOTAL		_____ BARRELS

The above total barrels of oil were produced from _____ Ft. to _____ Ft.

Remarks: _____

From - Comp. _____
COMPANY

(Signed) COMPANY REPRESENTATIVE

POTENTIAL REPORT

Type Well: Oil _____ Gas X Distillate _____

Type Test: Comp. _____ Recom. X Retest _____ Regauge _____

Parish CAMERON Field CRAB LAKE

Company FOREST OIL Serial No. 50882

Well Name & No. DR. M. O. MILLER #2

Location: Sec. 29 Twp 13-3 Rge. 5-4 Flowing - Pump _____

Prod. Horizon C-F SAND Perf. Int. 9919 to 9921

Casing Setting: Size 5 1/2" @ 12,489

Tubing Setting: Size 2 3/8" @ 9880 T.D. 12,858

Date Completed 5-18-69 Date Gauged 5-18-69

Acidize with _____ gals. Elev. of Derr. Floor 18'

TEST DATE

T. P. 1050 C. P. - Choke Size 29 /64th

Closing TK Gge. 8 ft. 5 1/2 in. @ 4:00 P.M. Time

Opening TK Gge. 8 ft. 5 in. @ 12:00 Noon Time

Diff. 0 ft. 1/2 in. 4 Hours (Time)

Tank No. 904 Tank Coef. 1.16

Bbls. per 4 Hrs. .58 Est. Bbls. per Day 3.98^N

Daily Gas Vol. 200 M.C.F. G/O Ratio 57.193^T

B.S.&W. PL % Corrected Gravity 49^S Deg. A.P.I.

Witnessed M. G. West Title PUMPER

Gauged by Leland L. Romano Inspector
Department of Conservation

District Office LAKE CHARLES, LA.

Remarks: AMERICAN ORIFICE METER

50" X 1000" 3" METER TUBE

.750" ORIFICE PLATE 650# @ 9"

05-75

MINERALS DIVISION
DEPARTMENT OF CONSERVATION
STATE OF LOUISIANA

P & A
L. C. #66

WORK PERMIT

PERMIT TO P & A DATE 3/24/66
PARISH Cameron FIELD Crab Lake
COMPANY Forest Oil Corp.
ADDRESS P. O. Box 51125, OCS, Lafayette, La.
WELL NAME M. O. Miller No. 2 SEC. 29 T. 15S R. 5W
WELL PERMIT SERIAL No. 50882 WORK PERMIT No. _____
LOCATION _____

YOU ARE HEREBY AUTHORIZED TO P & A according to La. Dept.
of Conservation rules and regulations. Set 100' cmt. plug
across perf. 100' plug across csg. cut-off point if any
csg. salvaged & 25' plug at surface. TD 12858'
PERMIT REQUESTED BY JOHN C. WILLIS

Company Representative
AUTHORIZED BY *William C. Wilhite*
WILLIAM C. WILHITE
Lake Charles, La.
District Office

Well



DEPARTMENT OF CONSERVATION

WELL HISTORY AND WORK RESUME REPORT

FIELD

Crab Lake

SERIAL NO.

50832

PRODUCING INTERVAL

None

RESERVOIR (COMPANY SAND IDENTIFICATION)

None

Three typewritten copies of this report must be filed with the District Office of the Department of Conservation in which the well is located within twenty (20) days of the date of completion: NOTE: If not properly completed and signed this report will be returned.

LEASE AND WELL DATA

DESIGNATE TYPE OF COMPLETION: NEW WELL RECOMPLETION SAME RESERVOIR DIFFERENT RESERVOIR OIL GAS P&A

OPERATOR: Forest Oil Corporation ADDRESS: P. O. Box 51125, OCS Lafayette, La.

LEASE NAME: Dr. M. O. Miller WELL NO.: 2

PARISH: Cameron SEC.: 29 TWP.: 15-S RGE.: 5-W DATE PERMIT ISSUED: 12-9-53

DATE SPUNDED: DATE READY TO PRODUCE: TOTAL DEPTH: 12,858' PBTD.

GROUND ELEVATION: CASING HEAD FLANGE ELEVATION: DISTANCE FROM RKB TO CHF: 18'

DATE WELL TURNED INTO TANKS: SINGLE, DUAL OR TRIPLE COMPLETION? NOTE: IF THIS IS A MULTIPLE COMPLETION, FURNISH A SEPARATE REPORT FOR EACH COMPLETION

WAS WELL DIRECTIONALLY DRILLED? No WAS DIRECTIONAL SURVEY MADE? No WERE 3 COPIES FILED WITH THE DEPARTMENT OF CONSERVATION? No DATE FILED: None

TYPE OF ELECTRICAL OR OTHER LOGS RUN (CIRCLE LOGS FILED WITH DEPT. OF CONSERVATION): DATE FILED: 1953

CASING, LINER AND TUBING RECORD

Table with 9 columns: CASING SIZE, HOLE SIZE, CASING WEIGHT, DEPTH SET, SACKS CEMENT, TEST PRESSURE, HOURS UNDER PRESSURE, DATE TESTED, NAME OF TEST WITNESS-STATE IF DEPT. AGENT OR OFFSET OPERATOR. Rows include 16", 10 3/4", and 5 1/2" casing sizes.

TUBING SIZE: DEPTH OF TUBING: DEPTH OF PACKER(S):

INITIAL COMPLETION OR RE-COMPLETION DATA

INITIAL PRODUCTION: GAS VOLUME: CHOKE SIZE: WELL STATUS: TUBING PRESSURE: CASING PRESSURE: GOR: GRAVITY: CONSERVATION AGENT MAKING GAUGE: COMPANY REPRESENTATIVE: DATE GAUGED:

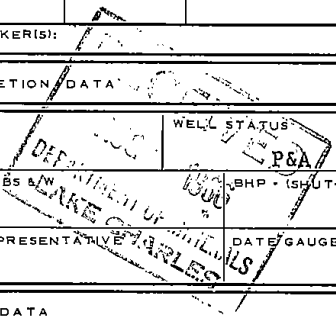

PLUG AND ABANDON (P&A) DATA

Table with 8 columns: CASING SIZE, AMOUNT PULLED, CEMENT PLUGS (FROM, TO, SACKS, HOW PLACED), DATE WORK PERFORMED, NAME OF TEST WITNESS-STATE IF DEPT. AGENT OR OFFSET OPERATOR. Rows include 16", 10 3/4", and 5 1/2" casing sizes.

CERTIFICATE: I, the undersigned, state: That I am employed by Forest Oil Corp., and that I am authorized to make this report, and that this report was prepared under my supervision and direction and that all facts stated herein are true, correct and complete to the best of my knowledge.

Form WH Signature: John C. Willis by O. F. Pechee Title: District Production Supt

* Date well is equipped to produce, but due to no available market, no pipe line connection, etc., the well has been shut-in.

WORK RESUME

List below all work performed under Department of Conservation Work Permits while drilling and completing well.

WORK PERMIT NO.	DATE WORK PERFORMED	SERVICE COMPANY	DESCRIPTION OF WORK
1C #66	7-12-66	Seaboard Well Service	Set 25 sx. plug 9918-9718', Set 65 sx. plug 3390-3590', Set 10 sx. plug 10-30'.

List below all important Paleofaunal or Geological Formation tops, Cap Rock and Salt tops and Salt Overhang bottoms.

FORMATION	DEPTH	FORMATION	DEPTH

Wells

DEPARTMENT OF CONSERVATION
STATE OF LOUISIANA

PLUG AND ABANDON REPORT

DATE WORK DONE 7-12-66

WELL SERIAL NO. 50822
WORK PERMIT NO. LC #66

Lake Charles DISTRICT
(Three Copies to be Filed with the District Office)

NOTE: This Report Will be Returned if Not Properly Completed And Signed.

Field Crab Lake Parish Cameron Sec. 29 Twp. 15-S Rge. 5-W

Company Forest Oil Corp. Lease Dr. M. O. Miller Well No. 2

Total Depth 12,858' Condition of Well P&A

- | | | | |
|----------------------|---------------------|---------------------|---------------------------|
| 1. Surface Casing | Size <u>16"</u> | Depth <u>120'</u> | Amount Pulled <u>None</u> |
| 2. Protection Casing | Size <u>10 3/4"</u> | Depth <u>3510'</u> | Amount Pulled <u>None</u> |
| 3. Production Casing | Size <u>5 1/2"</u> | Depth <u>12490'</u> | Amount Pulled <u>None</u> |

CEMENT PLUGS

- | | | | |
|----------------------|----------------|------------------------|-------------------------------|
| 1. Depth <u>9918</u> | To <u>9718</u> | No. of Sacks <u>25</u> | How Placed <u>Halliburton</u> |
| 2. Depth <u>3390</u> | To <u>3590</u> | No. of Sacks <u>65</u> | How Placed <u>Halliburton</u> |
| 3. Depth <u>10</u> | To <u>30</u> | No. of Sacks <u>10</u> | How Placed <u>Halliburton</u> |

Mud Record: Weight 10#

Viscosity 30

Remarks: _____

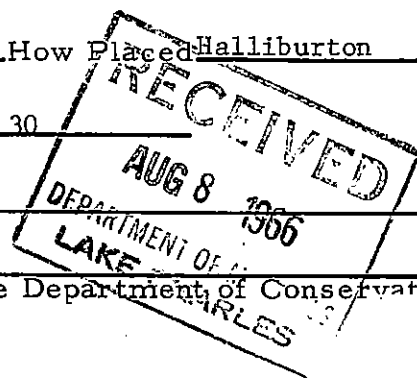

This work was done according to the Rules and Regulations of the Department of Conservation

H. L. Allen
WITNESS

Forest Oil Corporation
COMPANY

John C. Willis by O. F. Fisher
(Signed) REPRESENTATIVE