

MINERALS DIVISION
DEPARTMENT OF CONSERVATION
STATE OF LOUISIANA

Lake Charles

DISTRICT

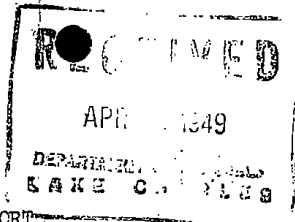

WELL COMPLETION OR RECOMPLETION REPORT

OIL WELL ()	<p style="text-align: center;"><u>NOTE</u></p> <p>One copy to be filed with District Office within three (3) days of date of completion or recompletion (as per Order No. 29-A, Section X, Paragraph A, Article 1.)</p>	COMPLETION ()
DIS. WELL ()		RECOMPLETION ()
GAS WELL ()		PERMIT 35727 SERIAL NO. _____

PARISH Cameron FIELD Little Chenier SEC. 14 TWP. 14-S RNG. 6-W
 COMPANY Gulf Refining Co Marmentau Mineral & Land
Gulf Prod. Div. LEASE Co Incorporated WELL NO. 1

DRILLING CONTRACTOR Prince DATE SPUDDED (OR W.O.) _____
Not Completed - Request for clearance of oil produced while testing - see reverse side
 DATE COMPLETED OR RECOMPLETED 10 ^{AM} 1949 ^{PM} **produced while testing - see reverse side**

COMPLETION DATA:

INITIAL PRODUCTION _____ BRLS./DAY (NET)
 TUBING PRESSURE _____ #/SQ. IN. GA. FLOWING () SHUT-IN ()
 CASING PRESSURE _____ #/SQ. IN. GA.
 CHOKE SIZE _____ POSITIVE () ADJUSTABLE ()
 B. S. & W. _____ PERCENT SALT WATER () WASH WATER ()
 GAS VOLUME _____ MCF/DAY
 GAS/OIL RATIO _____ CF/BBL.
 GRAVITY _____ (60° -A.P.I.)
 PRODUCING DEPTH _____ FT. TO _____ FT.
 PERFORATED YES () NO. () BOTTOM TUBING _____ FT. SIZE _____ IN.
 CASING (OIL STRING) SIZE _____ IN. I.D. () O.D. () BOTTOM SEAT _____ FT.
 TOTAL DEPTH DRILLED _____ FT. DERRICK FLOOR ELEVATION _____ FT.

Additional clearance is requested for _____ barrels of oil produced on drill-stem or other production tests. (See Section X, Paragraph B, of Order No. 29-A on reverse side.)

C O M P A N Y

COMPANY REPRESENTATIVE

MINERALS DIVISION
DEPARTMENT OF CONSERVATION
STATE OF LOUISIANA

This side to be used when requesting clearance for oil produced on Drill Stem Test or other production tests; made previous to official completion or recompletion.

Section X, Paragraph B of Order No. 29-A

Allowables given to wells for oil produced on drill stem tests, production test and any miscellaneous production of oil shall be in accordance with the following rule:

All operators are required, within five days, to file three signed copies of the record of the daily production from the well, showing the number of hours the well produced and the interval of production; as "from 8:00 A. M., August 5th, to 3:00 P.M., August 8th, 1942."

DATE OF TEST	T E S T D A T A		AMOUNT OF OIL PRODUCED
	TIME OF TEST		
3/27 1949	8.00 P.M.	TO 6.00 A.M.	21 BARRELS
3/28 1949	6.00 A.M.	TO 6.00 A.M.	59 BARRELS
3/29 1949	6.00 A.M.	TO 11.00 A.M.	20 BARRELS
19__	__ .M.	TO __ .M.	__ BARRELS
19__	__ .M.	TO __ .M.	__ BARRELS
19__	__ .M.	TO __ .M.	__ BARRELS
19__	__ .M.	TO __ .M.	__ BARRELS
19__	__ .M.	TO __ .M.	__ BARRELS
19__	__ .M.	TO __ .M.	__ BARRELS
19__	__ .M.	TO __ .M.	__ BARRELS
19__	__ .M.	TO __ .M.	__ BARRELS
19__	__ .M.	TO __ .M.	__ BARRELS
19__	__ .M.	TO __ .M.	__ BARRELS
TOTAL:			100 BARRELS
			10416 10424

The above total barrels of oil was produced from ___ Ft. to ___ Ft.
REMARKS: Oil Produced on Drill Stem Test.

GULF REFINING COMPANY
GULF PRODUCTION DIVISION

COMPANY
Randolph Bryant, Jr.
COMPANY REPRESENTATIVE
Randolph Bryant

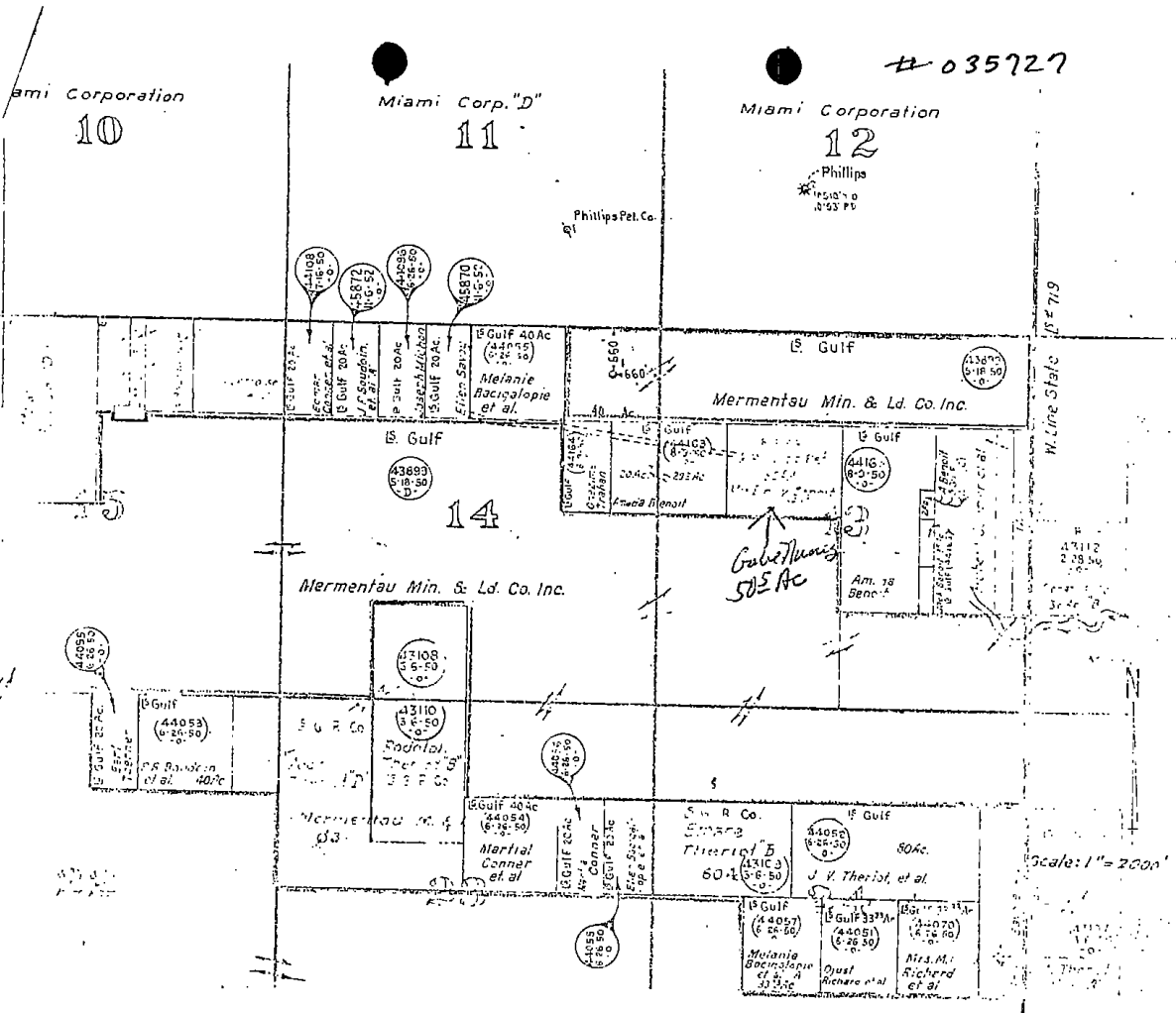

LITTLE CHENIER AREA (CANNON PARISH) LOUISIANA

Gulf Refg. Co.-Gulf Prod. Div. #1 Mermentau Mineral and Land Co., Inc. 660 feet North and 660 feet West of the Northeast corner of Sec. 14, T-14-S, R-7-E.

I hereby certify that the foregoing plat is accurately drawn to scale, and the dimensions and locations to which it relates are correctly reflected thereon in accordance with surveys on the ground.

Geo. H. Lacy
 GEO. H. LACY, Licensed Louisiana Surveyor.

035727

April 10, 1949

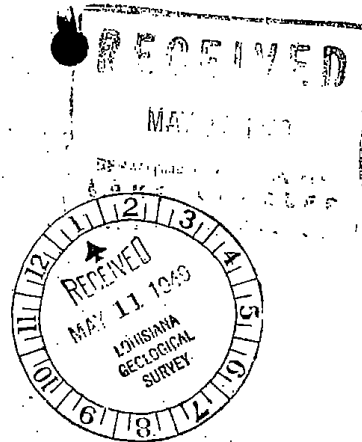

Mr. Thos. M. Winfield, Chief Eng.
Department of Conservation
State Capitol Building
Baton Rouge, Louisiana

Dear Sir:

Find enclosed copy of Log of Well of Gulf
Refining Company's Mermontau Min. & Ind. Co. Inc.
#1 well, Wildcat, Cameron Parish, Louisiana.
Serial No. 85727.

Yours very truly,

Ar
ARSENE P. EDWARDS
District Manager
Lake Charles, La.

APE:lml

Encl.
2ccs: State Geologist
Baton Rouge, La.



PETROLEUM AND ITS PRODUCTS

GULF REFINING COMPANY

GULF BUILDING

P. O. DRAWER 2100 · HOUSTON 1, TEXAS

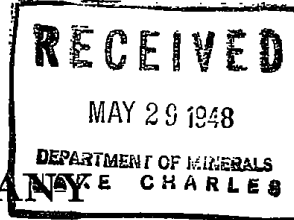

J. H. RUSSELL
VICE-PRESIDENT

GULF PRODUCTION
DIVISION

May 27, 1948.

Re: Mermentau Mineral and Land
Company, Inc., well No. 1,
Little Chenier Area, Cameron
Parish, Louisiana.

Department of Conservation,
State of Louisiana,
331 Broad Street,
Lake Charles, Louisiana.

Gentlemen:

Attached hereto is Gulf Refining Company, Gulf Production Division Voucher, Audit No. 5-29, Treas. No. 4630, in the amount of \$50.00 furnished to cover fee for permit to drill the above well.

Also attached is Department of Conservation Form MD-10-R, and plats, in duplicate, showing the location and other pertinent data regarding this well.

Please mail permit, your Form MD-13-R, to Mr. E.P. Hubbard, P. O. Box 2100, Houston 1, Texas. It is also requested that a copy be mailed to Mr. M. R. Redick, Box 37, Harvey, Louisiana.

Yours very truly,

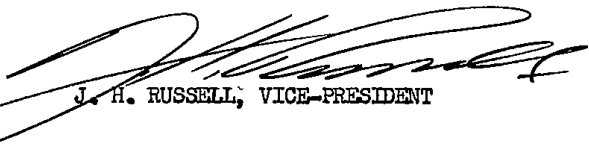
J. H. RUSSELL, VICE-PRESIDENT

CW/vg
cc-Department of Conservation,
Baton Rouge, Louisiana.

May 29, 1948

Mr. Rhos. M. Winfield, Chief Eng.
Department of Conservation
State Capitol Building
Baton Rouge, Louisiana

Dear Sir:

Find enclosed check for \$50.00 covering
permit fee, application of Gulf Refg. Company
to drill their Mermentau Min. & Ind. Co., Inc.
#1 well, Wildcat, Cameron Parish, Louisiana.

Yours very truly,

ARSENE P. EDWARDS
District Manager
Lake Charles, La.

APE:lm1

Encl.

Issued 6-1-48

Permit 20264
Serial 35727

~~Manner~~
REPORT

MINERAL

PAR. Cameron FIELD Wildcat

OPERATOR Gulf Refg. Co.

FARM Murmetan Min. & Ind. Co. WELL NO. 1

LOCATION 660' S. & 660' W. of the N. E. Cor.

SEC. 14 TWP. 14S RNG. 6W ELEV.

BEGAN DRLG. _____ COMPLETED _____

TOTAL DEPTH _____ TOP PAY _____

UNIT PRODUCTION _____

LOGGING RECORD _____

DATE	CONDITION
6-25-48	Ran "g" down
7-2-48	Set 13 3/8" csg. 2501 cost 1000 each
7-9-48	Drilled sandy shale & shell at 4920
7-16-48	Drilling sandy shale at 5857

DATE	CONDITION
7-23-48	Drilling shale at 6937'
7-30-48	" shale with hard streaks of sand at 7909'
8-6-48	Drilling sand & shale of shale, 13 3/8" log. at 9092.50
8-13-48	Drilling shale 13 3/8" log. at 9252' 7 1/2" 9115.9'
8-20-48	Drilling shale 13 3/8" log. at 9752'
	2D. 9755'
8-27-48	Drilling shale 9 5/8" log. at 9752' 2D. 9874
9-3-48	Drilling shale at 10248'
9-10-48	" " " 10500'
9-17-48	" " " 10802'
9-24-48	" " " "

FIELD

PRODUCTION RECORD

NO. FLOWING WELLS

AV. DAILY PROD.

NO. PUMPING WELLS

AV. DAILY PROD.

AGENT.

RECEIVED
 JUL 5 1948
 DEPARTMENT OF MINERALS
 LAKE CHARLES

MINERALS DIVISION
 DEPARTMENT OF CONSERVATION
 STATE OF LOUISIANA

Burn Rig

- AFFIDAVIT OF TEST OF CASING IN WELL -

DATE WORK DONE July 3-1948

WORK PERMIT NO. 20264
 WELL SERIAL NO. 35727

(One copy to be filed with the District Office)

NOTE:

THIS REPORT WILL BE RETURNED IF NOT PROPERLY FILLED IN AND SIGNED

PARISH Cameron FIELD Wildcat SEC. 14 TWP. 14 RGE 6W
 COMPANY Gulf Refining Co. LEASE Monument Mineral Plans Co. Inc WELL NO. 1
Gulf Prod. Division
 TOTAL DEPTH 2528'
 SIZE OF CASING 1 3/8 IN: WT. PER FT. 61 and 54.5 #: MAKE 955
 NO. OF THREADS PER IN. 8 GRADE A SEAMLESS yes NEW yes 2ND
 IF SECOND HAND, WAS PIPE TESTED? _____ DESCRIBE _____

DEPTH LANDED BELOW DERRICK FLOOR 2520.99 FT. SACKS OF CEMENT 1000
 SIZE OF HOLE 18 1/2 IN.: AMOUNT OF CEMENT LEFT IN PIPE 34'
 METHOD OF CEMENTING Halliburton CEMENT SET 16 HOURS UNDER 900 LBS.
 PRESSURE _____ TOTAL TIME SET 72 HOURS

DETAIL OF PRESSURE TEST BEFORE DRILLING PLUG

DATE OF TEST: July 3 1948. GAUGE PRESSURE ON CASING 1150 LBS.
 PRESSURE AT END OF THIRTY MINUTES (30) 1150 DROP None LBS.
 TEST FLUID: WATER and MUD 9.8 LBS. PER GAS: VISCOSITY 40 SEC.

REMARKS: Well head Equipment. Standards Cameron BP and Standards
Cameron BP with links name for master date. top 6000 ft test
was not operated. and bore test valves on tall up line and
two choke manifolds. Flow line above BP.
 THIS WORK WAS DONE ACCORDING TO THE RULES AND REGULATIONS OF THE DEPARTMENT OF CONSERVATION, MINERALS DIVISION.

SIGNED: Gulf Refining Co. Gulf Prod. Division
 COMPANY

WITNESS: George B. Masey
Petroleum Inspector

By J. L. Neal
 Representative

RECEIVED
 AUG 20 1948
 DEPARTMENT OF MINERALS
 LAKE CHARLES

MINERALS DIVISION
 DEPARTMENT OF CONSERVATION
 STATE OF LOUISIANA

- AFFIDAVIT OF TEST OF CASING IN WELL -

DATE WORK DONE Aug 14-1948

WORK PERMIT NO. 20264
 WELL SERIAL NO. 35727

(One copy to be filed with the District Office)

NOTE: THIS REPORT WILL BE RETURNED IF NOT PROPERLY FILLED IN AND SIGNED

PARISH Cameron FIELD Wild Cat SEC. 14 TWP. 14S RGE 6W
 COMPANY Gulf Refining Company Gulf Production Division Mermentau Mineral Lands Comp. WELL NO. 1

TOTAL DEPTH 9755'
 SIZE OF CASING 9 5/8 IN. WT. PER FT. 43.50 # 547 #: MAKE ✓
 NO. OF THREADS PER IN. 8 GRADE 75.8 SEAMLESS Yes NEW Yes 2ND
 IF SECOND HAND, WAS PIPE TESTED? _____ DESCRIBE _____

DEPTH LANDED BELOW DERRICK FLOOR 9733' FT. SACKS OF CEMENT 1000
 SIZE OF HOLE 12 1/4 IN.: AMOUNT OF CEMENT LEFT IN PIPE 1300 (Plug drilled to 490' ^{was} before casing test made.)
 METHOD OF CEMENTING Halliburton CEMENT SET 24 HOURS UNDER 1000 LBS.
 PRESSURE _____ TOTAL TIME SET 72 HOURS

DETAIL OF PRESSURE TEST BEFORE DRILLING PLUG

DATE OF TEST: Aug 19 1948 GAUGE PRESSURE ON CASING 1925 # Agamot 2RC LBS.
1900 # Agamot Halliburton
 PRESSURE AT END OF THIRTY MINUTES (30) 1975 DROP 25 # Agamot 2RC LBS.
Hydril
 TEST FLUID: WATER as MUD 10.2 LBS. PER GAS: VISCOSITY 4.5 SEC.

REMARKS: This test was made thru Kelly and 4 1/2" drill pipe, part of test being
against 10000' test hole area, and part of the test being against 10000' test
2RC BP. both water perates

THIS WORK WAS DONE ACCORDING TO THE RULES AND REGULATIONS OF THE DEPARTMENT OF CONSERVATION, MINERALS DIVISION.

WITNESS: George R. Casey
Petroleum Prospector
 Form Csg. (T)-MD16
 SIGNED: Gulf Refining Company
Gulf Production Division
E.W. Maister
D.J. Neal Representative

Mauson
REPORT

Page # *2*

VISION _____
 PAR. _____ FIELD _____
 OPERATOR *Gulf Refining Co. Inc.*
 FARM *Memontow Mining Co.* WELL NO. *1*
 LOCATION *Land Contour Inc.*

SEC. _____ TWP. *111* RNG. _____ ELEV. _____
 BEGAN DRG. _____ COMPLETED _____

TOTAL DEPTH _____ TOP PAY _____

UNIT. PRODUCTION _____

CASING RECORD

DATE	CONDITION
<i>10/6/48</i>	<i>TD 1124' sand shale</i>
	<i>run 925 1000 ft. in 7 1/2" pipe</i>
	<i>✓ another 500 - 250' - 250' -</i>
	<i>get in more casing 250'</i>
	<i>all open hole. Thus 17.5'</i>
	<i>run 4 1/2" total casing 2260'</i>
	<i>Formation takes cement.</i>
	<i>Driller's 9815' casing bottom</i>
	<i>retractable return. set 9607'</i>

Page #3

Memorandum March 21 1950
Shank one stand was taken
Closes 17.6. For record of
processes to 2 hrs. Remaining
now 11780' Unit 17.6 Vis 55-66-
6-14-48 12400' remaining to bottom

Unit 17.7 Vis 60

1-26-49 12736' Still Shows
17.7 Vis 64

Well abandoned -

LANE-WELLS COMPANY

PERFORATING

Number Jobs This Trip ONE
Sales Order No. 441403

District Southern Louisiana Operating Base Lake Charles Date Nov. 29, 48
Truck No. 18 Operator W. W. Smith Helper A. M. Leduc
Customer GULF Ref Co. Prod Div. Ordered by Mr Neal
Mileage: From _____ to _____ Miles
Mileage: From _____ to _____ Miles

PERFORATING INSTRUCTIONS—Given By Mr J. C. Neal

Name of Well Mecumetou Mierlet Lt Co No. 1 Field Chalier Ridge Dist. Area
State La. County/Parish Cameron

Bullet Size 1 1/2 Holes from 1115 to 1111 Ft. Holes from _____ to _____ Ft. Holes from _____ to _____ Ft.
Holes from _____ to _____ Ft. Shooting Zone Approved By [Signature]

TO LANE-WELLS COMPANY: Permit No. 1 CONDITIONS OF THIS CONTRACT

You are hereby requested to furnish the service and materials and equipment herein set forth upon the following terms and conditions, to wit:
The undersigned, as customer, agrees to pay you for the service and/or materials ordered hereunder at the office of Lane-Wells Company, in the City, County, and State from which the invoice originates. Should any account not be paid within the term fixed by the invoice, interest will be charged at the rate of six per cent per annum from the date of such invoice.

In the event you employ an attorney to enforce any claim of indebtedness against the undersigned customer, said customer agrees to pay all costs of collection and reasonable attorneys' fees which, in no event, shall be less than the sum of \$75.00.

Because of the uncertain and unknown conditions and the hazards existing in connection with the rendering of your field service, and because of physical conditions existing in an oil well which are not subject to your control, customer agrees that you do not guarantee the results of your service, and that you will not be held liable for injury to persons or property arising from any cause whatsoever in the performance of such field service by you.

Should any of your instruments, tools, or equipment be lost or destroyed in the rendition of your service, customer agrees to use all reasonable diligence and facilities available to recover the same, and customer agrees to reimburse you for the reasonable value of any instruments, tools, or other personal property that cannot be recovered, or for the cost of repairing any damage to items recovered.

Customer agrees that any service or services rendered by you hereafter shall be deemed to be rendered on the same terms and conditions as herein set forth.

Customer agrees that all depth measurements shall be made by it or its employees, and shall be supervised by customer or its employees. Customer certifies that it is the owner of the well on which the work herein ordered is to be done; or that it has the full right and authority to order such work done on such well; and that the well in which the work is to be done by you is in proper and suitable condition for the performance of said work.

Customer further agrees that the terms and conditions herein set forth constitute the entire agreement and that no employee of your company is authorized to alter the terms hereof.

Customer's Order No. _____ Customer GULF Ref Co. Prod Div. By [Signature]

NO.	NO.	NO.	NO.	NO.	NO.	NO.
1.						
2.						
3.						
4.						
5.						
6.						
7.						
8.						
9.						
10.						
11.						
12.						
13.						
14.						
15.						
16.						
17.						
18.						
19.						
20.						
21.						
22.						
23.						
24.						
25.						
26.						
27.						
28.						
29.						
30.						

RECEIVED
NOV 30 1948
LANE WELLS COMPANY
LAKE CHARLES

Perforating Data

On Job _____ A.M. _____ P.M. _____ M. Res. _____ Off Job _____ A.M. _____ P.M. _____ M. Res. _____
 Standby Time _____ Max. Temp. _____ ° F
 New or Old Well _____ Purpose of Perforating _____ Kind of Fluid _____ Level _____
 Casing Record _____ Cemented In _____ Liner Record _____ Cemented In _____
 Customer's Depth _____ Measure Method _____ Zero Point _____
 Lane-Well's Depth _____ Size Gun _____ No. _____ Controller _____ No. _____

RUNNING TIME	REMARKS
1) In From _____ to _____ A.M. P.M. Out From _____ to _____ A.M. P.M. Fluid _____ In _____ Out _____ Holes _____ Total _____	
2) In From _____ to _____ A.M. P.M. Out From _____ to _____ A.M. P.M. Fluid _____ In _____ Out _____ Holes _____ Total _____	
3) In From _____ to _____ A.M. P.M. Out From _____ to _____ A.M. P.M. Fluid _____ In _____ Out _____ Holes _____ Total _____	
4) In From _____ to _____ A.M. P.M. Out From _____ to _____ A.M. P.M. Fluid _____ In _____ Out _____ Holes _____ Total _____	
5) In From _____ to _____ A.M. P.M. Out From _____ to _____ A.M. P.M. Fluid _____ In _____ Out _____ Holes _____ Total _____	
6) In From _____ to _____ A.M. P.M. Out From _____ to _____ A.M. P.M. Fluid _____ In _____ Out _____ Holes _____ Total _____	
7) In From _____ to _____ A.M. P.M. Out From _____ to _____ A.M. P.M. Fluid _____ In _____ Out _____ Holes _____ Total _____	

Plug & Perforate
L.C. 12

MINERALS DIVISION
DEPARTMENT OF CONSERVATION
STATE OF LOUISIANA

WORK PERMIT

PERMIT TO Plug & Perforate DATE 2-22-49
PARISH Cameron FIELD Wildcat
COMPANY Gulf Refg. Co. Gulf Prod. Div.
ADDRESS Box 2100 Houston, Texas
WELL NAME Mermontau Min. & Ind. NO. 1 SEC. 14 T. 14S. 6W
WELL PERMIT SERIAL NO. 35727 WORK PERMIT NO. _____
LOCATION 660' S. & 660' W. of NE cor. of Sec. 14.

YOU ARE HEREBY AUTHORIZED TO Set 300' plug on outside 7"
casing 200' plug at 11124' Set 100' Plug inside 7"
casing and perforate from 11114' to 11126'.

TD 43280

PERMIT REQUESTED BY T.D. Maxwell
Company Representative

AUTHORIZED BY _____
ARSENE P. EDWARDS
LAKE CHARLES, La. District Office

MINERALS DIVISION
DEPARTMENT OF CONSERVATION
STATE OF LOUISIANA

Plug & Perforate
#11

WORK PERMIT

PERMIT TO Plug & Perforate DATE 2-23-49
PARISH Cameron FIELD Little Chenier
COMPANY Gulf Refg. Co. Gulf Prod. Div.
ADDRESS Box 2100 Houston 1, Texas
WELL NAME Mermentau Min & Ind. Co. NO. 1 SEC. 14 T. 14R SW
WELL PERMIT SERIAL NO. 35727 WORK PERMIT NO. _____
LOCATION 660' S & 660' W. of the NE cor. Sec. 14

YOU ARE HEREBY AUTHORIZED TO Set 300' plug 200' out side
7" csg. 100' in side 7" csg. & perforate from 10422
to 10428'.

PERMIT REQUESTED BY T.D. Maxwell TD. 13260'
Company Representative

AUTHORIZED BY _____
ARSENE P. EDWARDS
LAKE CHARLES, LA. District Office

LANE-WELLS COMPANY

PERFORATING

Number Jobs This Trip one
Sales Order No. A-47156

District South LA Operating Base LANE CHARLES Date 2-26-49
Truck No. 275 Operator A.F. HARRINGTON Helper TED ANDRUS
Customer GULF OIL & REFIN. Co. Ordered by MR. SHAWAN
Mileage: From _____ to _____ Miles
Mileage: From _____ to _____ Miles

PERFORATING INSTRUCTIONS—Given By

Name of Well MARABANTE AN MINERAL P. No. 1 Field LITTLE CHINEIR
State LA County/Parish CAMERON
Bullet Size 12 Holes from 10024 to 10023 Ft. 2 Holes from _____ Ft. _____
Holes from _____ to _____ Ft. Shooting Zone Approved By [Signature]

CONDITIONS OF THIS CONTRACT

TO LANE-WELLS COMPANY:

In consideration of the furnishing of your Gun Perforating service, the undersigned agrees as follows:
The undersigned agrees to pay you the amount of your published prices for said service at your office from which the invoice, reflecting the amount of the charge, originates. Should the amount due be not paid within the term fixed by the invoice, interest will be charged at the rate of six percent per annum from the date of such invoice.

In the event you employ an attorney to enforce any claim of indebtedness against the undersigned customer, said customer agrees to pay all costs of collection and reasonable attorneys' fees which, in no event, shall be less than the sum of \$75.00.

Because of the uncertain and unknown conditions and the hazards existing in connection with the rendering of your field service, and because of physical conditions existing in an oil well which are not subject to your control, customer agrees that you do not guarantee the results of your service, and that you will not be held liable for injury to persons or property arising from any cause whatsoever in the performance of such field service by you.

Should any of your instruments, tools, or equipment be lost or destroyed in the rendition of your service, customer agrees to use all reasonable diligence and facilities available to recover the same, and customer agrees to reimburse you for the reasonable value of any instruments, tools, or other personal property that cannot be recovered, or for the cost of repairing any damage to items recovered.

Customer agrees that any service or services rendered by you hereafter shall be deemed to be rendered on the same terms and conditions as herein set forth.

Customer agrees that all depth measurements shall be made by it or its employees, and shall be supervised by customer or its employees.
Customer certifies that it is the owner of the well on which the work herein ordered is to be done, or that it has the full right and authority to order such work done of such well; and that the well in which the work is to be done by you is in proper and suitable condition for the performance of said work.

Customer further agrees that the terms and conditions herein set forth constitute the entire agreement and that no employee of your company is authorized to alter the terms hereof.

Customer's Order No. _____ Customer GULF OIL & REFIN. Co. By [Signature]

NO.	NO.	NO.	NO.	NO.	NO.	NO.
1.						
2.						
3.						
4.						
5.						
6.						
7.						
8.						
9.						
10.						
11.						
12.						
13.						
14.						
15.						
16.						
17.						
18.						
19.						
20.						
21.						
22.						
23.						
24.						
25.						

RECEIVED
MAR 1 1949
DEPARTMENT OF REVENUE
LAKE CHARLES

JOB SCHEDULED..... A.M. ARRIVED AT LOCATION A.M.
P.M. P.M. LANDING P.M.

Perforating Data

On Job _____ A.M. _____ M. Res. _____ Off Job _____ A.M. _____ M. Res.
P.M. P.M. P.M. P.M.

Waiting Time _____

New or Old Well _____ Purpose of Perforating _____ Kind of Fluid _____ Level _____

Casing Record _____ Cemented In _____ Liner Record _____ Cemented In _____

Customer's Depth _____ Measure Method _____ Zero Point _____

Lane-Wells Depth _____ Size Gun _____ No. _____ Controller _____ No. _____

RUNNING TIME	REMARKS
1) In From _____ to _____ A.M. P.M.	
Out From _____ to _____ A.M. P.M.	
Fluid _____	
In _____ Out _____	
Holes _____ Total _____	
2) In From _____ to _____ A.M. P.M.	
Out From _____ to _____ A.M. P.M.	
2) In From _____ to _____ A.M. P.M.	
Out From _____ to _____ A.M. P.M.	
Fluid _____	
In _____ Out _____	
Holes _____ Total _____	
3) In From _____ to _____ A.M. P.M.	
Out From _____ to _____ A.M. P.M.	
3) In From _____ to _____ A.M. P.M.	
Out From _____ to _____ A.M. P.M.	
Fluid _____	
In _____ Out _____	
Holes _____ Total _____	
4) In From _____ to _____ A.M. P.M.	
Out From _____ to _____ A.M. P.M.	
4) In From _____ to _____ A.M. P.M.	
Out From _____ to _____ A.M. P.M.	
Fluid _____	
In _____ Out _____	
Holes _____ Total _____	
5) In From _____ to _____ A.M. P.M.	
Out From _____ to _____ A.M. P.M.	
5) In From _____ to _____ A.M. P.M.	
Out From _____ to _____ A.M. P.M.	
Fluid _____	
In _____ Out _____	
Holes _____ Total _____	
6) In From _____ to _____ A.M. P.M.	
Out From _____ to _____ A.M. P.M.	
6) In From _____ to _____ A.M. P.M.	
Out From _____ to _____ A.M. P.M.	
Fluid _____	
In _____ Out _____	
Holes _____ Total _____	
7) In From _____ to _____ A.M. P.M.	
Out From _____ to _____ A.M. P.M.	
7) In From _____ to _____ A.M. P.M.	
Out From _____ to _____ A.M. P.M.	
Fluid _____	
In _____ Out _____	
Holes _____ Total _____	

LANE-WELLS COMPANY

PERFORATING

Number Jobs This Trip One

District South Louisiana Operating Base Lake Charles Sales Order No. 241621
 Truck No. 4233 Operator W. H. Booth Date Feb. 28-49
 Customer GULFREY & Prod. Div. Ordered by Mr. Shannon Helper Archie Joubert - W. Cape - Tol
 Mileage: From _____ to _____ Miles
 Mileage: From _____ to _____ Miles

PERFORATING INSTRUCTIONS—Given By Mr. H. J. Reulhardt
 Name of Well Merrimentau Minerals Ltd Co No. 1 Field Little Prairie
 State La County/Parish Cameron
 Bullet Size 36 Holes from 10428 to 10422 Ft. Holes from _____ to _____ Ft. Holes from _____ to _____ Ft.
 Holes from _____ to _____ Ft. Shooting Zone Approved By H. J. Reulhardt

TO LANE-WELLS COMPANY: Permit Verbal CONDITIONS OF THIS CONTRACT

In consideration of the furnishing of your Gun Perforating service, the undersigned agrees as follows:
 The undersigned agrees to pay you the amount of your published prices for said service at your office from which the invoice, reflecting the amount of the charge, originates. Should the amount due be not paid within the term fixed by the invoice, interest will be charged at the rate of six percent per annum from the date of such invoice.
 In the event you employ an attorney to enforce any claim of indebtedness against the undersigned customer, said customer agrees to pay all costs of collection and reasonable attorneys' fees which, in no event, shall be less than the sum of \$75.00.
 Because of the uncertain and unknown conditions and the hazards existing in connection with the rendering of your field service, and because of physical conditions existing in an oil well which are not subject to your control, customer agrees that you do not guarantee the results of your service, and that you will not be held liable for injury to persons or property arising from any cause whatsoever in the performance of such field service by you.
 Should any of your instruments, tools, or equipment be lost or destroyed in the rendition of your service, customer agrees to use all reasonable diligence and facilities available to recover the same, and customer agrees to reimburse you for the reasonable value of any instruments, tools, or other personal property that cannot be recovered, or for the cost of repairing any damage to items recovered.
 Customer agrees that any service or services rendered by you hereafter shall be deemed to be rendered on the same terms and conditions as herein set forth.
 Customer agrees that all depth measurements shall be made by it or its employees, and shall be supervised by customer or its employees.
 Customer certifies that it is the owner of the well on which the work herein ordered is to be done; or that it has the full right and authority to order such work done on such well; and that the well in which the work is to be done by you is in proper and suitable condition for the performance of said work.
 Customer further agrees that the terms and conditions herein set forth constitute the entire agreement and that no employee of your company is authorized to alter the terms hereof.

Customer's Order No. _____ Customer GULFREY & Prod. Div. By H. J. Reulhardt

NO.	NO.	NO.	NO.	NO.	NO.	NO.
1.						
2.						
3.						
4.						
5.						
6.						
7.						
8.						
9.						
10.						
11.						
12.						
13.						
14.						
15.						
16.						
17.						
18.						
19.						
20.						
21.						
22.						
23.						
24.						
25.						

RECEIVED
 MAR 5 1949
 DEPARTMENT OF INDIAN AFFAIRS
 LAKE CHARLES

JOB SCHEDULED..... A.M. ARRIVED AT LOCATION..... A.M.
P.M. P.M. LANDING..... P.M.

Perforating Data

On Job _____ A.M. _____ M. Res. _____ Off Job _____ A.M. _____ M. Res.
P.M. P.M. P.M. P.M.

Waiting Time _____

New or Old Well _____ Purpose of Perforating _____ Kind of Fluid _____ Level _____

Casing Record _____ Cemented In _____ Liner Record _____ Cemented In _____

Customer's Depth _____ Measure Method _____ Zero Point _____

Lane- Wells Depth _____ Size Gun _____ No. _____ Controller _____ No. _____

RUNNING TIME		REMARKS
1) In From _____ to _____	A.M. _____ P.M. _____	
Out From _____ to _____	A.M. _____ P.M. _____	
Fluid _____		
In _____ Out _____		
Holes _____ Total _____		
2) In From _____ to _____	A.M. _____ P.M. _____	
Out From _____ to _____	A.M. _____ P.M. _____	
Fluid _____		
In _____ Out _____		
Holes _____ Total _____		
3) In From _____ to _____	A.M. _____ P.M. _____	
Out From _____ to _____	A.M. _____ P.M. _____	
Fluid _____		
In _____ Out _____		
Holes _____ Total _____		
4) In From _____ to _____	A.M. _____ P.M. _____	
Out From _____ to _____	A.M. _____ P.M. _____	
Fluid _____		
In _____ Out _____		
Holes _____ Total _____		
5) In From _____ to _____	A.M. _____ P.M. _____	
Out From _____ to _____	A.M. _____ P.M. _____	
Fluid _____		
In _____ Out _____		
Holes _____ Total _____		
6) In From _____ to _____	A.M. _____ P.M. _____	
Out From _____ to _____	A.M. _____ P.M. _____	
Fluid _____		
In _____ Out _____		
Holes _____ Total _____		
7) In From _____ to _____	A.M. _____ P.M. _____	
Out From _____ to _____	A.M. _____ P.M. _____	
Fluid _____		
In _____ Out _____		
Holes _____ Total _____		

RECEIVED
 MAR 2 1949
 DEPARTMENT OF MINERALS
 LAKE CHARLES

MINERALS DIVISION
 DEPARTMENT OF CONSERVATION
 STATE OF LOUISIANA

- PERFORATING RECORD -

WORK PERMIT NO. 20266 ✓
 WORK SERIAL NO. 35727 ✓

DATE WORK DONE February 28 and March 14 1949

(One Copy to be filed with the District Office)

NOTE: THIS REPORT WILL BE RETURNED IF NOT PROPERLY FILLED IN AND SIGNED

PARISH Cameron FIELD M/Cal SEC 14 TWP 14 SRGE 6N ✓
 COMPANY Gulf Refining Company Merchants Mineral and
Full Production Div. LEASE Kans Company Inc WELL NO. 1
 TOTAL DEPTH 13260' P.B.D 10436 1/2 Gamma Ray Measurement
 NEW OR OLD WELL New
 SIZE CASING 9 5/8" DEPTH OF CASING 9733' + 7' liner run to 11124'
 DEPTH OF PLUG BELOW PERFORATIONS 2 1/2'
 PERFORATED FROM 10422' TO 10428' Gamma Ray Measurement.
10422' 10428' Schmitt's log.
 NUMBER OF HOLES 36 SIZE OF HOLES 1/2" Cone Grate.
 PERFORATING COMPANY Lane Wells TRUCK NUMBER LR 233

PURPOSE OF PERFORATIONS For production
 REMARKS: Shooting nipple installed, with Lane Wells
piece of B-P attached, and as part of
well head equipment 10000# test ARE Cameron
Master Gate Valve M/OB.

THIS WORK WAS DONE ACCORDING TO THE RULES AND REGULATIONS OF THE DEPARTMENT OF CONSERVATION, MINERALS DIVISION.

Witness:
George B. Mason
Petroleum Inspector

SIGNED: Gulf Refining Company
Full Production Division
 COMPANY
[Signature]
 Representative

Form
 Perf - MD4

Foreman

RECEIVED
MAR 14 1949
DEPARTMENT OF MINERALS
LAKE CHARLES

MINERALS DIVISION
DEPARTMENT OF CONSERVATION
STATE OF LOUISIANA

- PERFORATING RECORD -

DATE WORK DONE ^{12th} March 12 - 1949

WORK PERMIT NO. 35727
WORK SERIAL NO. _____

(One Copy to be filed with the District Office)

NOTE: THIS REPORT WILL BE RETURNED IF NOT PROPERLY FILLED IN AND SIGNED

PARISH Cameron FIELD Wild Cat SEC 14 TWP 14 S RGE 6 W
COMPANY Gulf Refining Company LEASE Procedural and WELL NO. 1
Gulf Prod. Division Gamma Ray measurement
TOTAL DEPTH 13260' P.A.D. 10435' NEW OR OLD WELL New
SIZE CASING 9 5/8" DEPTH OF CASING 9733' + 7" down to 1124'
DEPTH OF PLUG BELOW PERFORATIONS 11 feet

PERFORATED FROM 10416' TO 10424' Gamma Ray Measurement
Schmittinger and Gamma Ray Measurements Reserve
NUMBER OF HOLES 42 SIZE OF HOLES 1/2 Core Bits

PERFORATING COMPANY Perforating Gamma Ray TRUCK NUMBER 10
PURPOSE OF PERFORATIONS For production

REMARKS: Shooting nipple installed, with perforating Gamma Ray
plug off B.P. attached, was, as part of Well Head
Equipment 10000' test Cameron SRC master Gate Valve
Water operates. P.O.B.P. on shooting nipple was lifted to 800'
Perforations from 10422' to 10428', Gamma Ray Measurement
for production. Wire squeezed off.

THIS WORK WAS DONE ACCORDING TO THE RULES AND REGULATIONS OF THE DEPARTMENT OF CONSERVATION, MINERALS DIVISION.

Witness
George D. Nalley
Petroleum Insp.
SIGNED: Gulf Refining Company
Gulf Production Division
COMPANY
J. O. B. Johnson
Representative
Wax and Sulphur

MINERALS DIVISION
DEPARTMENT OF CONSERVATION
STATE OF LOUISIANA

Lake Charles DISTRICT

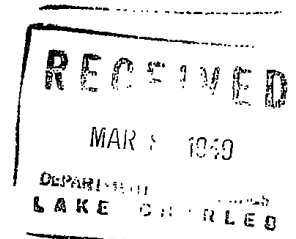

WELL COMPLETION OR RECOMPLETION REPORT

OIL WELL () N O T E COMPLETION ()
DIS. WELL () One copy to be filed with District Office within three (3) days of date of completion or recompletion (as per Order No. 29-A, Section X, Paragraph A, Article 1.) RECOMPLETION ()
GAS WELL () PERMIT
 SERIAL NO. 35727

PARISH Cameron FIELD Little Chenier SEC. 14 TWP. 14-S RNG. 6-W
COMPANY Gulf Refining Co. LEASE Mermentau Mineral & Land WELL NO. 1
Gulf Prod. Divn. Company Incorporated
DRILLING CONTRACTOR Prince Drilling DATE SPUNDED (OR W.O.) 6/22/1948
Company
DATE COMPLETED OR RECOMPLETED 3/5 1949, AT A.M. 2.15 P.M.

COMPLETION DATA:

INITIAL PRODUCTION 289 BBLS./DAY (NET)
TUBING PRESSURE 2800 #/SQ. IN. GA. FLOWING () SHUT IN ()
CASING PRESSURE Sealed Off #/SQ. IN. GA.
CHOKE SIZE 1/8" POSITIVE () ADJUSTABLE ()
B. S. & W. 4/10 of 1 PERCENT SALT WATER () WASH WATER ()
GAS VOLUME 433 MCF/DAY
GAS/OIL RATIO 1500/1 CF/BBLS.
GRAVITY 37.2 (60° -A.P.I.)
PRODUCING DEPTH 10422 FT. TO 10428 FT.
PERFORATED YES () NO. () BOTTOM TUBING 10400 FT. SIZE 2 IN.
CASING (OIL STRING) SIZE 7 IN. I.D. () O.D. () BOTTOM SEAT FT. 11124
TOTAL DEPTH DRILLED 13260 FT. DERRICK FLOOR ELEVATION 19 FT.

Additional clearance is requested for _____ barrels of oil produced on drill-stem or other production tests. (See Section X, Paragraph B, of Order No. 29-A on reverse side.)

GULF REFINING COMPANY
GULF PRODUCTION DIVISION
C O M P A N Y

T. D. Maxwell
COMPANY REPRESENTATIVE
T. D. Maxwell

FORM - SDM - 1-R
(Over)

MINERALS DIVISION
DEPARTMENT OF CONSERVATION
STATE OF LOUISIANA

This side to be used when requesting clearance for oil produced on Drill Stem Test or other production tests; made previous to official completion or recompletion.

Section X, Paragraph B of Order No. 29-A

Allowables given to wells for oil produced on drill stem tests, production test and any miscellaneous production of oil shall be in accordance with the following rule: All operators are required, within five days, to file three signed copies of the record of the daily production from the well, showing the number of hours the well produced and the interval of production; as "from 8:00 A. M., August 5th, to 3:00 P.M., August 8th, 1942."

DATE OF TEST	T E S T D A T A		AMOUNT OF OIL PRODUCED
	TIME OF TEST		
19	.M. TO	.M.	BARRELS
19	.M. TO	.M.	BARRELS
19	.M. TO	.M.	BARRELS
19	.M. TO	.M.	BARRELS
19	.M. TO	.M.	BARRELS
19	.M. TO	.M.	BARRELS
19	.M. TO	.M.	BARRELS
19	.M. TO	.M.	BARRELS
19	.M. TO	.M.	BARRELS
19	.M. TO	.M.	BARRELS
TOTAL:			BARRELS

The above total barrels of oil was produced from _____ Ft. to _____ Ft.
REMARKS:

C O M P A N Y

C O M P A N Y R E P R E S E N T A T I V E

RECEIVED
MAR 8 1949
 POTENTIAL REPORT
 DEPARTMENT OF MINERALS
 WAKE CHARLES

OIL WELL COMPLETION
 DISTILLATE WELL _____ RECOMPLETION _____

GAS WELL _____ RETEST _____

PARISH Cameron TIME GAUGED 2 HOUR

FIELD Wild Cat OPENING TANK GAUGE 7-7 1/2"

WELL NAME & NO. Mormontow Mineral and
Lans Company Inc. #1 CLOSING TANK GAUGE 8-3 3/4"

COMPANY Gulf Refining Co. Inc.
Sub Production No DIFFERENCE 8 1/4"

PERMIT NO. 20264 SERIAL NO. 35727 TANK NUMBER Best Tank

LOCATION: SEC. 14 TWP. 14S RANGE 6W TANK COEF. (BBLs, PER INCH) 2.76

DATE COMPLETED 3-5-49 2:15 PM BARRELS PER 22.77 HOURS 2 3 hrs

DATE GAUGED March 8 - 1949 ESTIMATED BBLs. PER DAY 225.42 7 ct

FLOWING OR PUMPING Flowing CHOCK SIZE 8/64 TYPE 6" Position

PRODUCING HORIZON _____ DAILY GAS VOLUME 266.37 "M": CU. FEET

PRODUCING FROM 10422' TO 10428' GAS/OIL RATIO: 1173/1

PERFORATED FROM 10422' TO 10428' TUBING PRESSURE 2575 LBS. SQ. IN.

CASING SEAT 9 5/8" 9752' + 70" in run to 11124' CASING PRESSURE 0 LBS. SQ. IN.

TUBING: SIZE 2 IN. BOTTOM 10404' PERCENT B. S. &/OR S. W. 17.5

TOTAL DEPTH 13210' OR 10430' CORRECTED GRAVITY 37.2 DEGREES A.P.I.

ACIDIZE WITH _____ GALLONS. ELEVATION OF DERRICK FLOOR 18.10

WITNESSED Randolph Bryant, Jr. GAUGED BY Gene B. Wase

TITLE Petroleum Engineer DISTRICT OFFICE Locust Fork, La.

CURRENT DATE 3/8/49

REMARKS: 4" Line 1" Orifice 2 1/2" x 2 1/2" x

Static pressure 180 * x Differential Pressure 12" x

*THOUSANDS

Form SDM #2 16.5 18 31.5 17.5 82.5 1856.4 / 43.085 6136

OSW

RECEIVED

MAR 8 1949

DEPARTMENT OF CONSERVATION
LAKE CHARLES

GULF REFINING COMPANY
GULF PRODUCTION DIVISION

Vinton, Louisiana
March 7, 1949

Mr. Arsene P. Edwards
Department of Conservation
Minerals Division
State of Louisiana
Lake Charles, Louisiana

Dear Sir:

Confirming telephone conversation date,
wish to advise that our Mermentau Mineral and Land
Company Incorporated No. 1, at Little Chenier,
Cameron Parish, Louisiana, was completed and turned
into tanks at 2.15 P.M., March 5, 1949.

Yours very truly

T. D. Maxwell
T. D. Maxwell
Area Prod. Supt.

ra

cc Mr. E. P. Hubbard
Houston, Texas

Mr. M. R. Redick
Harvey, Louisiana

File J-9-1

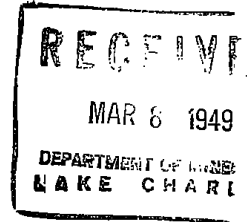

GULF REFINING COMPANY
GULF PRODUCTION DIVISION

Vinton, Louisiana
March 7, 1949

Mr. Arsene P. Edwards
Department of Conservation
Minerals Division
State of Louisiana
Lake Charles, Louisiana

Dear Sir:

Confirming telephone conversation date,
wish to advise that our Mermentau Mineral and Land
Company Incorporated No. 1, at Little Chenier,
Cameron Parish, Louisiana, was completed and turned
into tanks at 2.15 P.M., March 5, 1949.

Yours very truly

T. D. Maxwell
T. D. Maxwell
Area Prod. Supt.

ra

cc Mr. E. P. Hubbard
Houston, Texas

Mr. M. R. Redick
Harvey, Louisiana

File J-9-1

Squeeze & Perfor.
C.# 22

MINERALS DIVISION
DEPARTMENT OF CONSERVATION
STATE OF LOUISIANA

WORK PERMIT

PERMIT TO Squeeze & Perforate DATE 5-6-49
PARISH Cameron FIELD Wildcat
COMPANY Gulf Refining Co. Gulf Prod. Div.
ADDRESS Box 2100 Houston, Texas
WELL NAME Mermentau Min. & Ind. Co. No. 1 SEC 14 T 14S R 6W
WELL PERMIT SERIAL NO. 35727 WORK PERMIT NO. _____
LOCATION 660' S. & 660' W of the NE cor. Sec. 14

YOU ARE HEREBY AUTHORIZED TO Squeeze off present perforation
and perforate from 10422 to 10428.

PERMIT REQUESTED BY T.D. Maxwell TD 13260
Company Representative

AUTHORIZED BY _____

ARSENE P. EDWARDS District Office
LAKE CHARLES, LA.

MINERALS DIVISION
DEPARTMENT OF CONSERVATION
STATE OF LOUISIANA

Perforate
LC #40

WORK PERMIT

PERMIT TO Perforate DATE 3/10/49
PARISH Cameron FIELD Wildcat
COMPANY Gulf Refining Company
ADDRESS P.O. Drawer 2100 Houston, Texas
WELL NAME Mermentau Min. & Ld. Co. NO. 1 SEC 14 T. 14S. 6W
WELL PERMIT SERIAL NO. 35727 WORK PERMIT NO. _____
LOCATION 660' S & 660' W of NE corner of Sec 14

YOU ARE HEREBY AUTHORIZED TO Perforate Csg. from 10416-10424'

NOTE: Voids permission to reperforate as shown
on LC #22 "Squeeze & Perforate" TD 13260

PERMIT REQUESTED BY T.D. Maxwell

Company Representative

AUTHORIZED BY _____

ARSENE P. EDWARDS

LAKE CHARLES, DEPT. Office

MINERALS DIVISION
DEPARTMENT OF CONSERVATION
STATE OF LOUISIANA

MAR 18 1949
L A K E

Lake Charles DISTRICT

WELL COMPLETION OR RECOMPLETION REPORT

OIL WELL () NOTE COMPLETION ()
DIS. WELL () One copy to be filed with District Office within three (3) days of date of completion or recompletion (as per Order No. 29-A, Section X, Paragraph A, Article 1.) RECOMPLETION ()
GAS WELL () PERMIT
 SERIAL NO. 35727

PARISH Cameron FIELD Little Chenier SEC. 14 TWP. 14-8 RNG. 6-W
COMPANY Gulf Refining Co. LEASE Marmentau Mineral & Land WELL NO. 1
Gulf Prod. Div. Company Incorporated
DRILLING CONTRACTOR Prince Drilling DATE SPUNDED (OR W.O.) 3-8-1949
Co.
DATE COMPLETED OR RECOMPLETED 3-15 19 49, AT 8.30 A.M. P.M.

COMPLETION DATA:

INITIAL PRODUCTION 105 BBLs./DAY (NET)
TUBING PRESSURE 1550 #/SQ. IN. GA. FLOWING () SHUT IN ()
CASING PRESSURE Sealed Off #/SQ. IN. GA.
CHOKE SIZE 1/8" POSITIVE () ADJUSTABLE ()
B. S. & W. 15 PERCENT SALT WATER () WASH WATER ()
GAS VOLUME 336 MCF/DAY
GAS/OIL RATIO 1715 CF/BBLs.
GRAVITY 37.2 (60° -A.P.I.)
PRODUCING DEPTH 10416 FT. TO 10424 FT.
PERFORATED YES () NO. () BOTTOM TUBING 10405 FT. SIZE 2-3/8" IN.
CASING (OIL STRING) SIZE 7 IN. I.D. () O.D. () BOTTOM SEAT FT. 11124
TOTAL DEPTH DRILLED 13260 FT. DERRICK FLOOR ELEVATION 19 FT.

Additional clearance is requested for _____ barrels of oil produced on drill-stem or other production tests. (See Section X, Paragraph B, of Order No. 29-A on reverse side.)

**Gulf Refining Company
Gulf Production Division**

COMPANY

T. D. Maxwell
COMPANY REPRESENTATIVE
T. D. Maxwell 3/16/49

FORM - SDM - 1-R
(Over)

MINERALS DIVISION
DEPARTMENT OF CONSERVATION
STATE OF LOUISIANA

This side to be used when requesting clearance for oil produced on Drill Stem Test or other production tests; made previous to official completion or recompletion.

Section X, Paragraph B of Order No. 29-A

Allowables given to wells for oil produced on drill stem tests, production test and any miscellaneous production of oil shall be in accordance with the following rule: All operators are required, within five days, to file three signed copies of the record of the daily production from the well, showing the number of hours the well produced and the interval of production; as "from 8:00 A. M., August 5th, to 3:00 P.M., August 8th, 1942."

DATE OF TEST	T E S T D A T A		AMOUNT OF OIL PRODUCED
	TIME OF TEST		
_____ 19	_____ .M. TO _____ .M.	_____ BARRELS	
_____ 19	_____ .M. TO _____ .M.	_____ BARRELS	
_____ 19	_____ .M. TO _____ .M.	_____ BARRELS	
_____ 19	_____ .M. TO _____ .M.	_____ BARRELS	
_____ 19	_____ .M. TO _____ .M.	_____ BARRELS	
_____ 19	_____ .M. TO _____ .M.	_____ BARRELS	
_____ 19	_____ .M. TO _____ .M.	_____ BARRELS	
_____ 19	_____ .M. TO _____ .M.	_____ BARRELS	
_____ 19	_____ .M. TO _____ .M.	_____ BARRELS	
_____ 19	_____ .M. TO _____ .M.	_____ BARRELS	
_____ 19	_____ .M. TO _____ .M.	_____ BARRELS	
TOTAL:		_____ BARRELS	

The above total barrels of oil was produced from _____ Ft. to _____ Ft.

REMARKS:

C O M P A N Y

C O M P A N Y R E P R E S E N T A T I V E

MINERALS DIVISION
DEPARTMENT OF CONSERVATION
STATE OF LOUISIANA

Lake Charles DISTRICT

RECEIVED
MAR 18 1949
DEPT. OF CONSERVATION
STATE OF LOUISIANA

WELL COMPLETION OR RECOMPLETION REPORT

OIL WELL () NOTE COMPLETION ()
DIS. WELL () One copy to be filed with District Office within three (3) days of date of completion or recompletion (as per Order No. 29-A, Section X, Paragraph A, Article 1.) RECOMPLETION ()
GAS WELL () PERMIT 35727
 SERIAL NO. 35727

PARISH Cameron FIELD Little Chenier SEC. 14 TWP. 14-S RNG. 6-W
COMPANY Gulf Refining Co. Mormentau Mineral & Land
Gulf Prod. Divn. LEASE Company Incorporated WELL NO. 1
DRILLING CONTRACTOR Prince Drilling DATE SPUNDED (OR W.O.) 3-8-1949
Co.
DATE COMPLETED OR RECOMPLETED 3-15 19 49, AT 8.30 A.M. P.M.

COMPLETION DATA:

INITIAL PRODUCTION 195 BBLs./DAY (NET)
TUBING PRESSURE 1550 #/SQ. IN. GA. FLOWING () SHUT IN ()
CASING PRESSURE Sealed Off #/SQ. IN. GA.
CHOKE SIZE 1/8" POSITIVE () ADJUSTABLE ()
B. S. & W. 15 PERCENT SALT WATER () WASH WATER ()
GAS VOLUME 394 MCF/DAY
GAS/OIL RATIO 1715 CF/BBLs.
GRAVITY 37.2 (60° -A.P.I.)
PRODUCING DEPTH 10416 FT. TO 10424 FT. 10405
PERFORATED YES () NO. () BOTTOM TUBING 2-3/8" FT. SIZE 11124 IN.
CASING (OIL STRING) SIZE 7 IN. I.D. () O.D. () BOTTOM SEAT FT. 11124
TOTAL DEPTH DRILLED 13260 FT. DERRICK FLOOR ELEVATION 19 FT.

Additional clearance is requested for _____ barrels of oil produced on drill-stem or other production tests. (See Section X, Paragraph B, of Order No. 29-A on reverse side.)

Gulf Refining Company
Gulf Production Division

COMPANY

FORM - SDM - 1-R
(Over)

J. D. Maxwell
COMPANY REPRESENTATIVE
T. D. Maxwell 3/16/49

MINERALS DIVISION
DEPARTMENT OF CONSERVATION
STATE OF LOUISIANA

This side to be used when requesting clearance for oil produced on Drill Stem Test or other production tests; made previous to official completion or recompletion.

Section X, Paragraph 3 of Order No. 29-A

Allowables given to wells for oil production on drill stem tests, production test and any miscellaneous production of oil shall be in accordance with the following rule:
All operators are required, within five days, to file three signed copies of the record of the daily production from the well, showing the number of hours the well produced and the interval of production; as "from 8:00 A. M., August 5th, to 3:00 P.M., August 8th, 1942."

DATE OF TEST	TEST DATA TIME OF TEST	AMOUNT OF OIL PRODUCED:
_____ 19__	_____ .M. TO _____ .M.	_____ BARRELS
_____ 19__	_____ .M. TO _____ .M.	_____ BARRELS
_____ 19__	_____ .M. TO _____ .M.	_____ BARRELS
_____ 19__	_____ .M. TO _____ .M.	_____ BARRELS
_____ 19__	_____ .M. TO _____ .M.	_____ BARRELS
_____ 19__	_____ .M. TO _____ .M.	_____ BARRELS
_____ 19__	_____ .M. TO _____ .M.	_____ BARRELS
_____ 19__	_____ .M. TO _____ .M.	_____ BARRELS
_____ 19__	_____ .M. TO _____ .M.	_____ BARRELS
_____ 19__	_____ .M. TO _____ .M.	_____ BARRELS
TOTAL:		_____ BARRELS

The above total barrels of oil was produced from _____ Ft. to _____ Ft.
REMARKS:

C O M P A N Y

C O M P A N Y R E P R E S E N T A T I V E

Squeeze & Perforate

MINERALS DIVISION
DEPARTMENT OF CONSERVATION
STATE OF LOUISIANA

L.C. 28

WORK PERMIT

PERMIT TO Squeeze & Perforate DATE March 18, 1949
PARISH Cameron FIELD Wildcat
COMPANY Gulf Refining Company, Gulf Prod. Div.
ADDRESS Box 2100, Houston 1, Texas
WELL NAME Momentau Min. & Lnd. Co. No. 1 SEC. 14 T. 14S R. 6W
WELL PERMIT SERIAL NO. 35727 WORK PERMIT NO. _____
LOCATION 660' S & 660' W of the NE cor. Sec. 14

YOU ARE HEREBY AUTHORIZED TO Kill well squeeze off perforations 10416 to 10424 perforate 10452-56 and squeeze off.

TD 13260'

PERMIT REQUESTED BY T. D. Maxwell
Company Representative

AUTHORIZED BY
ARSENE P. EDWARDS
LAKE CHARLES, La. District Office

Perforate
L.C.# 49

MINERALS DIVISION
DEPARTMENT OF CONSERVATION
STATE OF LOUISIANA

WORK PERMIT

PERMIT TO Perforate DATE 3-23-49
PARISH Cameron FIELD Wildcat
COMPANY Gulf Refg. Co. Gulf Prod. Div.
ADDRESS Box 2100 Houston 1, Texas
WELL NAME Mormentau Min. & Lnd. NO. 1 SEC. 14 T. 14S R. 6W
WELL PERMIT SERIAL NO. 35727 WORK PERMIT NO. _____
LOCATION 660' S. & 660' W of NE cor. of Sec. 14

YOU ARE HEREBY AUTHORIZED TO Perforate for production from
10416 to 10424.

PERMIT REQUESTED BY F.D. Maxwell TD 13260
Company Representative

AUTHORIZED BY
ARSENE P. EDWARDS
LAKE CHARLE District Office

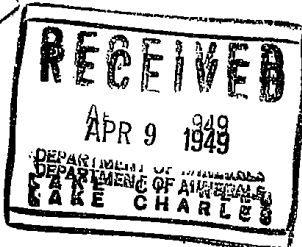

MINERALS DIVISION
DEPARTMENT OF CONSERVATION
STATE OF LOUISIANA

- PERFORATING RECORD -

DATE WORK DONE April 9-1949

WORK PERMIT NO. 20264
WORK SERIAL NO. 36727

(One Copy to be filed with the District Office)

NOTE:

THIS REPORT WILL BE RETURNED IF NOT PROPERLY FILLED IN AND SIGNED

PARISH Amite FIELD W/est SEC 16 TWP 14S RGE 6E
 COMPANY Gulf Refining Corp LEASE Amite Mineral Land WELL NO. 1
 TOTAL DEPTH 1326' PRD 1042' NEW OR OLD WELL New
 SIZE CASING 7" 26" 95" DEPTH OF CASING 95' to 1124'
 DEPTH OF PLUG BELOW PERFORATIONS one foot of follow
 PERFORATED FROM 10416' TO 10420' Gamma Ray measurement
 NUMBER OF HOLES 16 SIZE OF HOLES Cone - 1/2 hole 28 in.
 PERFORATING COMPANY Perforating Co. Inc TRUCK NUMBER 10

PURPOSE OF PERFORATIONS In production

REMARKS: Former Perforations for production 10416-10424'

Wm. Sawyer, Jr.
Shooting nipple installed, with 2" nipple used. Ex. Hydrill
no pack off B.P. and as part of well head,
Equipment, 10000' ARD Motor. Gate valve on 1
10000' test 2R.S. Valve on 2nd line, 15th M. O. G. line.

THIS WORK WAS DONE ACCORDING TO THE RULES AND REGULATIONS OF THE DEPARTMENT OF CONSERVATION, MINERALS DIVISION.

SIGNED: Gulf Refining Corp
Gulf Refining Corp
COMPANY

B. J. Reinhardt
Representative

Pull Casing
L.C.# 1

MINERALS DIVISION
DEPARTMENT OF CONSERVATION
STATE OF LOUISIANA

WORK PERMIT

PERMIT TO Pull Casing DATE April 18, 1949
PARISH Cameron FIELD Little Chenier *W.C.*
COMPANY Gulf Refg. Co. Gulf Prod. Div.
ADDRESS Box 2100 Houston, Texas
WELL NAME Mermentau Min. & Lnd. Co. NO. 1 SEC. 14 T. 14 R. SW
WELL PERMIT SERIAL NO. 20264 WORK PERMIT NO. _____
LOCATION 660' S. & 660' W. of the NE cor. of Sec. 14

YOU ARE HEREBY AUTHORIZED TO Cut & pull 9 5/8" OD casing
at 2475'. Cut & pull 13 3/8" casing at 100'.

PERMIT REQUESTED BY E.P. Hubbard TD 13260
Company Representative

AUTHORIZED BY *[Signature]*

ARSENE P. EDWARDS
LAKE CHARLES District Office

Plug & Abandon

L.C.# 27

MINERALS DIVISION
DEPARTMENT OF CONSERVATION
STATE OF LOUISIANA

WORK PERMIT

PERMIT TO Plug & Abandon DATE April 18, 1949
PARISH Cameron FIELD Wildcat
COMPANY Gulf Refg. Co. Gulf Prod. Div.
ADDRESS Box 2100, Houston, Texas
WELL NAME Mermentau Min.&Lnd. NO. 1 SEC. 14 T. 14S. 6W
WELL PERMIT SERIAL NO. 20264 WORK PERMIT NO. _____
LOCATION 660' S. & 660' W. of the NE cor. of Sec. 14

YOU ARE HEREBY AUTHORIZED TO Set 100' cmt. plug in 7" csg.
from 10420'-520'; 13 3/8" csg. OD csg. at 2275' & 20
cmt. plug in 13 3/8" csg. from 2275' to 2475'. Set
cmt. plug in 20" conductor pipe from surface 13260
to 100'.
PERMIT REQUESTED BY E. P. Hubbard

Company Representative

AUTHORIZED BY _____

ARSENE P. EDWARDS
LAKE CHARLES, District Office

RECEIVED
APR 20 1949
Department of Minerals
LAKE CHARLES



PETROLEUM AND ITS PRODUCTS

GULF REFINING COMPANY

GULF BUILDING

P. O. DRAWER 2100 · HOUSTON 1, TEXAS

GULF PRODUCTION
DIVISION

J. H. RUSSELL
VICE-PRESIDENT

April 18, 1949.

Re: Mermentau Mineral and Land
Company, Inc., Well No. 1,
Little Chenier, Cameron
Parish, Louisiana.

Department of Conservation,
Minerals Division,
State of Louisiana,
331 Broad Street,
Lake Charles, Louisiana.

Gentlemen:

Attached hereto is Department of Conservation Form
MD-11-R, marked Card #1 and Card #2, each in duplicate, covering
our application for permit to pull casing and plug and abandon
the above well.

Please mail permit to Mr. E. P. Hubbard, P. O. Box
2100, Houston, Texas.

Yours very truly,

J. H. RUSSELL, VICE-PRESIDENT.

CW/vg
cc-Department of Conservation,
Baton Rouge, Louisiana.



PETROLEUM AND ITS PRODUCTS

GULF REFINING COMPANY

GULF BUILDING

P. O. DRAWER 2100 · HOUSTON 1, TEXAS

GULF PRODUCTION
DIVISION

J. H. RUSSELL
VICE-PRESIDENT

April 27, 1949

RECEIVED
APR 29 1949
DEPARTMENT OF MINERALS
LAKE CHARLES

Department of Conservation
State of Louisiana
Minerals Division
331 Broad Street
Lake Charles, Louisiana

Gentlemen:

You will find attached, in triplicate, Schlumberger Log - Composite Run, covering the Gulf Refining Company, Gulf Production Division's Mermentau Mineral and Land Company, Inc., Well No. 1, located at Little Chenier Area, Cameron Parish, Louisiana.

Yours very truly,



J. H. Russell, Vice-President

WDA/lc

cc: Department of Conservation
State of Louisiana
Baton Rouge, Louisiana

Attach.

April 29, 1949

Mr. Thos. M. Winfield, Chief Eng.
Department of Conservation
State Capitol Building
Baton Rouge, Louisiana

Dear Sir:

Find enclosed copy of Schlumberger of Gulf
Refining Company's Mermentau Minerals & Land
Co. #1 well, Wildcat, Cameron Parish, Louisiana.
Serial No. 35727.

Yours very truly,

ARSENE P. EDWARDS
District Manager
Lake Charles, La.

APB:lmi

Encs.

2cc: State Geologist
Baton Rouge, La.

911

April 28, 1949

RECEIVED
MAY 5 1949
DEPARTMENT OF MINERALS
LAKE CHARLES

RECEIVED
MAY 2 1949
LOUISIANA
GEOLOGICAL
SURVEY

Mr. Thos. M. Winfield, Chief Eng.
Department of Conservation
State Capitol Building
Baton Rouge, Louisiana

Dear Sir:

Enclosed copy of Schlumberger of Gulf
Refining Company's Mermentau Minerals & Land
Co. #1 well Wildcat, Cameron Parish, Louisiana.
Serial No. 35727.

Yours very truly,

M. P. Edwards
MARSENE P. EDWARDS
District Manager
Lake Charles, La.

APE:iml

Enc. State Geologist
Baton Rouge, La.

Received



PETROLEUM AND ITS PRODUCTS

GULF REFINING COMPANY

GULF BUILDING

P. O. DRAWER 2100 · HOUSTON 1, TEXAS

GULF PRODUCTION
DIVISION

J. H. RUSSELL
VICE-PRESIDENT

May 4, 1949

Department of Conservation
State of Louisiana
Minerals Division
331 Broad Street
Lake Charles, Louisiana

Gentlemen:

You will find attached, in triplicate, Driller's Log covering the Gulf Refining Company - Gulf Production Division's Mermentau Mineral & Land Company, Inc., Well No. 1, located at Little Chenier Area, Cameron Parish, Louisiana.

Permit No. 20264 - Serial No. 35727

Yours very truly,



J. H. RUSSELL - VICE-PRESIDENT

JEE:sm
Attach.

cc: Department of Conservation
State of Louisiana
Baton Rouge, Louisiana