



FRANK P. SIMONEAUX  
SECRETARY

DEPARTMENT OF NATURAL RESOURCES  
DIVISION OF STATE LANDS

STEPHEN ZERANGUE  
DIRECTOR

June 2, 1982

Mr. J. Roy Faulk  
John E. Chance & Associates  
P. O. Box 52029  
Lafayette, LA 70505

RE: P820804 Coastal Use Permit Application  
Huffco Petroleum Corporation  
Construct board road and ring levee  
Sec. 25, T12S-R4W  
Cameron Parish, LA

Dear Mr. Faulk:

A review has been completed of the application referenced above. The proposed activity is being conducted outside the coastal zone and does not have a direct and significant impact on coastal waters. Therefore, in accordance with La. R.S. 49, Sections 213.4 and 213.15 A(10) of the Coastal Zone Management Act of 1978, a coastal use permit is not required.

Sincerely,

A handwritten signature in cursive script that reads 'Joel L. Lindsey'.

JOEL L. LINDSEY  
CMS/DNR ADMINISTRATOR

JLL/cb

cc: Mr. Charles Decker  
Corps of Engineers  
P. O. Box 60267  
New Orleans, LA 70160

181974

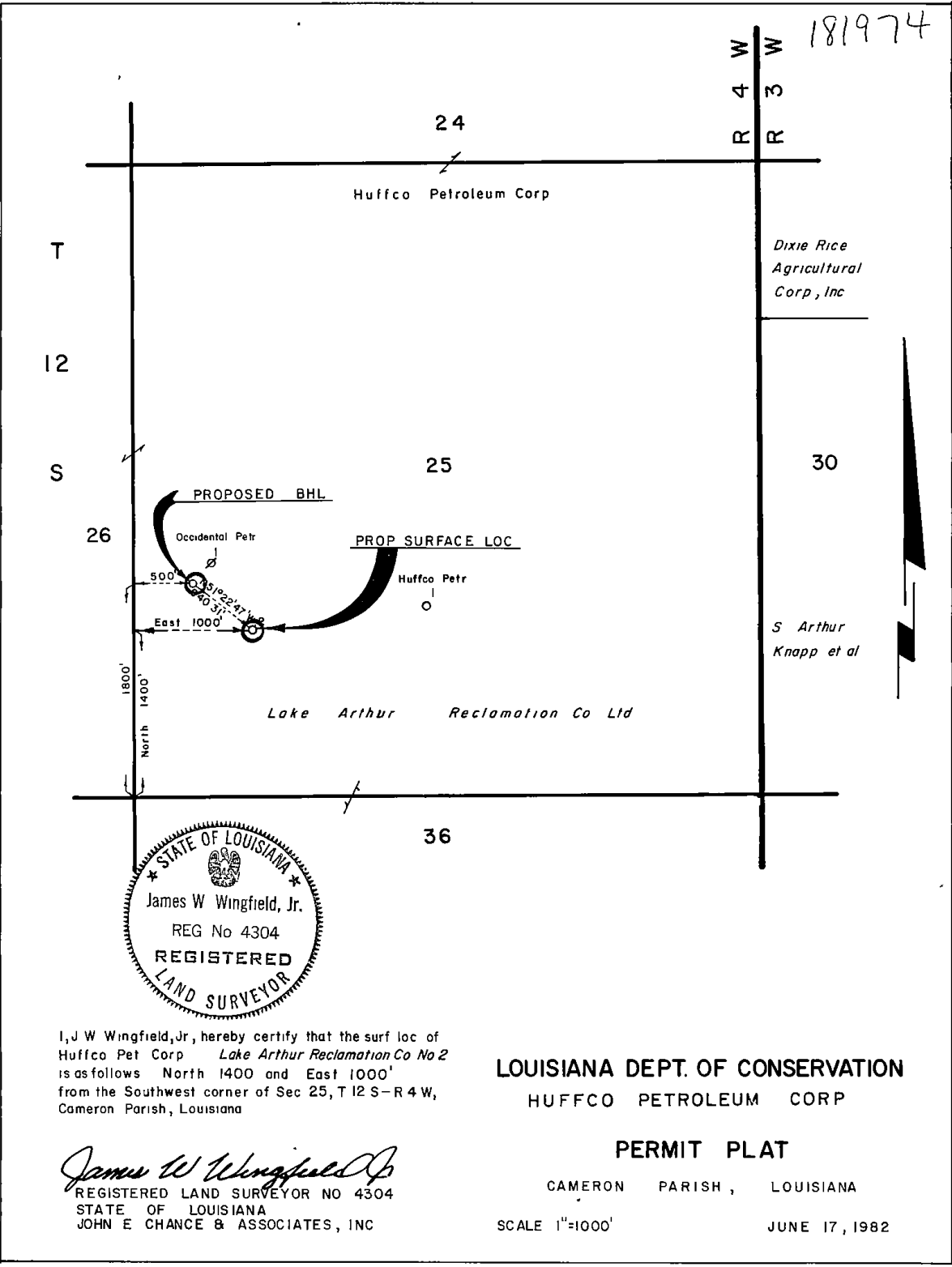

I, J W Wingfield, Jr, hereby certify that the surf loc of Huffco Pet Corp Lake Arthur Reclamation Co No 2 is as follows North 1400 and East 1000' from the Southwest corner of Sec 25, T 12 S-R 4 W, Cameron Parish, Louisiana

LOUISIANA DEPT. OF CONSERVATION  
 HUFFCO PETROLEUM CORP

PERMIT PLAT

CAMERON PARISH, LOUISIANA

SCALE 1"=1000'

JUNE 17, 1982

*James W Wingfield Jr*  
 REGISTERED LAND SURVEYOR NO 4304  
 STATE OF LOUISIANA  
 JOHN E CHANCE & ASSOCIATES, INC

STATE OF LOUISIANA  
OFFICE OF CONSERVATION

Inter Office

Date: 7/6/82

To: Baton Rouge Office  
From: Lake Charles District  
Attn: T. P. Heard

Enclosed herewith please find application from Huffco Petroleum Corporation  
for permit to drill  
their Lake Arthur Reclamation Co. #2, Wildcat Field  
Cameron Parish, Louisiana. Zone onshore

Also enclosed please find:

Check No. 000140 in the amount of \$ 100.00

xxx Well location plat  
xxx Well location certification

*OK w/c zm*  
*24B-1*  
*24E*

Form A.D.C.  
Electric Log.  
Schematic diagram  
(Dual) structure map if well does not comply with existing Orders  
(Selective-Onshore) structure map showing reservoir limits  
(Selective-Offshore) letter(s) of no objection from offset operators

Applicable Department of Conservation Order No. 29-B & E

Pending Hearing, Docket No. \_\_\_\_\_

Remarks & Recommendations:

Recommend approval. Routine.

By W. C. Wilhite  
District Manager

cc: Geological Oil & Gas Division  
Prod. Audit (for Amended Permits only)

W. C. WILHITE

LT-1

FORM MD 13 R

WELL FILE COPY

STATE OF LOUISIANA  
DEPT OF CONSERVATION

PERMIT TO DRILL FOR MINERALS

PERMIT \$100 00  
Multiple Zone Processing

Att

Send To Lake Charles/26 Date July 7, 1982

Serial No Ser#181974 API#1702321815

Parish Cameron 012 Field Wildcat 9733

Operator Huffco Petroleum Corporation 9999

Address P.O. box 4436

City & State Houston, Texas 77210

Well Name Lake Arthur Reclamation Co No.2

Location Sec.25, T12S, R4W  
Suf: N 1400' & E 1000' fr SW/cor of Sec.25.BHL: 1800' FSL & 500' FWL  
of Sec.25

PTD 13,000

Zone or Reservoir of Proposed Completion Milvey and/or Alliance Sd.

Applicable Department of Conservation Order 29B, 29E

*Patrick H. Martini*  
COMMISSIONER

*[Signature]*  
ISSUING AUTHORITY 16769



# State of Louisiana

PATRICK H. MARTIN  
COMMISSIONER

DEPARTMENT OF NATURAL RESOURCES  
OFFICE OF CONSERVATION

P.O. BOX 44275  
BATON ROUGE, LA. 70804-4275

Huffco Petroleum Corporation July 23, 1982  
P.O. Box 4436  
Houston, Texas 77210

RE: Cameron Parish  
Wildcat Field  
Lake Arthur Reclamation Co. #2  
Ser# 181974

Gentlemen:

We are issuing Permit to Drill for the above referenced well with the understanding that you will furnish the appropriate District Manager with a Directional Survey as proof that the well has been drilled in compliance with the provisions of the Statewide Order No. 29-B, Section XVIII, Paragraph 3 dated March 1, 1967.

In addition, completion of said well cannot be in any pool in which the location does not conform with the provisions of Statewide Order No. 29-F.

Very truly yours,

PATRICK H. MARTIN, COMMISSIONER  
OFFICE OF CONSERVATION

BY

Joseph W. Hecker  
Chief Engineer

cc: Mr. Wm. C. Vilhite  
District Manager

Lake Charles

JWH/TH/klw

29-B-1 F.

29-E COMPLIANCE        YES        NO  
 29 E UNIT ATTACHED        YES        NO  
 \_\_\_\_\_  
 D O C USE ONLY

STATE OF LOUISIANA  
 OFFICE OF CONSERVATION

WELL COMPLETION OR RECOMPLETION REPORT

DISTRICT        Lake Charles

CODE NUMBERS \_\_\_\_\_ DATE 8/24/82  
 \_\_\_\_\_ PARISH Cameron  
 \_\_\_\_\_ FIELD Wildcat  
 \_\_\_\_\_ OPERATOR Huffco Petroleum Corporation  
 \_\_\_\_\_ WELL NAME Lake Arthur Reclamation Co. NO 2 SERIAL NO 181974  
 \_\_\_\_\_ RESERVOIR 10,395-415' Sd 8/17/82 7:00  
 \_\_\_\_\_ COMPLETION DATE \_\_\_\_\_ TIME  AM  PM  
 SEC 25 T 12S R 4W  
 DOC ORDER NO \_\_\_\_\_

IMPORTANT IS A FORM MD 10 R A BEING FILED WITH THIS REPORT? IF NO, EXPLAIN YES  NO   
 REMARKS        N/A

COMPLETION DATA

* TYPE COMPLETION	PRIMARY PRODUCT	PRIMARY PRODUCT CHANGE?	PRODUCING METHOD	STATUS OF WELL
<input type="checkbox"/> 1 ORIG COMP <input type="checkbox"/> 2 RE COMP	<input type="checkbox"/> 1 OIL <input type="checkbox"/> 2 GAS <input type="checkbox"/> 3 DRY GAS	<input type="checkbox"/> 1 YES <input type="checkbox"/> 2 NO	<input type="checkbox"/> F F - FLOWING <input type="checkbox"/> GL GAS LIFT <input type="checkbox"/> P - PUMPING	<input type="checkbox"/> 3 <input type="checkbox"/> 7 SEE REVERSE SIDE FOR CODE

\* IF THIS IS A RE COMPLETION SPECIFY SAME RESERVOIR  DIFFERENT RESERVOIR

336 INITIAL PROD BOPD    296 GAS VOLUME MCF/DAY    1250 FLOWING TUBING PRESSURE PSIG    1500 SHUT-IN TUBING PRESSURE PSIG    0 CASING PRESSURE PSIG  
16 / 64" CHOKE SIZE     1 POSITIVE ADJUST    0 WATER PROD BPD    0 BS & W %    881 GOR CF/BBL    37.7 GRAVITY API AT 60°F

PERFORATIONS 10,395' - 10,415' TOTAL DEPTH 10679' MD

CLEARANCE & CERTIFICATION

ADDITIONAL CLEARANCE IS REQUESTED FOR 375 BBLs OF OIL PRODUCED ON DRILL STEM OR OTHER PRODUCTION TEST (SEE SECTION X PARAGRAPH B OF ORDER 29 B ON REVERSE SIDE)

*cleaned 8-31-82*

CERTIFICATION

I HEREBY CERTIFY THAT THE ABOVE INFORMATION IS TRUE AND CORRECT TO THE BEST OF MY KNOWLEDGE

INSTRUCTIONS

( THREE (3) COPIES TO BE FILED WITH THE DISTRICT OFFICE WITH IN THREE (3) DAYS OF DATE OF COMPLETION OR RECOMPLETION (AS PER ORDER 29 B, SECTION X, PARAGRAPH A, ARTICLE 1) )

L. H. Caplan  
 SIGNATURE  
 Huffco Petroleum Corporation  
 OPERATOR  
 Production Technician  
 TITLE





**OFFICE OF CONSERVATION**  
WELL HISTORY AND WORK RESUME REPORT

*Willie*

FIELD  
**Wildcat**

SERIAL NO  
**181974**

PRODUCING INTERVAL  
**10,395'-10,415'**

RESERVOIR (COMPANY SAND IDENTIFICATION)  
**10,400' Sand**

Three typewritten copies of this report must be filed with the District Office of the Office of Conservation in which the well is located within twenty (20) days of the date of completion. NOTE: If not properly completed and signed this report will be returned

LEASE AND WELL DATA

CHECK APPROPRIATE BOXES

NEW WELL  
 RECOMPLETION  
 P & A

31 INACTIVE DRY HOLE FUT UTIL  
 32 INACTIVE DRY HOLE NO FUT UTIL  
 36 INACTIVE WAITING ON PIPELINE  
 37 INACTIVE WAITING ON MARKET

PRODUCT  
 OIL  
 GAS  
 OTHER

IF RECOMPLETION  
 SAME RESERVOIR  
 DIFFERENT RESERVOIR

DATE COMP, RECOMP, OR P & A M D Y  
**8/17/82**

OPERATOR  
**Huffco Petroleum Corporation**

CODE  
**4**

ADDRESS  
**P.O. Box 4436, Houston, TX 77210**

WELL NAME  
**Lake Arthur Reclamation Co.**

WELL NO  
**2**

PARISH  
**Cameron**

**25<sup>SEC</sup> 125<sup>SP</sup> 46<sup>FW</sup>**

DATE PERMIT ISSUED  
**7/7/82**

DATE SPUNDED M D Y  
**7/18/82**

DATE READY TO PRODUCE\*  
**8/17/82**

TOTAL DEPTH  
**10679'**

PBTD  
**10605'**

GROUND ELEVATION  
**0**

CASING HEAD FLANGE ELEVATION  
**0**

DISTANCE FROM RKB TO CHF  
**21'**

DATE WELL TURNED INTO TANKS  
**8/27/82**

SINGLE, DUAL OR TRIPLE COMPLETION?  
**Single**

NOTE: IF THIS IS A MULTIPLE COMPLETION, FURNISH A SEPARATE REPORT FOR EACH COMPLETION

WAS WELL DIRECTIONALLY DRILLED? **Yes**

WAS DIRECTIONAL SURVEY MADE? **Yes**

WERE 3 COPIES FILED WITH THE OFFICE OF CONSERVATION? **Yes**

DATE FILED  
**9/2/82**

TYPE OF ELECTRICAL OR OTHER LOGS RUN (CIRCLE LOGS FILED WITH OFFICE OF CONSERVATION)  
**CBL-GR-Collar, Dual Ind, Dens, GR**

DATE FILED  
**9/16/82**

CASING, LINER AND TUBING RECORD

LOG NO	CASING SIZE	HOLE SIZE	CASING WEIGHT	DEPTH SET		SACKS CEMENT	TEST PRESSURE	HOURS UNDER PRESSURE	DATE TESTED (MM DD YY)	NAME OF TEST WITNESS - STATE IF CONSERVATION AGENT OR OFFSET OPERATOR
				FROM	TO					
101	10-3/4"	14-3/4"	45.5	0	3025	2100	1000#	1/2	7/22/82	Norman Schmitt
102	7"	9-7/8"	23.0	0	10679'	1264	1500#	1/2	8/14/82	Norman Schmitt
103										
104										
105										

TUBING SIZE: **2-7/8"** DEPTH OF TUBING: **10352'** DEPTH OF PACKER(S): **10330'**

INITIAL COMPLETION OR RE-COMPLETION DATA

INITIAL PRODUCTION  
**336**

GAS VOLUME  
**296**

GOR  
**881**

CHOKE SIZE  
**16**

PRODUCING METHOD  
**flowing**

FLOWING TUBING PRESSURE  
**1250**

SHUT-IN TUBING PRESSURE  
**1500**

CASING PRESSURE  
**0**

WATER PRODUCTION  
**0**

BSSW  
**0**

GRAVITY  
**37.7**

BHP (SHUT-IN)  
**4403**

COMPANY REPRESENTATIVE  
**David Poche**

DATE GAUGED  
**8/17/82**

PLUG AND ABANDON (P & A) DATA

CASING SIZE	AMOUNT PULLED	CEMENT PLUGS				DATE WORK PERFORMED	NAME OF TEST WITNESS - STATE IF CONSERVATION AGENT OR OFFSET OPERATOR
		FROM	TO	SACKS	HOW PLACED		

CERTIFICATE: I, the undersigned, state that I am employed by **Huffco Petroleum Corp.** and that I am authorized to make this report, and that this report was prepared under my supervision and direction and that all facts stated herein are true, correct and complete to the best of my knowledge.

Signature: *Lucretia H. Caplan* Title: **Production Technician**

\*Date well is equipped to produce, but due to no available market, no pipe line connection, etc; the well has been shut-in



WORK RESUME

List below all work performed under Office of Conservation Work Permits while drilling and completing well

WORK PERMIT NO	DATE WORK PERFORMED	SERVICE COMPANY	DESCRIPTION OF WORK
			<p>1. PB to 9400'-8879'</p> <p>2. Sidetrack 8879'-10679'</p> <p>3. Perforate 10395'-10415'</p>

32100' 9 AIO: 21  
 PERFORATE

List below all important Paleofaunal or Geological Formation tops, Cap Rock and Salt Overhang bottoms

FORMATION	DEPTH	FORMATION	DEPTH
<p>13 A 8: 53</p>	<p>13 A 8: 53</p>	<p>13 A 8: 53</p>	<p>13 A 8: 53</p>

13 A 8: 53

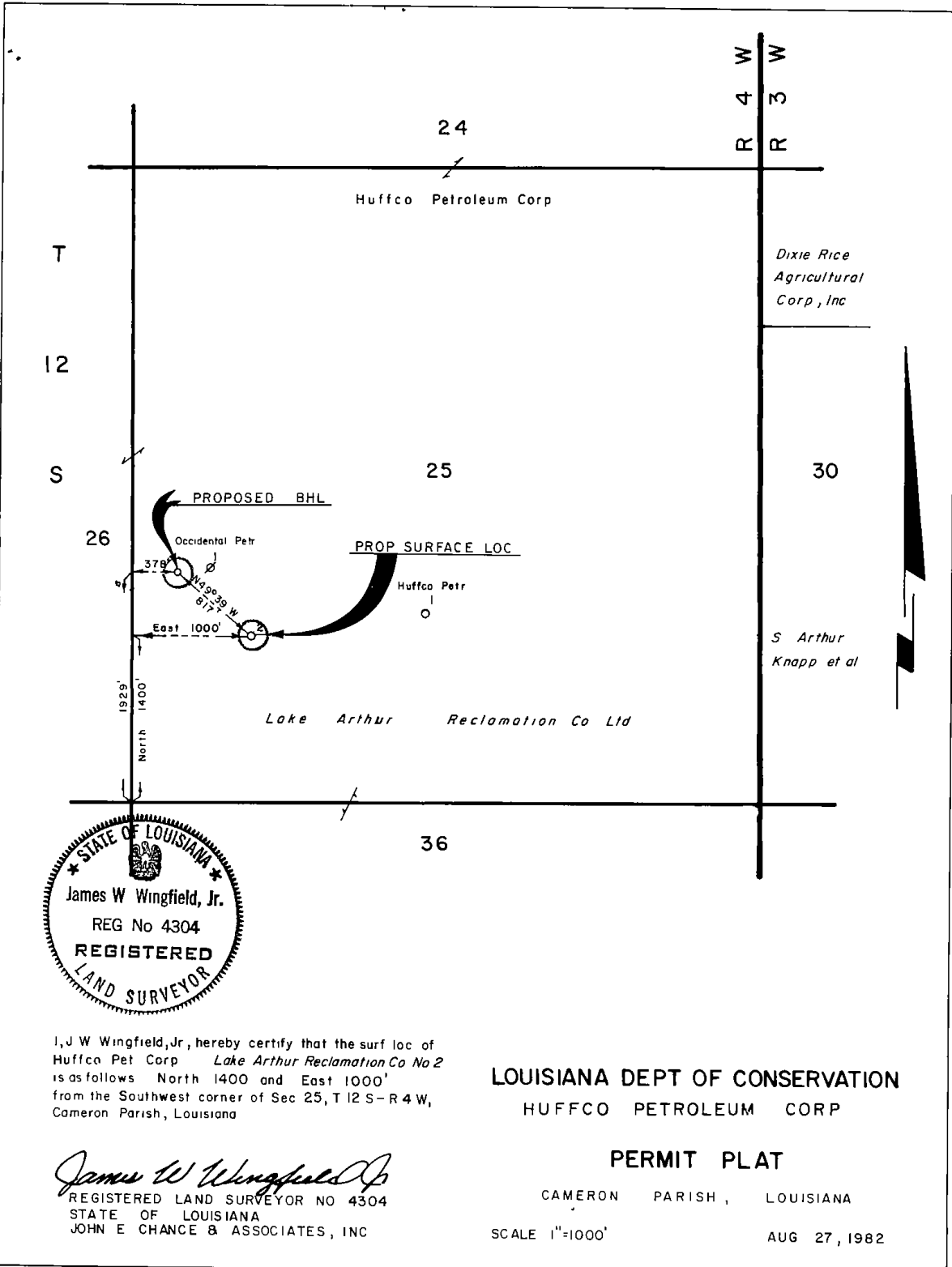

I, J W Wingfield, Jr, hereby certify that the surf loc of Huffco Pet Corp Lake Arthur Reclamation Co No 2 is as follows North 1400 and East 1000' from the Southwest corner of Sec 25, T 12 S - R 4 W, Cameron Parish, Louisiana

LOUISIANA DEPT OF CONSERVATION  
 HUFFCO PETROLEUM CORP

*James W Wingfield Jr*  
 REGISTERED LAND SURVEYOR NO 4304  
 STATE OF LOUISIANA  
 JOHN E CHANCE & ASSOCIATES, INC

PERMIT PLAT  
 CAMERON PARISH, LOUISIANA  
 SCALE 1"=1000'  
 AUG 27, 1982

1819.74

STATE OF LOUISIANA  
OFFICE OF CONSERVATION  
LOUISIANA STATE POTENTIAL REPORT

District Lake Charles INPUT TYPE  
 Field Camp W/C 1 - OC Only  
 Parish Cameron  2 - Original  
 Operator Huffco Pet Corp. Code 11 3 - Correction  
 Sec 25 TWP. 12S RGE 4W Test Date 9 / 6 / 82  
 12 Mo Day Yr

TYPE OF WELL TYPE OF TEST PRODUCING METHOD  
 1 1-OIL  1 1-COMPLETION  F F-FLOWING  
 18 2-GAS  19 2-RECOMPLETION  P P-PUMPING  
 20 G-GASLIFT

WELL SERIAL NO	WELL NAME	WELL NO	NAME OF RESERVOIR
181974	L.A. Reclamation	2	10,000' sand

TOTAL DEPTH	PERFORATED INTERVAL FROM	PERFORATED INTERVAL TO	CHOKE /64"	OIL BBL/DAY	COND BBL/DAY	GAS MCF/DAY	GAS/OIL RATIO CF/BBL
10679	10393	10415	18	480	-	275	573/1

API GRAV @ 60° F	WATER BBL/DAY	BS & W %	FLOWING PRES (PSIG)	CASING PRES (PSIG)	DATE OF COMPLETION		
76	80	86	89	95	MO	DAY	YR
38.0	0	.1	1300	0	8	28	82

CLOSE TANK / METER GAUGE 18' 8" @ 9 AM TIME  
 OPEN TANK / METER GAUGE 15' 8" @ 12:00 noon TIME  
 DIFFERENCE 3' 0" IN 3 HOURS  
 TANK / METER NO New TANK COEF 1.67

STATIC PRES \_\_\_\_\_ DIFFERENTIAL PRES. \_\_\_\_\_ LINE SIZE \_\_\_\_\_  
 PLATE SIZE \_\_\_\_\_ COEFFICIENT \_\_\_\_\_ METER SPRING & DIFF RANGE \_\_\_\_\_  
 REMARKS Orifice well tester 15" Atmospheric Pressure  
10" Mer. 1" plate 2" lead

WITNESSED BY Marvin Smith GAUGED BY D. H. Pangray  
 TITLE Exec. Asst. Insp. TITLE Prod. Foreman

STATE OF LOUISIANA  
OFFICE OF CONSERVATION

Inter Office

Date: 9/9/82

To: Baton Rouge Office  
From: Lake Charles District  
Attn: T. P. Heard

Enclosed herewith please find application from Huffco Petroleum Corporation  
\_\_\_\_\_ for permit to amend BHL  
their Lake Arthur Reclamation Co. #2, Wildcat \_\_\_\_\_ Field  
Cameron \_\_\_\_\_ Parish, Louisiana. Zone onshore

Also enclosed please find:

Check No. 000216 in the amount of \$ 25.00

xxx Well location plat  
xxx Well location certification

*29-B*  
*29-E*

\_\_\_\_\_ Form A.D.C.  
\_\_\_\_\_ Electric Log  
\_\_\_\_\_ Schematic diagram  
\_\_\_\_\_ (Dual) structure map if well does not comply with existing Orders  
\_\_\_\_\_ (Selective-Onshore) structure map showing reservoir limits  
\_\_\_\_\_ (Selective-Offshore) letter(s) of no objection from offset operators

Applicable Department of Conservation Order No. 29-B & E

Pending Hearing, Docket No. \_\_\_\_\_

Remarks & Recommendations:

Recommend approval. Routine.

~~XXXXXXXX~~

By W. C. Wilhite  
District Manager

cc: Geological Oil & Gas Division  
Prod: Audit (for Amended Permits only)

W. C. WILHITE

LT-1

DEPT OF CONSERVATION  
USE ONLY

FORM MD-15 R  
(R 2 1976)

AMENDED PERMIT TO DRILL FOR MINERALS

STATE OF LOUISIANA  
DEPARTMENT OF CONSERVATION  
Amended Permit \$25 00

Change

181974 Serial No LC Date 9-14-82

8208 Effective  
yy/mm

CURRENT CODES

012 PARISH Cameron  
9733 FIELD Wildcat  
2726 OPERATOR Huffco Petroleum Corporation  
ADDRESS P.O. Box 4436  
CITY & STATE Hosuton, TX 77210

FORMER CODES

AMENDMENT ACTION

PARISH

FIELD

OPERATOR

LSE UN

UN-LSE

LSE-LSE

UN-UN

WELL NO

LOCATION

039033 WELL NAME Lake Arthur Reclamation Co No 2

LOCATION OF WELL Sec 25 T 12S R 4W Former Well No \_\_\_\_\_

Location Change: Surf: N1400' & E 1000' from SW cor. of Sec. 25.

VBHL: 1929' N & 378' E of SW cor. Sec. 25

API#1702321815

Applicable Department of Conservation Order 29B 29E

*Patrick H. Martin*  
Commissioner

WELL FILE COPY

*[Signature]*  
No. 78146 id A



PATRICK H. MARTIN  
COMMISSIONER



DEPARTMENT OF NATURAL RESOURCES  
OFFICE OF CONSERVATION

P O BOX 44275  
BATON ROUGE, LA 70804-4275

October 1, 1982

RE: Cameron Parish  
Wildcat Field  
Lake Arthur Reclamation Co #2  
Serial #181974

Huffco Petroleum Corporation  
P.O. Box 4436  
Houston, TX 77210

Gentlemen:

We are issuing Amended Permit to Drill for the above referenced well with the understanding that you will furnish the appropriate District Manager with Inclination and/or Directional Survey data as proof that the well has been drilled in compliance with the provisions of the Statewide Order No. 29-B, Section XVIII, dated March 1, 1967.

In addition, completion of said well cannot be in any pool in which the location does not conform with the provisions of the Statewide Order No. 29-E.

No allowable will be assigned said well unless in compliance with the above provisions.

Very truly yours,

PATRICK H. MARTIN, COMMISSIONER  
OFFICE OF CONSERVATION

BY

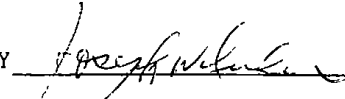
  
Joseph W. Hecker  
Chief Engineer

cc: Wm. C. Wilhite  
District Manager  
JWH/TPH/jd

29-B, E

DEPT OF CONSERVATION  
USE ONLY

1  Change  
2  Correction

8303 Effective Date  
yymm

9999 End Date  
yymm

AMENDMENT ACTION

- 0.0.9  PARISH
- 0.3.4  FIELD
- 0.3.5  OPERATOR
- 0.1.6  LSE-UN
- 0.1.6  UN-LSE
- 0.1.6  LSE LSE
- 0.1.6  UN-UN
- 0.1.4  WELL NO
- 5.2.1  LOCATION

LC 11 MD-15 RC  
(R 2 1976)

AMENDED PERMIT TO DRILL FOR MINERALS (CORRECTED)

STATE OF LOUISIANA  
DEPARTMENT OF CONSERVATION  
Amended Permit (Corrected)

Serial No 181974 LC Date May 2, 1983

CURRENT CODES

012 PARISH Cameron

7325 FIELD Perreau Island \*

2726 OPERATOR Huffco Petroleum Corporation

ADDRESS P.O. Box 4436

CITY & STATE Houston, TX 77210

FORMER CODES

9733

039033 WELL NAME Lake Arthur Reclamation Co No 2

LOCATION OF WELL Sec 25 T 12S R 4W Former Well No \_\_\_\_\_

Location Same. \*Formerly: Wildcat

API#1702321815

Applicable Department of Conservation Order

*Rafuck H. Mentz*  
Commissioner

*[Signature]*  
Issuing Authority

WELL FILE COPY

No

A-C



STATE OF LOUISIANA  
OFFICE OF CONSERVATION

Inter Office

Date: 4/25/85

To: Baton Rouge Office

From: Lake Charles District

Attn: Ed Buford

Enclosed herewith please find application from Huffco Petroleum Corp.  
\_\_\_\_\_ for permit to amend well name  
their 10300 RA SUD; LK Arthur Rec. #2, Perreau Island Field  
Cameron Parish, Louisiana. Zone Onshore

Also enclosed please find:

Check No. \_\_\_\_\_ in the amount of \$ \_\_\_\_\_.

\_\_\_\_\_ Well location plat

\_\_\_\_\_ Well location certification

\_\_\_\_\_ Form A.D.C.

\_\_\_\_\_ Electric Log

\_\_\_\_\_ Schematic diagram

\_\_\_\_\_ (Dual) structure map if well does not comply with existing Orders

\_\_\_\_\_ (Selective-Onshore) structure map showing reservoir limits

\_\_\_\_\_ (Selective-Offshore) letter(s) of no objection from offset operators

Applicable Department of Conservation Order No. 1265.

Pending Hearing, Docket No. \_\_\_\_\_.

Remarks & Recommendations: Recommend approval. Amendment to change well name per nomenclature of unit Order 1265 for which this well is completed into.

FORMERLY: Lake Arthur Reclamation Co . #2

By Frank Perkins Jr.  
District Manager

cc: Geological Oil & Gas Division  
Prod. Audit (for Amended Permits only)

LT-1



STATE OF LOUISIANA  
OFFICE OF CONSERVATION  
LOUISIANA STATE POTENTIAL REPORT

PERMIT SECTION

District Lake Charles INPUT TYPE 2 2- Original  
 Field Oak Island Perea Island 1- Only  
 Parish Cameron 11  
 Operator Huffco Petr. Code 2726 3- Correction  
 Sec. 25 TWP. 12<sup>E</sup> RGE. 4<sup>W</sup> Test Date 3 / 3 / 86  
12 Mo Day Yr.

TYPE OF WELL                      TYPE OF TEST                      PRODUCING METHOD

1- OIL                       1- COMPLETION                       F- FLOWING  
 2- GAS                       2- RECOMPLETION                       P- PUMPING  
 18                       19                       20                       G- GASLIFT

WELL SERIAL NO	WELL NAME	WELL NO.	NAME OF RESERVOIR
181974	Lake Arthur Reclam.	2	10300 RA 54 D

TOTAL DEPTH	PERFORATED INTERVAL FROM	TO	CHOKE /64"	OIL BBL/DAY	COND BBL/DAY	GAS MCF/DAY	GAS/OIL RATIO CF/BBL
10500	10395	10415	02	75	-	-	-

API GRAV @ 60° F	WATER BBL/DAY	BS&W %	FLOWING PRES (PSIG)	CASING PRES (PSIG)	DATE OF COMPLETION		
					MO	DAY	YR
40.0	1000	93%	115	3275	1	28	86

CLOSE TANK / METER GAUGE 14' 0" • 9 AM TIME  
 OPEN TANK / METER GAUGE 10' 2" • 9 AM TIME  
 DIFFERENCE 3' 10" in 24 HOURS  
 TANK / METER NO. New TANK COEF. 1.67

STATIC PRES. \_\_\_\_\_ DIFFERENTIAL PRES. \_\_\_\_\_ LINE SIZE \_\_\_\_\_  
 PLATE SIZE \_\_\_\_\_ COEFFICIENT \_\_\_\_\_ METER SPRING & DIFF. RANGE \_\_\_\_\_

REMARKS Hope injection pump. Inject down tubing & Flowing through Csp.  
No Gas.

WITNESSED BY [Signature] GAUGED BY [Signature]  
 TITLE Energy Mgr. Insp. TITLE Inspector

DEPT OF CONSERVATION  
USE ONLY

~~XXX~~ Change

8609 Effective  
yy/mm

AMENDMENT ACTION

- 0.0.9 PARISH
- 0.3.4 FIELD
- 0.8.1 OPERATOR
- 0.1.6 LSE-UN
- 0.1.6 UN-LSE
- 0.1.6 LSE-LSE
- 0.1.6 UN-UN
- 0.1.4 WELL NO
- 5.2.1 LOCATION

FORM MD 15-R  
(R 2-1976)

AMENDED PERMIT TO DRILL FOR MINERALS

STATE OF LOUISIANA  
DEPARTMENT OF CONSERVATION

Amended Permit \$75 00

181974 Serial No L Date October 15, 1986

CURRENT CODES

012 PARISH Cameron  
7325 FIELD Perreau Island  
3654 OPERATOR M & M Investments\*  
 ADDRESS 205 Stoney Brook Cove  
 CITY & STATE Jackson, MS 39211

FORMER CODES

2726

041925 WELL NAME 10300 RA SUD;LK Arthur Rec No 2

LOCATION OF WELL Sec 25 T 12S R 4W Former Well No \_\_\_\_\_

\*Huffco Petroleum Corporation

Applicable Department of Conservation Order \_\_\_\_\_

Robert W. Thompson  
Commissioner

[Signature]  
Issuing Authority

WELL FILE COPY

No. 103684 A

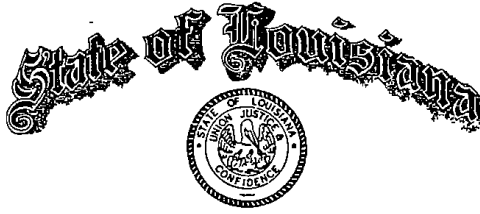

EDWIN W EDWARDS  
GOVERNOR  
B JIM PORTER  
SECRETARY

DEPARTMENT OF NATURAL RESOURCES  
OFFICE OF CONSERVATION  
September 1, 1987

HERBERT W. THOMPSON  
ASSISTANT SECRETARY  
AND  
COMMISSIONER

Office of Conservation  
Attn: Mr. W. J. Clark  
P.O. Box 94275 Capitol Station  
Baton Rouge, La. 70804-9275

Dear Mr. Clark:

Enclosed herewith please find application for permit to amend the operator name from M & M Investments to Central Southwest Company on their 10300 RA SUD; Lk Arthur Rec # 2 Serial # 181974 Field Perreau Island, Parish Cameron.

Also enclosed is a COPY of Check No 104 for \$75.00. This check was forwarded under separate cover to the Accounting Section of the Baton Rouge office.

The effective date of this change is 7-1-87 and the product is OIL.

Yours very truly,

  
Gerard E. LeBlanc, Manager  
Lafayette District

GEL;rr

Encls.

CC: Audit Section  
Baton Rouge, La.

DEPT OF CONSERVATION  
USE ONLY

~~XXXX~~ Change

8707 Effective  
yy/mm

AMENDMENT ACTION

- 0.0.0.1 PARISH
- 0.3.4.2 FIELD
- 0.0.0.0 OPERATOR
- 0.1.6.4 LSE-UN
- 0.1.6.5 UN-LSE
- 0.1.6.6 LSE-LSE
- 0.1.6.7 UN-UN
- 0.1.4.8 WELL NO
- 5.2.1.9 LOCATION

FORM MD-15-R  
(R 2-1976)

AMENDED PERMIT TO DRILL FOR MINERALS

STATE OF LOUISIANA  
DEPARTMENT OF CONSERVATION

Amended Permit \$75.00

181974 Serial No L Date September 17, 1987

CURRENT CODES

012 PARISH Cameron  
 7325 FIELD Perreau Island  
 0412 OPERATOR Central Southwest Company\*  
 ADDRESS Rt. 3, Box 194  
 CITY & STATE Milton, FL 32570

FORMER CODES

3654

041925 WELL NAME 10300 RA SUD; Lb Arthur Rec No 2

LOCATION OF WELL Sec 25 T 12S R 4W Former Well No

\* M & M Investments

Applicable Department of Conservation Order 29B

*Herbert W. Thompson*  
Commissioner

*[Signature]*  
Issuing Authority

WELL FILE COPY

No. 107770 A

Work Permit

STATE OF LOUISIANA DEPARTMENT OF CONSERVATION

Well Name & No 10300 RA SUD; Lk. Arthur Rec. No.2 Sec 25 T 12S R 4W  
Field Perreau Island Parish Cameron  
Permit Serial No 181974 Work Permit No LP# 776-90

Description of Work P&A well as per LA Dept. of Conservation rules & regu-  
lations by swz. perfs 10395-415 & set a plug from 13395-295, cut &  
pull 7" @ 3000 & set a cmt. plug from 3100-2900'. Set a 50' plug  
from 54'-4' & cut all pipe 4' BGL & weld 9 1/2" steel plate on same

Sand & Reservoir To Be Tested P & A TD 11,275

Operator Central Southwest Company  
Address 107 Joyner Lane  
City, State & Zip Bruton, AL 36426

Permit Requested By Brian K. Vesey Brian K. Vesey Date 7-20-90

Original Signed By:  
Permit Authorized By G. E. LeBlanc District Laf Date 7-20-90

See Instructions On Reverse Side

Form DM 4R Rev

STATE OF LOUISIANA **RECEIVED**  
 OFFICE OF CONSERVATION FEB 03 1992  
 Office of Conservation  
 Well Files  
 Baton Rouge, LA

PLUG AND ABANDON REPORT

WORK PERMIT NO LP# 746-90

WELL SERIAL NO 181974  
~~181972~~

DATE WORK FINISHED (MM-DD-YY) 7-3-90

Lafayette DISTRICT

(Three Copies to be Filed with the District Office)

NOTE This Report Will Be Returned If Not Properly Completed And Signed

Field Barrou Island Parish Cameron Sec 25 Twp 103 Rge 4w  
 Operator Central Southwest Co Well Name PA 501 - L.A. Arthur Well No 12  
 Total Depth 11,225 Condition of Well P.F.A.

**RECEIVED**

JAN 28 1992

LAFAYETTE DISTRICT OFFICE  
OF CONSERVATION

CHECK APPROPRIATE BOX:

- 29 DRY HOLE
- 30 FORMERLY PRODUCTIVE WELL

	CASING SIZE	AMOUNT PULLED	CEMENT PLUGS			
			FROM	TO	SACKS	HOW PLACED
301	<u>2 7/8 16g</u>	<u>10,300</u>	<u>10,400</u>	<u>10,295</u>	<u>25.5XS</u>	<u>pumped by SWAP</u>
302	<u>2"</u>	<u>3030</u>	<u>3130</u>	<u>2930</u>	<u>20.5XS</u>	<u>pumped by SWAP</u>
303	<u>1 7/8</u>	<u>0</u>	<u>54</u>	<u>4</u>	<u>30.5XS</u>	<u>pumped by SWAP</u>
304						

Mud Record: Weight 9.1 Viscosity 36

Remarks Put 1 5/8" casing 9' below ground level & welded 1/2" steel plate on seam JAN 21, 1992

This work was done according to the Rules and Regulations of the Office of Conservation

WITNESS \_\_\_\_\_ OPERATOR Central Southwest Company

(Signed) \_\_\_\_\_ REPRESENTATIVE  
Willie Stearns (SWAP Rep)