

R5W

R 4 W

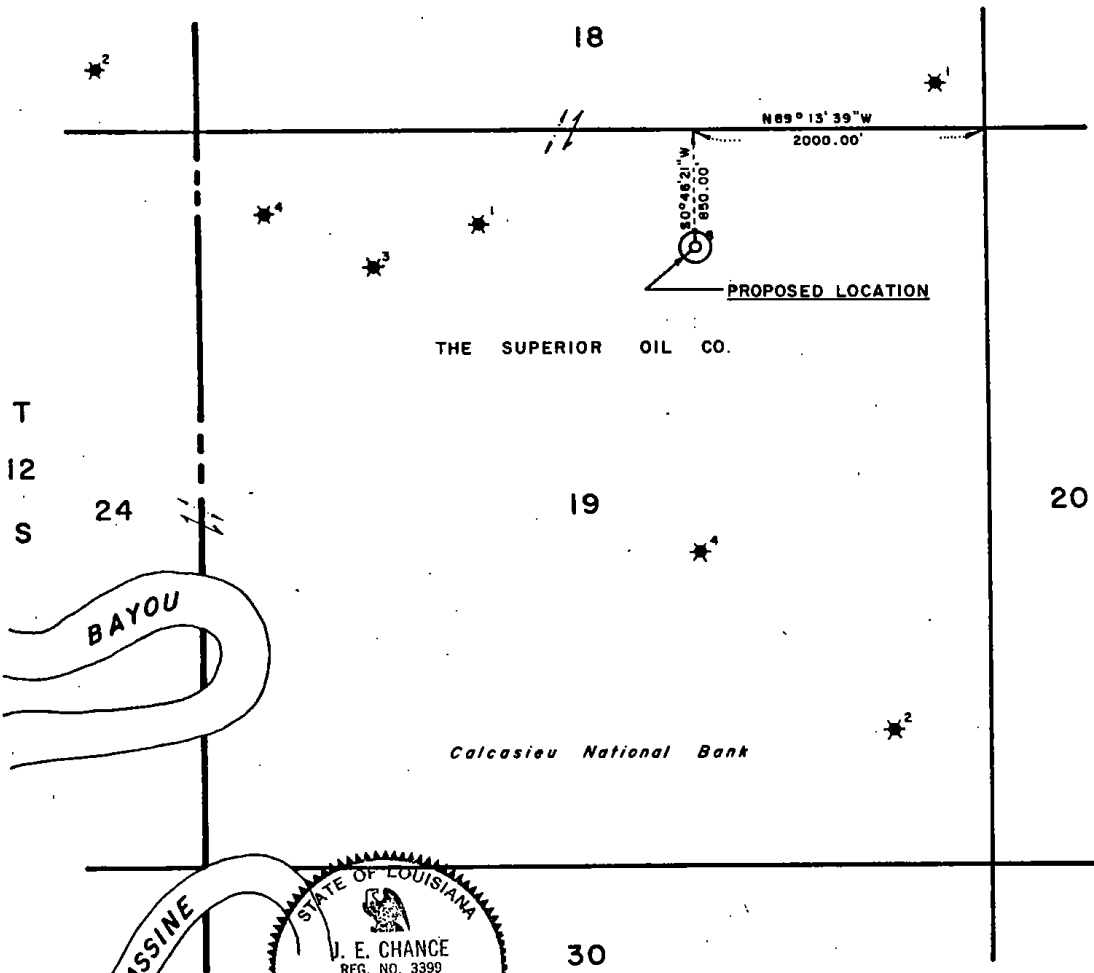

T
12
S

BAYOU

LACASSINE

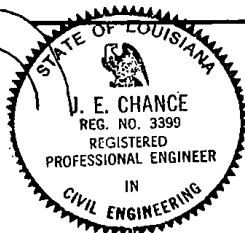

I, John E. Chance, hereby certify that the location of
 The Superior Oil Co.'s *Calcasieu National Bank Well*
No. 8 is as follows: N89°13'39"W 2000.00' and
 S0°46'21"W 850.00' from the Northeast corner of
 Section 19, T12S-R4W, Cameron Parish, Louisiana.

John E. Chance
 REGISTERED CIVIL ENGINEER NO. 3399
 STATE OF LOUISIANA
 JOHN E. CHANCE & ASSOCIATES, INC.

#109860
LOUISIANA DEPT. OF CONSERVATION

THE SUPERIOR OIL CO.

PERMIT PLAT
CAMERON PARISH, LOUISIANA

SCALE: 1" = 1000'

APRIL 8, 1965

State of Louisiana
DEPARTMENT OF CONSERVATION
Inter Office

Date: 5/28/65

To: Baton Rouge Office
From: Lake Charles District
Att'n: Fritz Spencer

Enclosed herewith please find application from The Superior Oil Company
for permit to dual w/alternate their

Calcasieu Nat'l. Bank #8-D Zone: 6400, 9200 & 9500'
Lakeside Field, Cameron Parish.

Also enclosed please find:

Check No. 11901 in the amount of \$125.00

Well Location Plat xxx

Well Location Certification xxx

Form A. D. C. xxx

Electric Log * xxx

Schematic Diagram xxx

Applicable Department of Conservation Order No. 29-B, E, C Pending Hearing
Docket No.

Remarks & Recommendations:

Recommend approval. Routine insofar as dual is concerned. In connection with the alternate zone, the operator has stated in telephone conversation that the productive limits are confined to the Calcasieu Nat'l Bank lease and complies in all other respects with the method for handling selective completions onshore.

Yours very truly,

By: District Manager
W. C. WILHITE

cc: Geological Survey *

WCH:jt
ET-1

NOTICE TO THE PUBLIC

1997

Notice

Department of Health

Department of Health

Department of Health

Notice

Department of Health

Notice

Department of Health

Department of Health

Department of Health

Department of Health

DEPARTMENT OF CONSERVATION
STATE OF LOUISIANA

WELL COMPLETION OR RECOMPLETION REPORT

109860
Pending

LAKE CHARLES, LA. DISTRICT Re: Well Serial No.: Pending
Completed Flowing Operator: THE SUPERIOR OIL CO.
Recompleted Gas-Lifting Well Name: CALCASIEU NAT'L. BANK
Oil Pumping Well No.: 8-D, Sec. 19, Twp. 12-S, Rge. 4-W
Gas Shut-In Field LAKESIDE
Parish CAMERON

Date Completed or Recompleted 6/2/65 at 4:00 (a.m.) (~~p.m.~~)

COMPLETION DATA

Initial Production 24.44 BOPD Gas Volume 1514 MCF/Day
Tubing Pressure 2475 psig Casing Pressure ---- psig
Choke Size 12/64" Positive Adjustable B.S. & W. 431 %
Gas/Oil Ratio 61948:1 CF/Bbl. Gravity 53.9 at 60° A. P. I.
Producing Depth: From 6388 Ft. to 6392 Ft. T. D. 10400 Ft.
Name of Producing Sand: 6400' SAND

*New Pool *Old Pool List Reason(s) for Pool Classification _____

*As Defined in Statewide Order No. 29-H.

Additional clearance is requested for _____ barrels of oil produced on drill stem or other production tests (See Section X, Paragraph B of Order No. 29-B on reverse side).

Three (3) copies to be filed with the District Office within three (3) days of date of completion or recompletion (as per Order 29-B, Section X, Paragraph A, Article 1).

I hereby certify that the above information is true and correct to the best of my knowledge.

DISTRICT MANAGER ONLY

29-E Compliance - Yes ___ No ___
29-E Unit Attached - Yes ___ No ___

DATE: _____

DML: ls

Form - Comp. *SIGN*

THE SUPERIOR OIL CO.
COMPANY

Jm Landry
COMPANY REPRESENTATIVE

GEOLOGIST
TITLE

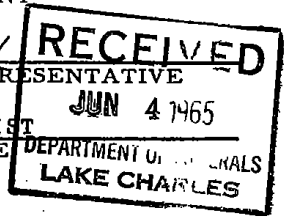

1

weew



DEPARTMENT OF CONSERVATION
WELL HISTORY AND WORK RESUME REPORT

FIELD: **LAKESIDE**
SERIAL NO.: **(PENDING)**
PRODUCING INTERVAL: **6388-92**
RESERVOIR (COMPANY SAND IDENTIFICATION): **6400' SAND**

Three typewritten copies of this report must be filed with the District Office of the Department of Conservation in which the well is located within twenty (20) days of the date of completion or recompletion. NOTE: If not properly completed and signed, this report will be returned.

LEASE AND WELL DATA

DESIGNATE TYPE OF COMPLETION: NEW WELL RECOMPLETION SAME RESERVOIR DIFFERENT RESERVOIR OIL GAS P&A

OPERATOR: **THE SUPERIOR OIL CO.** ADDRESS: **P.O. BOX 51108, O.C.S., LAFAYETTE, LA.**

LEASE NAME: **CALCASIEU NAT'L. BANK** WELL NO.: **8-D**

PARISH: **Cameron** SEC. **19** TWP. **12-S** RGE. **4-W** DATE PERMIT ISSUED: **4/13/65**

DATE SPUDDED: **5/1/65** TOTAL DEPTH: **10400** PBTD: **9512**

GROUND ELEVATION: **+3 MLG** CASING HEAD FLANGE ELEVATION: **-----** DISTANCE FROM RKB TO CHF: **22.40**

DATE WELL TURNED INTO TANKS: **----** SINGLE, DUAL OR TRIPLE COMPLETION? **Dual w/Alt.** NOTE: IF THIS IS A MULTIPLE COMPLETION, FURNISH A SEPARATE REPORT FOR EACH COMPLETION

WAS WELL DIRECTIONALLY DRILLED? **No** WAS DIRECTIONAL SURVEY MADE? **No** WERE 3 COPIES FILED WITH THE DEPARTMENT OF CONSERVATION? **-----** DATE FILED: **-----**

TYPE OF ELECTRICAL OR OTHER LOGS RUN (CIRCLE LOGS FILED WITH DEPT. OF CONSERVATION): **(ES)** DATE FILED: **6/2/65**

CASING, LINER AND TUBING RECORD

CASING SIZE	HOLE SIZE	CASING WEIGHT	DEPTH SET	SACKS CEMENT	TEST PRESSURE	HRS. UNDER PRESSURE	DATE TESTED	NAME OF TEST WITNESS - STATE IF DEPT. AGENT OR OFFSET OPR.
TUBING SIZE: 2-3/8"		DEPTH OF TUBING: 6323		DEPTH OF PACKER (S): 9460, 9205, & 6323				

INITIAL COMPLETION OR RE-COMPLETION DATA

INITIAL PRODUCTION: **24.44** BOPD GAS VOLUME: **1514** MCF/DAY CHOKE SIZE: **12/64"** WELL STATUS: **C.I.**

TUBING PRESSURE: **2475** psig CASING PRESSURE: **-----** psig GOR: **61,948:1** BS & W: **4.31** % BHP - (SHUT-IN): **2920** psi

GRAVITY: **53.9** °API @ 60°F CONSERVATION AGENT MAKING GAUGE: **-----** COMPANY REPRESENTATIVE: **J. B. HARRIST** DATE GAUGED: **5/25/65**

PLUG AND ABANDON (P&A) DATA

CASING SIZE	AMOUNT PULLED	CEMENT PLUGS				DATE WORK PERFORMED	NAME OF TEST WITNESS - STATE IF DEPT. AGENT OR OFFSET OPR.
		FROM	TO	SACKS	HOW PLACED		

CERTIFICATE: I, the undersigned, state: That I am employed by **THE SUPERIOR OIL CO.** and that I am authorized to make this report, and that this report was prepared under my supervision and direction and that all facts stated herein are true, correct and complete to the best of my knowledge.

Form #H Signature: *J. B. Harrist* Title: **GEOLOGIST**

RECEIVED
JUN 4 1965
DEPARTMENT OF MINERALS
LAKE CHARLES

POTENTIAL REPORT

Type Well: Oil _____ Gas Distillate _____

Type Test: Comp. Recomp. _____ Retest. _____ Regauge _____

Parish Cameron Field Lake Side

Company The Superior Oil Co. Serial No. 109860

Well Name & No. Calcasieu Bank #8-D

Location: Sec. 19 Twp. 12S Rge. 4W Flowing Pump _____

Prod. Horizon _____ Perf. Int. 6379 to 6383

Casing Setting: Size 7 @ 10400

Tubing Setting: Size 2 @ 6324 T.D. 9512

Date ^{online} Completed 7-9-65 Date Gauged 7-12-65

Acidize with _____ gals. Elev. of Derr. Floor. _____

--- TEST DATE ---

T. P. 2450 C. P. 100 Choke Size 16 /64th

Closing ^{Meter} 2.06 ft. in. @ 4 PM Time

Opening ^{Meter} 0.12 ft. in. @ 2 PM Time

Diff. 1.94 ft. in. 2 Hours (Time)

Tank No. Meter Tank Coef. Meter - 8431

Bbls. per 2 Hrs. 1.64 Est. Bbls. per Day 19.68

Daily Gas Vol. 1527 M.C.F. G/O Ratio 7789/1

B.S.&W. 1 % Corrected Gravity 55.3 Deg. A.P.I.

Witnessed W. P. Slagter Title Well Tester

Gauged by Walter Schmidt Title Oil/Gas Ins.
Department of Conservation

District Office Lake Charles

Remarks: 3" x 1 1/2 o.p. - 2000# x 100"

St. 7.5 x Diff. 2.95 Flg. Taps

L-10 chart 2300# B.P. Held on

well.

MINERALS DIVISION
DEPARTMENT OF CONSERVATION
STATE OF LOUISIANA

Sq. & Perf.
L. C. #55

WORK PERMIT

PERMIT TO Sq. & Perf. DATE June 3, 1968
PARISH Cameron FIELD Lakeview
COMPANY Superior Oil Co.
ADDRESS P. O. Box 5108 OCS, Lafayette, La. 70501
WELL NAME 6400 SU A; Walker A No. 8-D SEC. 19 T. 12SR 4W
WELL PERMIT SERIAL No. 109860 WORK PERMIT No. _____
LOCATION _____

YOU ARE HEREBY AUTHORIZED TO Sq. perms. 6383-92 with mud acid
& cut. perf. 6370-6386 & test.

PERMIT REQUESTED BY D. H. LANDRY T 10400'
Company Representative

AUTHORIZED BY [Signature]
WILLIAM C. WILLIAMS
Minerals Division, La.

Sq. & Perf.
L.C. #61

MINERALS DIVISION
DEPARTMENT OF CONSERVATION
STATE OF LOUISIANA

WORK PERMIT

PERMIT TO Squeeze & Perforate DATE 6-13-68
PARISH Cameron FIELD Lakeside
COMPANY The Superior Oil Company
ADDRESS P. O. Box 51108 OCS, Lafayette, La., 70501
WELL NAME 6400 SUA; Walker "A" No. 8-D SEC. 19 T. 12S R. 4W
WELL PERMIT SERIAL No. 109860 WORK PERMIT No. _____
LOCATION _____

YOU ARE HEREBY AUTHORIZED TO Sq. perms. 6370-76 with cmt. and
reperforate 6370-76 & test.

_____ TD 10400'
PERMIT REQUESTED BY S. M. Landry
Company Representative

AUTHORIZED BY William C. White
Jake C. ...
District Office

W.M.:fhs
D.P. Hall

Sq. & Perf.
L/C #64

MINERALS DIVISION
DEPARTMENT OF CONSERVATION
STATE OF LOUISIANA

WORK PERMIT

PERMIT TO Squeeze & perforate DATE 6-16-68
PARISH Cameron FIELD Lakedide
COMPANY The Superior Oil Company
ADDRESS P. O. Box 51108 OCS, Lafayette, La., 70501
WELL NAME 6400 SU A; Walker "A" No. 8-D SEC 19 T. 125 R. 4W
WELL PERMIT SERIAL No. 109860 WORK PERMIT No. _____
LOCATION _____

YOU ARE HEREBY AUTHORIZED TO Sq. perms. 6370-76 with cement & mud acid and perforate 6389-92 & test.

PERMIT REQUESTED BY S. M. Landry TD 104001
Company Representative

AUTHORIZED BY W. L. Wilhite
W. L. Wilhite
Lafayette, La.

F. d. A
L.C. 1147

MINERALS DIVISION
DEPARTMENT OF CONSERVATION
STATE OF LOUISIANA

WORK PERMIT

PERMIT TO Plug & ABN DATE 6/20/68
PARISH Cameron FIELD Lakeside
COMPANY The Superior Oil Company
ADDRESS P.O. Box 51103 CCS, Lafayette, La 70501
WELL NAME 6400 SU A; Walker "A" NO 8-D SEC 19 T 12S R AW
WELL PERMIT SERIAL No 109860 WORK PERMIT No _____
LOCATION _____

YOU ARE HEREBY AUTHORIZED TO Sq. perms. 6389-92 with cnt. & ABN.
Well No. 8-D

PERMIT REQUESTED BY D. M. Landry TD 10400'

Company Representative
AUTHORIZED BY William G. Wilhite
William G. Wilhite
Lake Charles, La.
District Office

Form D-10-1-68

DEPARTMENT OF CONSERVATION
STATE OF LOUISIANA

PLUG AND ABANDON REPORT

DATE WORK DONE June 20, 1968

WELL SERIAL NO. 109860
WORK PERMIT NO. Pending

Lake Charles DISTRICT
(Three Copies to be Filed with the District Office)

NOTE: This Report Will be Returned if Not Properly Completed And Signed.

Field Lakeside Parish Cameron Sec. 19 Twp. 12S Rgc. 4W
Company The Superior Oil Co. Lease 6400 SU A; Walker "A" Well No. 8-D
Total Depth 10400 Condition of Well P & A

- | | | | |
|----------------------|--------------------|--------------------|------------------------|
| 1. Surface Casing | Size <u>10-3/4</u> | Depth <u>1800</u> | Amount Pulled <u>-</u> |
| 2. Protection Casing | Size <u>7"</u> | Depth <u>10400</u> | Amount Pulled <u>-</u> |
| 3. Production Casing | Size _____ | Depth _____ | Amount Pulled _____ |

CEMENT PLUGS

- | | | | |
|----------------------|----------------|-------------------------|----------------------------|
| 1. Depth <u>6146</u> | To <u>6400</u> | No. of Sacks <u>300</u> | How Placed <u>Squeezed</u> |
| 2. Depth _____ | To _____ | No. of Sacks _____ | How Placed _____ |
| 3. Depth _____ | To _____ | No. of Sacks _____ | How Placed _____ |

Mud Record: Weight _____ Viscosity _____

Remarks: Squeezed perms. 6389-92 with cmt. & ARN well No. 8-"D"

This work was done according to the Rules and Regulations of the Department of Conservation.

WITNESS

The Superior Oil Company
COMPANY

(Signed)

Jay Smoter DEPT. CONSERVATION
JUN 27 1968
REPRESENTATIVE

LAKE CHARLES

Form - P & A



DEPARTMENT OF CONSERVATION
WELL HISTORY AND WORK RESUME REPORT

FIELD: **Lakeside**

SERIAL NO.: **109860**

PRODUCING INTERVAL:

RESERVOIR (COMPANY SAND IDENTIFICATION): **P & A**

Three typewritten copies of this report must be filed with the District Office of the Department of Conservation in which the well is located within twenty (20) days of the date of completion: NOTE: If not properly completed and signed this report will be returned.

LEASE AND WELL DATA

DESIGNATE TYPE OF COMPLETION: NEW WELL RECOMPLETION SAME RESERVOIR DIFFERENT RESERVOIR OIL GAS P&A

OPERATOR: **The Superior Oil Company** ADDRESS: **P.O. Box 51108 CCS, Lafayette, Louisiana**

LEASE NAME: **6400 SU A; Walker "A"** WELL NO.: **8-D**

PARISH: Cameron	SEC: 19 TWP. 12S RGE. 4W	DATE PERMIT ISSUED: 6-22-65
DATE SPUDDED: 6-2-68	DATE READY TO PRODUCE:	TOTAL DEPTH: 10400
DATE SPUDDED: 6-2-68	DATE READY TO PRODUCE:	FBTD: 9512
GROUND ELEVATION: + 3 MLG	CASING HEAD FLANGE ELEVATION: -	DISTANCE FROM RKB TO CHF: -
DATE WELL TURNED INTO TANKS: P & A 6-20-68	SINGLE, DUAL OR TRIPLE COMPLETION?: P & A	NOTE: IF THIS IS A MULTIPLE COMPLETION, FURNISH A SEPARATE REPORT FOR EACH COMPLETION
WAS WELL DIRECTIONALLY DRILLED?: NO	WAS DIRECTIONAL SURVEY MADE?: NO	WERE 3 COPIES FILED WITH THE DEPARTMENT OF CONSERVATION?: -
TYPE OF ELECTRICAL OR OTHER LOGS RUN (CIRCLE LOGS FILED WITH DEPT. OF CONSERVATION): (ES)		DATE FILED: 6-2-65

CASING, LINER AND TUBING RECORD

CASING SIZE	HOLE SIZE	CASING WEIGHT	DEPTH SET	SACKS CEMENT	TEST PRESSURE	HOURS UNDER PRESSURE	DATE TESTED	NAME OF TEST WITNESS-STATE IF DEPT. AGENT OR OFFSET OPERATOR

TUBING SIZE: DEPTH OF TUBING: DEPTH OF PACKER(S):

INITIAL COMPLETION OR RE-COMPLETION DATA

INITIAL PRODUCTION	GAS VOLUME	CHOKE SIZE	WELL STATUS
BOPD	MCF/DAY		P & A 6-20-68
TUBING PRESSURE	CASING PRESSURE	GOR	BS & W
psig	psig		%
GRAVITY	CONSERVATION AGENT MAKING GAUGE	COMPANY REPRESENTATIVE	DATE GAUGED
*API 90°F			

PLUG AND ABANDON (P&A) DATA

CASING SIZE	AMOUNT PULLED	CEMENT PLUGS				DATE WORK PERFORMED	NAME OF TEST WITNESS-STATE IF DEPT. AGENT OR OFFSET OPERATOR
		FROM	TO	SACKS	HOW PLACED		
		6146	6400	300	Squeezed	6-20-68	

CERTIFICATE: I, the undersigned, state: That I am employed by **The Superior Oil Co.** and that I am authorized to make this report, and that this report was prepared under my supervision and direction and that all facts stated herein are true, correct and complete to the best of my knowledge.

Form WH Signature: *Jay Moter* Title: **Geologist**

* Date well is equipped to produce, but due to no available market, no pipe line connection, etc.; the well has been shut-in.

JUN 27 1968

LAKE CHARLES

WORK RESUME

List below all work performed under Department of Conservation Work Permits while drilling and completing well.

WORK PERMIT NO.	DATE WORK PERFORMED	SERVICE COMPANY	DESCRIPTION OF WORK
Sq. & Perf. LC # 55	6-11-68	Halliburton & Perf. Guns	Sq. perfs. 6388-92 with 500 gals. mud acid & 300 sx cmt. BP 900 FP 4000 # & perforate 6370-76 (EL) 6360-66 (GR) & test No. 6400 Sd.
Sq. & Perf. LC #61	6-12-68	Halliburton	Sq. perfs. 6370-76 (ELM) with 400 sx. BP 1000# FP 4000# & reperf. 6370-76 (ELM) & test.
Sq. & perf. LC # 64	6-16-68	Halliburton	Sq. perfs. 6370-76 with 200 sx. cmt. BP 500# FP 4500# & perf. 6389-92 (ELM) 6379-82 (GRM)
Sq. & ABN LC # Pending	6-20-68	Halliburton	Sq. perfs. 6389-92 with 300 sx. cmt. BP 400 FP 4500 # & ABN. 6400 SU A; Walker "A" No. 8-"D" Well.

List below all important Paleofaunal or Geological Formation tops, Cap Rock and Salt tops and Salt Overhang bottoms.

FORMATION	DEPTH	FORMATION	DEPTH

DEPT. CONSERVATION

JUN 27 1968

LAKE CHARLES