

WELL LOCATION
WATSON OIL CORP.
No. 1 Dr. M. O. Miller

From the Corner common to Sections
 20, 21, 28 and 29, T. 15 S., R. 5 W. go
 North 500.0 ft. to the Location.
 Ground Elev. 1.5

We hereby certify that we staked the
 above Well Location as shown November
 26, 1974. F. Shutts' Sons-Civil Engineers.

Fred N. Shutts
 FRED N. SHUTTS, C.E., LA. REG. NO. 79

WATSON OIL CORP.
WELL LOCATION
ON EAST LINE OF SECTION 20
T. 15 S., R. 5 W
CAMERON PARISH, LA.

SCALE: 1" = 1000' DECEMBER 4, 1974

F. Shutts' Sons
 Civil Engineers
 Lake Charles, La.

RECEIVED

DEC 17 1974

DEPT. OF CONSERVATION
PERMIT SECTION
BATON ROUGE, LA.

DEPT. CONSERVATION

DEC 12 1974

LAKE CHARLES

State of Louisiana
DEPARTMENT OF CONSERVATION

Inter Office

Date: 12/13/74

To: Baton Rouge Office

From: Lake Charles District

Att'n: Joseph F. DeVall

Enclosed herewith please find application from Watson Oil Corporation

for permit to drill their _____

Dr. M. O. Miller Well No. 1

Zone: _____

Crab Lake

Field, _____

Cameron

Parish .

Also enclosed please find:

Check No. 1719 in the amount of \$100.00

Well Location Plat XXX

Well Location Certification XXX

Form A. D. C. _____

Electric Log _____

Schematic Diagram _____

Applicable Department of Conservation Order No. 29-B & E/ 865 series Pending Hearing
Docket No. _____

Remarks & Recommendations:

Recommend approval specifying compliance with the amended directional drilling provisions of order 29-B. This location is approximately 500' from the boundary of the unit created by order 865 which order specifies development in accordance with order 29-E.

Yours very truly,

By: W^m C. Wilhite
District Manager
W. C. WILHITE

cc: Geological Survey

LT-1

STATE OF LOUISIANA
DEPARTMENT OF CONSERVATION

RECEIVED

DEC 17 1974

DEPT. OF CONSERVATION
PERMIT SECTION
BATON ROUGE, LA.

WELL FILE COPY
PERMIT TO DRILL FOR MINERALS

PERMIT\$100.00
Multiple Zone Processing

ATT
Send To LAKE CHARLES/17 Date DECEMBER 17, 1974
Serial No. Ser. #147552 AAPI #1702320886
Parish CAMERON Field CRAB LAKE

Operator WATSON OIL CORPORATION
Address P.O. BOX 4128
City & State SHREVEPORT, LOUISIANA 71104
Well Name DR. M. O. MILLER NO. 1
Location SEC 20, T15S, R5W
FROM CORNER COMMON TO SECTION 20, 21, 28, AND 29, T15S-R5W, GO
N 500' TO THE LOCATION.

Zone or Reservoir of Proposed Completion P. T. D. 13,000'
Applicable Department of Conservation Order MIOCENE
29S, 29E, 865 SERIES

COMMISSIONER

ISSUING AUTHORITY

131555

State of Louisiana



R. T. SUTTON
COMMISSIONER

DEPARTMENT OF CONSERVATION
P. O. BOX 44275 - CAPITOL STATION
BATON ROUGE, LA 70804

December 18, 1974

RE: **Cameron Parish
Crab Lake Field
Dr. M. O. Miller #1
Serial #147552**

**Watson Oil Corporation
P. O. Box 4128
Shreveport, LA 71104**

Gentlemen:

We are issuing Permit to Drill for the above referenced well with the understanding that completion cannot be in any pool in which the location does not conform with the provisions of Statewide Order No. 29-E. In the event the well is a producer no allowable will be assigned until a suitable unit has been formed in compliance with the provisions of Statewide Order No. 29-E.

In addition, the permit to drill is issued with the understanding that you will furnish the appropriate District Manager with Inclination and/or Directional Survey data as proof that the well will be completed in compliance with the provisions of Statewide Order No. 29-B, Section XVIII, dated March 1, 1967, before an allowable will be assigned said well.

Very truly yours,

R. T. SUTTON, COMMISSIONER
DEPARTMENT OF CONSERVATION

BY _____
J. W. Hecker
~~Assistant~~ Chief Engineer

cc: **Wm. C. Wilhite**
District Manager
Lake Charles

JFD/sdb
29-E, 29-E-U & 29-B



DEPARTMENT OF CONSERVATION

WELL HISTORY AND WORK RESUME REPORT

FIELD **Crab Lake**

SERIAL NO. **147552**

PRODUCING INTERVAL **12,421-12,450';12,471-12,490';
12,498-12,540';12,556-12,564'**

RESERVOIR (COMPANY SAND IDENTIFICATION)
Robulus

Three typewritten copies of this report must be filed with the District Office of the Department of Conservation in which the well is located within twenty (20) days of the date of completion: NOTE: If not properly completed and signed this report will be returned.

LEASE AND WELL DATA

DESIGNATE TYPE OF COMPLETION: NEW WELL RECOMPLETION SAME RESERVOIR DIFFERENT RESERVOIR OIL GAS P&A

OPERATOR **Watson Oil Corporation** ADDRESS **P. O. Box 4128 Shreveport, La. 71104**

LEASE NAME **Dr. M. O. Miller** WELL NO. **1**

PARISH **Cameron** SEC. **20** TWP. **15S** RGE. **5W** DATE PERMIT ISSUED **12-18-74**

DATE SPUDDED **2-10-75** DATE READY TO PRODUCE* **4-18-75** TOTAL DEPTH **12,685** PBTD. **12,650**

GROUND ELEVATION **1.5** CASING HEAD FLANGE ELEVATION **2.0** DISTANCE FROM RKB TO CHF **26.0**

DATE WELL TURNED INTO TANKS **WOPL** SINGLE, DUAL OR TRIPLE COMPLETION? **Single** NOTE: IF THIS IS A MULTIPLE COMPLETION, FURNISH A SEPARATE REPORT FOR EACH COMPLETION

WAS WELL DIRECTIONALLY DRILLED? **No** WAS DIRECTIONAL SURVEY MADE? **Totco's** WERE 3 COPIES FILED WITH THE DEPARTMENT OF CONSERVATION? **Form AD** DATE FILED **4-22-75**

TYPE OF ELECTRICAL OR OTHER LOGS RUN (CIRCLE LOGS FILED WITH DEPT. OF CONSERVATION) **ISE/Sonic Dipmeter; CBL** DATE FILED **4-22-75**

CASING, LINER AND TUBING RECORD

CASING SIZE	HOLE SIZE	CASING WEIGHT	DEPTH SET	SACKS CEMENT	TEST PRESSURE	HOURS UNDER PRESSURE	DATE TESTED	NAME OF TEST WITNESS-STATE (IF DEPT. AGENT OR OFFSET OPERATOR)
16"	Driven		147'					
10-3/4"	15"	40.5	2690'	1860	1000	1/2	2-13-75	
7"	9-7/8"	26	12,685'	1400	1500	1/2	4-6-75	

TUBING SIZE: **3 1/2"** DEPTH OF TUBING: **12,230'** DEPTH OF PACKERIS: **12,230'**

INITIAL COMPLETION OR RE-COMPLETION DATA

INITIAL PRODUCTION **Trace** GAS VOLUME **23,099** MCF/DAY CHOKER SIZE **27/64"** WELL STATUS **Flowing**

TUBING PRESSURE **4530** psig CASING PRESSURE **pkp** psig GOR **23,000,000:1** SS & W **0** % **XXX** (SHUT-IN) **4900** psi

GRAVITY **44.1** *API 60°F CONSERVATION AGENT MAKING GAUGE COMPANY REPRESENTATIVE **Pelt** DATE GAUGED **4-18-75**

PLUG AND ABANDON (P&A) DATA

CASING SIZE	AMOUNT PULLED	CEMENT PLUGS				DATE WORK PERFORMED	NAME OF TEST WITNESS-STATE (IF DEPT. AGENT OR OFFSET OPERATOR)
		FROM	TO	SACKS	HOW PLACED		

CERTIFICATE: I, the undersigned, state: That I am employed by **Watson Oil Corp.** and that I am authorized to make this report, and that this report was prepared under my supervision and direction and that all facts stated herein are true, correct and complete to the best of my knowledge.

Form WH Signature: **R. C. Leunham** Title: **Petroleum Engineer**

* Date well is equipped to produce, but due to no available market, no pipe line connection, etc., the well has been shut-in.

WORK RESUME

List below all work performed under Department of Conservation Work Permits while drilling and completing well.

WORK PERMIT NO.	DATE WORK PERFORMED	SERVICE COMPANY	DESCRIPTION OF WORK
316-75	4-16&17-75	Schlumberger	Perforating

List below all important Paleofaunal or Geological Formation tops, Cap Rock and Salt tops and Salt Overhang bottoms.

FORMATION	DEPTH	FORMATION	DEPTH
		<p>RECEIVED</p> <p>APR 25 1975</p> <p>DEPT. OF CONSERVATION PERMIT SECTION BATON ROUGE, LA.</p> <p>DEPT. CONSERVATION</p>	

APR 24 1975

LAKE CHARLES



OFFICE OF CONSERVATION
WELL HISTORY AND WORK RESUME REPORT

FIELD	Crab Lake ✓
SERIAL NO.	147552 ✓
PRODUCING INTERVAL	9908-9913'
RESERVOIR (COMPANY SAND IDENTIFICATION)	9900' Sand

Three typewritten copies of this report must be filed with the District Office of the Office of Conservation in which the well is located within twenty (20) days of the date of completion. NOTE: If not properly completed and signed this report will be returned.

LEASE AND WELL DATA

CHECK APPROPRIATE BOXES	<input type="checkbox"/> 31 INACTIVE DRY HOLE FUT. UTIL. <input type="checkbox"/> 32 INACTIVE DRY HOLE NO FUT. UTIL. <input type="checkbox"/> 35 INACTIVE WAITING ON PIPELINE <input type="checkbox"/> 37 INACTIVE WAITING ON MARKET	PRODUCT	<input type="checkbox"/> OIL <input checked="" type="checkbox"/> GAS <input type="checkbox"/> OTHER	IF RECOMPLETION	<input checked="" type="checkbox"/> SAME RESERVOIR <input type="checkbox"/> DIFFERENT RESERVOIR	DATE COMP. RECOMP. OR P & A M D Y
<input type="checkbox"/> NEW WELL <input checked="" type="checkbox"/> RECOMPLETION <input type="checkbox"/> P & A						

OPERATOR	CODE	ADDRESS
Watson Oil Corporation	6279	4801 Woodway, Suite 480 West, Houston, TX 77056
WELL NAME	WELL NO.	
Dr. M. O. Miller	1	

PARISH	SEC.	TWP.	RGE.	DATE PERMIT ISSUED
Cameron	20	15S	5W	12-18-74
DATE SPUNDED M D Y	DATE READY TO PRODUCE*	TOTAL DEPTH	PSD.	
2-10-75	4-18-75	12,685'	12,650'	
GROUND ELEVATION	CASING HEAD FLANGE ELEVATION	DISTANCE FROM RKB TO CHF		
1.5'	2.0'	26.0		
DATE WELL TURNED INTO TANKS	SINGLE, DUAL OR TRIPLE COMPLETION?	NOTE: IF THIS IS A MULTIPLE COMPLETION, FURNISH A SEPARATE REPORT FOR EACH COMPLETION		
10-8-76	Single			
WAS WELL DIRECTIONALLY DRILLED?	WAS DIRECTIONAL SURVEY MADE?	WERE 3 COPIES FILED WITH THE OFFICE OF CONSERVATION?	DATE FILED	
No	Totco's	Form AD	4-22-75	
TYPE OF ELECTRICAL OR OTHER LOGS RUN (CIRCLE LOGS FILED WITH OFFICE OF CONSERVATION)			DATE FILED	
ISF Sonic; Dipmeter; CBL			4-22-75	

CASING, LINE² AND TUBING RECORD

NO.	CASING SIZE	HOLE SIZE	CASING WEIGHT	DEPTH SET		SACKS CEMENT	TEST PRESSURE	HOURS UNDER PRESSURE	DATE TESTED (MM DD YY)	NAME OF TEST WITNESS - STATE IF CONSERVATION AGENT OR OFFSET OPERATOR	
				FROM	TO						
101	16"	Driven			147'						
102	10-3/4"	15"	40.5#		2,690'	1860	1000	1/2	2-13-75		
103	7"	9-7/8"	26#		12,685'	1400	1500	1/2	4-06-75		
104											
105											
TUBING SIZE		2-7/8"		DEPTH OF TUBING		9855'		DEPTH OF PACKER(S)		9855'	

INITIAL COMPLETION OR RE-COMPLETION DATA

INITIAL PRODUCTION	DAS VOLUME	GOR	CHOKE SIZE	PRODUCING METHOD
46 BOPD	2,200 MCF/DAY	47826 CF/BSL	11 /64"	Flowing
FLOWING TUBING PRESSURE	SHUT-IN TUBING PRESSURE	CASING PRESSURE	WATER PRODUCTION	BS&W
3450 psig	3525 psig	800	1 BPD	.1 %
GRAVITY	BHP (SHUT-IN)	COMPANY REPRESENTATIVE	DATE GAUGED	
50.3 °API @ 60° F	4623 Calc. psig	Melvin Theriot	10-24-78	

PLUG AND ABANDON (P & A) DATA

CASING SIZE	AMOUNT PULLED	CEMENT PLUGS				DATE WORK PERFORMED	NAME OF TEST WITNESS - STATE IF CONSERVATION AGENT OR OFFSET OPERATOR
		FROM	TO	SACKS	HOW PLACED		

CERTIFICATE: I, the undersigned, state: That I am employed by Watson Oil Corp. and that I am authorized to make this report, and that this report was prepared under my supervision and direction and that all facts stated herein are true, correct and complete to the best of my knowledge.

Signature: Alley R. Theriot Title: Sr. Petroleum Engr.

*Data well is equipped to produce, but due to no available market, no pipe line connection, etc., the well has been shut-in.

WORK RESUME

List below all work performed under Office of Conservation Work Permits while drilling and completing well.

WORK PERMIT NO.	DATE WORK PERFORMED	SERVICE COMPANY	DESCRIPTION OF WORK
866-78	9-13-78	Western	Squeezed perms. 12,470-479'. Cleaned out to 12,535' tested to 2000#.
	9-17-78	Go Wireline	Set Guiberson Type B Bridge Plug @ 12,470'. Set Baker Model R pkr @ 12,318'. Perf. 12,500-12,512'.
	9-18-78	Go Wireline	Set Otis N nipple in plug @ 12,456'. Swabbed to 4000'.
	9-20-78	"	Perf. 12,420-428'. Swabbed water.
982-78	10-12-78	"	Set CIBP @ 10,000'. Set pkr @ 9855'.
	10-13-78	"	Perf. 9908-9913'.

List below all important Paleofaunal or Geological Formation tops, Cap Rock and Salt Overhang bottoms.

FORMATION	DEPTH	FORMATION	DEPTH

JUN 9 1978
 DEPT. OF CONSERVATION
 PERMIT DIVISION
 BATON ROUGE, LA.

CONSERVATION DEPT.
 OCT 30 1978
 LAKE CHARLES

CONSERVATION DEPT.
 NOV 3 1978
 LAKE CHARLES

DEPARTMENT OF CONSERVATION
STATE OF LOUISIANA



WELL COMPLETION OR RECOMPLETION REPORT

Lake Charles DISTRICT

Re: Well Serial No.: 147552

Completed	<input checked="" type="checkbox"/>	Flowing	<input checked="" type="checkbox"/>	Operator:	<u>Watson Oil Corporation</u>
Recompleted	<input type="checkbox"/>	Gas-Lifting	<input type="checkbox"/>	Well Name:	<u>Dr. M. O. Miller</u>
Oil	<input type="checkbox"/>	Pumping	<input type="checkbox"/>	Well No.:	<u>1</u> , Sec. <u>20</u> , Twp. <u>15S</u> , Rge. <u>5W</u>
Gas	<input checked="" type="checkbox"/>	Shut-In	<input type="checkbox"/>	Field	<u>Crab Lake</u>
				Parish	<u>Cameron</u>

Date Completed ~~Recompleted~~ April 18, 1975 at 6:30 (a.m.) (~~pm.~~)

COMPLETION DATA

Initial Production Trace BOPD Gas Volume 23,099 MCF/Day

Tubing Pressure 4530 psig Casing Pressure - psig

Choke Size 27/64 Positive Adjustable X B.S. & W. 0 %

Gas/Oil Ratio 23,000,000 CF/Bbl. Gravity 44.1 at 60° A. P. I.

Producing Depth: From 12,421 Ft. to 12,450 Ft. T. D. 12,685 Ft.

12,471 12,490

12,498 12,540

Name of Producing Sand: 12,556 Robulus 12,564

*New Pool *Old Pool List Reason(s) for Pool Classification First Robulus production on this structure

*As Defined in Statewide Order No. 29-H.

Additional clearance is requested for barrels of oil produced on drill stem or other production tests (See Section X, Paragraph B of Order No. 29-B on reverse side).

Three (3) copies to be filed with the District Office within three (3) days of date of completion or recompletion (as per Order 29-B, Section X, Paragraph A, Article 1).

I hereby certify that the above information is true and correct to the best of my knowledge.

DISTRICT MANAGER ONLY

29-E Compliance - Yes No Watson Oil Corporation
COMPANY

29-E Unit Attached - Yes No R. C. Turnham
R. C. Turnham
COMPANY REPRESENTATIVE

DATE: Petroleum Engineer
TITLE

DEPARTMENT OF CONSERVATION
STATE OF LOUISIANA

This side is to be used when requesting clearance for oil produced on Drill Stem Test or other Production Tests, made previous to official completion or recompletion.

SECTION X, PARAGRAPH B OF ORDER NO. 29-B

Allowables given to wells for oil produced on drill stem tests, production test and miscellaneous production of oil shall be in accordance with the following rule:

All operators are required within five days, to file three signed copies of the record of the daily production from the well, showing the number of hours the well produced and the interval of production --- as "from 8:00 A.M., August 5 to 3:00 P.M., August 8, 1952."

<u>Date of Test</u>	<u>TEST DATA</u>		<u>Amount of Oil Produced</u>
	<u>Time of Test</u>		
_____	_____ M. to _____	_____ M.	_____ Barrels
_____	_____ M. to _____	_____ M.	_____ Barrels
_____	_____ M. to _____	_____ M.	_____ Barrels
_____	_____ M. to _____	_____ M.	_____ Barrels
_____	_____ M. to _____	_____ M.	_____ Barrels
_____	_____ M. to _____	_____ M.	_____ Barrels
_____	_____ M. to _____	_____ M.	_____ Barrels
_____	_____ M. to _____	_____ M.	_____ Barrels
_____	_____ M. to _____	_____ M.	_____ Barrels
_____	_____ M. to _____	_____ M.	_____ Barrels
_____	_____ M. to _____	_____ M.	_____ Barrels
TOTAL			_____ BARRELS

The above total barrels of oil were produced from _____ Ft. to _____ Ft.

Remarks: _____

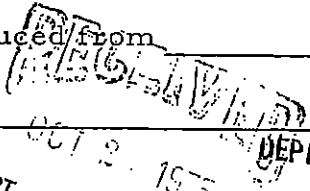
 DEPT. OF CONSERVATION
 PERMIT SECTION
 (Signed) _____
 APR 24 1975
 COMPANY REPRESENTATIVE
 LAKE CHARLES

From - Comp. _____
COMPANY

STATE OF LOUISIANA
DEPARTMENT OF CONSERVATION

FORM A D

REPORT OF PROOF OF APPARENT DEVIATION

SERIAL NO. 147552

OPERATOR Watson Oil Corporation DISTRICT Lake Charles

FIELD Crab Lake PARISH Cameron

WELL NAME & NO. Dr. M. O. Miller #1 SEC. 20 T 15S R 5W

Degrees Deviation	Deviation Factor	DEGREES DEVIATION	DEPTH FROM SURFACE	LENGTH OF INTERVAL	DEVIATION FACTOR	DEVIATION OF INTERVAL	CUMULATIVE APPARENT DEVIATION	REMARKS
		3/4	339	339	.01309	4.4	4.4	
¼	.00436							
½	.00873	1/2	866	527	.00873	4.6	9.0	
¾	.01309							
1	.01745	1/2	1369	503	.00873	4.4	13.4	
1¼	.02182							
1½	.02618	1/2	1890	521	.00873	4.5	17.9	
1¾	.03054							
2	.03490	3/4	2699	809	.01309	10.6	28.5	
2¼	.03926							
2½	.04362	1/4	3680	981	.00436	4.3	32.8	
2¾	.04798							
3	.05234	3/4	4430	750	.01309	9.8	42.6	
3¼	.05669							
3½	.06105	3/4	5213	783	.01309	10.2	52.8	
3¾	.06540							
4	.06976	3/4	5908	695	.01309	9.1	61.9	
4¼	.07411							
4½	.07846	3/4	6808	900	.01309	11.8	73.7	
4¾	.08281							
5	.08716	1	7634	826	.01745	14.4	88.1	
5¼	.09150							
5½	.09585	3/4	8353	719	.01309	9.4	97.5	
5¾	.10019							
6	.10453	0	8934	581	0	0	97.5	
6¼	.10887							
6½	.11320	3/4	9864	930	.01309	12.2	109.7	
6¾	.11754							
7	.12187	3/4	10,681	817	.01309	10.7	120.4	
7¼	.12620							
7½	.13053	3/4	11,551	870	.01309	11.4	131.8	
7¾	.13485							
8	.13917	1/2	12,094	543	.00873	4.7	136.5	
8¼	.14349							
8½	.14781							
8¾	.15212							
9	.15643							
9¼	.16074							
9½	.16505							
9¾	.16935							
10	.17365							

Certified as Being True & Correct by

R. C. Lumb

Title Petroleum Engineer Date 4-22-75

NOTICE: NO ALLOWABLE WILL BE ASSIGNED UNTIL PROOF OF COMPLIANCE WITH SECTION XVIII, STATEWIDE ORDER NO. 29-B IS RECEIVED BY THE DEPARTMENT OF CONSERVATION. THREE (3) SIGNED COPIES OF THIS REPORT SHOULD BE SUBMITTED WITH FORM WH ON ALL WELLS, EXCEPT AS NOTED ON THE REVERSE SIDE.

SEE INSTRUCTIONS ON REVERSE SIDE

I N S T R U C T I O N S

This report shall be typewritten only and filed in triplicate as an attachment to the Well History and Work Resume Report (Form WH).

The tabulation, set apart in the blocked section on the left is for easy reference, and the three blank columns located between the double lines are for convenience in calculations. All blank columns should be completed so that all work may be easily checked.

In the first two columns record the Degrees Deviation and the Depth from Surface at which such deviation was recorded.

The Length of Interval for any particular Depth from Surface is obtained by subtracting the previous Depth from Surface from that particular point.

The only exception being the first Length of Interval which is equal to its Depth from Surface.

The Deviation Factor may be obtained from the tabulation on the left. Multiply the Length of Interval by the respective Deviation Factor to obtain the Deviation of Interval.

Cumulative Apparent Deviation is a running summation of Deviation of Interval values and the final figure in the Cumulative Apparent Deviation Column should be equal to the sum of all the individual Deviation of Interval figures and will be the apparent resultant lateral deviation of the hole at Total Depth.

If a Directional Survey for determining the bottom of the hole is filed with the Commissioner of Conservation upon completion of the well, it shall not be necessary to furnish the Inclination Survey data.

RECEIVED
APR 23 1975
DEPT. OF CONSERVATION
PERMIT SECTION
BATON ROUGE, LA.

DEPT. OF CONSERVATION

APR 24 1975

LAKE CHARLES

WATSON OIL CORPORATION

P. O. BOX 4128

SHREVEPORT, LOUISIANA 71104

147552

January 15, 1976

State of Louisiana
Department of Conservation
P. O. Box 1767
Lake Charles, Louisiana 70601

RE: Watson Oil Corporation
Dr. M. O. Miller No. 1 ¹⁴⁷⁵⁵²
and "A" No. 1 ¹⁴⁹⁷¹⁹
Crab Lake Field
Cameron Parish, Louisiana

Gentlemen:

We respectfully request permission to complete the above wells using 3-1/2" tubing. The tubing was run for the following reasons:

1) The lower velocity of the gas through the 3-1/2" tubing should significantly reduce the erosion and corrosion in the tubing string. Formation tests of the reservoir indicated the gas to be fairly dry and, in most cases, this tends to create a very corrosive environment. We also plastic coated the tubing to aid in the prevention of corrosion.

2) This less friction through the larger tubing string should allow us to produce some additional gas from the reservoir.

3) The available 3-1/2" tubing was stronger than the available 2-7/8" tubing.

Both of the above wells are completed in the same reservoir and both are located on Dr. M. O. Miller leases.

Thank you for your assistance.

Very truly yours,

WATSON OIL CORPORATION

R. C. Turnham
R. C. Turnham
Chief Petroleum Engineer

RCT/jo.

Your request to use 3 1/2" tubing in the Miller #1 and Miller A #1 is hereby approved
W^{TR}-b. Wilhite

Change
 Correction
7609 Effective Date
yymm
9999 End Date
yymm

14752* Serial No. Date 9-1-76
CURRENT CODES
012 PARISH Cameron
3000 FIELD Crab Lake
6279 OPERATOR Watson Oil Corporation
ADDRESS P.O. Box 4128
CITY & STATE Shreveport, La. 71104

FORMER CODES

AMENDMENT ACTION
0.0.9. PARISH
0.3.4. FIELD
0.3.5. OPERATOR
0.1.6. LSE-UN
0.1.6. UN-LSE
0.1.6. LSE-LSE
0.1.6. UN-UN
0.1.4. WELL NO.
5.2.1. LOCATION

WELL NAME Rob I RA SUA;Miller No. 1
LOCATION OF WELL: Sec 20 T 15S R 5W Former Well No. 1
Location Same
*Formerly typed as Serial #147522

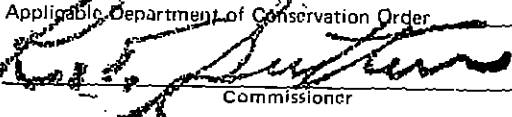
Applicable Department of Conservation Order

Commissioner

Issuing Authority

WELL FILE COPY

No. A-C

RECEIVED

SEP 15 1976

DEPT. OF CONSERVATION
PERMIT SECTION
BATON ROUGE, LA.

1. Change
2. Correction
7609 Effective Date
yy mm

End Date
yy mm

147522 Serial No.

Date **9-15-76**

CURRENT CODES

012

PARISH

Cameron

3000

FIELD

Crab Lake

6279

OPERATOR

Watson Oil Corporation

ADDRESS

P. O. Box 4128

CITY & STATE

Shreveport, La.

71104

FORMER CODES

AMENDMENT ACTION

- 0.0.9. PARISH
- 0.3.4. FIELD
- 0.3.5. OPERATOR
- 0.1.6. LSE-UN
- 0.1.6. UN-LSE
- 0.1.6. LSE-LSE
- 0.1.6. UN-UN
- 0.1.4. WELL NO.
- 5.2.1. LOCATION

WELL NAME **Rob I RA SUA;Miller** No. **1**

LOCATION OF WELL: Sec. **20** T. **15S** R. **5W** Former Well No. **1**

Location Same

***Formerly: Dr. M. O. Miller**

Applicable Department of Conservation Order **865-A**

Commissioner

Joseph I. DeWalt
Issuing Authority

WELL FILE COPY

No.

A-C

POTENTIAL REPORT

Type Well: Oil _____ Gas Distillate _____

Type Test: Comp. Recomp. _____ Retest _____ Regauge _____

Parish CAMERON Field CRAB LAKE

Company WATSON OIL Corp Serial No 147552

Well Name & No. DR. M. O. MILLER #1

Location: Sec. 20 Twp 15S Rge. 5E Flowing Pump _____

Prod. Horizon Rob - 1 Perf. Int. 12471 to 12490

Casing Setting: Size 7" @ 12498 to 12564

Tubing Setting: Size 3 1/2" @ 12362 T.D. 12685

Date Completed 10-9-76 Date Gauged 10-20-76

Acidize with _____ gals. Elev. of Derr. Floor 22.32

— TEST DATE —

T. P. 4825 C. P. 925 Choke Size Adj /64th

Closing TK Gge. 2 ft. 11 3/4 in. @ 2:30 PM Time

Opening TK Gge. 2 ft. 0 in. @ 10:30 AM Time

Diff. 11 3/4 ft. in. 4 Hours (Time)

Tank No. 1 Tank Coef. 2.08

Bbls. per 4 Hrs. 24.44 Est. Bbls. per Day 147

Daily Gas Vol. 10000 M.C.F. G/O Ratio 68027

B.S.&W. 1/10 % Corrected Gravity 43.8 Deg. A.P.I.

Witnessed by [Signature] Title _____

Gauged by [Signature] Title _____
Department of Conservation

District Office Lake Charles

Remarks: 900# @ 21"

6 x 3 1/4 OP

Std. Chart. 1500# @ 100"

Handwritten notes and numbers at the top of the page, including "10-20-76" and "10-21-76".

Handwritten notes and numbers in the middle section, including "10-21-76" and "10-22-76".

RECEIVED

NOV 03 1976

DEPT. OF CONSERVATION
PERMIT SECTION
BATON ROUGE, LA

CONSERVATION DEPT.

OCT 21 1976

CHARLES

STATE OF LOUISIANA
OFFICE OF CONSERVATION
LOUISIANA STATE POTENTIAL REPORT

District Lake Charles INPUT TYPE
 Field Crab Lake 1 - OC Only
 Parish Cameron 2 - Original
 Operator Watson Oil Corp. Code 16279 3 - Correction
 Sec. 20 TWP. 15^S RGE. 5^W Test Date 7, 19, 78
 12 Mo. Day Yr.

TYPE OF WELL TYPE OF TEST PRODUCING METHOD
 1-OIL 1-COMPLETION F-FLOWING
 2-GAS 2-RECOMPLETION P-PUMPING
 3-RETEST 20 G-GASLIFT

WELL SERIAL NO.	WELL NAME	WELL NO.	NAME OF RESERVOIR
147552	Dr. M.O. Miller	1	Rob 1

TOTAL DEPTH	PERFORATED INTERVAL FROM TO	CHOKE /64"	OIL BBL/DAY	COND. BBL/DAY	GAS MCF/DAY	GAS/OIL RATIO CF/BBL
12685	12470 12479	11	-	16.55	2000	120846/1

API GRAV. @ 60° F.	WATER BBL/DAY	BS&W %	FLOWING PRES. (PSIG)	CASING PRES. (PSIG)	DATE OF COMPLETION		
					MO.	DAY	YR.
43.8	390	96	2050	0	4	28	78

CLOSE TANK/METER GAUGE 8' 8" • 12N TIME
 OPEN TANK/METER GAUGE 8' 0" • 12N TIME
 DIFFERENCE 8" in 24 HOURS
 TANK/METER NO. 16292 TANK COEF. 2.07

STATIC PRES. 900[#] DIFFERENTIAL PRES. 45" LINE SIZE 6"
 PLATE SIZE 1 1/4" COEFFICIENT 1500[#] METER SPRING & DIFF. RANGE 100"
 REMARKS _____

WITNESSED BY [Signature] GAUGED BY [Signature]
 TITLE Oil & Gas Ins. TITLE Asst. Gen. Foreman

STATE OF LOUISIANA
 OFFICE OF CONSERVATION
 PERMIT SECTION
 BATS AND STAMPS REPORT

REPORT NO. 100-1000
 DATE 7/18/78
 COUNTY St. Charles
 LOCALITY St. Charles
 EST. DATE 7/18/78

TYPE OF TEST SWIMMING
 TYPE OF TEST SWIMMING
 TYPE OF TEST SWIMMING

NO.	DATE	TIME	LOCATION	RESULTS
1	7/18/78	10:00	St. Charles	1 bat
2	7/18/78	10:15	St. Charles	1 bat
3	7/18/78	10:30	St. Charles	1 bat
4	7/18/78	10:45	St. Charles	1 bat
5	7/18/78	11:00	St. Charles	1 bat

PERMIT NO. 100-1000
 TIME 10:00
 HOURS 10:00 - 11:00

RECEIVED

JUL 24 1978

DEPT. OF CONSERVATION
 PERMIT SECTION
 BATON ROUGE, LA.

JUL 21 1978

STAMPS

[Handwritten signatures and notes at the bottom of the page]

29-E COMPLIANCE
 YES NO
 29-E UNIT ATTACHED
 YES NO

STATE OF LOUISIANA
 DEPARTMENT OF CONSERVATION

WELL COMPLETION OR RECOMPLETION REPORT

D.O.C. USE ONLY

DISTRICT Lake Charles

CODE NUMBERS: | DATE May 5, 1978
12 | PARISH Cameron
3000 | FIELD Crab Lake
6279 | OPERATOR Watson Oil Corporation
605111 | WELL NAME Dr. M. O. Miller NO. 1 SERIAL NO. 147552
 | RESERVOIR Robulus 4/28/78 6:30
 | COMPLETION DATE TIME AM PM

1 - ON-SHORE
 2 - INTERMEDIATE
 3 - OFF-SHORE
 SEC. 20 T 15S R 5W

DOC ORDER NO. _____

IMPORTANT: IS A FORM MD-10-R-A BEING FILED WITH THIS REPORT? IF NO, EXPLAIN YES NO

REMARKS: Still completed in same reservoir

COMPLETION DATA:

* TYPE COMPLETION PRIMARY PRODUCT PRIMARY PRODUCT CHANGE? PRODUCING METHOD

1 - ORIG. COMP. 1 - OIL 1 - YES 1 - FLOWING
 2 - RE-COMP. 2 - GAS 2 - NO 2 - GAS LIFT
 3 - DRY GAS 3 - PUMPING
 4 - SHUT IN

* IF THIS IS A RE-COMPLETION SPECIFY: SAME RESERVOIR DIFFERENT RESERVOIR

10 BOPD 1,000 MCF/DAY 2150 PSIG 2750 PSIG Sealed PSIG
 INITIAL PROD. GAS VOLUME FLOWING TUBING SHUT-IN TUBING CASING PRESSURE
 PRESSURE PRESSURE PRESSURE

10/64" 1 - POSITIVE
 CHOKE SIZE 2 - ADJUST 0 % 100,000 CF/BBL 45.5 API AT 60°F
 BS & W GOR GRAVITY

PERFORATIONS 12,470-479' TOTAL DEPTH 12,650'

CLEARANCE & CERTIFICATION:

ADDITIONAL CLEARANCE IS REQUESTED FOR --- BBLs. OF OIL PRODUCED ON DRILL-STEM OR OTHER PRODUCTION TEST: (SEE SECTION X PARAGRAPH 8 OF ORDER 29-B ON REVERSE SIDE).

CERTIFICATION

I HEREBY CERTIFY THAT THE ABOVE INFORMATION IS TRUE AND CORRECT TO THE BEST OF MY KNOWLEDGE.

INSTRUCTIONS

THREE (3) COPIES TO BE FILED WITH THE DISTRICT OFFICE WITHIN THREE (3) DAYS OF DATE OF COMPLETION OR RECOMPLETION (AS PER ORDER 29-B, SECTION X, PARAGRAPH A, ARTICLE 1).

James Guerin
 SIGNATURE
Watson Oil Corporation
 OPERATOR
Drilling Superintendent
 TITLE

DEPARTMENT OF CONSERVATION
STATE OF LOUISIANA

This side is to be used when requesting clearance for oil produced on Drill Stem Test or other Production Tests, made previous to official completion or recompletion.

SECTION X, PARAGRAPH B OF ORDER NO. 29-B

Allowables given to wells for oil produced on drill stem tests, production test and miscellaneous production of oil shall be in accordance with the following rule:

All operators are required within five days, to file three signed copies of the record of the daily production from the well, showing the number of hours the well produced and the interval of production --- as "from 8:00 A.M., August 5 to 3:00 P.M., August 8, 1952."

<u>Date of Test</u>	<u>TEST DATA</u>		<u>Amount of Oil Produced</u>
	<u>Time of Test</u>		
_____	_____ M. to _____	_____ M.	_____ Barrels
_____	_____ M. to _____	_____ M.	_____ Barrels
_____	_____ M. to _____	_____ M.	_____ Barrels
_____	_____ M. to _____	_____ M.	_____ Barrels
_____	_____ M. to _____	_____ M.	_____ Barrels
_____	_____ M. to _____	_____ M.	_____ Barrels
_____	_____ M. to _____	_____ M.	_____ Barrels
_____	_____ M. to _____	_____ M.	_____ Barrels
_____	_____ M. to _____	_____ M.	_____ Barrels
_____	_____ M. to _____	_____ M.	_____ Barrels
TOTAL			_____ BARRELS

RECEIVED
MAY 15 1978

JUN 16 1978
TOTAL _____ BARRELS

The above total barrels of oil were produced from _____ Ft. to _____ Ft.

DEPT. OF CONSERVATION
BAYOU BOULEVARD
MONROE, LA.
CONSERVATION DEPT.

Remarks: _____

MAY 17 1978

LAKE CHARLES,

OPERATOR

(Signed) OPERATOR REPRESENTATIVE



OFFICE OF CONSERVATION
WELL HISTORY AND WORK RESUME REPORT

FIELD
Crab Lake

SERIAL NO.
147552

PRODUCING INTERVAL
12,470-479'

RESERVOIR (COMPANY SAND IDENTIFICATION)
Robulus

Three typewritten copies of this report must be filed with the District Office of the Office of Conservation in which the well is located within twenty (20) days of the date of completion. NOTE: if not properly completed and signed this report will be returned.

LEASE AND WELL DATA

CHECK APPROPRIATE BOXES

NEW WELL

RECOMPLETION

P B A

31 INACTIVE DRY HOLE FUT. UTIL.

32 INACTIVE DRY HOLE NO FUT. UTIL.

36 INACTIVE WAITING ON PIPELINE

37 INACTIVE WAITING ON MARKET

PRODUCT

OIL

GAS

OTHER

IF RECOMPLETION

SAME RESERVOIR

DIFFERENT RESERVOIR

DATE COMP. RECOMPL. OR P B A M D Y

4/28/78

OPERATOR
Watson Oil Corporation

CODE
6279

ADDRESS
4801 Woodway - Suite 480-W, Houston, TX 77056

WELL NAME **Dr. M. O. Miller**

WELL NO.
1

PARISH
Cameron

SEC. **20** TWP. **15S** R6E **5W**

DATE PERMIT ISSUED
12/18/74

DATE SPUNDED **2/10/75**

DATE READY TO PRODUCE* **4/18/75**

TOTAL DEPTH
12,685

PBTD.
12,650

GROUND ELEVATION
1.5

CASING HEAD FLANGE ELEVATION
2.0

DISTANCE FROM RKB TO CNF
26.0

DATE WELL TURNED INTO TANKS
10/8/76

SINGLE, DUAL OR TRIPLE COMPLETION?
Single

NOTE: IF THIS IS A MULTIPLE COMPLETION, FURNISH A SEPARATE REPORT FOR EACH COMPLETION

WAS WELL DIRECTIONALLY DRILLED? **No**

WAS DIRECTIONAL SURVEY MADE? **Totco's**

WERE 3 COPIES FILED WITH THE OFFICE OF CONSERVATION?
Form AD

DATE FILED
4/22/75

TYPE OF ELECTRICAL OR OTHER LOGS RUN (CIRCLE LOGS FILED WITH OFFICE OF CONSERVATION)

ISF Sonic; Dipmeter; CBL

DATE FILED
4/22/75

CASING, LINER AND TUBING RECORD

C	CASING SIZE	HOLE SIZE	CASING WEIGHT	DEPTH SET		SACKS CEMENT	TEST PRESSURE	HOURS UNDER PRESSURE	DATE TESTED (MM DD YY)	NAME OF TEST WITNESS - STATE IF CONSERVATION AGENT OR OFFSET OPERATOR	
				FROM	TO						
101	16"	Driven			147'						
102	10-3/4"	15"	40.5		2,690'	1860	1000	1/2	2/13/75		
103	7"	9-7/8"	26		12,685'	1400	1500	1/2	4/06/75		
104											
105											
TUBING SIZE:		3-1/2"		DEPTH OF TUBING:		12,203		DEPTH OF PACKER(S):		12,203	

INITIAL COMPLETION OR RE-COMPLETION DATA

INITIAL PRODUCTION
10

GAS VOLUME
1,000

GOR
100,000

CHOKE SIZE
10

PRODUCING METHOD
Flowing

FLOWING TUBING PRESSURE
2150

SHUT-IN TUBING PRESSURE
2750

CASING PRESSURE
Sealed

WATER PRODUCTION
35

BSSW
0

GRAVITY
45.5

BHP (SHUT-IN)
4000

COMPANY REPRESENTATIVE
Melvin Theriot

DATE GAUGED
4/28/78

PLUG AND ABANDON (P B A) DATA

CASING SIZE	AMOUNT PULLED	CEMENT PLUGS				DATE WORK PERFORMED	NAME OF TEST WITNESS - STATE IF CONSERVATION AGENT OR OFFSET OPERATOR
		FROM	TO	SACKS	HOW PLACED		

CERTIFICATE: I, the undersigned, state that I am employed by Watson Oil Corp. and that I am authorized to make this report, and that this report was prepared under my supervision and direction and that all facts stated herein are true, correct and complete to the best of my knowledge.

Signature: Mario Garcia Title: Drilling Superintendent

*Data well is equipped to produce, but due to no available market, no pipe line connection, etc., the well has been shut-in.

WORK RESUME

List below all work performed under Office of Conservation Work Permits while drilling and completing well.

WORK PERMIT NO.	DATE WORK PERFORMED	SERVICE COMPANY	DESCRIPTION OF WORK
264-78	4/14/78	Halliburton	Set RTTS @ 12,250', sq. perfs. 12,421' to 12,564' w/150 sx cmt.
	4/22/78	Schlumberger & Go Int'l.	Set Baker Model R pkr @ 12,203' Perf from 12,554'-562'
426-78	4/26/78	Go Int'l.	Set Go Elite Bridge Plug @ 12,545' Perf 12,470'-479'.

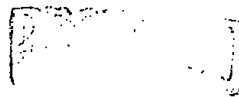

MAY 8 1978

DEPT. OF CONSERVATION
PERMIT SECTION
BATON ROUGE, LA.

List below all important Paleofaunal or Geological Formation tops, Cap Rock and Salt Overhang bottoms.

FORMATION	DEPTH	FORMATION	DEPTH

CONSERVATION DEPT.

MAY 17 1978

LAKE CHARLES

CONSERVATION DEPT.

MAY 23 1978

LAKE CHARLES

Lake Charles
 Conservation Dept.
 Permit Section
 Baton Rouge, LA

RECEIVED
 DEPT. OF CONSERVATION
 PERMIT SECTION
 BATON ROUGE, LA.

14225	Dr M C Miller	1	2420	800	10 13 78
14222	Dr M C Miller	1	2420	800	10 13 78
14221	Dr M C Miller	1	2420	800	10 13 78
14220	Dr M C Miller	1	2420	800	10 13 78

RECEIVED
 DEPT. OF CONSERVATION
 PERMIT SECTION
 BATON ROUGE, LA.

DEC 5 1978

DEPT. OF CONSERVATION
 PERMIT SECTION
 BATON ROUGE, LA.

CONSERVATION DEPT.

OCT 25 1978

LAKE CHARLES

[Handwritten signatures and notes at the bottom of the page, including names like "Miller" and "Conservation Dept."]

STATE OF LOUISIANA
DEPARTMENT OF CONSERVATION

WELL COMPLETION OR RECOMPLETION REPORT

29-E COMPLIANCE	YES	NO
29-E UNIT ATTACHED	YES	NO
D.O.C. USE ONLY		

DISTRICT Lake Charles

CODE NUMBERS: <u>12</u>	DATE <u>10-24-78</u>	<input type="checkbox"/> 1 - ON-SHORE <input checked="" type="checkbox"/> 2 - INTERMEDIATE <input type="checkbox"/> 3 - OFF-SHORE
<u>3000</u>	PARISH <u>Cameron</u>	SEC. <u>20</u> T <u>15S</u> R <u>5W</u>
<u>6279</u>	FIELD <u>Crab Lake</u>	DOC ORDER NO. _____
<u>605111</u>	OPERATOR <u>Watson Oil Corporation</u>	
	WELL NAME <u>Dr. M. O. Miller</u>	NO. <u>1</u> SERIAL NO. <u>147552</u>
	RESERVOIR <u>9900' Sand</u>	10-24-78 8:00 COMPLETION DATE TIME <input checked="" type="checkbox"/> AM <input type="checkbox"/> PM

IMPORTANT: IS A FORM MD-10-R-A BEING FILED WITH THIS REPORT? IF NO, EXPLAIN YES NO

REMARKS: _____

COMPLETION DATA:

* TYPE COMPLETION	PRIMARY PRODUCT	PRIMARY PRODUCT CHANGE?	PRODUCING METHOD
<input checked="" type="checkbox"/> 1 - ORIG. COMP. <input type="checkbox"/> 2 - RE-COMP.	<input checked="" type="checkbox"/> 1 - OIL <input type="checkbox"/> 2 - GAS <input type="checkbox"/> 3 - DRY GAS	<input checked="" type="checkbox"/> 1 - YES <input type="checkbox"/> 2 - NO	<input checked="" type="checkbox"/> 1 - FLOWING <input type="checkbox"/> 2 - GAS LIFT <input type="checkbox"/> 3 - PUMPING <input type="checkbox"/> 4 - SHUT IN

* IF THIS IS A RE-COMPLETION SPECIFY: SAME RESERVOIR DIFFERENT RESERVOIR

<u>46</u> BOPD INITIAL PROD.	<u>2,200</u> MCF/DAY GAS VOLUME	<u>3450</u> PSIG FLOWING TUBING PRESSURE	<u>3525</u> PSIG SHUT-IN TUBING PRESSURE	<u>800</u> PSIG CASING PRESSURE
<u>11</u> / 64" <input checked="" type="checkbox"/> 1 - POSITIVE <input type="checkbox"/> 2 - ADJUST CHOKE SIZE	<u>.1</u> % BS & W	<u>47826</u> CF/BBL GOR	<u>50.3</u> API AT 60°F GRAVITY	

PERFORATIONS 9908-9913' TOTAL DEPTH 12,650'

CLEARANCE & CERTIFICATION:

ADDITIONAL CLEARANCE IS REQUESTED FOR _____ BBLs. OF OIL PRODUCED ON DRILL-STEM OR OTHER PRODUCTION TEST: (SEE SECTION X PARAGRAPH B OF ORDER 29-B ON REVERSE SIDE).

CERTIFICATION

I HEREBY CERTIFY THAT THE ABOVE INFORMATION IS TRUE AND CORRECT TO THE BEST OF MY KNOWLEDGE.

Cathy D. Thomas
SIGNATURE
Watson Oil Corporation
OPERATOR
Senior Petroleum Engineer
TITLE

INSTRUCTIONS

(THREE (3) COPIES TO BE FILED WITH THE DISTRICT OFFICE WITHIN THREE (3) DAYS OF DATE OF COMPLETION OR RECOMPLETION (AS PER ORDER 29-B, SECTION X, PARAGRAPH A, ARTICLE 1).)

DEPARTMENT OF CONSERVATION
STATE OF LOUISIANA

This side is to be used when requesting clearance for oil produced on Drill Stem Test or other Production Tests, made previous to official completion or recompletion.

SECTION X, PARAGRAPH B OF ORDER NO. 29-B

Allowables given to wells for oil produced on drill stem tests, production test and miscellaneous production of oil shall be in accordance with the following rule:

All operators are required within five days, to file three signed copies of the record of the daily production from the well, showing the number of hours the well produced and the interval of production --- as "from 8:00 A.M., August 5 to 3:00 P.M., August 8, 1952."

T E S T D A T A

<u>Date of Test</u>	<u>Time of Test</u>	<u>Amount of Oil Produced</u>
_____	M. to _____ M.	_____ Barrels
_____	M. to _____ M.	_____ Barrels
_____	M. to _____ M.	_____ Barrels
_____	M. to _____ M.	_____ Barrels
_____	M. to _____ M.	_____ Barrels
_____	M. to _____ M.	_____ Barrels
_____	M. to _____ M.	_____ Barrels
_____	M. to _____ M.	_____ Barrels
_____	M. to _____ M.	_____ Barrels
_____	M. to _____ M.	_____ Barrels
TOTAL _____		BARRELS

The above total barrels of oil were produced from _____ Ft. to _____ Ft.

Remarks: _____

OCT 31 1978

CONSERVATION DEPT.

DEPT. OF CONSERVATION
PERMIT SECTION
BATON ROUGE, LA.

OCT 30 1978

LAKE CHARLES

OPERATOR

(Signed) OPERATOR REPRESENTATIVE

12,450'

(Cherryville)
JAMC
*20278

15,027'

L/86-8
1-25-80
66.67% WI/180 ac

Hilliard
20611
11,952'

Forest:
11,350'

2,176'

Imperial Am Mol
126,252 Ac Unit
Miller No. 2

L/86-1
2-1-78
100% WI/440 ac.
75% NRI-BPO
72% NRI-APO

Shenandoah
12,016'

Forest:
12,016'

13,915'

13,207'

HBP
Rt. above 13,307'

12,950'

L/86-7 12,750'
HBP
100% WI-BPO
50% WI-APO
62% NRI

L/86-5
7-21-78
100% WI/40 ac.
67% NRI

17,900'

12,650'

WOC VOL UT
227,567 Ac
Miller No. 4

Dyce
12,018'

12,018'

ROB I RA SU A
159,492 acs.

L/86-4

L/86-6
10-31-78
100% WI/160 acs.
67% NRI

13,200' SU
89.05 acs.

L/86-4
3-19-78
100% WI/960 ac
67% NRI

Forest
12,689'
L/86-2
10-31-77
100% WI in
200 acs.
68.5% NRI

CRAB

LAKES

437+ Ac

WATSON OIL CORPORATION

CRAB LAKE

CAMERON PARISH, LOUISIANA
ACREAGE ALLOCATION PLAN

WOC - MILLER #1

All Sands Not Restored

29

20

21

Agms: 10-7-77 8
12-15-77)
Linda K Miller, et al

12,975' 6
Dr. Woods
12,007'

Miller
12,007'

WOC
12,685'

Shenandoah
14,025'

WOC
14,600'

Miller

L/86-4

L/86-4

L/86-7

Miller 1-A

WOC

WOC

L/86-4

12,858'

12,617'

13,337'

12,689'

14,600'

RECEIVED

DEC 5 1978

DEPT. OF CONSERVATION
PERMIT SECTION
BATON ROUGE, LA.

OFF. OF CONSERVATION
LAKE CHARLES DIST.

78 NOV 30 A 9 : 26

RECEIVED AND TIME

STATE OF LOUISIANA
OFFICE OF CONSERVATION

Inter Office

Date: 12/5/78

To: Baton Rouge Office

From: Lake Charles District

Attn: Joseph F. DeVall

Enclosed herewith please find application from Watson Oil Corporation
for permit to amend name on
their Dr. M. O. Miller #1, Crab Lake Field
Cameron Parish, Louisiana. Zone onshore ☒

Also enclosed please find:

Check No. _____ in the amount of \$ _____.

_____ Well location plat

_____ Well location certification

- _____ Form A.D.C.
- _____ Electric Log
- _____ Schematic diagram
- _____ (Dual) structure map if well does not comply with existing Orders
- _____ (Selective-Onshore) structure map showing reservoir limits
- _____ (Selective-Offshore) letter(s) of no objection from offset operators

Applicable Department of Conservation Order No. 29-B

Pending Hearing, Docket No. _____

Remarks & Recommendations:

Recommend approval. This well has been recompleted out of the unit sand and returns to lease status. This amendment is exempt from the fee.

FORMERLY: Rob 1 RA SUA; Miller #1

By W. C. Wilhite
District Manager
W.C. WILHITE

cc: Geological Oil & Gas Division
Prod. Audit (for Amended Permits only)

LT-1

STATE OF LOUISIANA
OFFICE OF CONSERVATION

Form A.D.C. 100
Application for a permit to
excavate, fill, or otherwise
alter the natural surface of
the land, or to construct, alter,
or remove any structure, or to
perform any other activity which
may affect the natural resources
of the State.

RECEIVED

DEC 6 1978

DEPT. OF CONSERVATION
PERMIT SECTION
BATON ROUGE, LA

BY: _____
Special Agent

For a copy of the permit application form, contact the Permit Section, Department of Conservation, Baton Rouge, Louisiana.

LC

147552 Serial No.

Date 12-6-78

CURRENT CODES

012 PARISH Cameron
3000 FIELD Crab Lake
6279 OPERATOR Watson Oil Corporation
ADDRESS 4801 Woodway, Suite 480W
CITY & STATE Houston, TX 77056

FORMER CODES

- Change
- Correction
- 7812 Effective Date
yymm
- 9999 End Date
yymm

AMENDMENT ACTION

- 0.0.9. PARISH
- 0.3.4. FIELD
- 0.3.5. OPERATOR
- 0.1.6. LSE-UN
- 0.1.6. UN-LSE
- 0.1.6. LSE-LSE
- 0.1.6. UN-UN
- 0.1.4. WELL NO.
- 5.2.1. LOCATION

147552 WELL NAME Dr M O Miller* No. 1 504961
LOCATION OF WELL: Sec. 20 T 15S R 5W Former Well No. _____
Location Same
*Formerly Rob I RA SUA; Miller

Applicable Department of Conservation Order 29B

[Signature]
Commissioner

[Signature]
Issuing Authority

WELL FILE COPY

No. 1 A-C

STATE OF LOUISIANA
OFFICE OF CONSERVATION

Inter Office

Date: 4/24/81

To: Baton Rouge Office
From: Lake Charles District
Attn: Ed Buford

Enclosed herewith please find application from Watson Oil Corporation
_____ for permit to amend name on
their 2 wells, _____ Crab Lake Field
_____ Cameron Parish, Louisiana. Zone onshore

Also enclosed please find:

Check No. _____ in the amount of \$ _____.

_____ Well location plat
_____ Well location certification

_____ Form A.D.C.
_____ Electric Log
_____ Schematic diagram
_____ (Dual) structure map if well does not comply with existing Orders
_____ (Selective-Onshore) structure map showing reservoir limits
_____ (Selective-Offshore) letter(s) of no objection from offset operators

Applicable Department of Conservation Order No. 865-B.

Pending Hearing, Docket No. _____.

Remarks & Recommendations:

Recommend approval. Names changed to comply with the provisions of order 865-B and nomenclature standards. ~~THESE AMENDMENTS~~ These amendments are exempt from the fee.

Formerly: Dr. M. O. Miller #1
M. O. Miller #13

By W. C. Wilhite
District Manager
W. C. WILHITE

cc: Geological Oil & Gas Division
Prod. Audit (for Amended Permits only)

DEPT. OF CONSERVATION
PERMIT SECTION
BATON ROUGE, LA

RECEIVED
APR 27 1961

1000

...with a ...
...with ...
...with ...

1000

...

- 1. Change
- 2. Correction
- 8008 Effective Date
yymm
- 9999 End Date
yymm

147552 Serial No. LC Date 4-27-81

CURRENT CODES

012 PARISH Cameron

3000 FIELD Crab Lake

6279 OPERATOR Watson Oil Corporation

ADDRESS 4801 Woodway, #480W

CITY & STATE Houston, TX 77056

FORMER CODES

AMENDMENT ACTION

- 0.0.9. PARISH
- 0.3.4. FIELD
- 0.3.5. OPERATOR
- 0.1.6. LSE-UN
- 0.1.6. UN-LSE
- 0.1.6. LSE-LSE
- 0.1.6. UN-UN
- 0.1.4. WELL NO.
- 5.2.1. LOCATION

606975 WELL NAME 9900 RA SUA; Miller * No. 1 147552

LOCATION OF WELL: Sec. 20 T 15S R 5W Former Well No. _____

Location same * Dr M O Miller

Applicable Department of Conservation Order 865-B

R. T. Sutter
Commissioner

E. J. [Signature]
Issuing Authority

kcd

WELL FILE COPY

No.

A-C

AMENDED PERMIT TO DRILL FOR MINERALS

Change

8107 Effective
yymm

147552 Serial No. LC Date 8-27-81
CURRENT CODES
012 PARISH Camreon
3000 FIELD Crab Lake
3637 OPERATOR MCOR Oil Development *
ADDRESS 4801 Woodway, Ste 480 W
CITY & STATE Houston, TX 77056

FORMER CODES
6279

AMENDMENT ACTION

- 0.0.9. PARISH
- 0.3.4. FIELD
- 0.3.5. OPERATOR
- 0.1.6. LSE-UN
- 0.1.6. UN-LSE
- 0.1.6. LSE-LSE
- 0.1.6. UN-UN
- 0.1.4. WELL NO.
- 5.2.1. LOCATION

606975 WELL NAME 9900 RA SUA; Miller No. 1
LOCATION OF WELL: Sec. 20 T 15S R 5W Former Well No.

Location same * Watson Oil Corporation

Applicable Department of Conservation Order

[Signature]
Commissioner

[Signature]
Issuing Authority

kcd

WELL FILE COPY

No. 73100 A

1945
1946
1947
1948
1949
1950
1951
1952
1953
1954
1955
1956
1957
1958
1959
1960
1961
1962
1963
1964
1965
1966
1967
1968
1969
1970
1971
1972
1973
1974
1975
1976
1977
1978
1979
1980
1981
1982
1983
1984
1985
1986
1987
1988
1989
1990
1991
1992
1993
1994
1995
1996
1997
1998
1999
2000
2001
2002
2003
2004
2005
2006
2007
2008
2009
2010
2011
2012
2013
2014
2015
2016
2017
2018
2019
2020
2021
2022
2023
2024
2025

Work Permit
STATE OF LOUISIANA DEPARTMENT OF CONSERVATION

Well Name & No. Dr. M. O. Miller #1 Sec. 20 T. 15S R. 5W
Field Crab Lake Parish Cameron
Permit Serial No. 147552 Work Permit No. 1313-81

Description of Work P&A - Set Plug @ 9700'-9800' with 25 sacks cement,
set plug @ 2600'-2800' with 65 sacks, set plug @ 5'-55' with 25
sacks. Cut 10 3/4" casing 4' below ground level and weld 1/2"
plate on top of casing. Seaboard Pipe & Equip. Co. contractor.

Sand & Reservoir To Be Tested _____ TD _____

Operator MCOR Oil Development, Inc.
Address 4801 Woodway, Suite 480W
City, State & Zip Houston, Texas 77056

Permit Requested By Jane Ashcraft Date 12-7-81
Jane Ashcraft

Permit Authorized By W. L. Whit District L.C. Date 12-14-81

STATE OF LOUISIANA
OFFICE OF CONSERVATION
PLUG AND ABANDON REPORT

WORK PERMIT NO. Applied for WELL SERIAL NO. 147552
DATE WORK FINISHED (MM-DD-YY) 12-11-81

Cameron DISTRICT
(Three Copies to be Filed with the District Office)

NOTE: This Report Will Be Returned If Not Properly Completed And Signed.

Field Crab Lake Parish Cameron Sec. 20 Twp. 15-5 Rge. 5-W
Operator MCOR Oil Development, Inc. Well Name Dr. M.O. Miller Well No. 1
Total Depth 10000 Condition of Well Depleted

CHECK APPROPRIATE BOX:
 29 DRY HOLE
 30 FORMERLY PRODUCTIVE WELL

	CASING SIZE	AMOUNT PULLED	CEMENT PLUGS			
			FROM	TO	SACKS	HOW PLACED
301			9850	9750	25	Subroad-pump
302	7"	2675'	2775	2575	75	" -
303	10 3/4"	0	35'	5	15	" -
304						

Mud Record: Weight 9.5 SW. Viscosity _____

Remarks: Logged Cement @ 2550' w/ try weight, Cut all pipe 4'
to ground level and weld 1/2" steel plate on top.

This work was done according to the Rules and Regulations of the Office of Conservation.

WITNESS

MCOR Oil Development, Inc.
OPERATOR

(Signed) Tommy Stalley
REPRESENTATIVE

Street Oil - Miller Well No 13

1 - No. 13 ALT.
SU A 176 Acs

20214
12,450'
Cherryville
20278
15,027'

CANAL

L/86-9
1-25-80
19,32/28,974
W.I. 66.67%
N.R.I. 73%
Hilliard
20611
11,962'

Emerald
Forrest
11,350'
S.I.
12,176'

Imperial Am. Mgt.
128,262 Ac. Unit
Miller No. 2
100% W.I./400.41 dc.
2-1-81
75% NRI-BPO
72% NRI-APPO

Forest
12,016'
Sherandoah
2,400'
W 400'
N 2200'

MCORD VOL. UT
227,567 Ac.
Miller No. 4

David S. Meyer
12,650'

160 Ac. Product
allocated to WPE

ROB I RA SU A
159,492 acs.

WPE Miller No.

13,200' SL
89.05 acs

L/86-4
3-19-78
100% W.I./96'
67% NRI
Part HBP

CRAB LAKE

MCORDD OIL DEVELOPMENT, INC.
4801 Woodway, Suite 480W, Houston, Texas 77058

CAMERON PARISH, LOUISIANA

ACREAGE ALLOCATION PLAT
MCORDD MILLER # 1

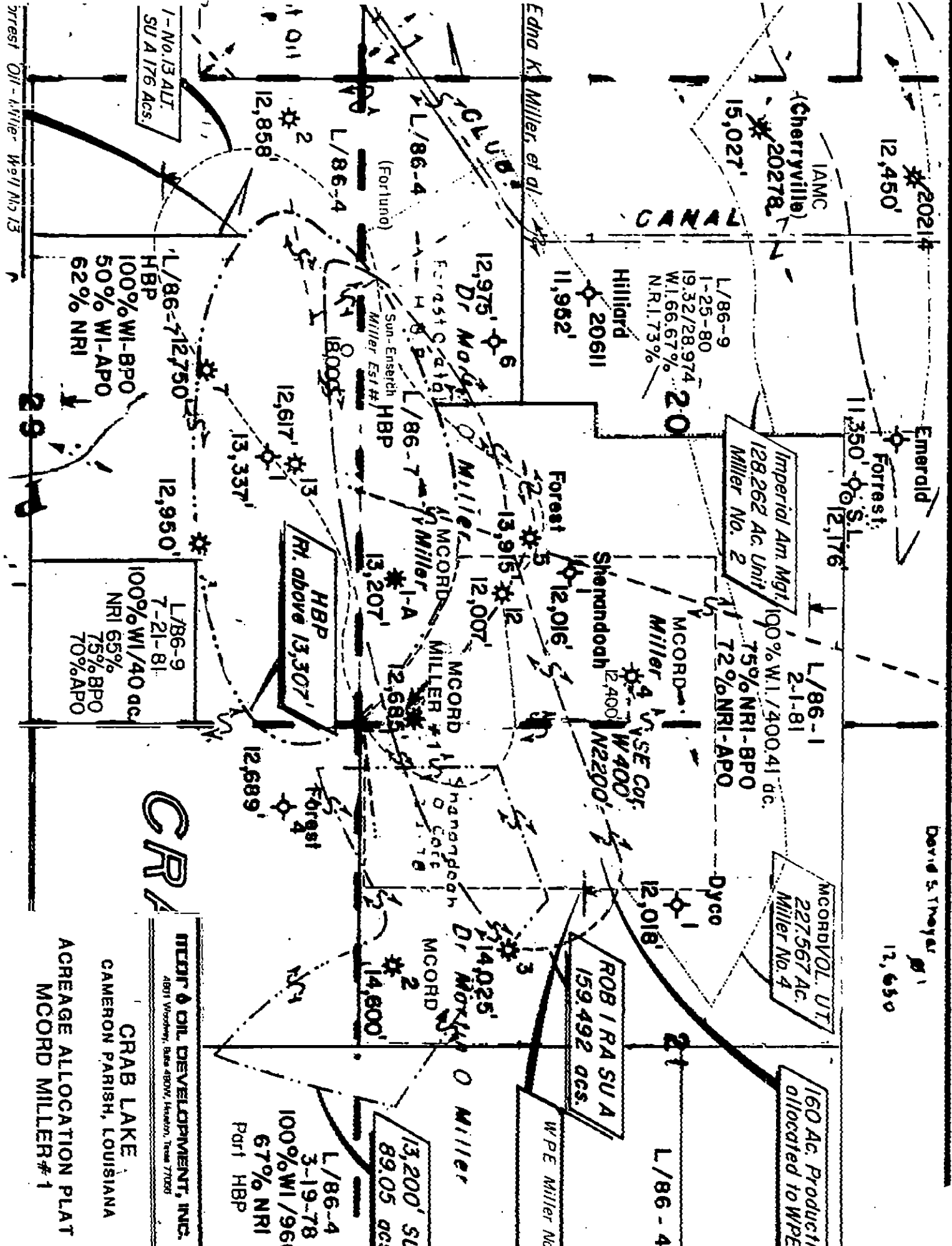

DEPARTMENT OF CONSERVATION
STATE OF LOUISIANA

PLUG AND ABANDON REPORT

DATE WORK DONE December 16, 1981

WELL SERIAL NO. 147552
WORK PERMIT NO. 1313-81

Lake Charles DISTRICT
(Three Copies to be Filed with the District Office)

NOTE: This Report Will be Returned if Not Properly Completed And Signed.

Field Crab Lake Parish Cameron Sec. 20 Twp. 15S Rge. 5W
Operator MCOR Oil Development, Inc. Well Name Dr. M. O. Miller Well No. 1
Total Depth 12,685' Condition of Well Watered Out

1. Surface Casing	Size <u>16"</u>	Depth <u>147'</u>	Amount Pulled <u>0</u>
2. Protection Casing	Size <u>10-3/4"</u>	Depth <u>2690'</u>	Amount Pulled <u>0</u>
3. Production Casing	Size <u>7"</u>	Depth <u>12,685'</u>	Amount Pulled <u>2675</u>

CEMENT PLUGS

1. Depth <u>9700'</u>	To <u>9800'</u>	No. of Sacks <u>25</u>	How Placed <u>Pumped</u>
2. Depth <u>2600'</u>	To <u>2800'</u>	No. of Sacks <u>65</u>	How Placed <u>Pumped</u>
3. Depth <u>5'</u>	To <u>55'</u>	No. of Sacks <u>25</u>	How Placed <u>Pumped</u>

Mud Record: Weight _____ Viscosity _____

Remarks: _____

This work was done according to the Rules and Regulations of the Department of Conservation.

WITNESS

MCOR Oil Development, Inc.

OPERATOR

{ Signed }

Jane Ashcraft

REPRESENTATIVE

CONSERVATION DEPT.

DEC 28 1981

WAYNE CHARLES



OFFICE OF CONSERVATION
WELL HISTORY AND WORK RESUME REPORT

FIELD	Crab Lake
SERIAL NO.	147552 ✓
PRODUCING INTERVAL	9908-9913'
RESERVOIR (COMPANY SAND IDENTIFICATION)	9900 Sand

Three typewritten copies of this report must be filed with the District Office of the Office of Conservation in which the well is located within twenty (20) days of the date of completion. NOTE: If not properly completed and signed this report will be returned.

LEASE AND WELL DATA

CHECK APPROPRIATE BOXES	<input checked="" type="checkbox"/> 31 INACTIVE DRY HOLE FUT. UTIL.	PRODUCT	IF RECOMPLETION	DATE COMP. RECD. OR P & A M D Y
<input type="checkbox"/> NEW WELL	<input type="checkbox"/> 32 INACTIVE DRY HOLE NO FUT. UTIL.	<input type="checkbox"/> OIL	<input type="checkbox"/> SAME RESERVOIR	12/16/81
<input type="checkbox"/> RECOMPLETION	<input type="checkbox"/> 36 INACTIVE WAITING ON PIPELINE	<input type="checkbox"/> GAS	<input type="checkbox"/> DIFFERENT RESERVOIR	
<input checked="" type="checkbox"/> P & A	<input type="checkbox"/> 37 INACTIVE WAITING ON MARKET	<input type="checkbox"/> OTHER		

OPERATOR	CODE	ADDRESS
MCOR Oil Development, Inc.	3637	4801 Woodway, Suite 480W Houston, Texas 77056

WELL NAME	WELL NO.
9900 RA SUIA, Dr. M. G. Miller	I

PARISH	SEC.	TWP.	RGE.	DATE PERMIT ISSUED
Cameron	20	15S	5W	12/18/74

DATE SPUDDED	DATE READY TO PRODUCE*	TOTAL DEPTH	PSTD.
2/10/75	4/18/75	12,685'	12,650'

GROUND ELEVATION	CASING HEAD FLANGE ELEVATION	DISTANCE FROM RKB TO CHF
1.5'	2.0'	26.0

DATE WELL TURNED INTO TANKS	SINGLE, DUAL OR TRIPLE COMPLETION?	NOTE: IF THIS IS A MULTIPLE COMPLETION, FURNISH A SEPARATE REPORT FOR EACH COMPLETION
10/8/76	Single	

WAS WELL DIRECTIONALLY DRILLED?	WAS DIRECTIONAL SURVEY MADE?	WERE 3 COPIES FILED WITH THE OFFICE OF CONSERVATION?	DATE FILED
No	TOTCO's	Form AD	4/22/75

TYPE OF ELECTRICAL OR OTHER LOGS RUN (CIRCLE LOGS FILED WITH OFFICE OF CONSERVATION)	DATE FILED
ISF Sonic; Dipmeter; CBL	4/22/75

CASING, LINER AND TUBING RECORD

C	CASING SIZE	HOLE SIZE	CASING WEIGHT	DEPTH SET		SACKS CEMENT	TEST PRESSURE	HOURS UNDER PRESSURE	DATE TESTED (MM DD YY)	NAME OF TEST WITNESS - STATE IF CONSERVATION AGENT OR OFFSET OPERATOR
				FROM	TO					
101	16"	Driven			147'					
102	10-3/4"	15"	40.5#		2690'	1860	1000	1/2	2-13-75	
103	7"	9-7/8"	26#		12685'	1400	1500	1/2	4-6-75	
104										
105										
TUBING SIZE: 2-7/8"		DEPTH OF TUBING: 9855'		DEPTH OF PACKERIS: 9855'						

INITIAL COMPLETION OR RE-COMPLETION DATA

INITIAL PRODUCTION	GAS VOLUME	GOR	CHOKE SIZE	PRODUCING METHOD
BOPD	MCF/DAY	CF/BBL	/64"	
FLOWING TUBING PRESSURE	SHUT-IN TUBING PRESSURE	CASING PRESSURE	WATER PRODUCTION	BSSW
psig	psig		BPD	%
GRAVITY	BHP (SHUT-IN)	COMPANY REPRESENTATIVE	DATE GAUGED	
*API 60° F	psig			

PLUG AND ABANDON (P & A) DATA

CASING SIZE	AMOUNT PULLED	CEMENT PLUGS				DATE WORK PERFORMED	NAME OF TEST WITNESS - STATE IF CONSERVATION AGENT OR OFFSET OPERATOR
		FROM	TO	SACKS	HOW PLACED		
7"	2675	9700'	9800'	25	Pumped	12-16-81	
10-3/4"	0	2600'	2800'	65	Pumped	12-16-81	
16"	0	5'	55'	25	Pumped	12-16-81	

CERTIFICATE: I, the undersigned, state that I am employed by MCOR Oil Dev., Inc. and that I am authorized to make this report, and that this report was prepared under my supervision and direction and that all facts stated herein are true, correct and complete to the best of my knowledge.

Signature: Jane Ashcraft Title: Sr. Production Analyst

*Date well is equipped to produce, but due to no available market, no pipe line connection, etc., the well has been shut-in.

WORK RESUME

List below all work performed under Office of Conservation Work Permits while drilling and completing well.

WORK PERMIT NO.	DATE WORK PERFORMED	SERVICE COMPANY	DESCRIPTION OF WORK
1313-81	12-16-81	Seaboard Pipe & Equipment Company	P&A - Set plug at 9700'-9800' with 25 sacks cement, set plug at 2600'-2800' with 65 sacks, set plug at 5'-55' with 25 sacks. Cut 10-3/4" casing 4' below ground level and weld 1/2" plate on top of casing.

RECEIVED

MAR 22 1982

DEPT. OF CONSERVATION
WELL FILES
BATON ROUGE, LA.

List below all important Paleofaunal or Geological Formation tops, Cap Rock and Salt Overhang bottoms.

FORMATION	DEPTH	FORMATION	DEPTH
		CONSERVATION DEPT. DEC 28 1981	

CHARLES

STATE OF LOUISIANA
OFFICE OF CONSERVATION

Inter Office

Date: 12/28/81

To: Baton Rouge Office
From: Lake Charles District
Attn: T. P. Heard

Enclosed herewith please find application from MCOR Oil Development, Inc.
for permit to amend name
their Dr. M. O. Miller #1, Crab Lake Field
Cameron Parish, Louisiana. Zone Onshore

Also enclosed please find:

Check No. _____ in the amount of \$ _____.

_____ Well location plat
_____ Well Location certification

_____ Form A.D.C.
_____ Electric Log
_____ Schematic diagram
_____ (Dual) structure map if well does not comply with existing Orders
_____ (Selective-Onshore) structure map showing reservoir limits
_____ (Selective-Offshore) letter(s) of no objection from offset operators

29-B
Order 865

Applicable Department of Conservation Order No. 29-B; 865.

Pending Hearing, Docket No. _____.

Remarks & Recommendations: Recommend approval. This well has been recompleted out of the unit sand and returns to lease status. This amendment is exempt from the fee.

FORMERLY: 9900 RA SUA; Miller #1

By *W. G. White*
District Manager

cc: Geological Oil & Gas Division
Prod. Audit (for Amended Permits only)

LT-1

MEMORANDUM

1911

MEMORANDUM

1911

MEMORANDUM

MEMORANDUM

MEMORANDUM

MEMORANDUM

MEMORANDUM

MEMORANDUM

MEMORANDUM

MEMORANDUM

MEMORANDUM

MEMORANDUM

MEMORANDUM

MEMORANDUM

MEMORANDUM

MEMORANDUM

MEMORANDUM

MEMORANDUM

MEMORANDUM

MEMORANDUM

MEMORANDUM

MEMORANDUM

MEMORANDUM

MEMORANDUM

MEMORANDUM

MEMORANDUM

MEMORANDUM

MEMORANDUM

MEMORANDUM

MEMORANDUM

MEMORANDUM

MEMORANDUM

MEMORANDUM

MEMORANDUM

MEMORANDUM

MEMORANDUM

MEMORANDUM

MEMORANDUM

MEMORANDUM

MEMORANDUM

MEMORANDUM

MEMORANDUM

MEMORANDUM

MEMORANDUM

MEMORANDUM

MEMORANDUM

MEMORANDUM

MEMORANDUM

MEMORANDUM

MEMORANDUM

MEMORANDUM

MEMORANDUM

MEMORANDUM

MEMORANDUM

MEMORANDUM

MEMORANDUM

Change
 Correction
8169 Effective Date
yymm
9999 End Date
yymm

147552 Serial No. LC Date 1-14-82
CURRENT CODES
012 PARISH Cameron
3000 FIELD Crab Lake
3637 OPERATOR MCOR Oil Development Inc.
ADDRESS 4801 Woodway, Ste 480W
CITY & STATE Houston, TX 77056

FORMER CODES

AMENDMENT ACTION
0.0.9. PARISH
0.3.4. FIELD
0.3.5. OPERATOR
0.1.6. LSE-UN
0.1.6. UN-LSE
0.1.6. LSE-LSE
0.1.6. UN-UN
0.1.4. WELL NO.
5.2.1. LOCATION

147552 WELL NAME Dr M O Miller * No. 1 606975
LOCATION OF WELL: Sec. 20 T 15S R 5W Former Well No.
Location Same. *Formerly: 9900 RA SUA; Miller

Applicable Department of Conservation Order

[Signature]
Commissioner

[Signature]
Issuing Authority

WELL FILE COPY

No.

A-C

State of Louisiana



R. T. SUTTON
COMMISSIONER

OFFICE OF CONSERVATION
P.O. BOX 44275 - CAPITOL STATION
BATON ROUGE, LOUISIANA 70804

January 28, 1982

RE: 'Cameron Parish
Crab Lake Field
Dr M O Miller #1
Ser#147552

MCOR Oil Development Inc.
4801 Woodway, Ste 480W
Houston, TX 77056

Gentlemen:

The above application for Amended Permit to Drill is approved with the understanding there will be no completion in any reservoir which is not in compliance with the provisions of the Louisiana Office of Conservation Orders of the 865 Series, for the above captioned field and parish.

In addition, the amended permit to drill is issued with the understanding that you will furnish the appropriate District Manager with Inclination and/or Directional Survey data as proof that the well has been drilled in compliance with the provisions of Statewide Order No. 29-B, Section XVIII, dated March 1, 1967.

Very truly yours,

R.T. SUTTON, COMMISSIONER
OFFICE OF CONSERVATION

BY 
J.W. Hecker
Chief Engineer

cc: Mr. W.C. Wilhite
District Manager
Lake Charles

JWH/TPH/lb

Special Order & 29-B